

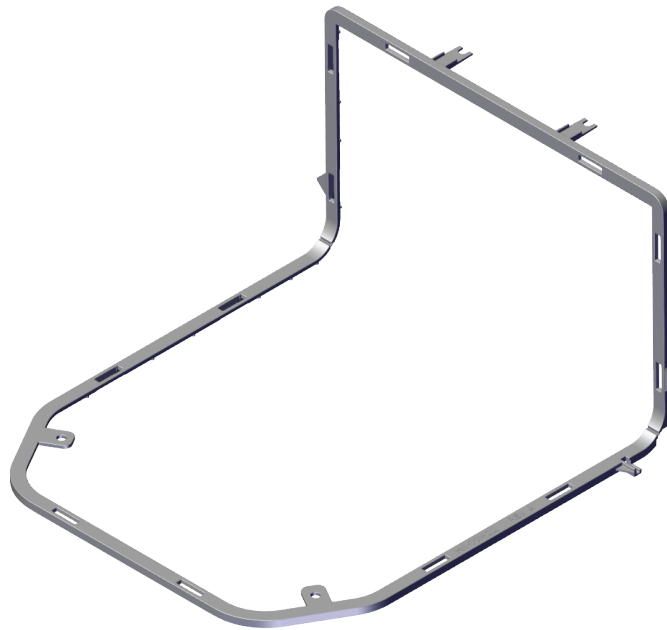

Checkpoint Antenna, MP72

Kit Instructions

7896



7896-K942

Issue A

Copyright and Trademark Information

The product described in this document is a licensed product of NCR Voyix Corporation.

Product names mentioned in this publication may be trademarks or registered trademarks of their respective companies and are hereby acknowledged.

Where creation of derivative works, modifications or copies of this NCR Voyix copyrighted documentation is permitted under the terms and conditions of an agreement you have with NCR Voyix, NCR Voyix's copyright notice must be included.

Disclaimer:

It is the policy of NCR Voyix Corporation to improve products as technology, components, software and firmware become available. NCR Voyix therefore reserves the right to change specifications without prior notice.

All features, functions and operations described herein may not be marketed by NCR Voyix in all parts of the world. In some instances, photographs are of equipment prototypes.

Therefore, before using this document, consult with your NCR Voyix representative or NCR Voyix office for information that is applicable and current.

© 2025

By NCR Voyix Corporation

Atlanta, Georgia, USA

All Rights Reserved

Revision Record

Publication issue	Date	Remarks
A	Oct 2025	Initial Release

7896-K942 Checkpoint Antenna, MP72

This kit provides a Checkpoint Antenna for the NCR Voyix 7896 Scanner/Scale.

Kit Contents

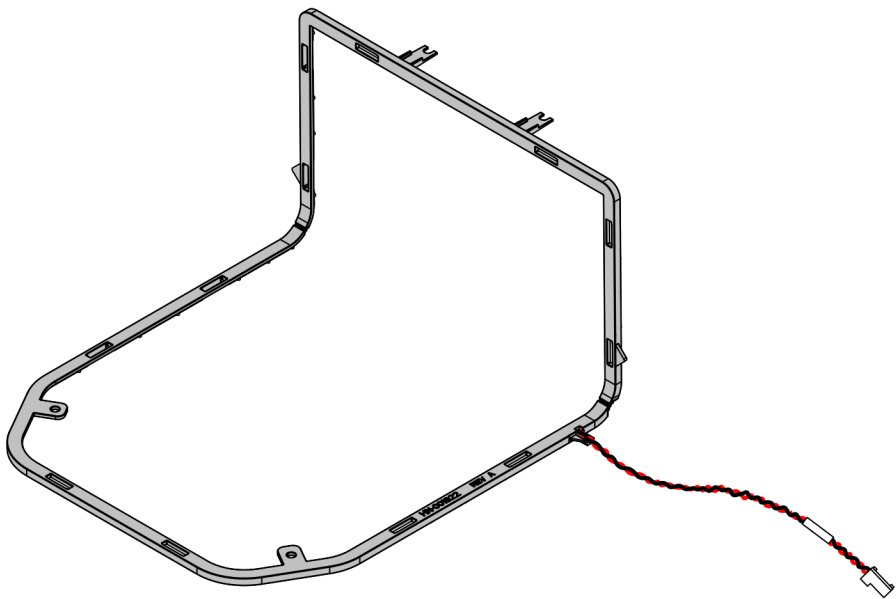

CCP-86053

Part Number	Description
497-0538668	Assembly, Checkpoint Antenna, MP72

Installation Procedure

1. Remove the Top Plate.

- **For Full-size scanner-only models**

Hold the front edge and the top of the Top Plate, and then lift the Top Plate off the scanner.

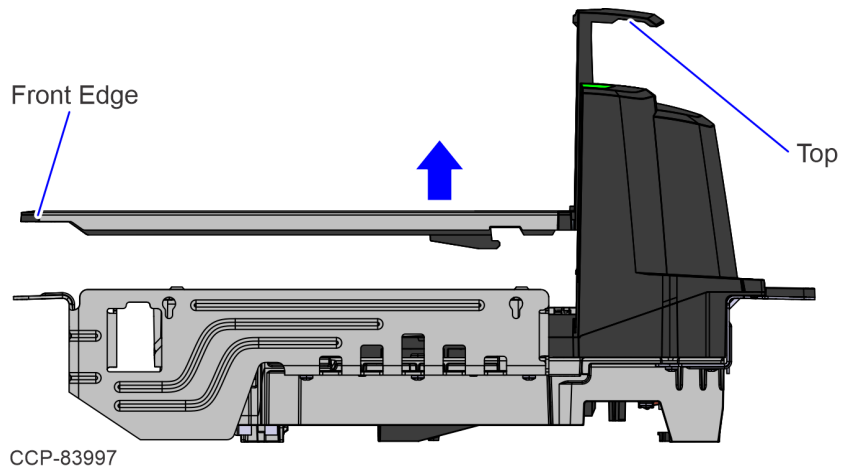

- **For Full-size scanner/scale models**

- Slightly lift up the front edge of the Top Plate and slide the Top Plate forward until its hooks are released from the positioning tabs on the scale.

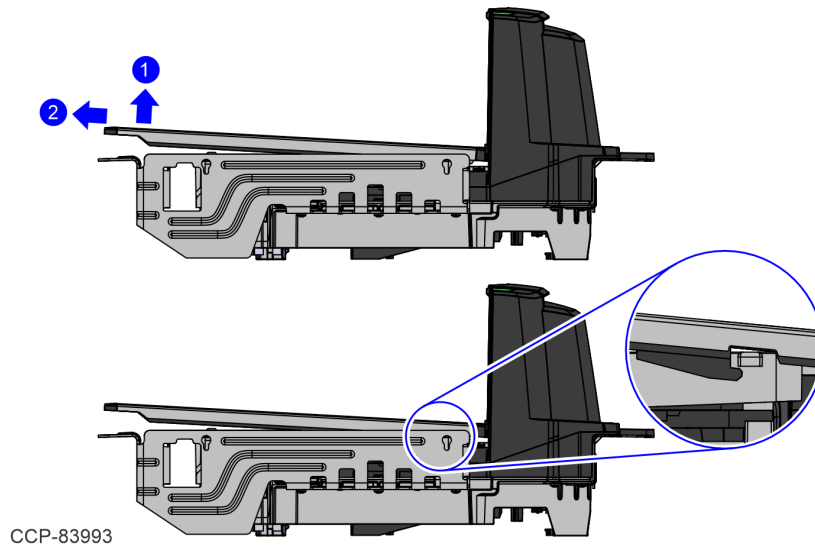

- Holding the front edge and the top of the Top Plate, lift it off the scanner.

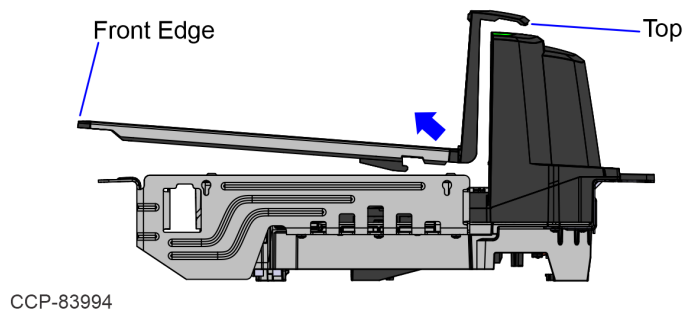

- **For Midsize and Compact models, scanner-only and scanner/scale**

Hold the front edge and the top of the Top Plate, and then lift the Top Plate off the scanner.

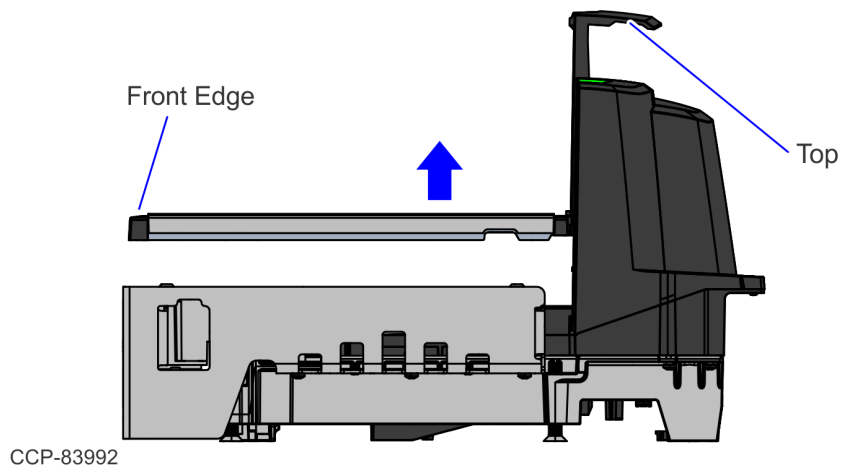

2. Place the Checkpoint Antenna around the Vertical Scan Window and into the scanner housing, with the antenna cable routed through the side of the scanner. Ensure that the top of the Checkpoint Antenna does not extend above the top surface of the scanner.

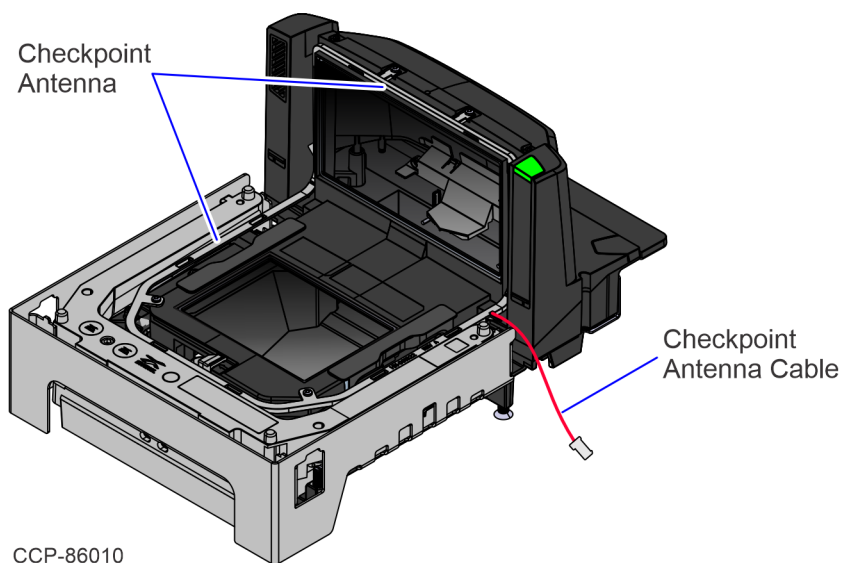

3. Secure the Checkpoint Antenna using four (4) screws and a T8 Torx screwdriver.

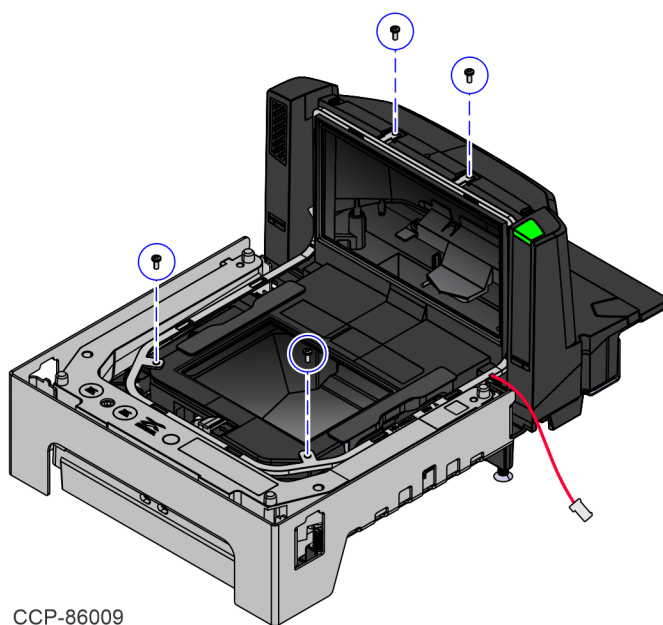

4. Re-install the Top Plate.

- **For Full-size scanner-only models**

Hold the front edge and the top of the Top Plate, and then lower the Top Plate onto the scanner until it sits on the tabs of the metal frame.

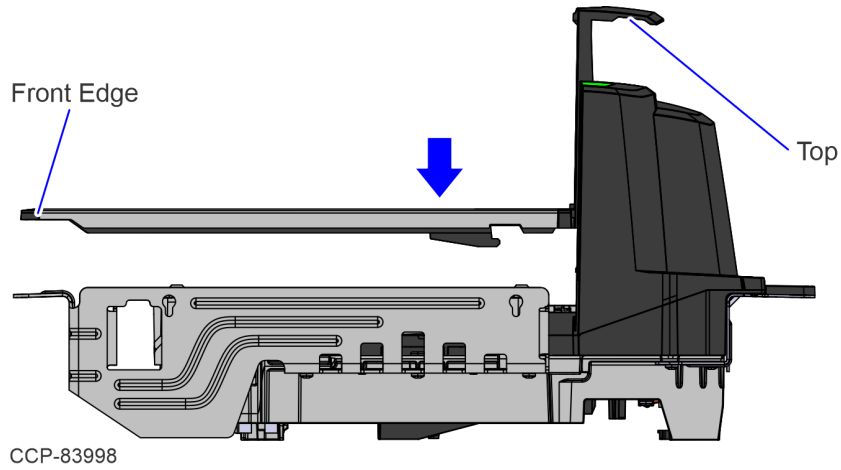

- **For Full-size scanner/scale models**

- a. Holding the front edge and the top of the Top Plate, and with the Top Plate slightly tilted, position the Top Plate on top of the scanner base.
- b. Slide the Top Plate onto the scanner base until the hooks on the bottom of the Top Plate are positioned under the tabs on the scale.

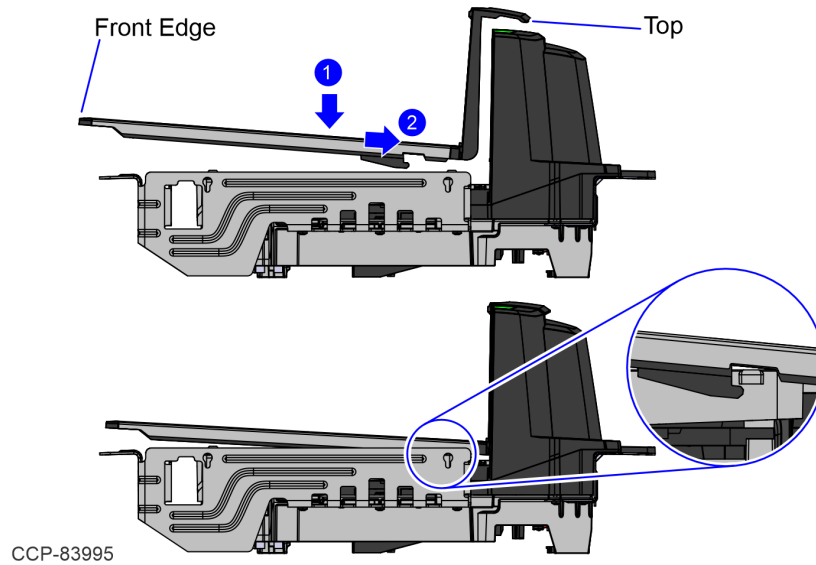

- c. Lower the front edge of the Top Plate until the Top Plate sits securely on the scanner base.

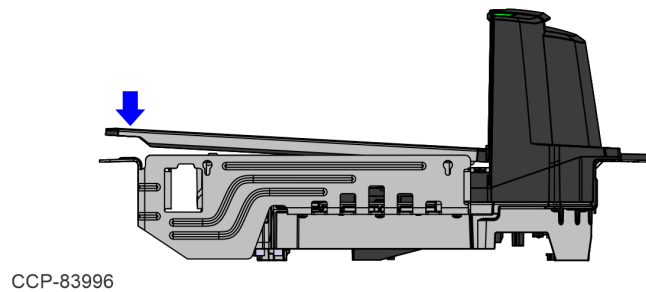

- **For Midsize and Compact models, scanner-only and scanner/scale**

Hold the front edge and the top of the Top Plate, and then lower the Top Plate onto the scanner until it is secure.

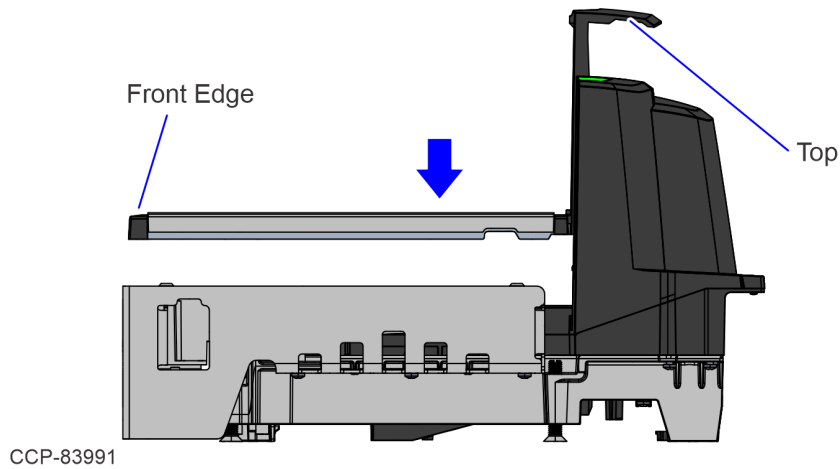

5. Route the Checkpoint Antenna away from the data cables to prevent electromagnetic interference.
6. Contact your local Checkpoint representative to install the EAS cable to the Checkpoint System. Refer to the Checkpoint device documentation for details about its functionality.



Note

The following cables are also required to complete the Checkpoint EAS installation:

- Checkpoint Interlock Cable (1432-C887-0030)—connects the Checkpoint Controller to the Checkpoint Interlock port of the NCR Voyix 7896 Scanner/Scale.
- Checkpoint Antenna Extender (1432-C893-0030)—connects the Antenna Cable to the Checkpoint Controller.