

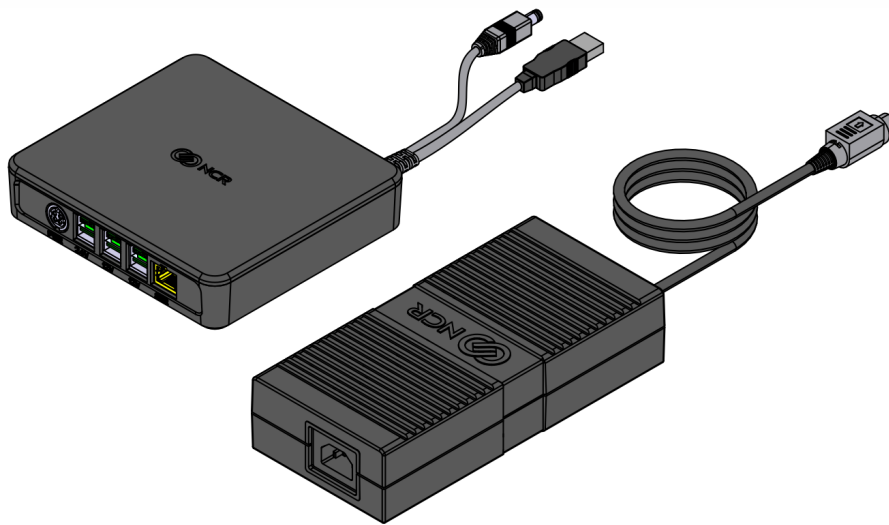

NCR Voyix 9700

Expansion Box for 7746

9700-0036-7746



BCC5-0000-5789

Issue B

Copyright and Trademark Information

The product described in this document is a licensed product of NCR Voyix Corporation.

NCR Voyix Configurable Assemblies is a trademark of NCR Voyix Corporation in the United States and/or other countries. Other product names mentioned in this publication may be trademarks or registered trademarks of their respective companies and are hereby acknowledged.

Where creation of derivative works, modifications or copies of this NCR Voyix copyrighted documentation is permitted under the terms and conditions of an agreement you have with NCR Voyix, NCR Voyix's copyright notice must be included.

Disclaimer:

It is the policy of NCR Voyix Corporation to improve products as technology, components, software and firmware become available. NCR Voyix therefore reserves the right to change specifications without prior notice.

All features, functions and operations described herein may not be marketed by NCR Voyix in all parts of the world. In some instances, photographs are of equipment prototypes.

Therefore, before using this document, consult with your NCR Voyix representative or NCR Voyix office for information that is applicable and current.

© 2018–2025

By NCR Voyix Corporation

Atlanta, Georgia, USA

All Rights Reserved

Preface

Audience

This publication is written for hardware installer/service personnel, system integrators, and field engineers.



Note

This document is NCR Voyix proprietary information and is not to be disclosed or reproduced without consent.

Table of Contents

9700-0036-7746 Expansion Box for 7746	6
Installation Procedure	7

Revision Record

Publication issue	Date	Description of change
A	Oct 2018	First issue
B	Jul 2025	<ul style="list-style-type: none">• Updated to NCR Voyix brand.• Added IP book number.

9700-0036-7746 Expansion Box for 7746

This kit provides an Expansion Box for the NCR PX10/PX15 POS (7746).

Expansion Box, 7746
497-0519751

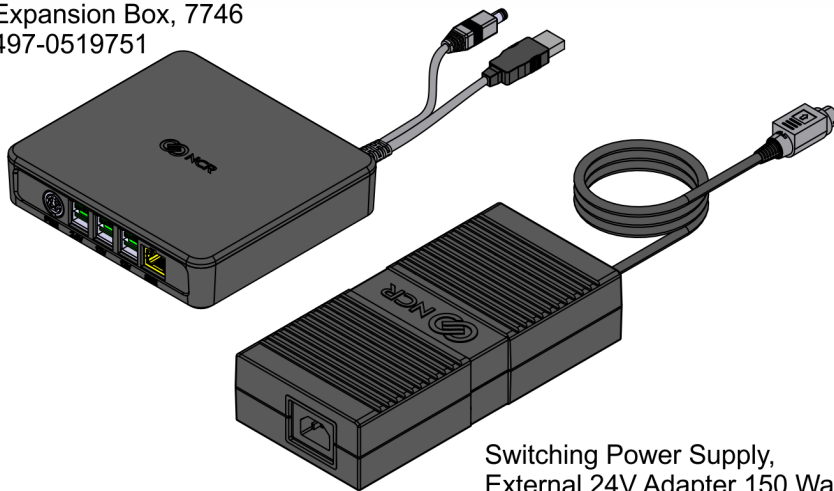

Switching Power Supply,
External 24V Adapter 150 Watt
497-0508598

CCP-75433

Installation Procedure

1. Connect the Expansion Box to the NCR PX10/PX15 POS (7746).
 - a. Connect the USB cable of the Expansion Box to any available USB Port on the terminal.
 - b. Connect the Power cable of the Expansion Box to the Power Input Port of the terminal.

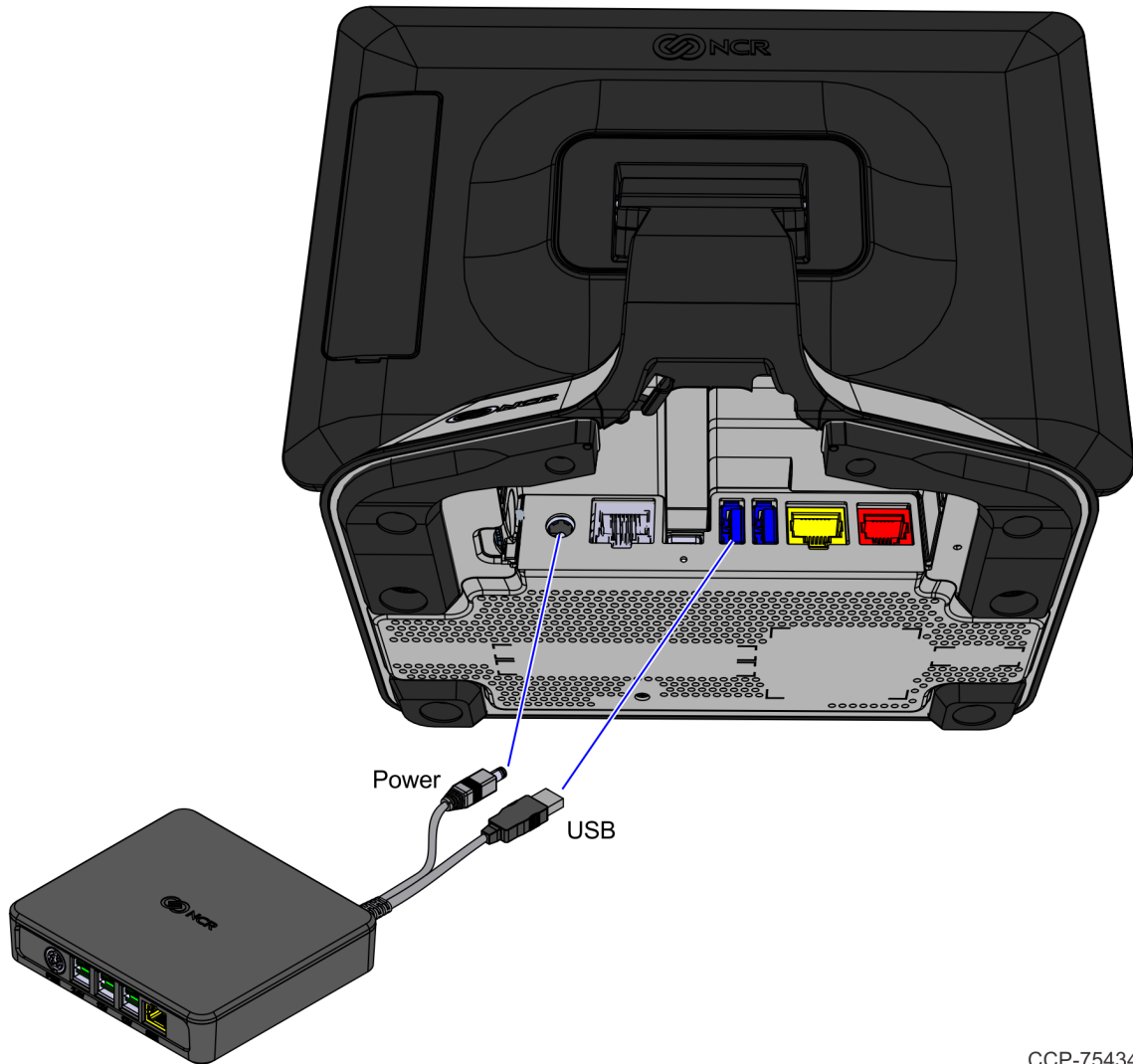

CCP-75434

2. Connect the Power Supply Cable to the Expansion Box.

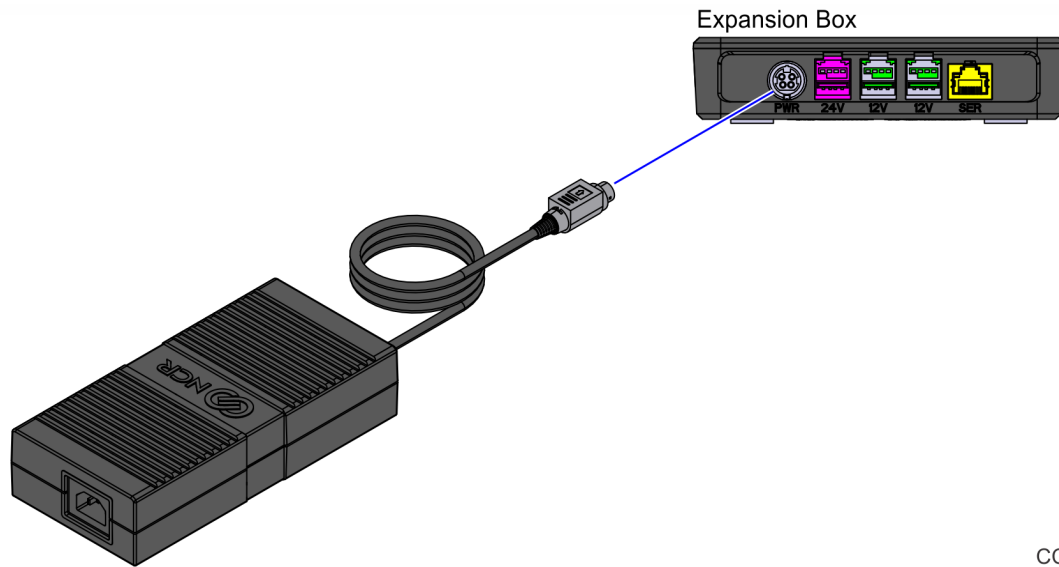

CCP-75435