



NCR Voyix SelfServ™ 90 (7709)

Kit Instructions

TPP Saturn 1000-L Mount

7709-K904
Issue B

Copyright and Trademark Information

The product described in this document is a copyrighted work of NCR Voyix Corporation.

NCR Voyix SelfServ™ 90 (7709) is a trademark of NCR Voyix Corporation.

It is the policy of NCR Voyix Corporation to improve products as technology, components, software and firmware become available. NCR Voyix therefore reserves the right to change specifications without prior notice.

All features, functions and operations described herein may not be marketed by NCR Voyix in all parts of the world. In some instances, photographs are of equipment prototypes.

Therefore, before using this document, consult with your NCR Voyix representative or NCR Voyix office for information that is applicable and current.

© 2020 – 2026

By NCR Voyix Corporation

Atlanta, Georgia, USA

All Rights Reserved

Confidential and proprietary information of NCR Voyix.

Use and disclose solely pursuant to company instructions.

Table of Contents

7709-K904 TPP Saturn 1000-L Mount	5
Kit Contents	5
Installation Procedure	7

Revision Record

Publication issue	Date	Description of change
A	Aug 2020	First issue.
B	Jan 2026	Updated with NCR Voyix brand.

7709-K904 TPP Saturn 1000-L Mount

This publication provides procedures for installing the TPP Saturn 1000-L device using a mounting bracket on the NCR Voyix SelfServ™ 90 (7709).



Note

The TPP Saturn 1000-L device is provided by the customer.

Kit Contents

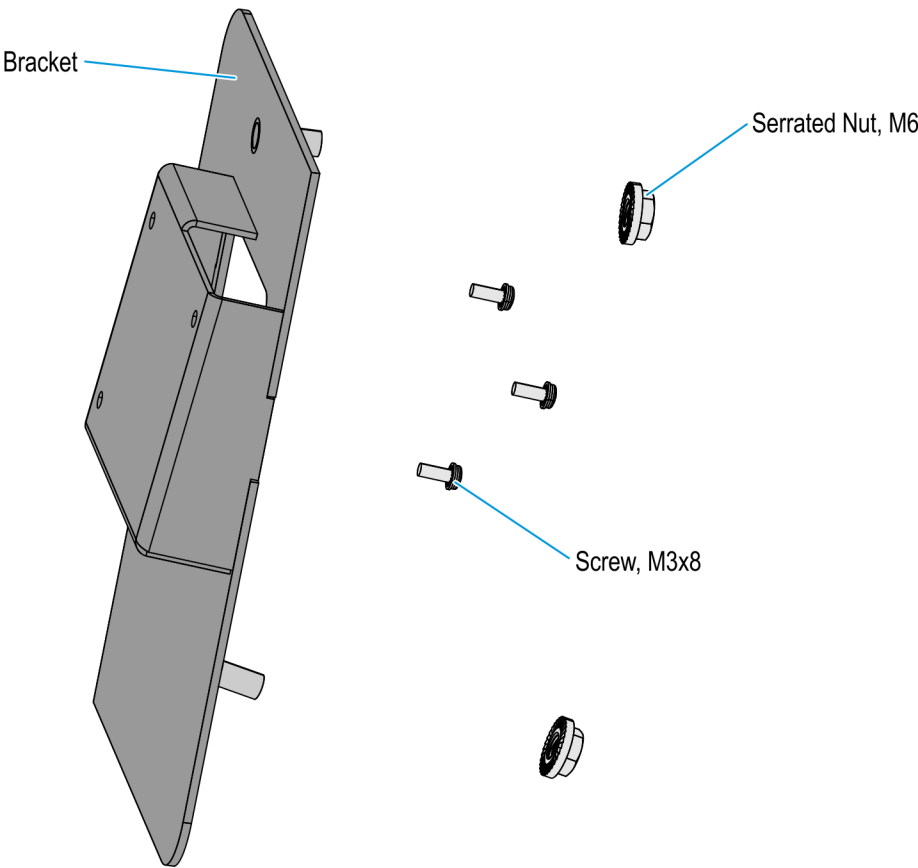

CCP-79461

Part Number	Description
497-0528347	7709-K904 TPP Saturn 1000-L Mount
497-0528349	Pin-Pad Bracket, Saturn 1000-L
006-8604588	Screw,M3X8,Sems,Phil,Pan,Stl,Z (3 Pcs)

Part Number	Description
006-8622925	Locknut - Hex, Serrated, M6 (2 Pcs)
* 497-0423108	Instructions-Kit (Reference Sheet)

* Items marked with an asterisk are not called out on the image.

Installation Procedure

1. Connect the cables to the Saturn 1000-L device.

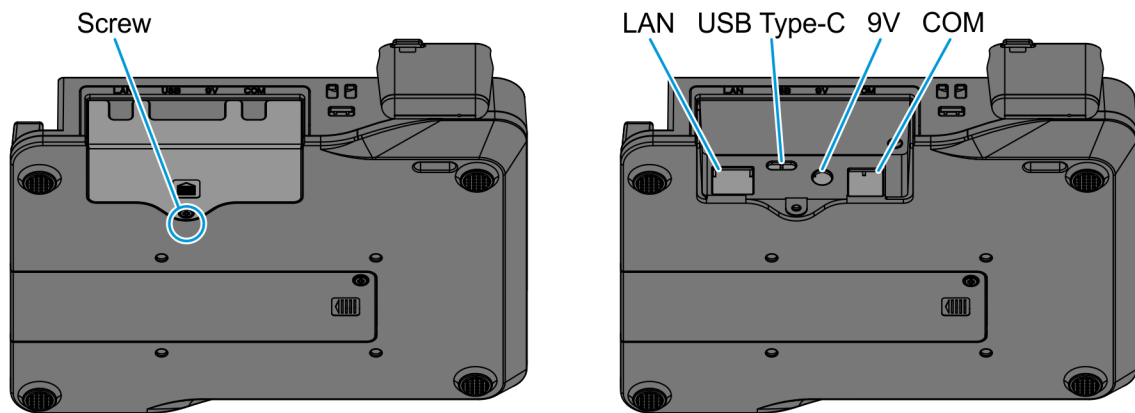

CCP-79459

- a. Remove the back cover by removing the screw indicated in the above image.
- b. Connect the cables to their corresponding ports.



Note

Cable connections may vary depending on customer configuration.

- c. Reinstall the back cover and secure using the screw.

2. Install the Saturn 1000-L onto its mounting bracket.

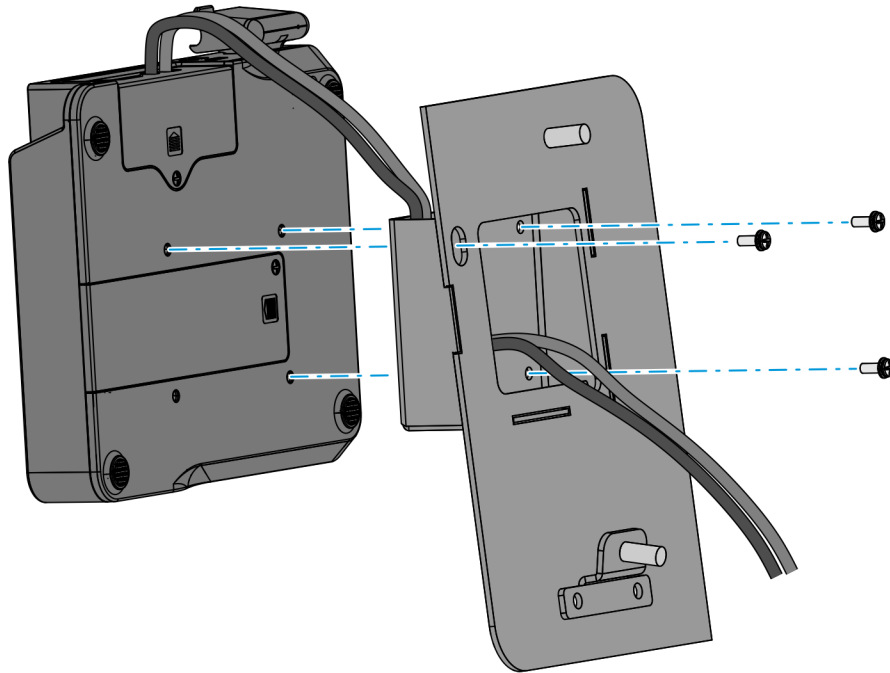

CCP-79460

- a. Route the cables through the cable access hole on the bracket.
- b. Align the Saturn 1000-L mounting holes with the bracket mounting holes, and then secure the Saturn 1000-L using three M3x8 screws.

3. Open the kiosk. Insert the key into the lock, turn the key clockwise, and carefully open the front of the kiosk.
 - For 7709 R1.0 and R1.1 units, the lock is located at the back of the kiosk.
 - For 7709 R1.2 and R2.x units, the lock is located at the right-hand side of the kiosk.

**Caution**

Do NOT abruptly open and release the front of the kiosk. Hold and support the front of the kiosk until fully extended.

**Note**

The image below shows a 7709 R1.2 unit.

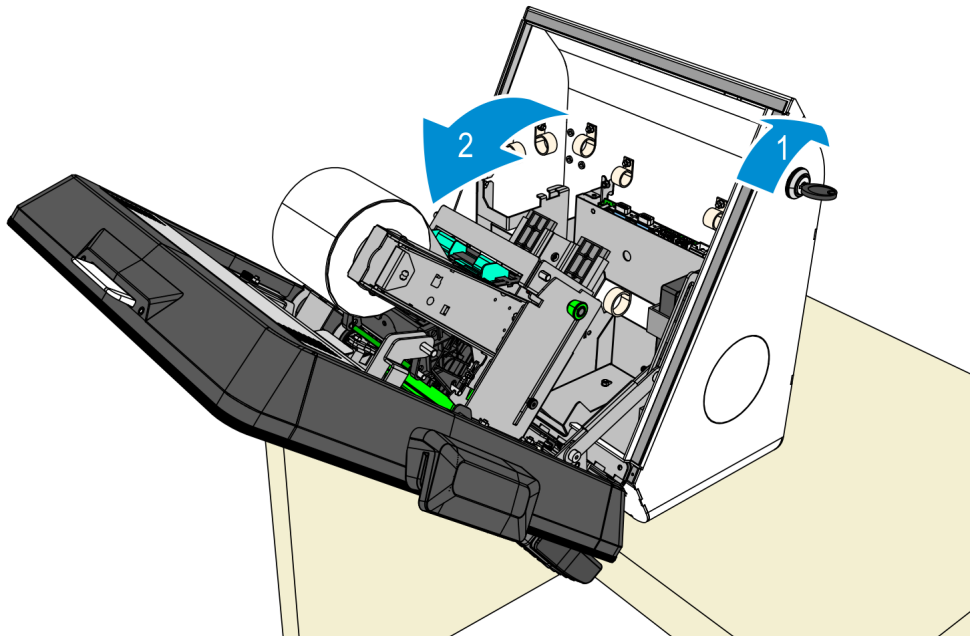

CCP-73618

4. Loosen the two thumbscrews that secure the Blank Plate to the Display Head, and then remove the Blank Plate.

**Note**

Hold the PIN Pad Blank Plate from outside the kiosk while loosening the thumbscrews.

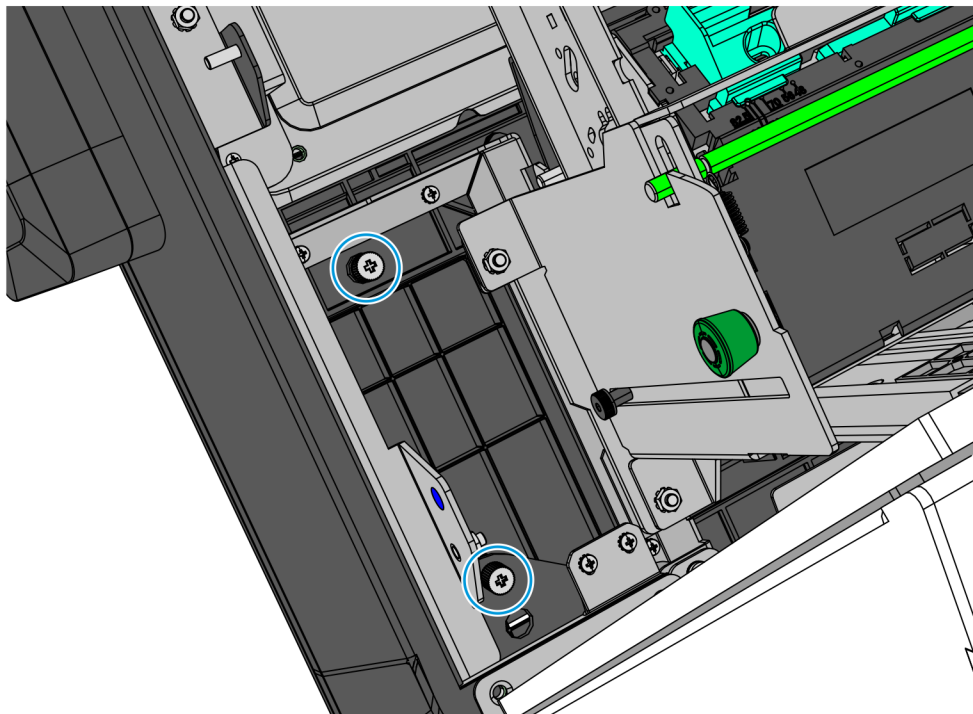

CCP-79457

5. Install the Saturn 1000-L Assembly on the Display Head by doing the following:
 - a. Route the Saturn 1000-L cables through the opening on the Display Head and insert the bracket mounting studs into the Display Head mounting holes.

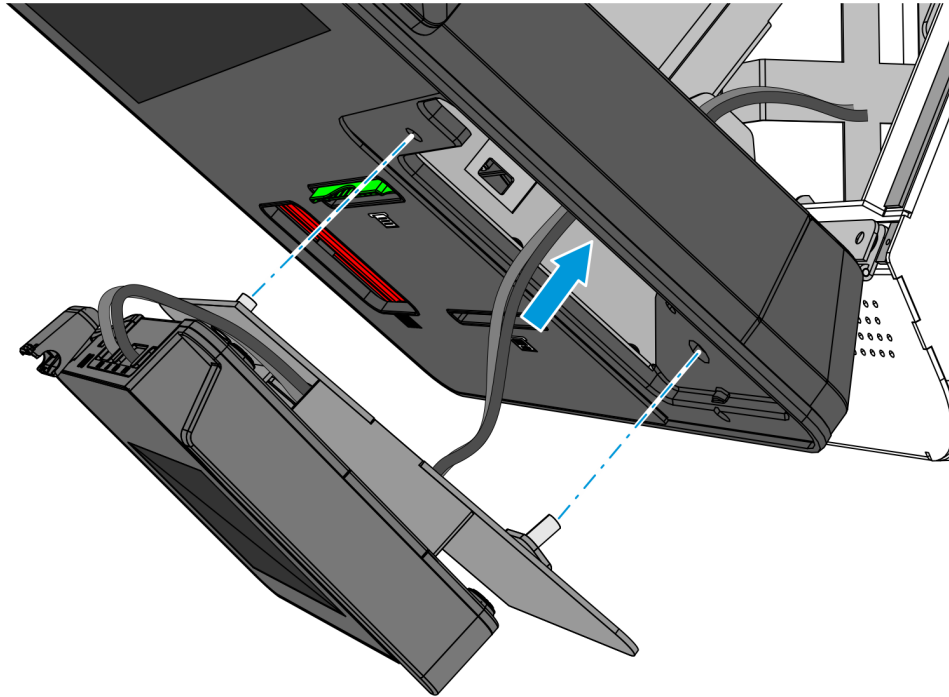

CCP-79456

- b. Secure the Saturn 1000-L Assembly using two M6 nuts.

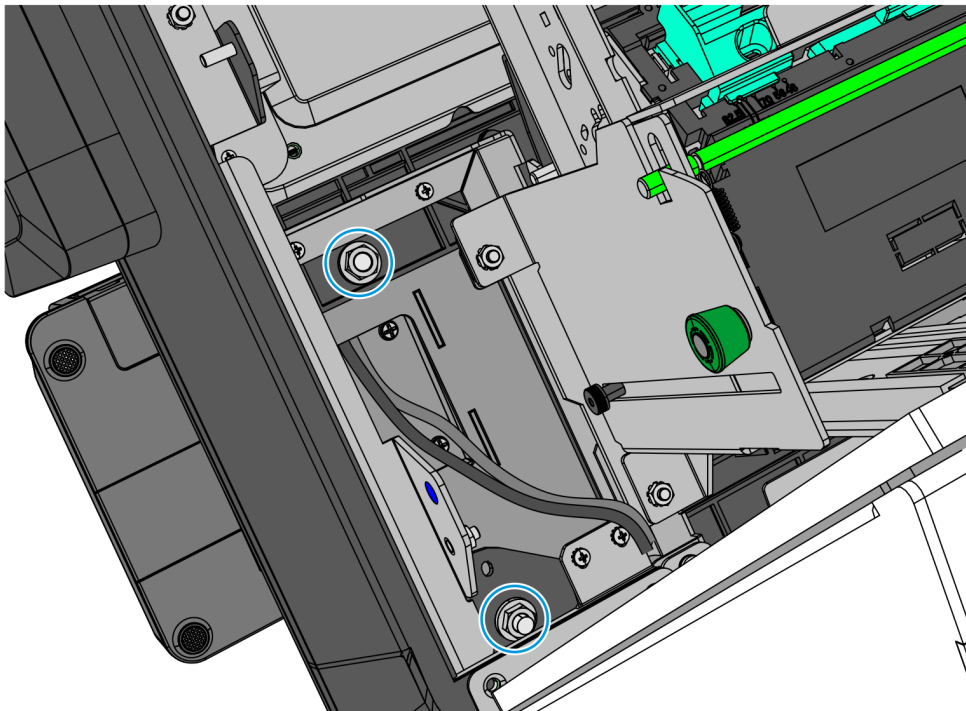

CCP-79458

- c. Connect the cables to their corresponding ports.



Note

Cable connections may vary depending on customer configuration.