



NCR Voyix SelfServ™ 90 (7709)

Kit Instructions

PIN Pad Arm



7709-K720
Issue C

Copyright and Trademark Information

The product described in this document is a copyrighted work of NCR Voyix Corporation.

NCR Voyix SelfServ™ 90 (7709) is a trademark of NCR Voyix Corporation.

It is the policy of NCR Voyix Corporation to improve products as technology, components, software and firmware become available. NCR Voyix therefore reserves the right to change specifications without prior notice.

All features, functions and operations described herein may not be marketed by NCR Voyix in all parts of the world. In some instances, photographs are of equipment prototypes.

Therefore, before using this document, consult with your NCR Voyix representative or NCR Voyix office for information that is applicable and current.

© 2016 – 2026

By NCR Voyix Corporation

Atlanta, Georgia, USA

All Rights Reserved

Table of Contents

7709-K720 PIN Pad Arm	5
Kit Contents	5
Installation Procedure	6

Revision Record

Publication issue	Date	Description of change
A	Apr 2016	First issue.
B	Sep 2017	Updated to remove parts and revise instructions.
C	Jan 2026	Updated with NCR Voyix brand.

7709-K720 PIN Pad Arm

This publication provides procedures for installing the 7709-K720 PIN Pad Arm to the NCR Voyix SelfServ™ 90 (7709).

Kit Contents

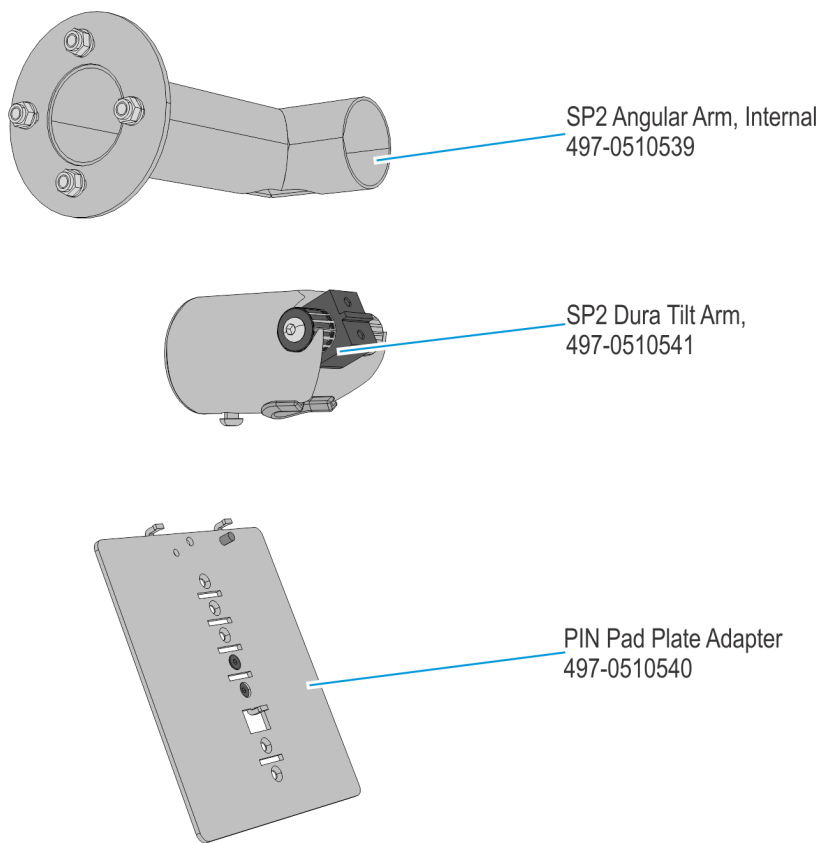

60898

Part Number	Description
497-0519761	7709-K720 PIN Pad Arm
497-0510539	SP2 Angular Arm, Internal C/M

Installation Procedure



Warning

Disconnect the AC power cord before disassembling the Terminal.

1. Open the front of the kiosk.

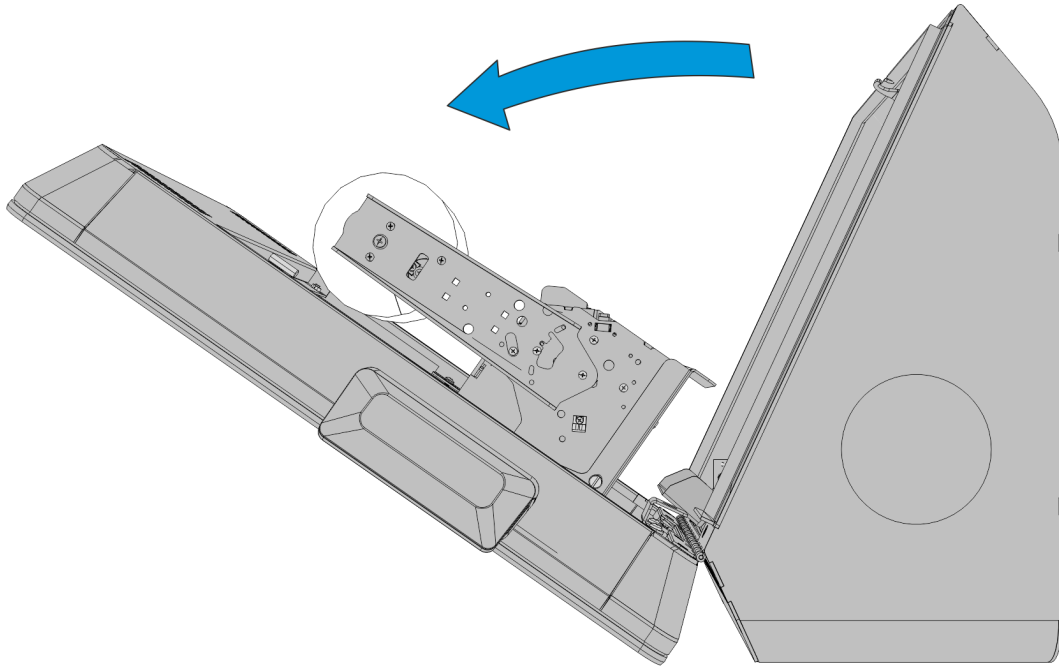

60922

2. Remove PIN pad arm blank plate.
 - a. Unstrap the cinch straps (2) that secure the power supply to the bracket. Remove the power supply and the cinch straps from the bracket.

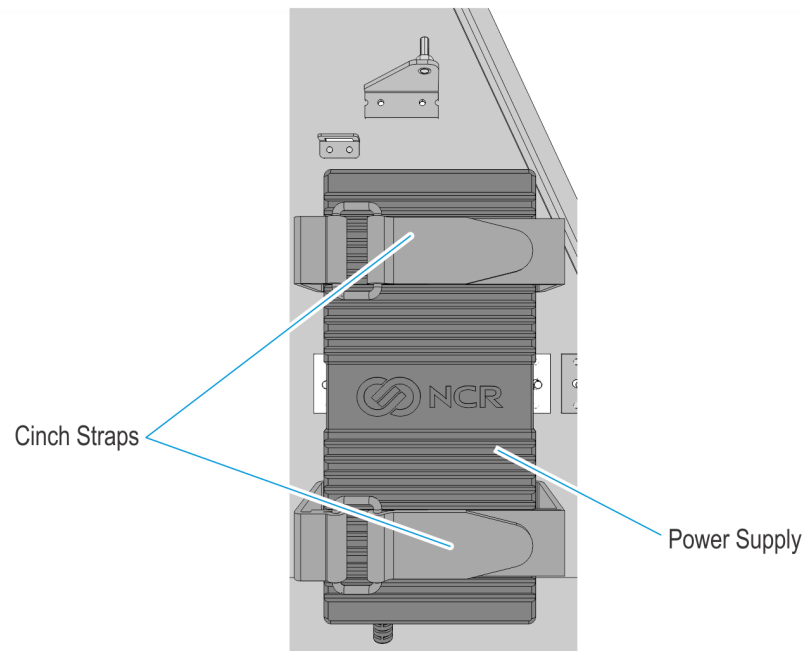

60907

- b. Remove the screws (2) that secure the power supply bracket. Remove the bracket.

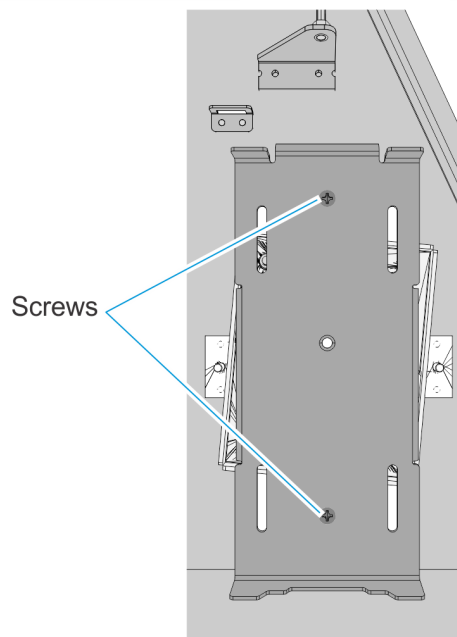

60906

- c. Remove the screws (2) that secure the blank plate. Remove the blank plate.

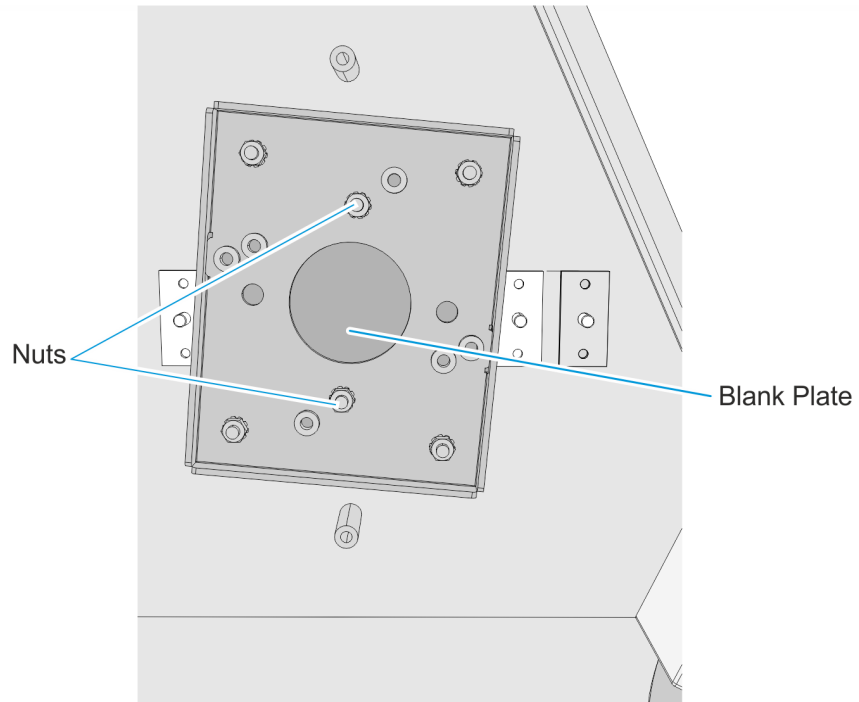

60905

3. From inside the kiosk cabinet, route the PIN pad cable out through the access hole and through the angular arm.

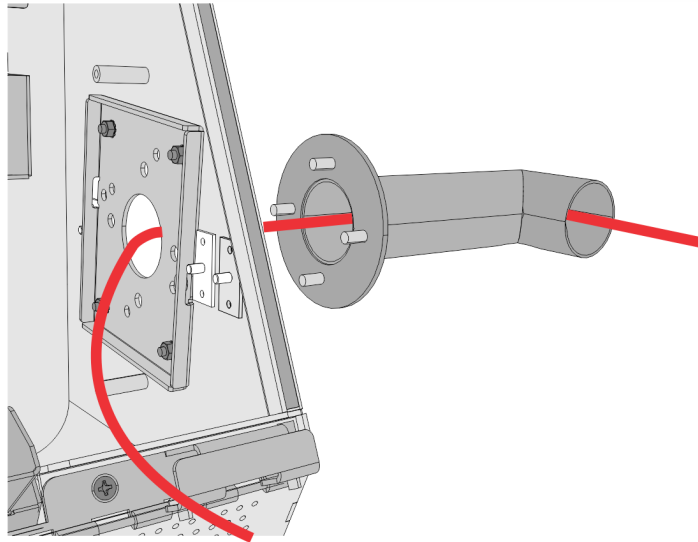

60904

4. Insert the mounting studs of the angular arm through the mounting holes on the cabinet and secure the arm with nuts (4).

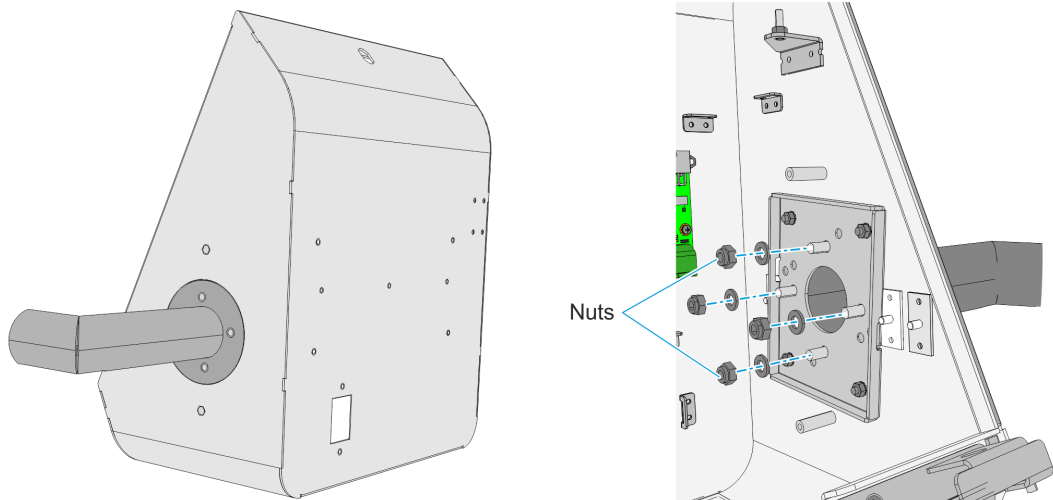

60901

5. Secure the tilt arm to the angular arm.
 - a. Route the PIN pad cable through the tilt arm, exiting through the lower opening.
 - b. Insert the angular arm to the tilt arm.

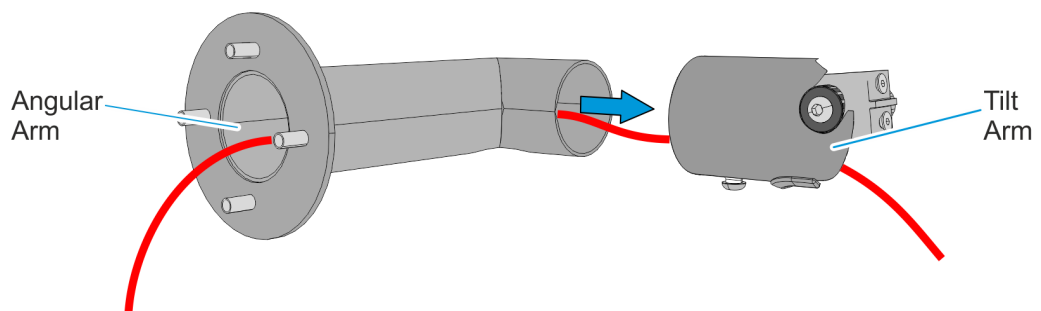

60903

- c. Adjust the tilt arm, rotating it clockwise or counter-clockwise, to position the locking screw at the center.

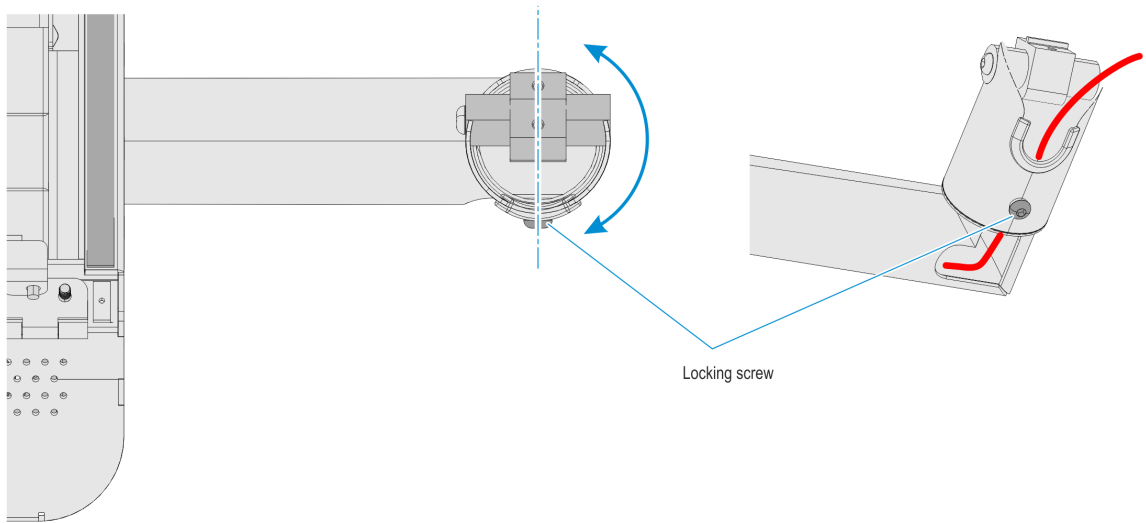

CCP-60870

- d. Tighten the screw to lock and secure the tilt arm.

6. Mount the PIN pad adapter plate into the mounting arms through the fourth mounting slot. Secure with screws (2).

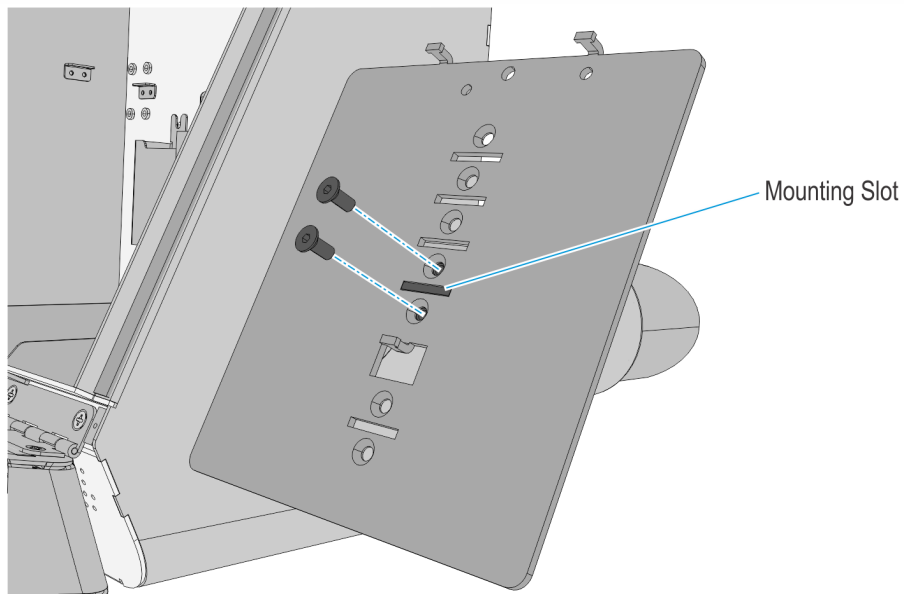

60900

7. Ensure that the left edge of the adapter plate is straight and parallel to the right edge of the cabinet.. Otherwise, adjust the tilt arm until the adapter plate is straight.

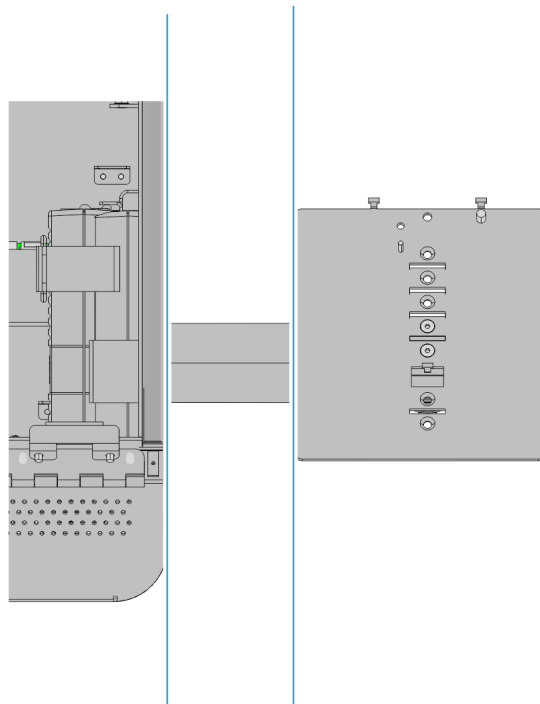

CCP-60868

8. Connect the PIN pad connector to the PIN pad.

9. Mount the PIN pad on the adapter plate.
 - a. Insert the PIN pad mounting holes through the hooks (3) on the adapter plate.

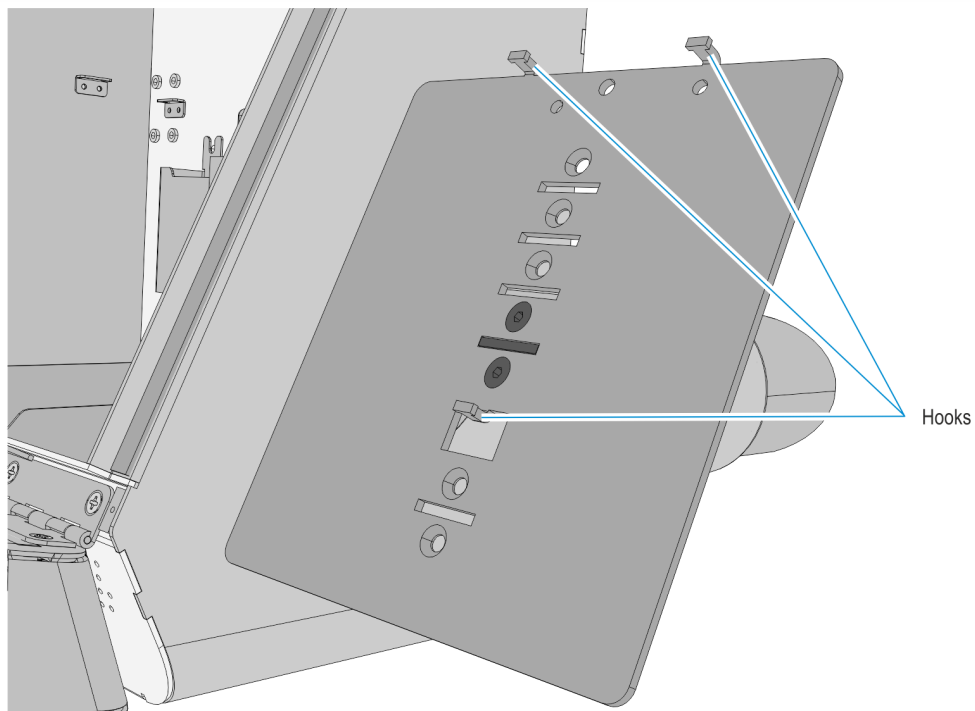

60867

- b. Tighten the screw at the upper left—hand corner to secure the PIN pad.

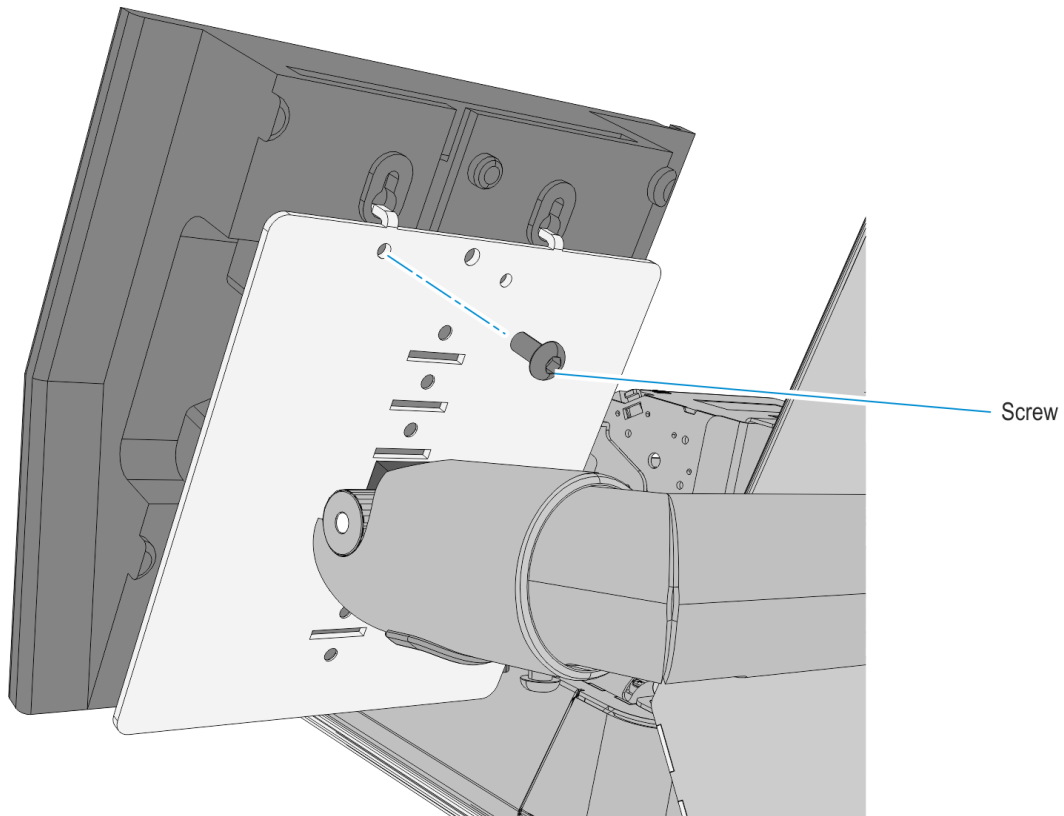

60899

10. Inside the kiosk cabinet, route and connect the PIN pad cable to the motherboard.
 - a. Route the PIN pad cable towards the motherboard as shown below.
 - b. Connect the USB+Power connector of the PIN cable to the 12V power USB C port on the motherboard.
 - c. Cable tie the cable along its route as necessary. Bundle the extra length of the cable with a cable tie and place it at the space on the left-hand side of the coupon bin.

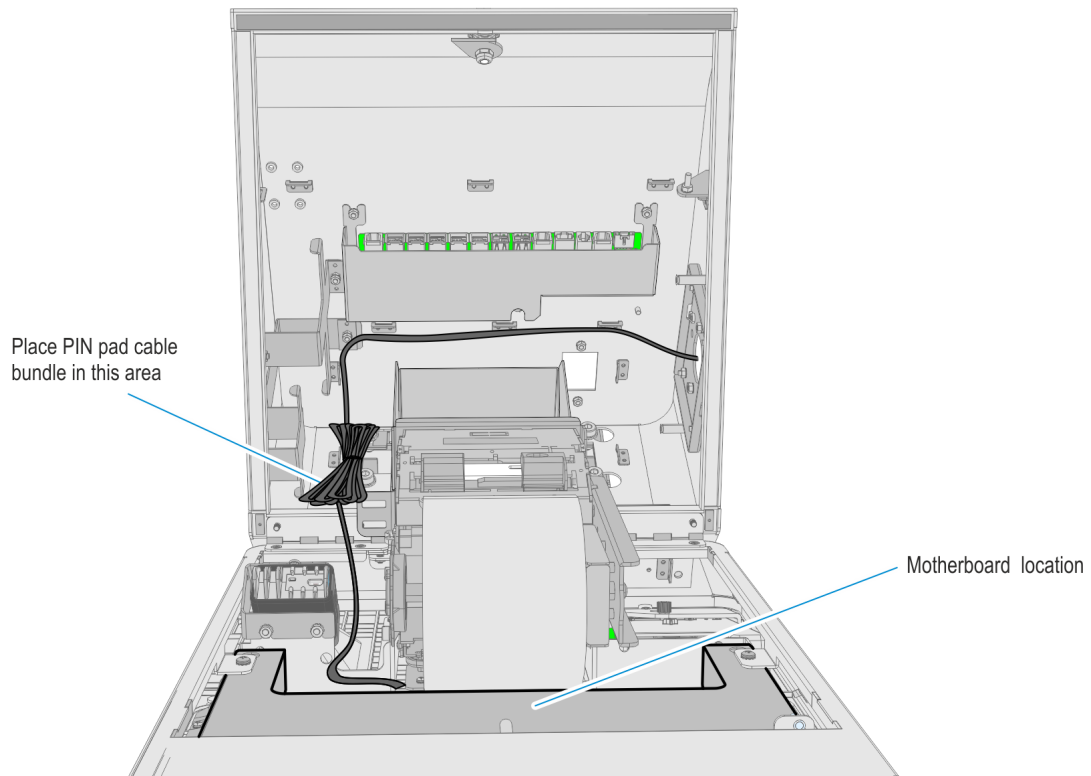

CCP-60848

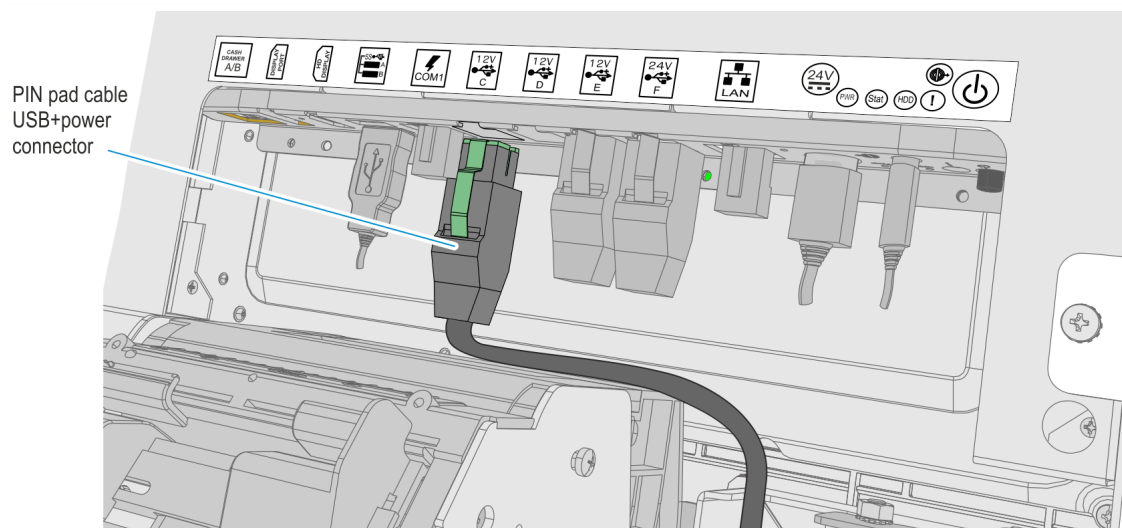

CCP-60849

11. Re-install the power supply bracket and power supply.
12. Ensure that the left edge of the PIN pad is straight and parallel to the right edge of the display head. Otherwise, adjust the tilt arm until the PIN pad is straight.

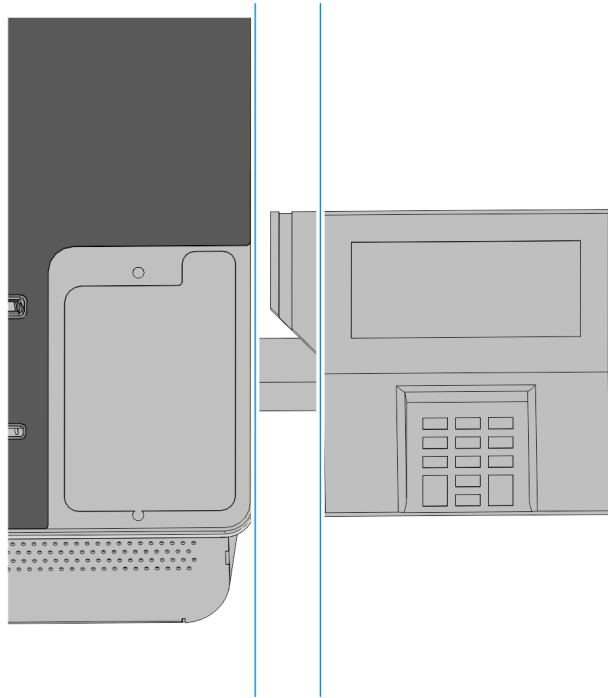

CCP-60869

13. Check that all the modules in the kiosk are functioning properly.