

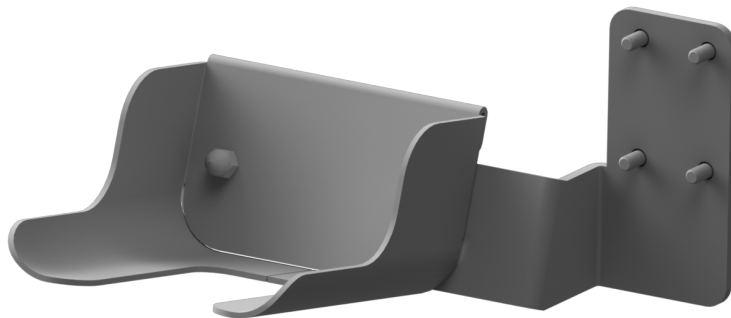

NCR Voyix SelfServ™ 90 (7709)

Kit Instructions

Handheld Scanner



7709-K700
Issue B

Copyright and Trademark Information

The product described in this document is a copyrighted work of NCR Voyix Corporation.

NCR Voyix SelfServ™ 90 (7709) is a trademark of NCR Voyix Corporation.

It is the policy of NCR Voyix Corporation to improve products as technology, components, software and firmware become available. NCR Voyix therefore reserves the right to change specifications without prior notice.

All features, functions and operations described herein may not be marketed by NCR Voyix in all parts of the world. In some instances, photographs are of equipment prototypes.

Therefore, before using this document, consult with your NCR Voyix representative or NCR Voyix office for information that is applicable and current.

© 2016 – 2026

By NCR Voyix Corporation

Atlanta, Georgia, USA

All Rights Reserved

Table of Contents

7709-K700 Handheld Scanner	5
Kit Contents	5
Installation Procedure	7

Revision Record

Publication issue	Date	Description of change
A	Apr 2016	First issue.
B	Jan 2026	Updated with NCR Voyix brand.

7709-K700 Handheld Scanner

This publication provides procedures for installing the 7709-K700 Handheld Scanner to the NCR Voyix SelfServ™ 90 (7709).

Kit Contents

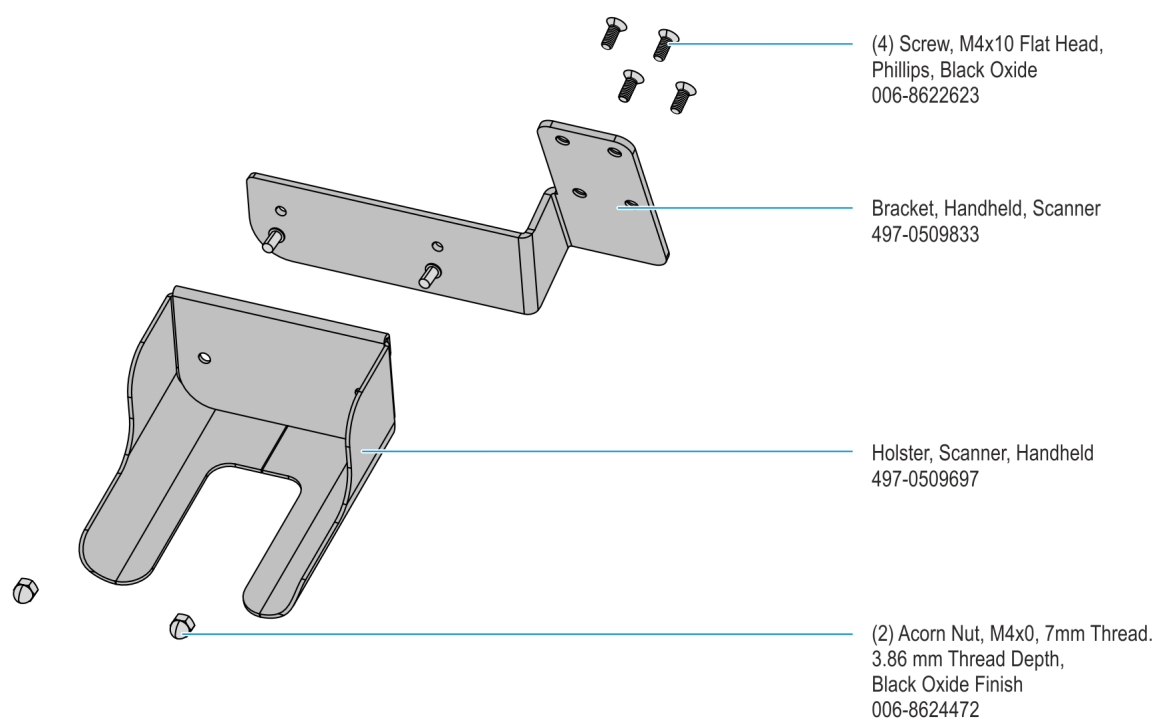

CCP-60571

Part Number	Description
497-0520694	Kit - Handheld Scanner W/ Packaging
006-8622623	Screw, M4 X 10, Flat Head, Phillips, Black Oxide (4 pcs)
006-8628973	Nylock Acorn Nut – M4 X 0.7Mm, 7Mm Width, 9.6Mm Height - Black Oxide Finish (2 pcs)
497-0531681	Holster, Scanner, Handheld

Part Number	Description
497-0509833	Bracket, Handheld, Scanner
006-8628477	End Cap - Handheld Holster (2 pcs)
* 497-0423108	Instructions-Kit (Reference Sheet)

* Items marked with an asterisk are not called out on the image.

Installation Procedure



Warning

Disconnect the AC power cord before disassembling the Terminal.



Caution

Make sure that the cables are routed as shown. Some units may have installed Sensormatic Modules which give off strong electrical discharge that may damage other modules.



Caution

Static Electricity Discharge may permanently damage your system. Discharge any static electricity build up in your body by touching your computer's case for a few seconds. Avoid any contact with internal parts and handle cards only by their external edges.

1. Shutdown and power off the kiosk.
2. Secure the Holster to the Bracket with acorn nuts (2).

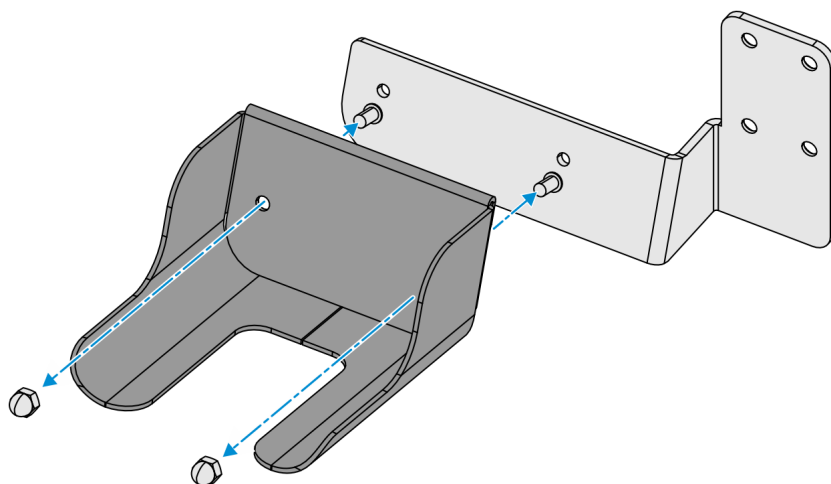

CCP-60572

3. Align the mounting holes of the Holster and Bracket assembly to the mounting holes at the back of the kiosk cabinet and secure with screws (4).

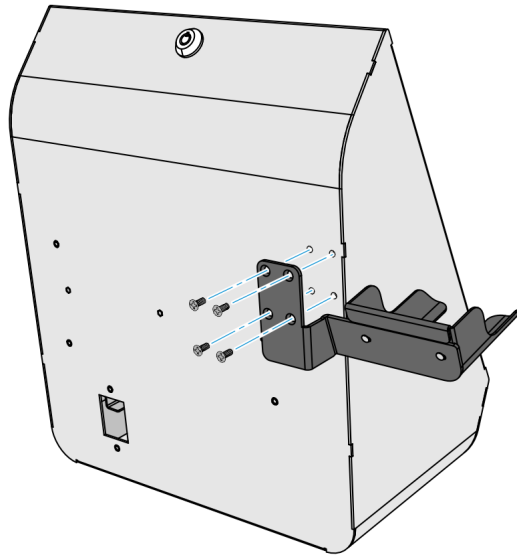

CCP-60573

4. Mount the handheld scanner unto the handheld scanner holster.
5. Perform either one of the procedures below to route the scanner cable into the kiosk cabinet and connect the cable to the I/O Daughter card.
 - ["Kiosk without Sensormatic Back Pack"](#) on the next page
 - ["Kiosk with Sensormatic Back Pack"](#) on page 10

Kiosk without Sensormatic Back Pack

1. Route the scanner cable into the cabinet through the rear access hole of the cabinet.
2. Inside the cabinet, route the cable upwards toward the I/O daughter card, running across the rear right-hand corner of the cabinet, behind the Power Supply. Then plug USB connector to the **USB A** port of the I/O Daughter Card. Cable tie the cable as shown below.

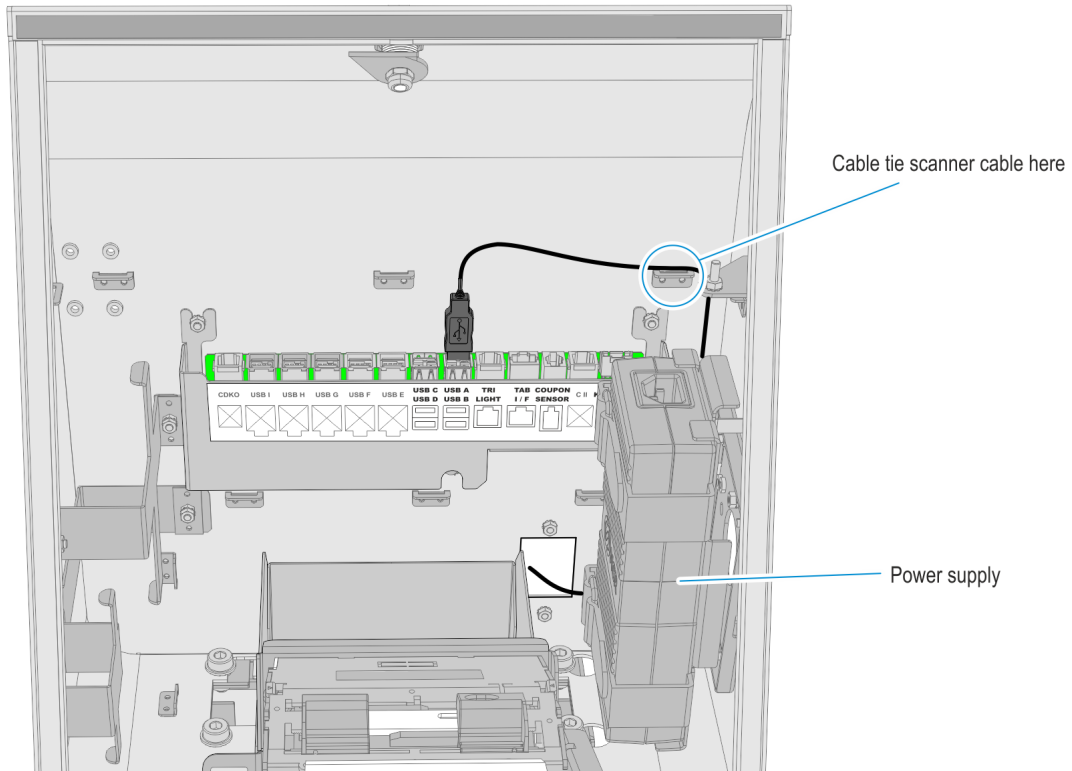

CCP-60850

3. Place all extra cable length of the scanner cable outside of the cabinet. Make sure that there is enough slack on the cable for the scanner to dismounted from the holster and scan items.

Kiosk with Sensormatic Back Pack



Caution

Make sure that the cables are routed as shown. Sensormatic Modules give off strong electrical discharge that may damage other modules.

1. Remove the sensormatic case cover. Remove screws (2 - one on each side) to remove the cover.

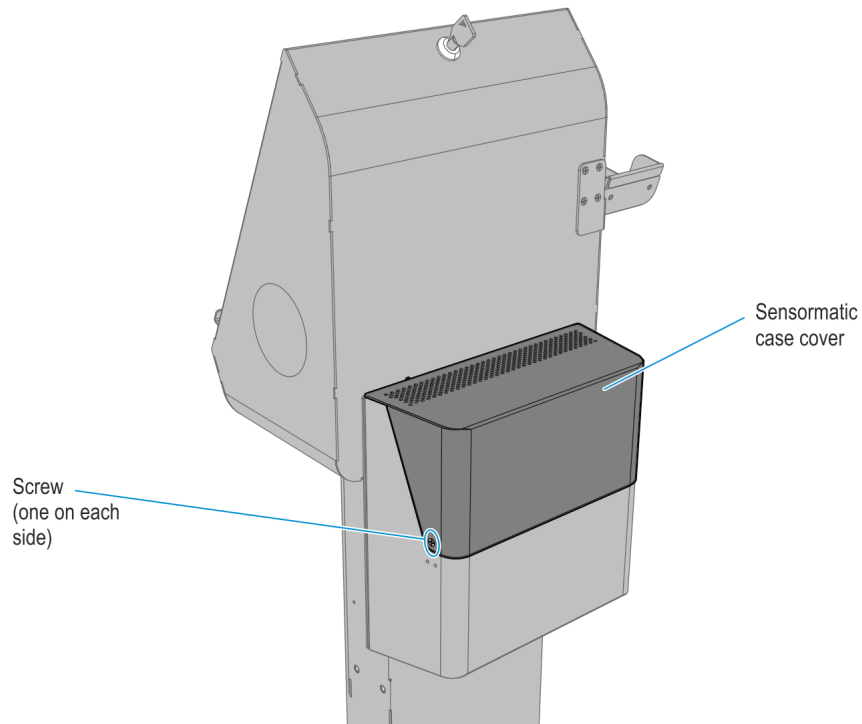

CCP-60575

2. Lift up the Sensormatic controller and route the cable through the access hole at the bottom of the Sensormatic case then upwards across the corner of the case then through the rear access hole of the cabinet.

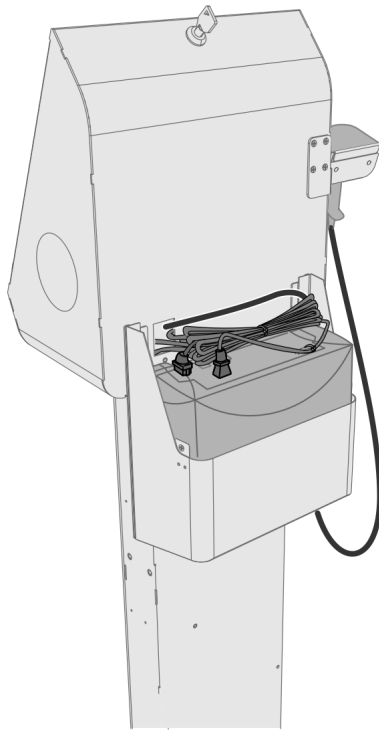

CCP-60570

3. Inside the cabinet, route the cable upwards toward the I/O daughter card, running across the rear right-hand corner of the cabinet, behind the PSU. Then plug the USB connector to the **USB A port** of the I/O daughter card. Cable tie the cable along its route as necessary.

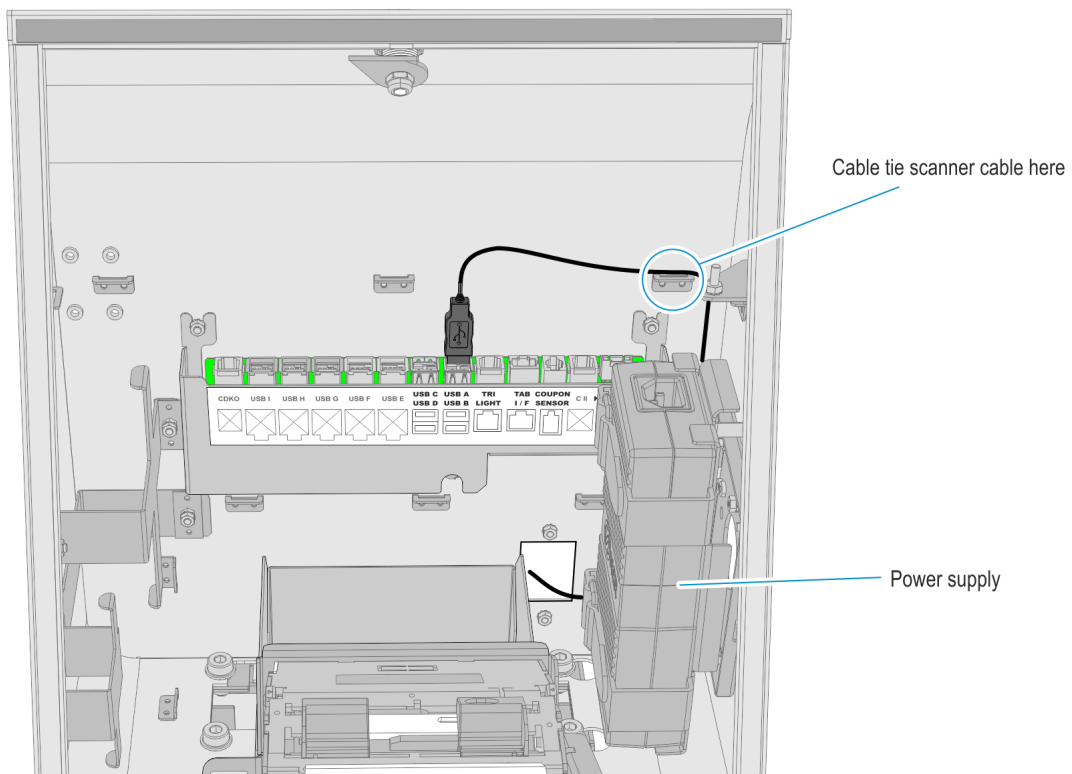

CCP-60850

4. Make sure that there is enough slack on the scanner cable to be dismounted from the holster and scan items, then cable tie the cable to the nearest air hole at the bottom of the sensormatic case.
5. Bundle the extra length of the scanner cable with the Sensormatic cables and place the bundle on top of the Sensormatic controller.
6. Attach and secure the Sensormatic case cover.
7. Check that all the modules in the kiosk are functioning properly.