



# NCR Voyix SelfServ™ 90 (7709)

## Kit Instructions

---

**Two Shelves with Left-Hand and Right-Hand  
Stiffener, Wide (Dark White)**

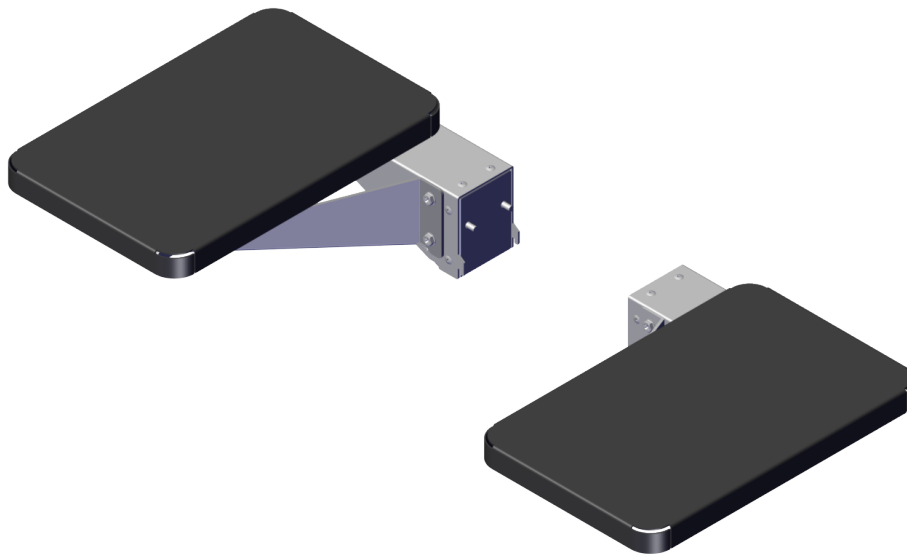

7709-K440  
Issue A

# Copyright and Trademark Information

---

The product described in this document is a copyrighted work of NCR Voyix Corporation.

NCR Voyix SelfServ™ 90 (7709) is a trademark of NCR Voyix Corporation.

It is the policy of NCR Voyix Corporation to improve products as technology, components, software and firmware become available. NCR Voyix therefore reserves the right to change specifications without prior notice.

All features, functions and operations described herein may not be marketed by NCR Voyix in all parts of the world. In some instances, photographs are of equipment prototypes.

Therefore, before using this document, consult with your NCR Voyix representative or NCR Voyix office for information that is applicable and current.

© 2026

By NCR Voyix Corporation

Atlanta, Georgia, USA

All Rights Reserved

# Table of Contents

---

**7709-K440 Two Shelves with Left-Hand and Right-Hand Stiffener, Wide (Dark White) . 5**

Kit Contents ..... 6

Installation Procedures ..... 8

Installing the Wide Shelf (Left-Hand) ..... 9

Installing the Wide Shelf (Right-Hand) .....14

Removing the Wide Shelf (Left-Hand) ..... 19

Removing the Wide Shelf (Right-Hand) .....22

# Revision Record

---

Publication issue	Date	Description of change
A	Jan 2026	First issue.

# 7709-K440 Two Shelves with Left-Hand and Right-Hand Stiffener, Wide (Dark White)

---

This publication provides procedures for installing the 7709-K440 Two Shelves with Left-Hand and Right-Hand Stiffener, Wide (Dark White) on either of the following units:

- NCR Voyix SelfServ 90 (7709)
- NCR Voyix SelfServ XK22 (2246)

# Kit Contents

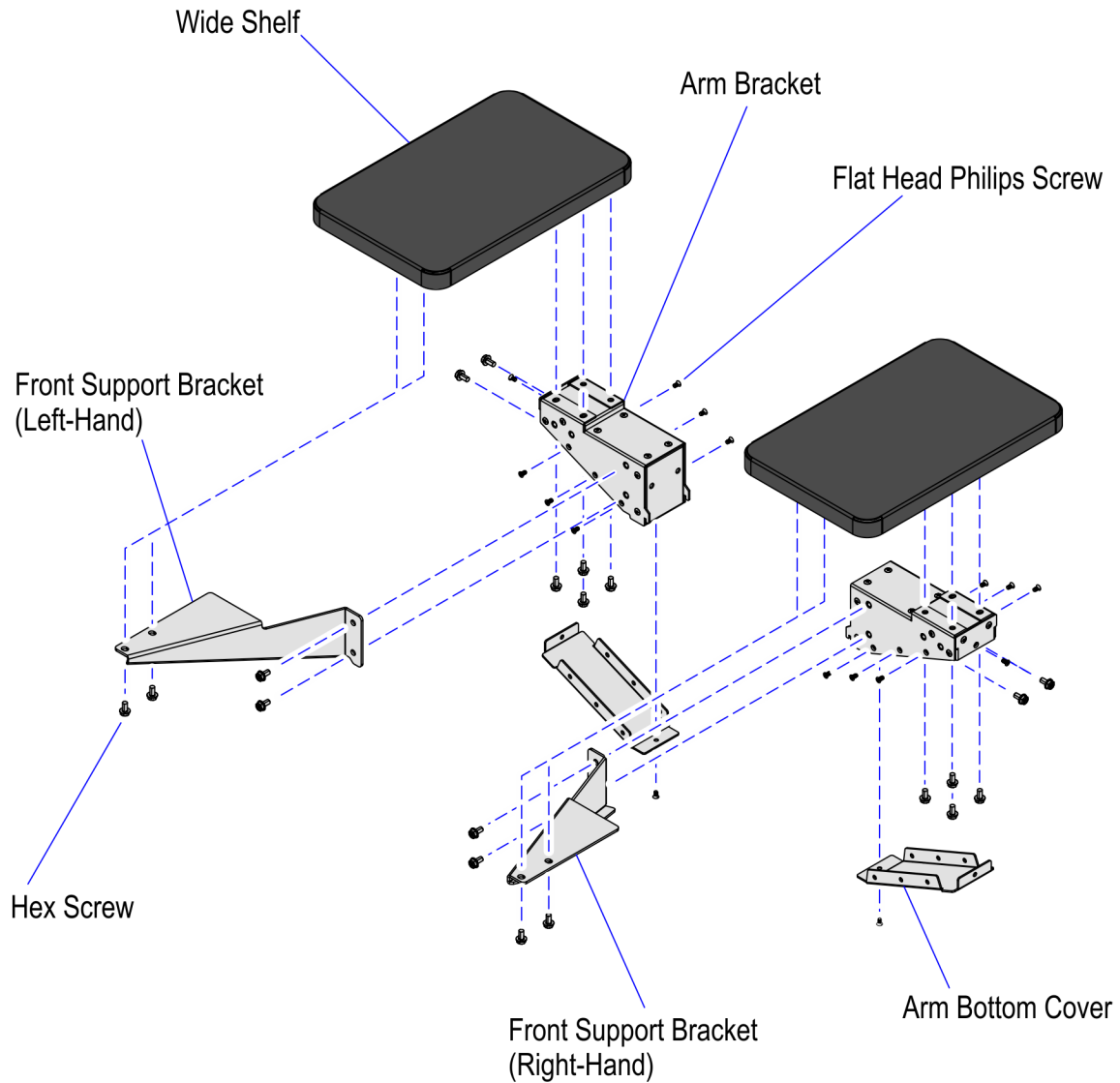

CCP-86360

Part Number	Description
497-0539448	7709-K440 Two Shelves with Left-Hand and Right-Hand Stiffener, Wide (Dark White)
006-8613226	Screw - Metric Flat Head Phillips Machine Screw Zinc-Plated Stl, M4 Size, 8Mm Length, .7Mm Pitch (16 pcs)
006-8628739	Screw Hex M6 X 12 Mc Comb (20 pcs)
497-0506020	Shelf, Wide (2 pcs)

Confidential and proprietary information of NCR Voyix.  
Use and disclose solely pursuant to company instructions.

Part Number	Description
795-0305201	Bracket, Arm, Shelf (Dark White) (2 pcs)
795-0305301	Cover, Bottom, Arm (Dark White) (2 pcs)
795-0305501	Bracket, Front Support, Shelf, LH (Dark White)
795-0305601	Bracket, Front Support, Shelf, RH (Dark White)
* 795-0284101	SS90 Hole Cover Label - Dark White

\* Items marked with an asterisk are not called out on the image.

# Installation Procedures

To install the 7709-K440 Two Shelves with Left-Hand and Right-Hand Stiffener, Wide (Dark White), follow these steps:

1. Install the Wide Shelf assemblies on each side of the Pedestal. For more information, refer to the following:
  - ["Installing the Wide Shelf \(Left-Hand\)"](#) on the next page
  - ["Installing the Wide Shelf \(Right-Hand\)"](#) on page 14
2. Cover unused mounting holes on the back side of the Arm Brackets using Hole Cover Labels, as shown in the image below.

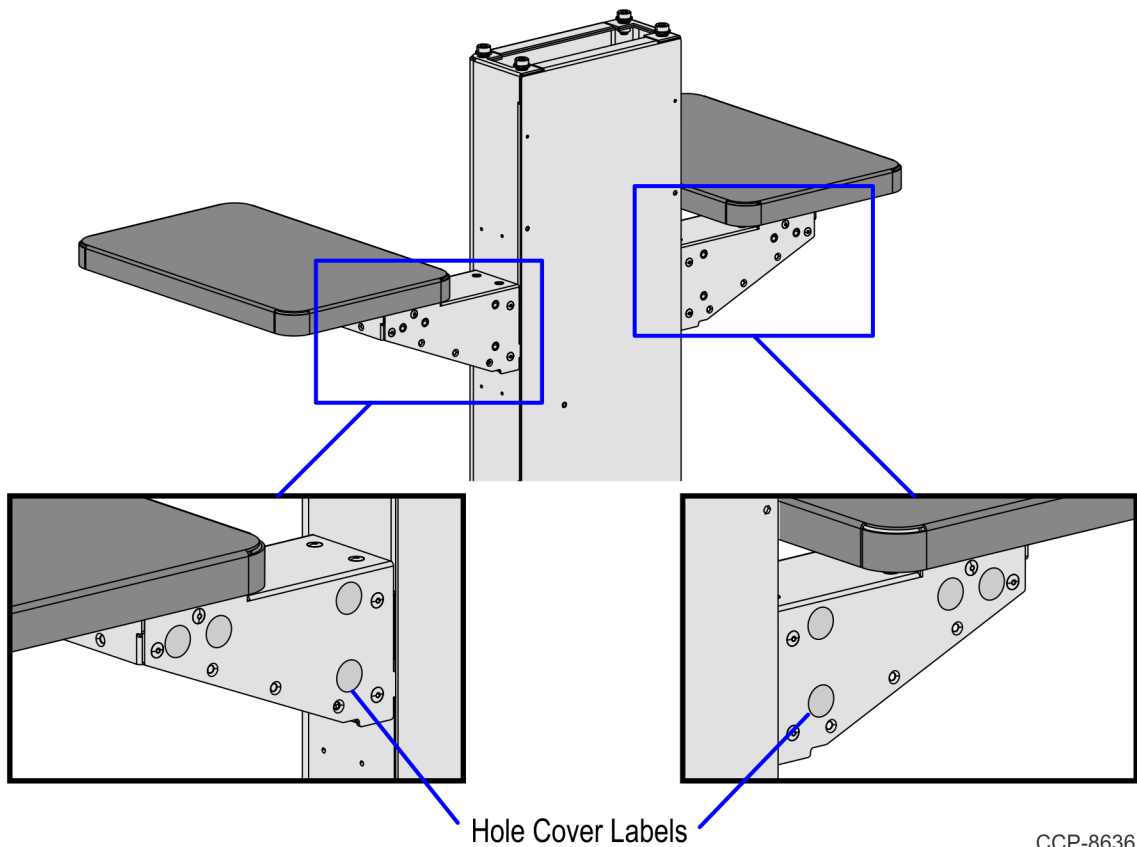

CCP-86361



# Installing the Wide Shelf (Left-Hand)

To install the Wide Shelf (Left-Hand) to the Pedestal, follow these steps:

1. Assemble the Wide Shelf (Left-Hand) by doing the following:
  - a. Attach and tightly secure the Wide Shelf to the Arm Bracket using four (4) hex screws.

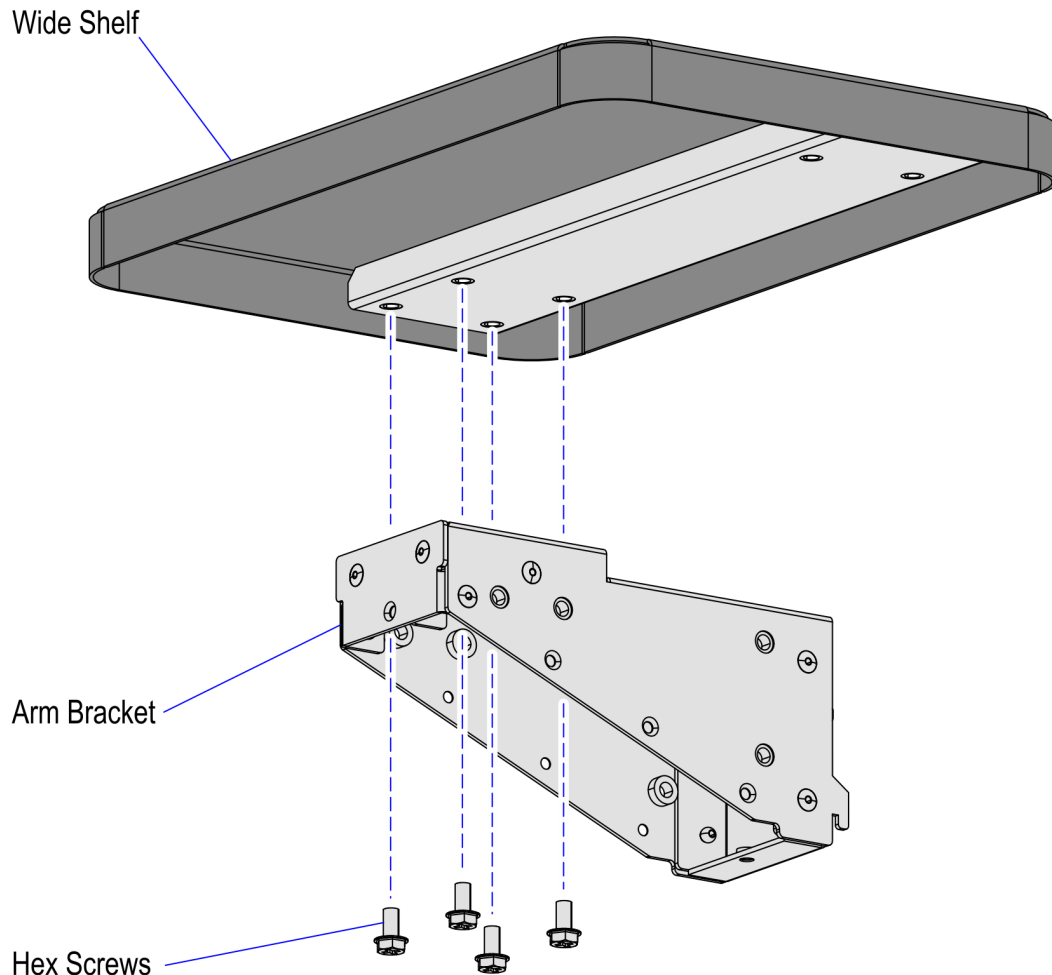

CCP-86362

- b. Attach and tightly secure the Front Support Bracket (Left-Hand) to the Shelf and Arm Bracket using four (4) hex screws, as shown in the image below.

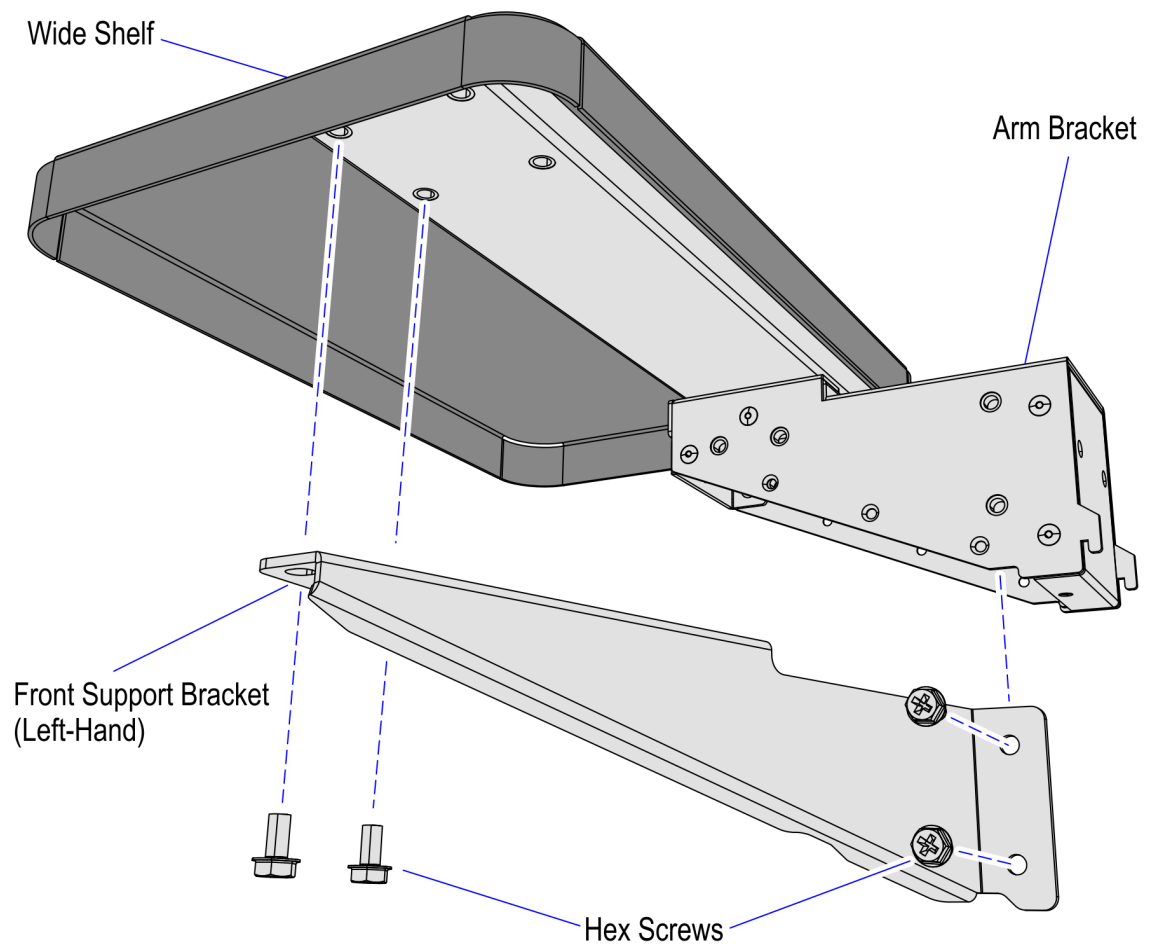

2. Insert the tabs on the bottom of the Arm Bracket through the corresponding holes on the side of the Pedestal, as shown in the image below.

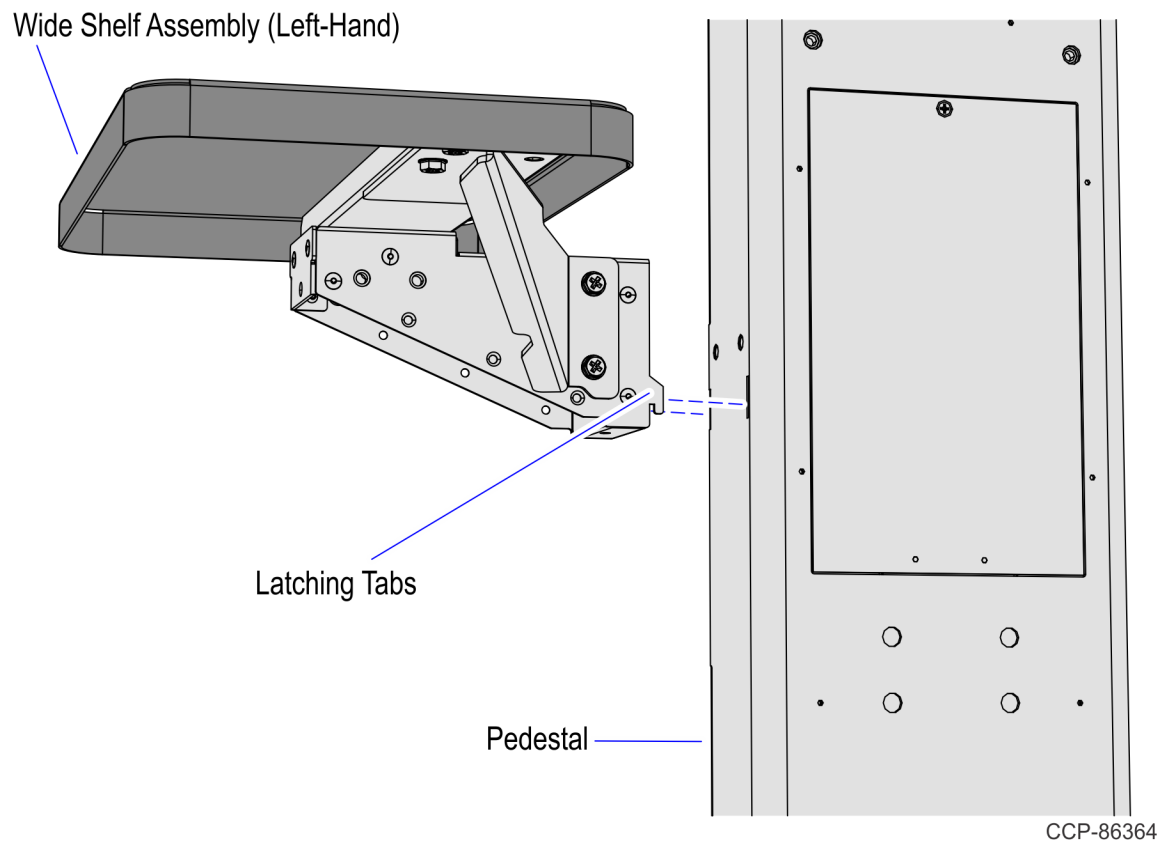

3. Tightly secure the Wide Shelf assembly to the Pedestal using two (2) hex screws.

Wide Shelf Assembly (Left-Hand)

Hex Screws

Pedestal

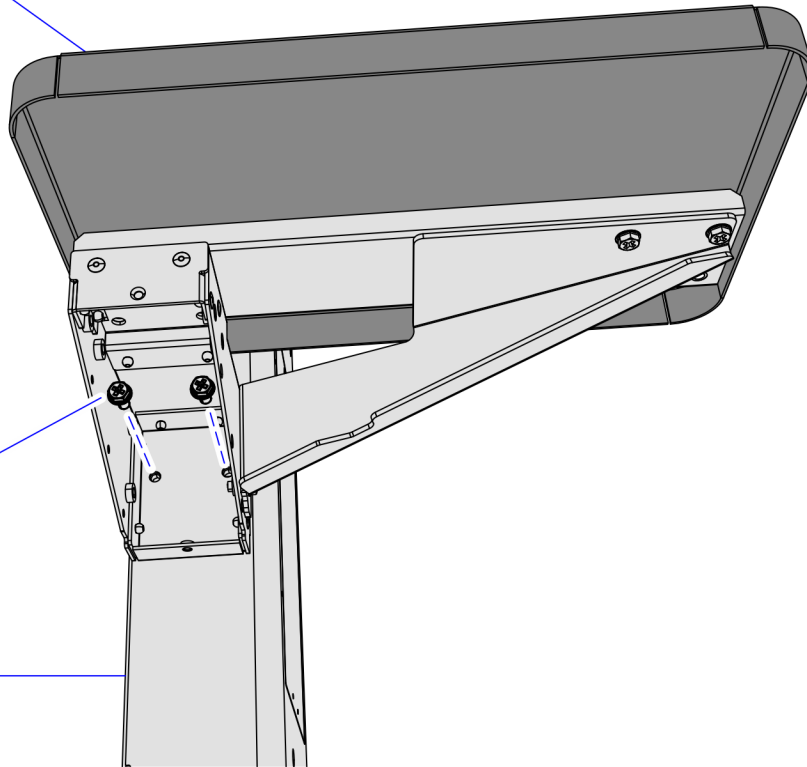

CCP-86365

4. Attach the Bottom Cover to the Arm bracket using eight (8) flat head screws.

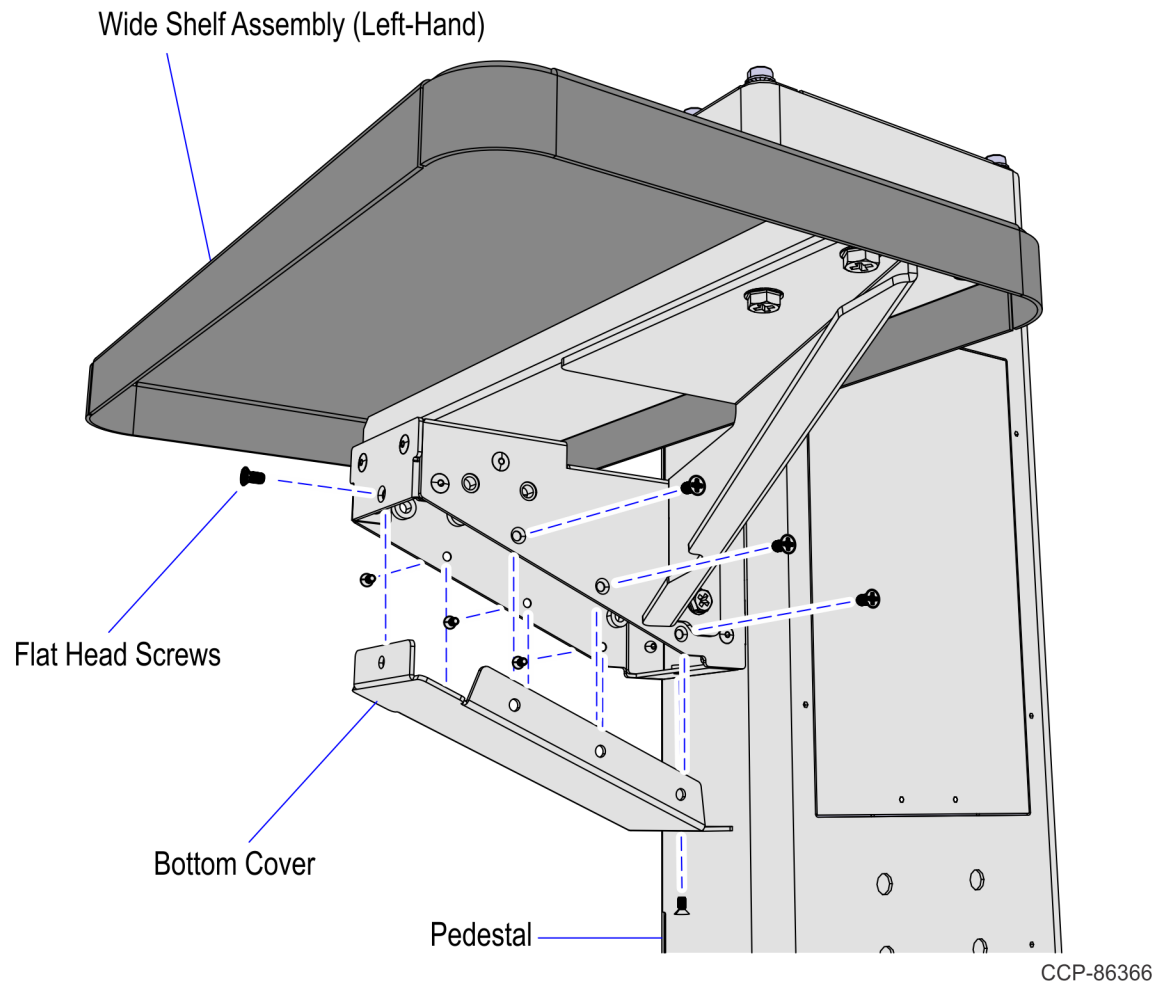

# Installing the Wide Shelf (Right-Hand)

To install the Wide Shelf (Right-Hand) to the Pedestal, follow these steps:

1. Assemble the Wide Shelf (Right-Hand) by doing the following:
  - a. Attach and tightly secure the Wide Shelf to the Arm Bracket using four (4) hex screws.

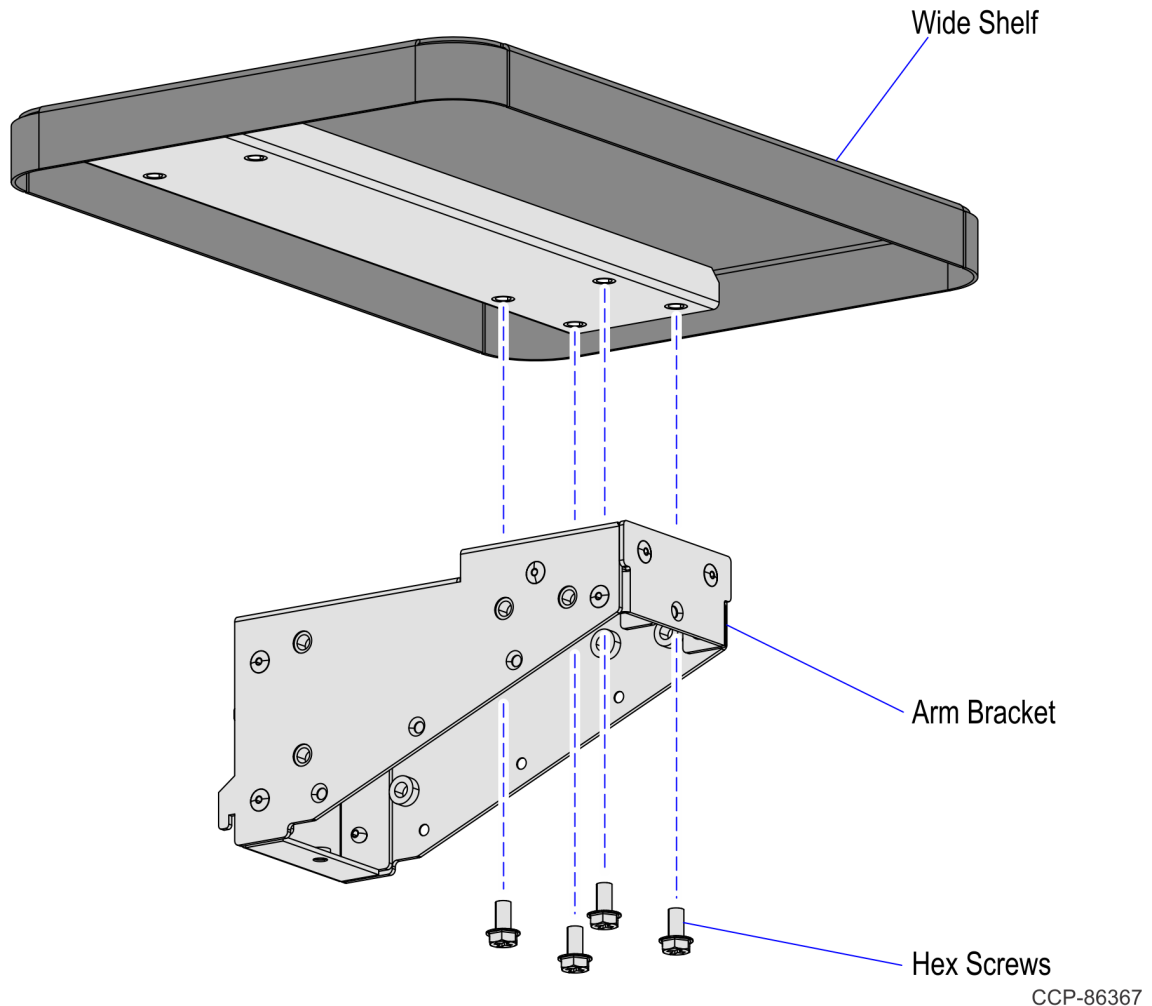

- b. Attach and tightly secure the Front Support Bracket (Right-Hand) to the Shelf and Arm bracket using four (4) hex screws, as shown in the image below.

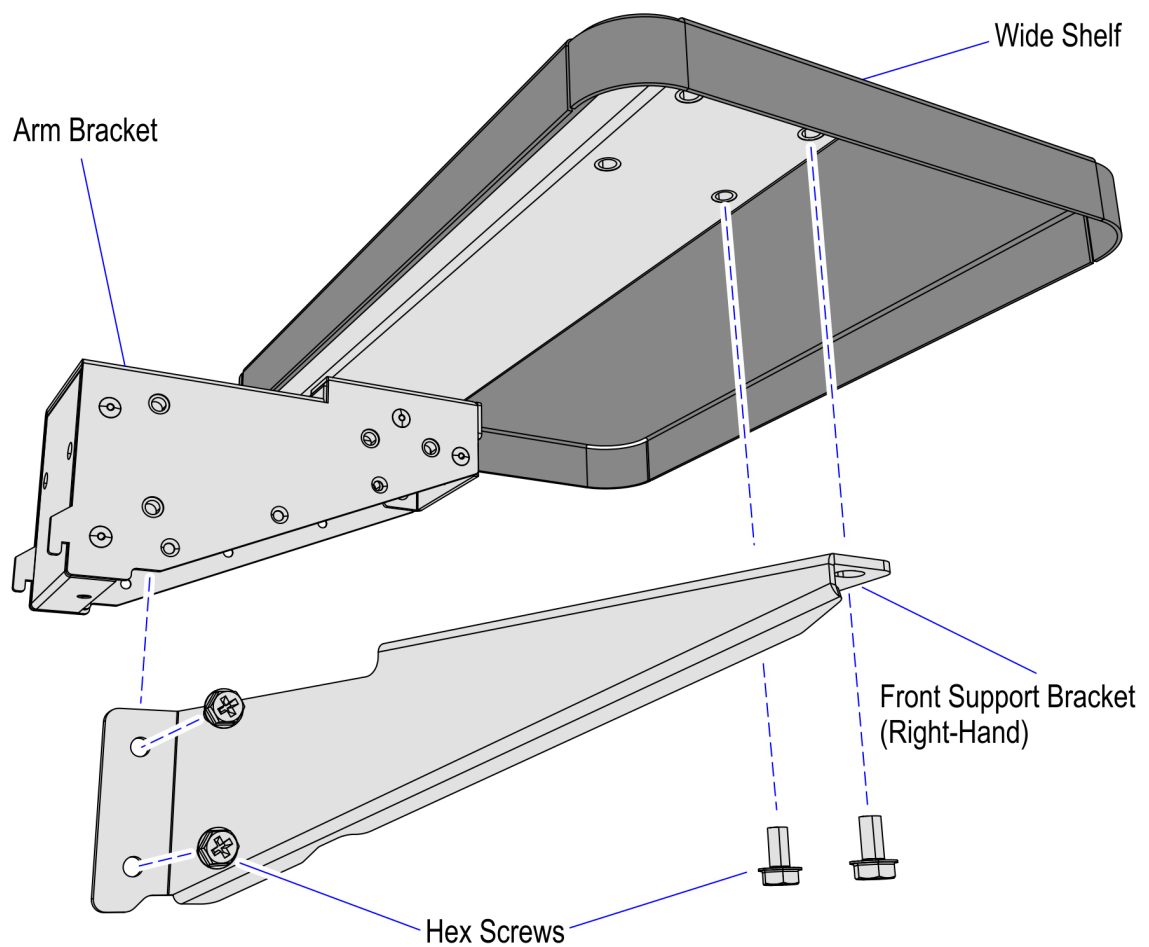

CCP-86368

2. Insert the tabs on the bottom of the Arm Bracket through the corresponding holes on the side of the Pedestal, as shown in the image below.

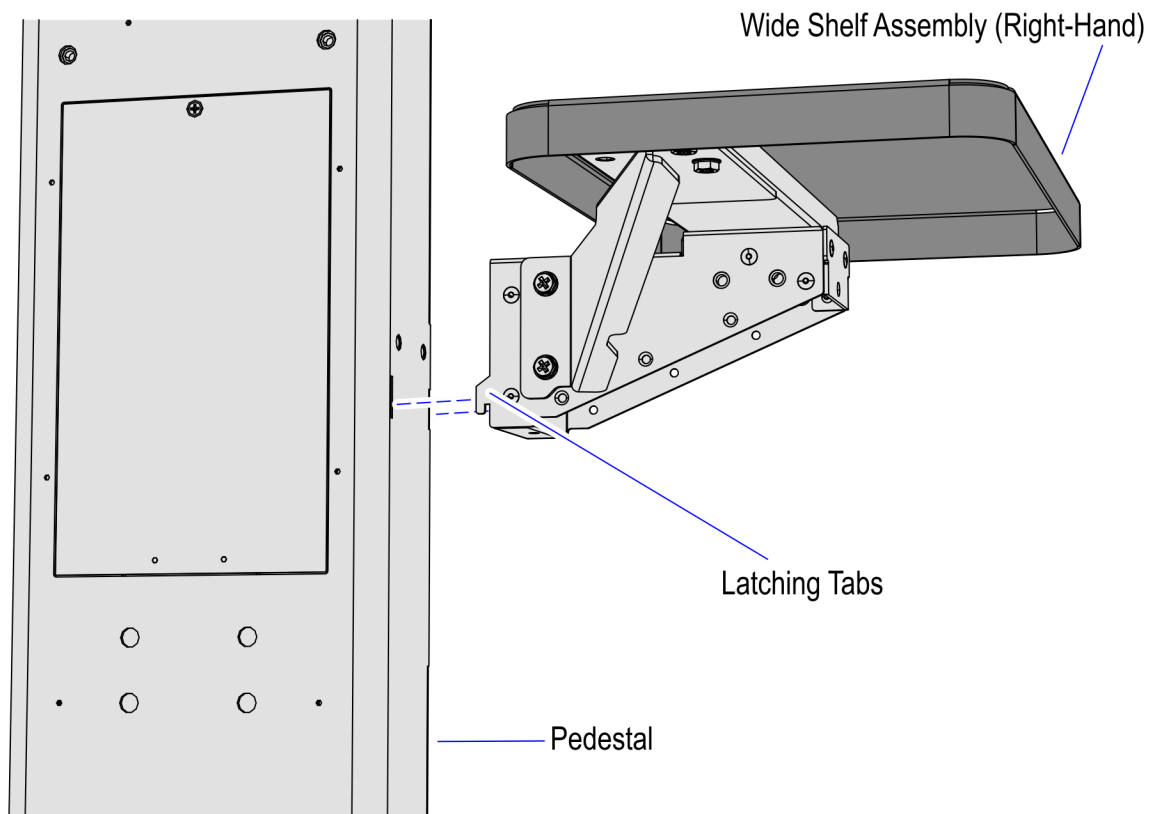

CCP-86369



3. Tightly secure the Wide Shelf to the Pedestal using two (2) hex screws.

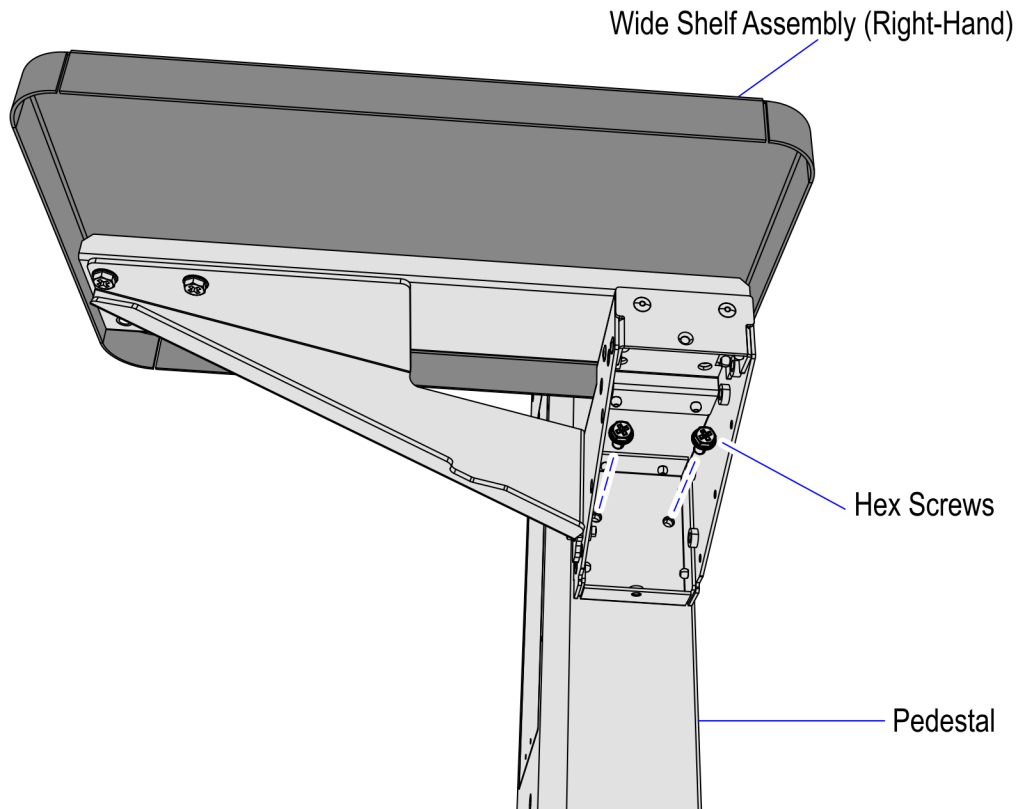

CCP-86370

4. Attach the Bottom Cover to the Arm Bracket using eight (8) flat head screws.

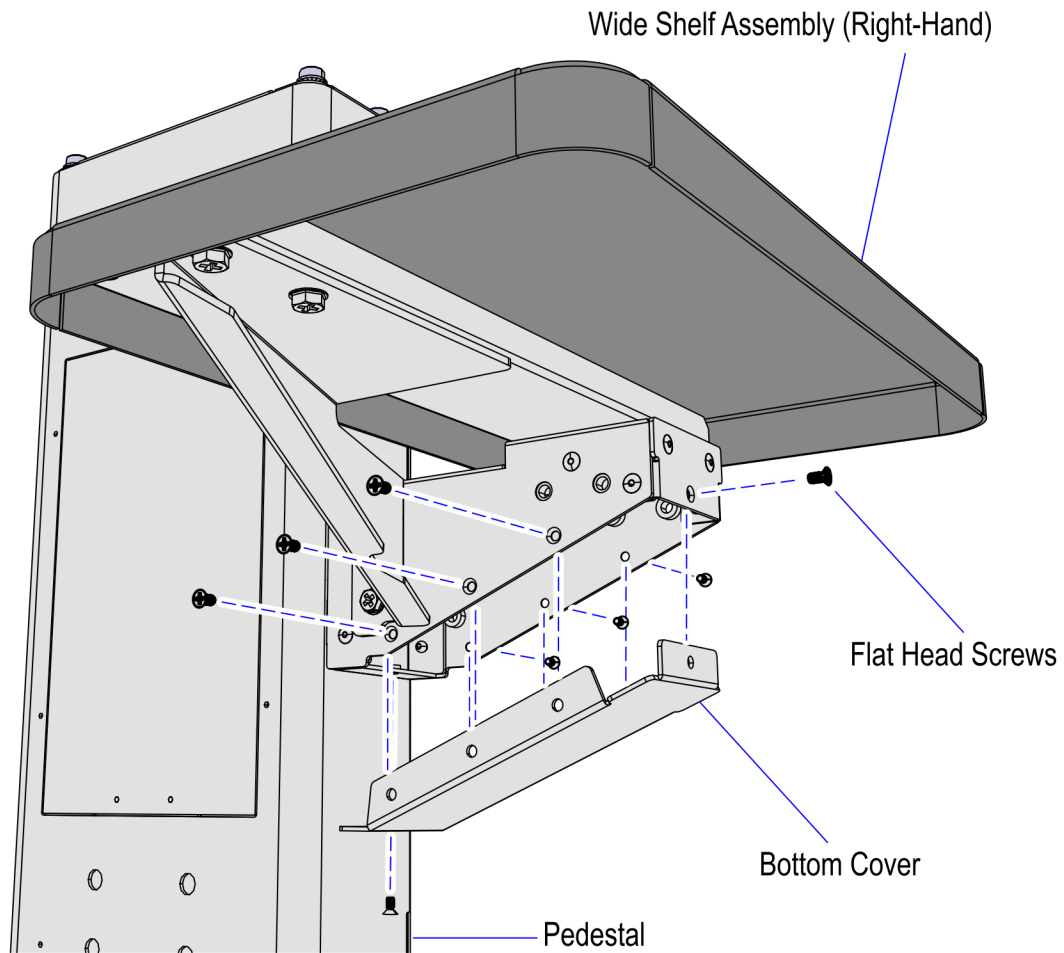

CCP-86371

# Removing the Wide Shelf (Left-Hand)

To remove the Wide Shelf (Left-Hand) from the Pedestal, follow these steps:

1. Remove eight (8) flat head screws to detach the Bottom Cover from the Arm bracket.

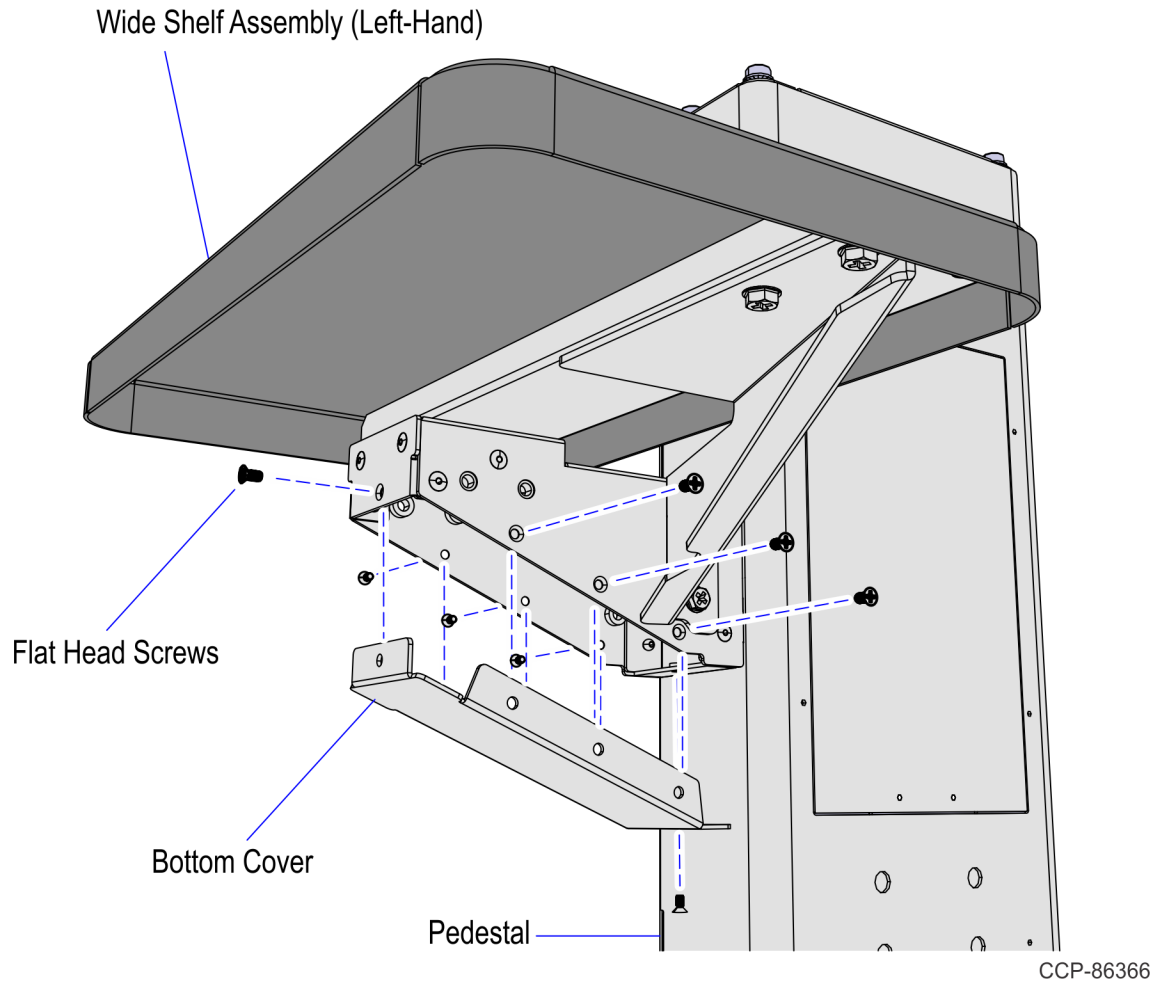

2. Remove two (2) hex screws to detach the Wide Shelf assembly from the Pedestal.

Wide Shelf Assembly (Left-Hand)

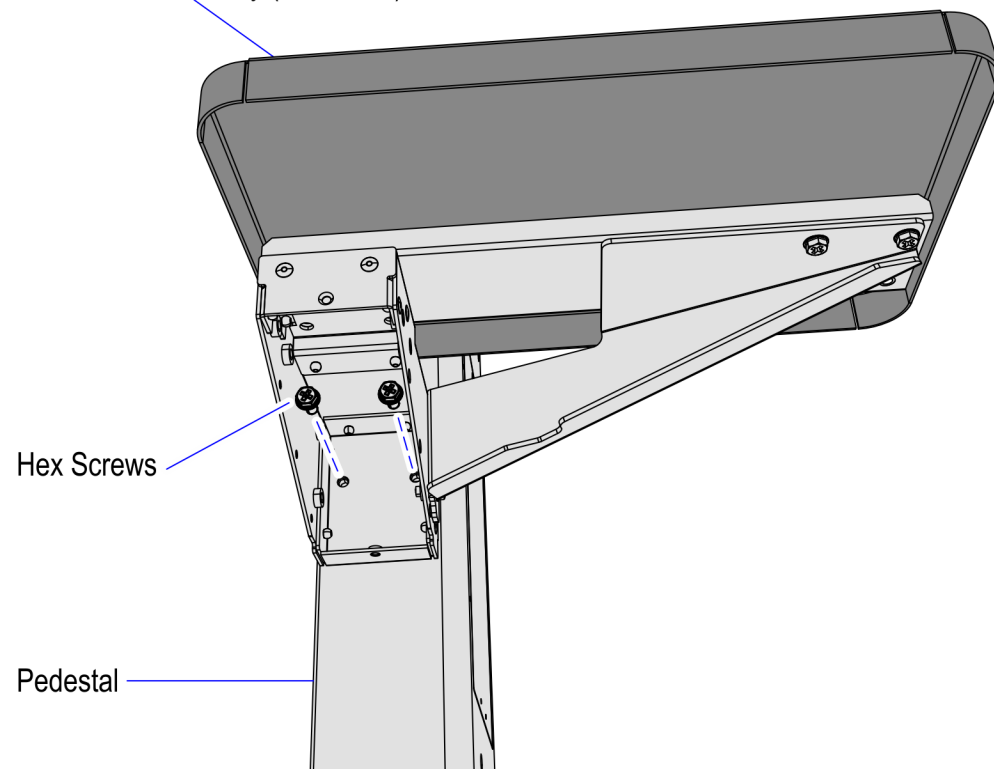

CCP-86365

3. Slightly lift the Shelf assembly to detach the tabs on the bottom of the Arm Bracket from the side of the Pedestal, as shown in the image below.

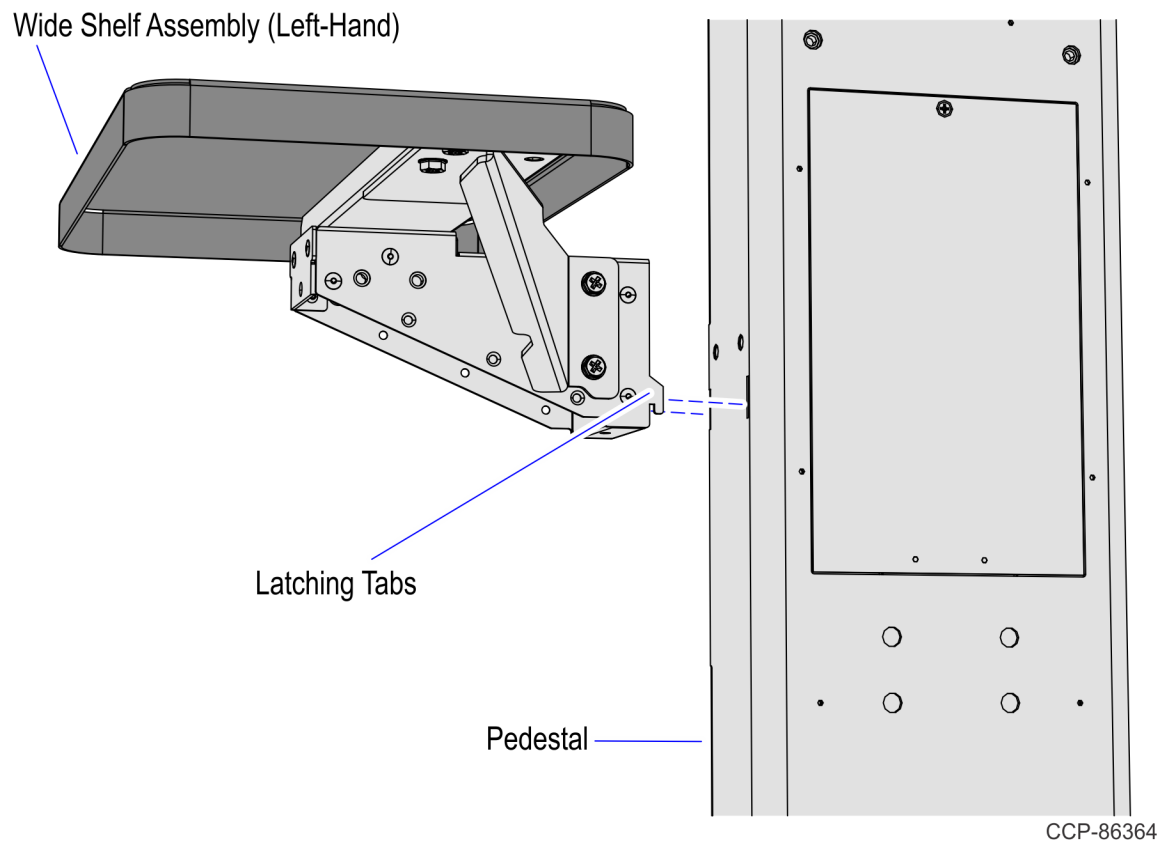

# Removing the Wide Shelf (Right-Hand)

To remove the Wide Shelf (Right-Hand) from the Pedestal, follow these steps:

1. Remove eight (8) flat head screws to detach the Bottom Cover from the Arm Bracket.

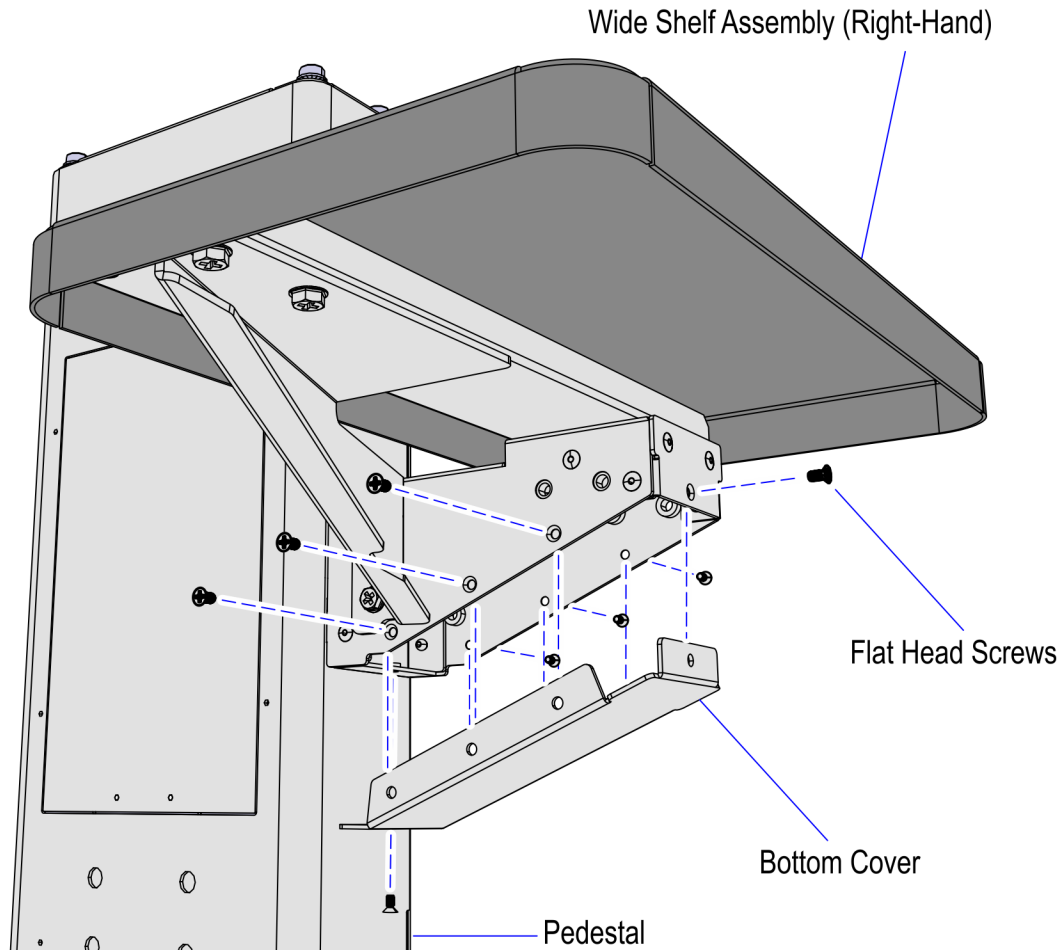

CCP-86371

2. Remove two (2) hex screws to detach the Wide Shelf from the Pedestal.

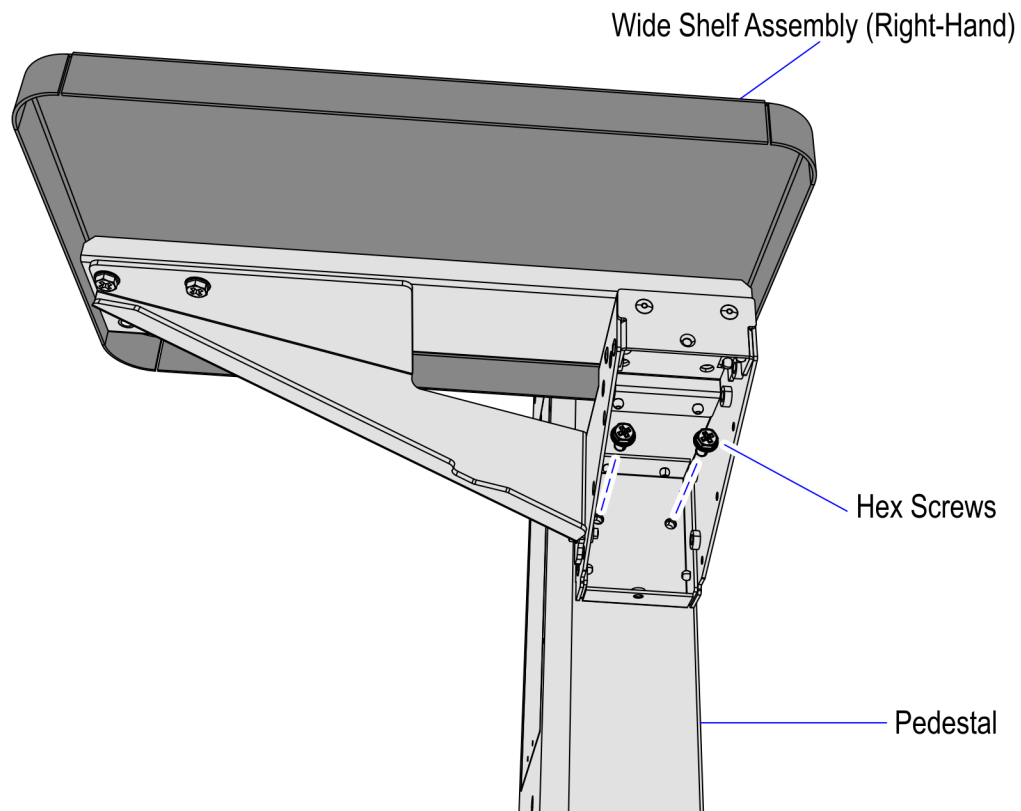

CCP-86370

3. Slightly lift the Shelf assembly to detach the tabs on the bottom of the Arm Bracket from the side of the Pedestal, as shown in the image below.

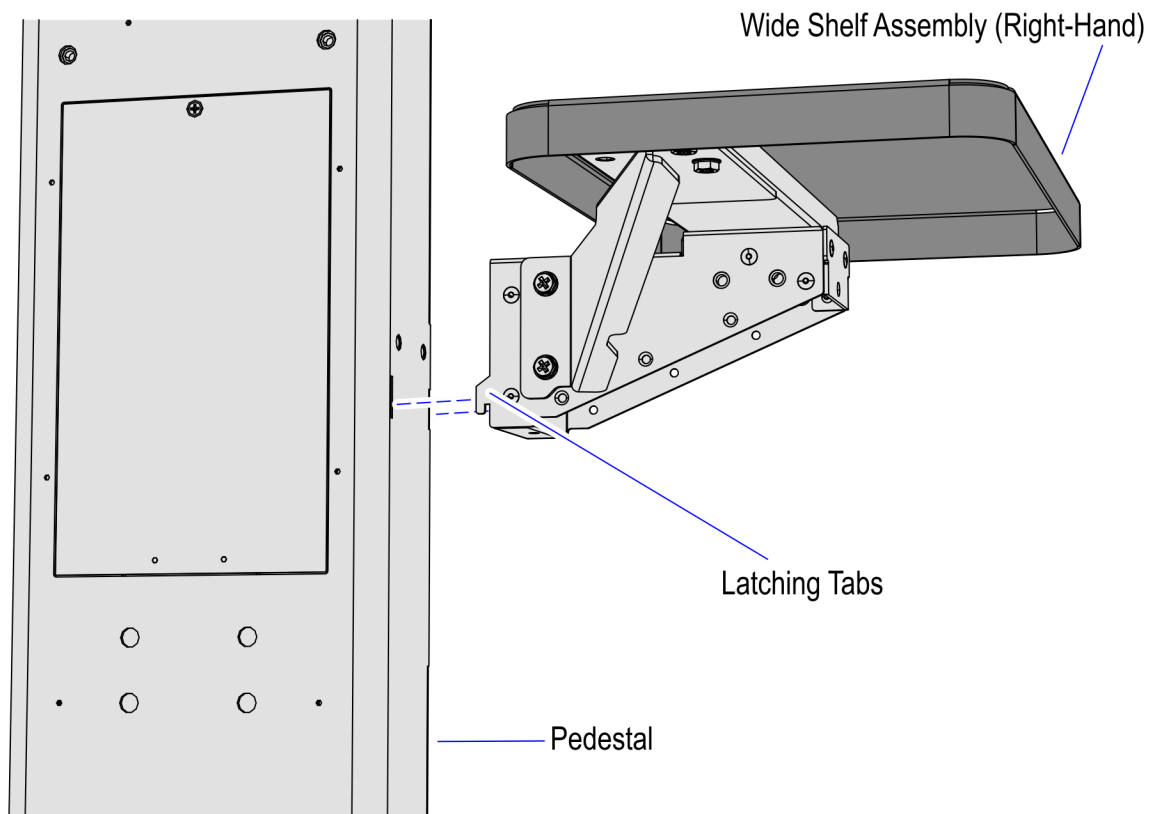

CCP-86369