



NCR Voyix SelfServ™ 90 (7709)

Kit Instructions

Wide Shelf (Dark White)



7709-K433
Issue B

Copyright and Trademark Information

The product described in this document is a copyrighted work of NCR Voyix Corporation.

NCR Voyix SelfServ™ 90 (7709) is a trademark of NCR Voyix Corporation.

It is the policy of NCR Voyix Corporation to improve products as technology, components, software and firmware become available. NCR Voyix therefore reserves the right to change specifications without prior notice.

All features, functions and operations described herein may not be marketed by NCR Voyix in all parts of the world. In some instances, photographs are of equipment prototypes.

Therefore, before using this document, consult with your NCR Voyix representative or NCR Voyix office for information that is applicable and current.

© 2016 – 2026

By NCR Voyix Corporation

Atlanta, Georgia, USA

All Rights Reserved

Table of Contents

7709-K433 Wide Shelf (Dark White)	5
Kit Contents	5
Installation Procedure	6

Revision Record

Publication issue	Date	Description of change
A	Apr 2016	First issue.
B	Jan 2026	Updated with NCR Voyix brand.

7709-K433 Wide Shelf (Dark White)

This publication provides procedures for installing the 7709-K433 Wide Shelf (Dark White) to the NCR Voyix SelfServ™ 90 (7709) Kiosk.

Kit Contents

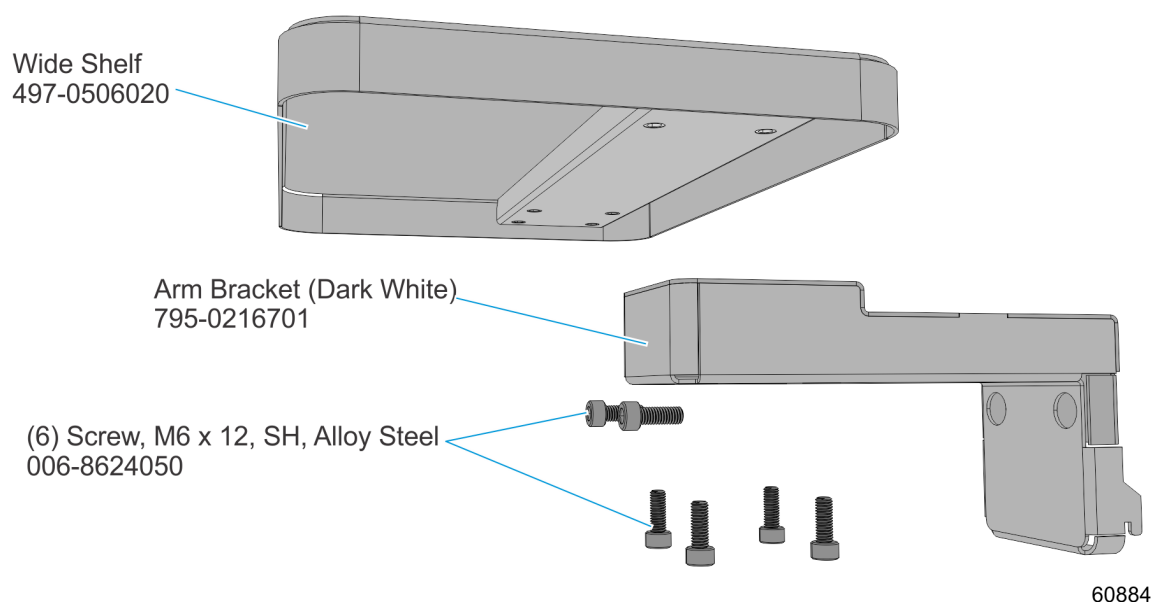

Installation Procedure

1. Attach the Wide Shelf to the Arm Bracket. Secure with screws (4).

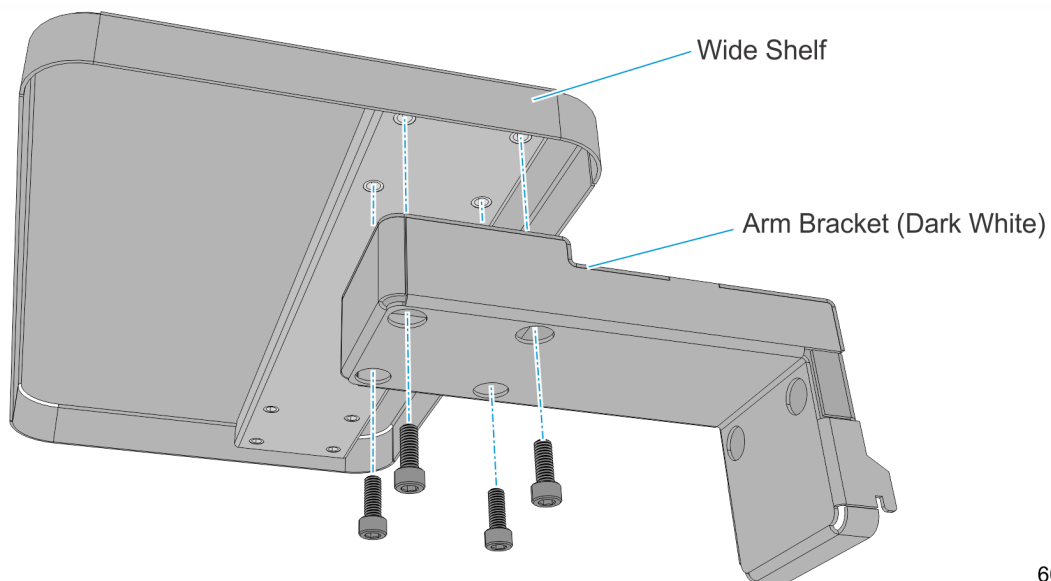

2. Position the Latching Tabs (2) on the bottom of the arm bracket through the slots on the side of the pedestal.

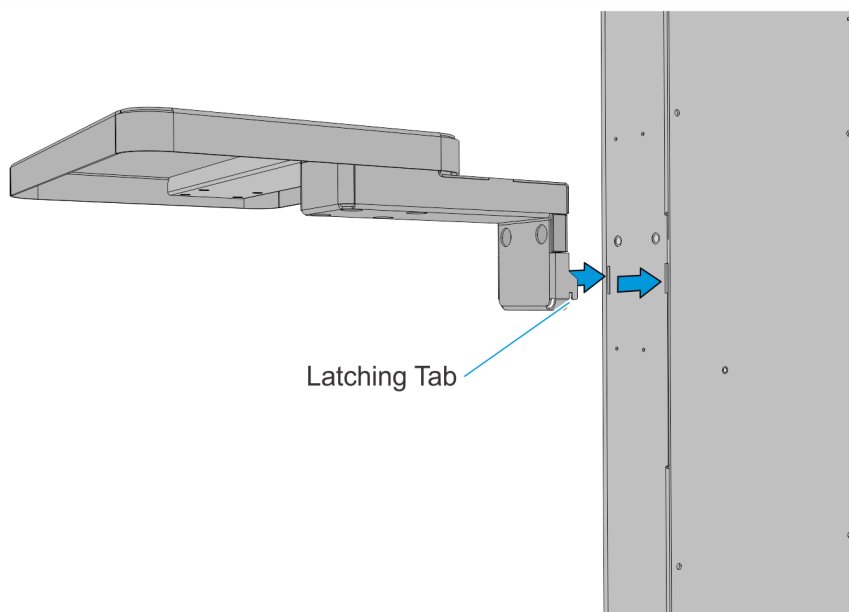

3. Secure and tighten with screws (2).

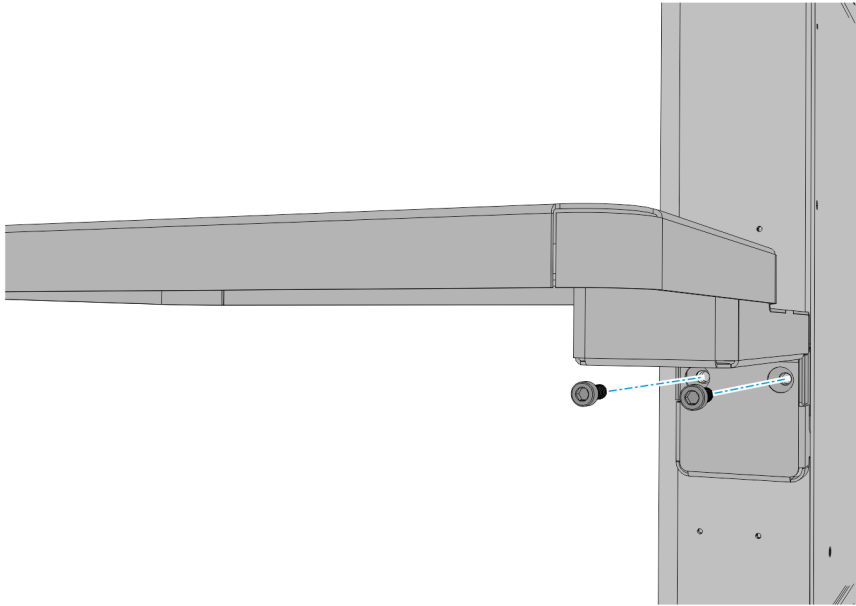

60885