



NCR Voyix SelfServ™ 90 (7709)

Kit Instructions

Wall Mount (Dark White Color)



7709-K431

Issue: B

Copyright and Trademark Information

The product described in this document is a copyrighted work of NCR Voyix Corporation.

NCR Voyix SelfServ™ 90 (7709) is a trademark of NCR Voyix Corporation.

It is the policy of NCR Voyix Corporation to improve products as technology, components, software and firmware become available. NCR Voyix therefore reserves the right to change specifications without prior notice.

All features, functions and operations described herein may not be marketed by NCR Voyix in all parts of the world. In some instances, photographs are of equipment prototypes.

Therefore, before using this document, consult with your NCR Voyix representative or NCR Voyix office for information that is applicable and current.

© 2016 – 2026

By NCR Voyix Corporation

Atlanta, Georgia, USA

All Rights Reserved

Table of Contents

7709-K431 Wall Mount (Dark White Color)	5
Kit Contents	5
Installation Procedure	6

Revision Record

Publication issue	Date	Description of change
A	Apr 2016	First Issue.
B	Jan 2026	Updated with NCR Voyix brand.

7709-K431 Wall Mount (Dark White Color)

This kit provides the components to add a wall mount to the NCR SelfServ™ 90 Kiosk.

Kit Contents

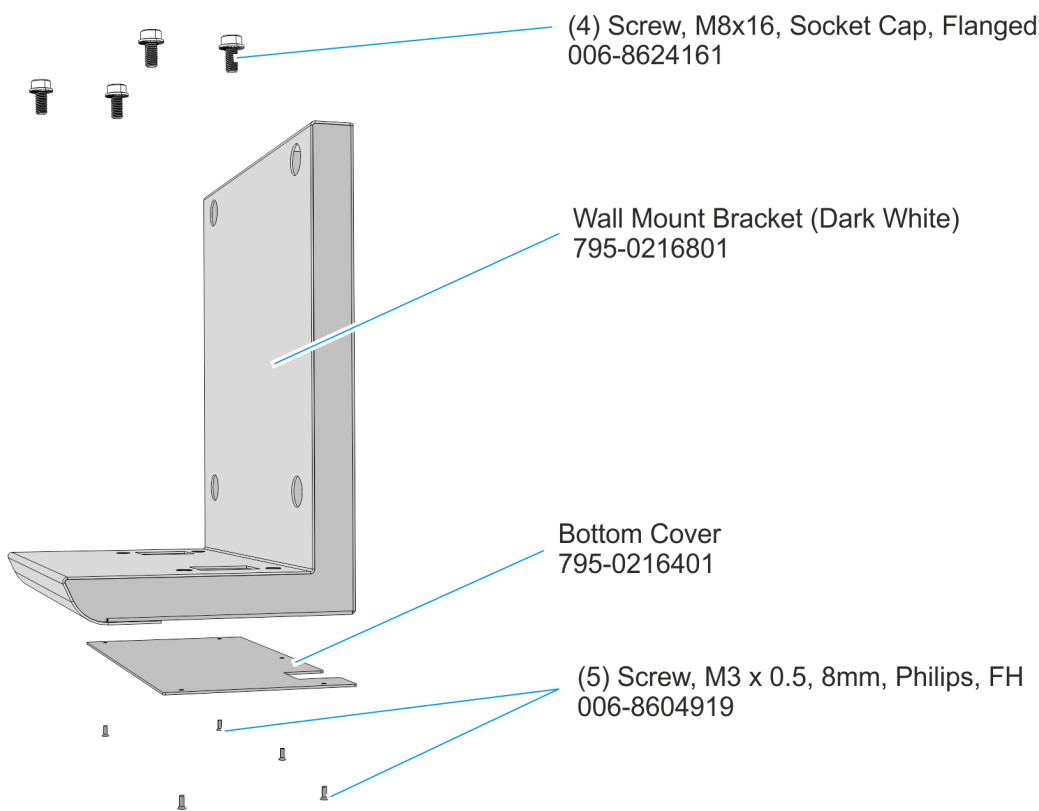

60874

Installation Procedure

The wall mount bracket is first fastened to the wall then the kiosk is fastened to the wall mount bracket. The AC Power Cord and the LAN Cable go through a hole in the bottom of the kiosk and into the mount bracket; the cables feed toward the back of the bracket and out a hole in the bottom of it.

1. Install the Wall Mount Bracket.

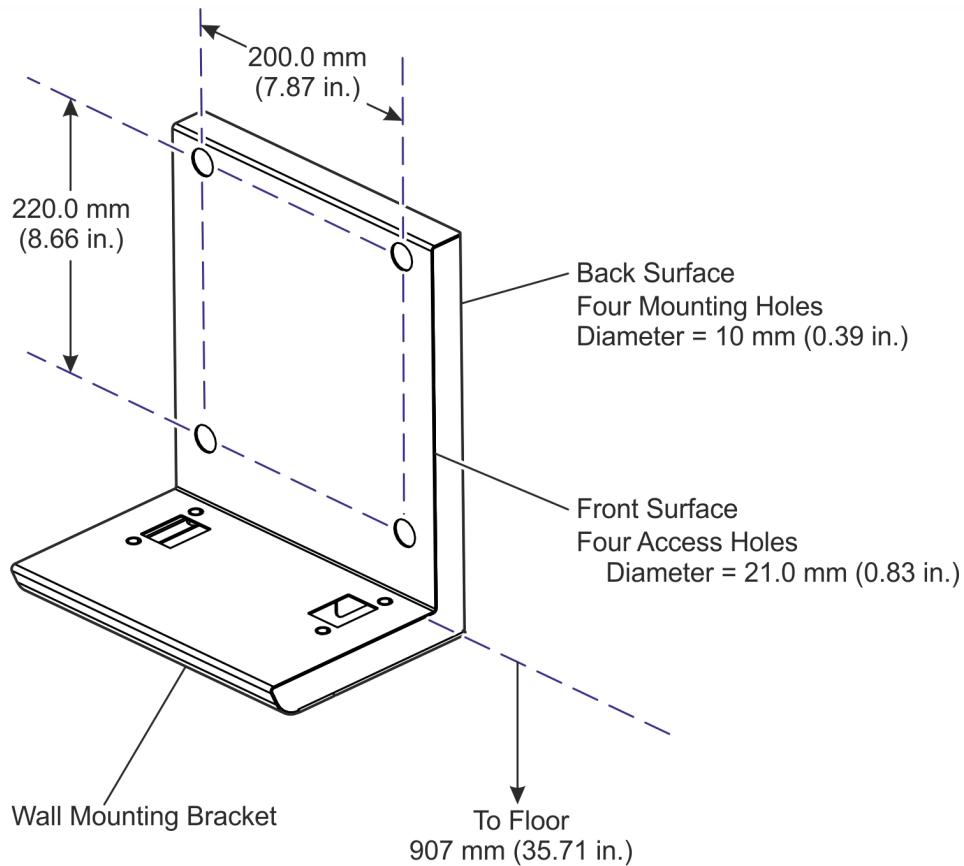

Note: Use 5/16-inch (M8) bolts to secure the Wall Mount Bracket to the wall.

60878

NCR recommends locating the wall mount bracket so that the base of the bracket is 907 mm (35.71 in.) above the floor. Be sure that the mounting is adequate to support the weight of the kiosk: 23.2 kg (51.1 lbs). Also, be sure that the location provides adequate access and service clearance for the kiosk as identified in the *NCR Voyix SelfServ™ 90 (7709) Site Preparation Guide*.

2. Install the Mounting Screws (3) on the right side of the bracket. Do not tighten the Mounting Screws, leave room for the kiosk cabinet to slide under the screw heads or lock—washers.

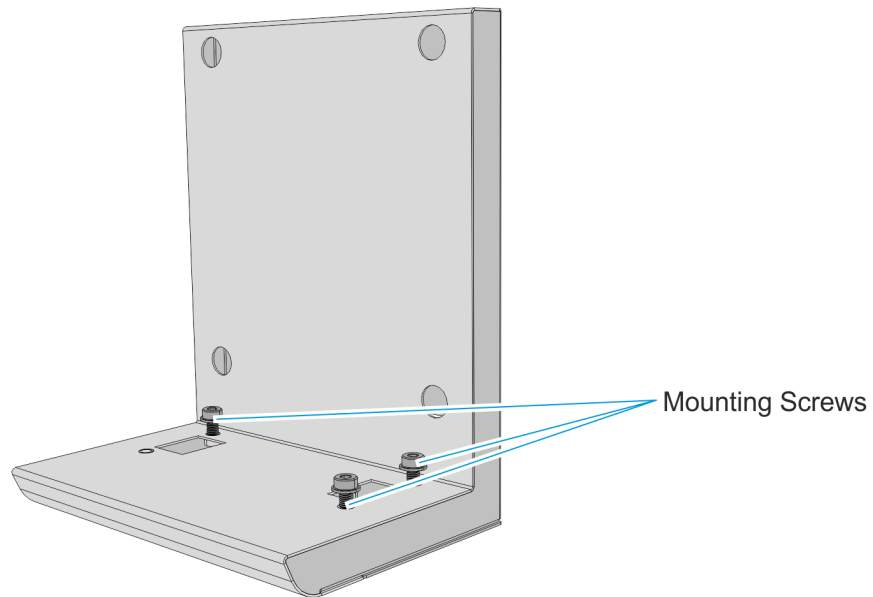

60877

3. Position the kiosk on the bracket with the Mounting Screws (3) extending up through the keyholes in the bottom of the kiosk cabinet. Slide the kiosk to the right.

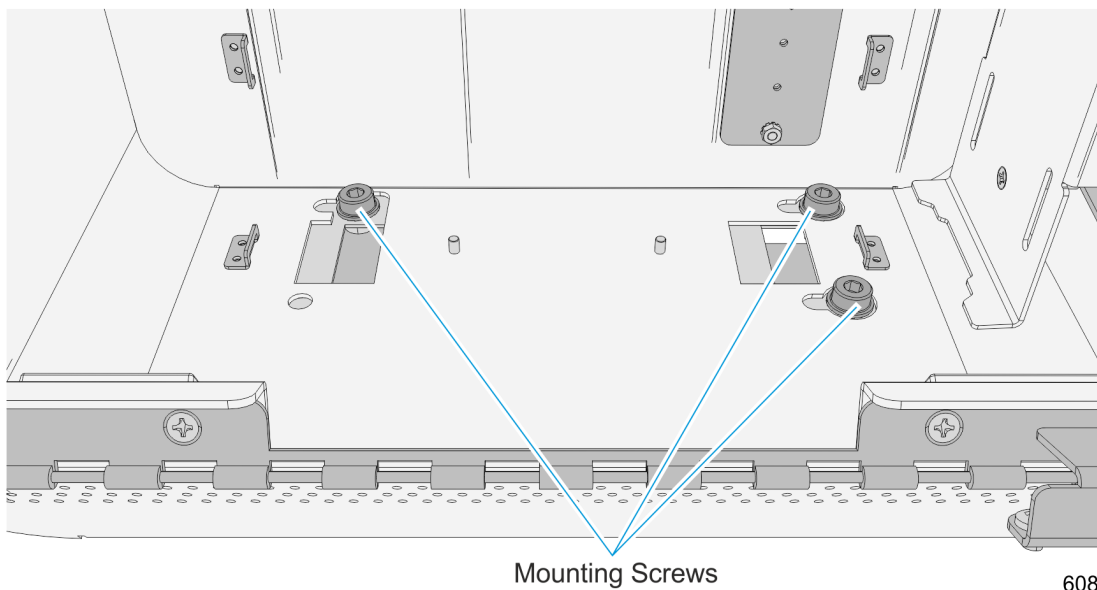

60876

4. Install the Mounting Screws (1) through the remaining mounting hole. Tighten all mounting screws.

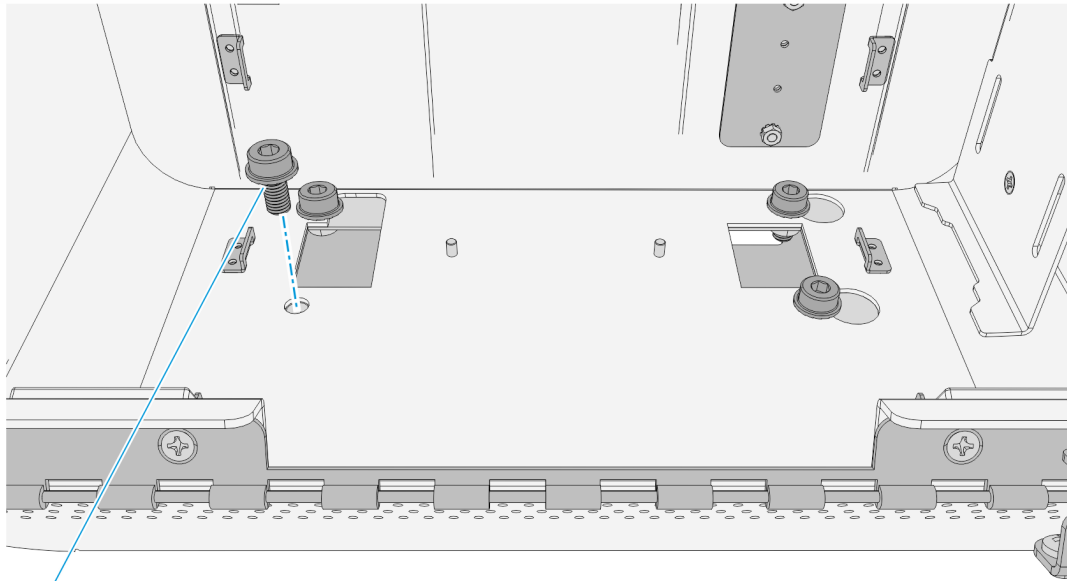

Mounting Screw

60875