



# NCR Voyix SelfServ™ 90 (7709)

## Kit Instructions

---

### Printer Mount Upgrade (7709 R1.0/1.1 to 2.0)

7709-K309  
Issue C

# Copyright and Trademark Information

---

The product described in this document is a copyrighted work of NCR Voyix Corporation.

NCR Voyix SelfServ™ 90 (7709) is a trademark of NCR Voyix Corporation.

It is the policy of NCR Voyix Corporation to improve products as technology, components, software and firmware become available. NCR Voyix therefore reserves the right to change specifications without prior notice.

All features, functions and operations described herein may not be marketed by NCR Voyix in all parts of the world. In some instances, photographs are of equipment prototypes.

Therefore, before using this document, consult with your NCR Voyix representative or NCR Voyix office for information that is applicable and current.

© 2019 – 2026

By NCR Voyix Corporation

Atlanta, Georgia, USA

All Rights Reserved

# Table of Contents

---

<b>7709-K309 Printer Mount Upgrade (7709 R1.0/1.1 to 2.0)</b>	<b>6</b>
Kit Contents	6
Installation Procedures	9
Opening the Kiosk	11
Removing the Ingenico IPP320/350 PIN Pad	12
Removing the Verifone VX805/820 PIN Pad	13
Removing the Imaging Scanner	15
Removing the Receipt Printer	16
Attaching the New Printer Service Label	17
Removing the Supervisor Switch	18
Removing the Coupon Sensors	19
Removing the Sensormatic Antenna	20
Removing the Display Head	22
Removing the Rear Cover	24
Removing the Old Z-shaped Brackets	26
Installing the New Z-shaped Brackets	27
Installing the Rear Cover	28
Installing the Coupon Bin	30
Installing the Display Head	31
Installing the Sensormatic Antenna	32
Installing the Coupon Sensors	34
Installing the Supervisor Switch	35
Installing the Imaging Scanner	37
Installing the Receipt Printer	38
Installing the Ingenico IPP320/350 PIN Pad	42
Installing the Verifone VX805/820 PIN Pad	43

I/O Motherboard Cable Connections .....46

I/O Adapter Cable Connections .....48



# Revision Record

---

Publication issue	Date	Description of change
A	Dec 2019	First issue.
B	May 2021	Updated kit contents and procedures for kit version V002 (upgrade from R1.0/1.1 to R2.0).
C	Jan 2026	Updated with NCR Voyix brand.

# 7709-K309 Printer Mount Upgrade

## (7709 R1.0/1.1 to 2.0)

This publication provides procedures for installing <Kit Name> to the <Complete Product Name>.

This publication provides procedures for installing the 7709-K309 Printer Mount Upgrade (7709 R1.0/1.1 to 2.0) to the NCR Voyix SelfServ™ 90 (7709).

### Kit Contents

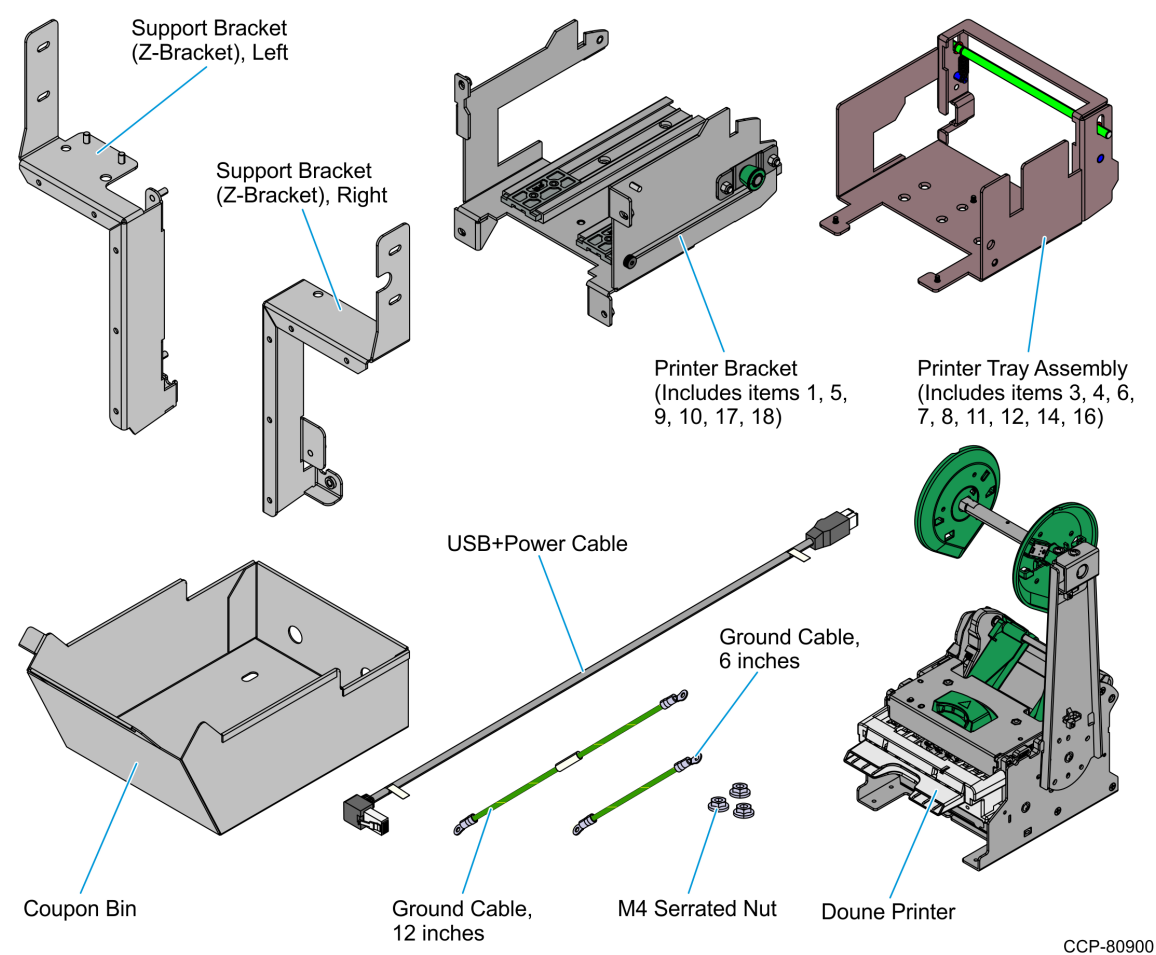

Part Number	Description
497-0530810	7709-K309 Printer Mount Upgrade (7709 R1.0/1.1 to 2.0)

Part Number	Description
006-8615143	Cable Tie, 142Mm X 3.6Mm (3 pcs)
006-8622588	M4 X 6Mm Length, Flat Head, Zinc Plated (4 pcs)
006-8624581	Screw- M3X0.5X6 Flat Head Phillips Machine (3 pcs)
006-8626386	Screw - M4X6, Hex Drive Rounded (6 pcs)
006-8626388	E Clip - 5-7 Mm Od (2 pcs)
006-8626522	Spring - Extension, Free Length 1" (2 pcs)
006-8626942	Screw - Shoulder, 5Mm D 8Mm L, M4
006-8627073	Zinc-Plated Steel Nylon-Insert Locknut, Class 8, M4X0.7 (2 pcs)
497-0535530	Rail And Carriage Assembly (2 pcs)
497-0456989	Label - Service, Green Stripe
497-0470177	Label - Service, Green, 3.50 X 0.58 In.
497-0524044	Cable - Usb+Power (24V) To Ra Latch-N-Lok Pos2 Keyed, 0.61M
497-0518794	Latch - Rod, 7709 R1.2
497-0526247	Label – Service, Receipt Printer, Doune Retail
497-0520030	Bracket - Printer, Tray, 7709 R2.0
497-0524609	Bracket - Printer, 7709 R2.0
497-0521278	Plunger Mount, 7709 R1.2
497-0524591	Bin, Receipt, Printer
497-0527129	Bracket - Support, Right
497-0527130	Bracket - Support, Left
009-0007087	Serrated Nut - Self Locking (M4, 4.2) (8 Pcs)
497-0435725	Cable – Ground Wire, 12 Awg, 6"

Part Number	Description
497-0474872	Cable - Ground Wire, 12 Awg, 12 Inch
497-0538239	Printer - 7709 Doune Thermal Receipt 1St 80Mm Firmware Main V62.13, Ipl V30.01, SbcS V01.03, Dbcs V01.03, Table V31.04
* 497-0423108	Instructions-Kit (Reference Sheet)

\* Items marked with an asterisk are not called out on the image.

# Installation Procedures

Installing the Printer Mount Upgrade kit on an NCR Voyix 7709 R1.0/1.1 unit involves the following procedures:

1. Open the NCR Voyix 7709 unit. For more information, refer to "[Opening the Kiosk](#)" on page 11.
2. Disconnect all cables from the Motherboard.
3. Do the following:
  - a. Remove the PIN Pad. Depending on the PIN Pad, refer to either of the following procedures:
    - "[Removing the Ingenico IPP320/350 PIN Pad](#)" on page 12
    - "[Removing the Verifone VX805/820 PIN Pad](#)" on page 13
  - b. Remove the Imaging Scanner. For more information, refer to "[Removing the Imaging Scanner](#)" on page 15
  - c. Remove the Receipt Printer. For more information, refer to "[Removing the Receipt Printer](#)" on page 16.
  - d. Attach the new printer service label over the old one. For more information, refer to "[Attaching the New Printer Service Label](#)" on page 17.
  - e. Remove the Supervisor Switch. For more information, refer to "[Removing the Supervisor Switch](#)" on page 18.
  - f. Remove the Coupon Sensors. For more information, refer to "[Removing the Coupon Sensors](#)" on page 19.
  - g. If present, remove the Sensormatic Antenna. For more information, refer to "[Removing the Sensormatic Antenna](#)" on page 20.
  - h. Remove the Display Head. For more information, refer to "[Removing the Display Head](#)" on page 22.
  - i. Remove the Rear Head Cover. For more information, refer to "[Removing the Rear Cover](#)" on page 24.
  - j. Remove the Old Z-shaped Brackets. For more information, refer to "[Removing the Old Z-shaped Brackets](#)" on page 26.

4. Do the following:
  - a. Install the New Z-shaped Brackets that are included in the kit. For more information, refer to ["Installing the New Z-shaped Brackets"](#) on page 27.
  - b. Install the Rear Head Cover. For more information, refer to ["Installing the Rear Cover"](#) on page 28.
  - c. Install the R1.2 Coupon Bin included in the kit. For more information, refer to ["Installing the Coupon Bin"](#) on page 30.
  - d. Attach and secure the Display Head Hinge to the cabinet. Do NOT re-attach the chain at this point. For more information, refer to ["Installing the Display Head"](#) on page 31.
  - e. Install the Sensormatic Antenna, if present. For more information, refer to ["Installing the Sensormatic Antenna"](#) on page 32
  - f. Install the Coupon Sensors. For more information, refer to ["Installing the Coupon Sensors"](#) on page 34.
  - g. Install the Supervisor Switch. For more information, refer to ["Installing the Supervisor Switch"](#) on page 35.
  - h. Install Imaging Scanner. For more information, refer to ["Installing the Imaging Scanner"](#) on page 37.
  - i. Install the Receipt Printer. For more information, refer to ["Installing the Receipt Printer"](#) on page 38
  - j. Install the PIN Pad. Depending on the PIN Pad, refer to either of the following procedures:
    - ["Installing the Ingenico IPP320/350 PIN Pad"](#) on page 42
    - ["Installing the Verifone VX805/820 PIN Pad"](#) on page 43
  - k. Attach the Display Head Chain to the cabinet. For more information, refer to ["Installing the Display Head"](#) on page 31.
5. Connect all cables to the Motherboard. For more information, refer to the following:
  - ["I/O Motherboard Cable Connections"](#) on page 46
  - ["I/O Adapter Cable Connections"](#) on page 48

# Opening the Kiosk

To access the kiosk components, insert the key into the lock, turn the key clockwise, and carefully open the front of the kiosk.

- For 7709 R1.0 and R1.1 units, the lock is located at the back of the kiosk.
- For 7709 R1.2 and R2.0 units, the lock is located at the right-hand side of the kiosk.



## Caution

Do NOT abruptly open and release the front of the kiosk. Hold and support the front of the kiosk until fully extended.



## Note

The image below shows a 7709 R2.0 unit only for reference.

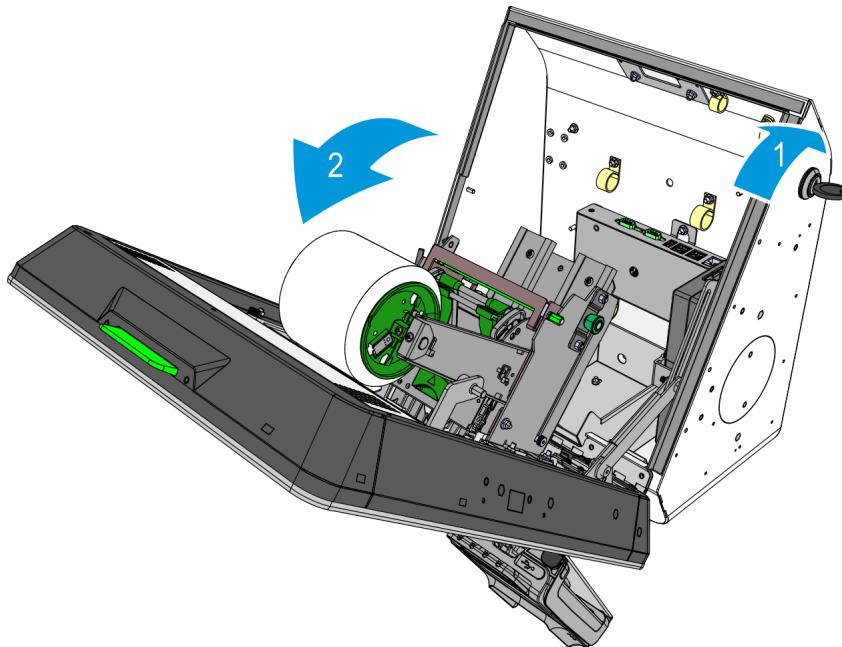

CCP-77624

# Removing the Ingenico IPP320/350 PIN Pad

1. While holding the PIN Pad from outside of the kiosk, pull on the tab on the upper portion of the Mounting Bracket (accessed from the inside of the kiosk), and then remove the PIN Pad.
2. Disconnect the PIN Pad Cable from the PIN Pad.
3. Loosen the two screws that secure the Mounting Bracket to the PIN Pad Cradle.

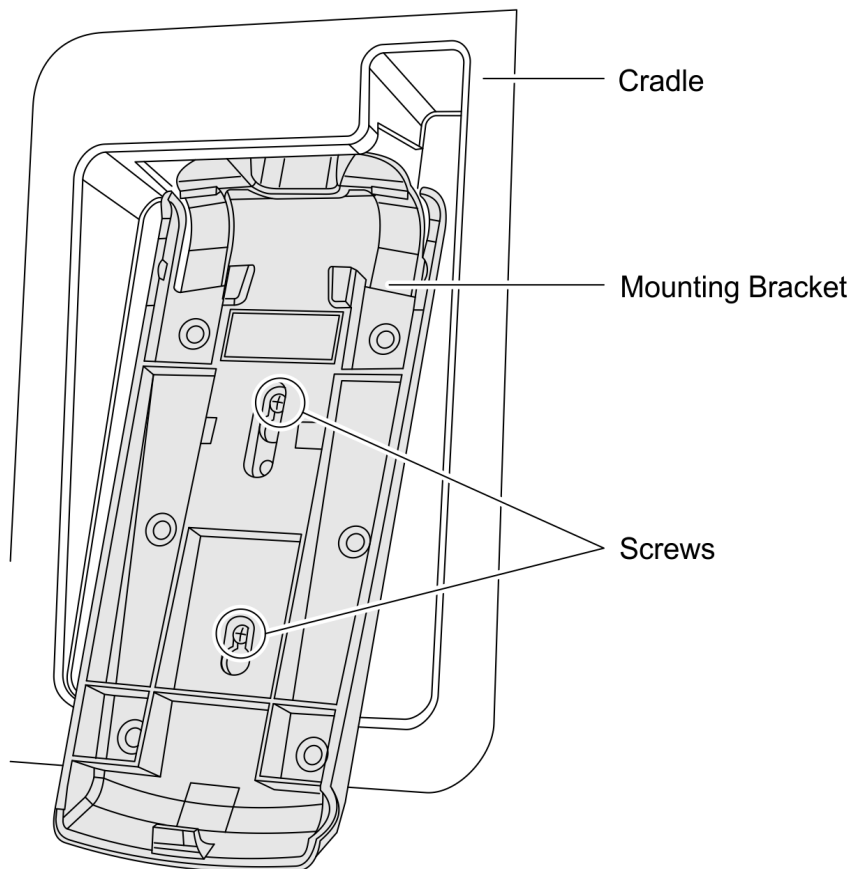

CCP-60090

4. Slide up and remove the Mounting Bracket.



# Removing the Verifone VX805/820 PIN Pad

1. Disconnect the PIN Pad Cable from the Motherboard and cut off cable ties as necessary.

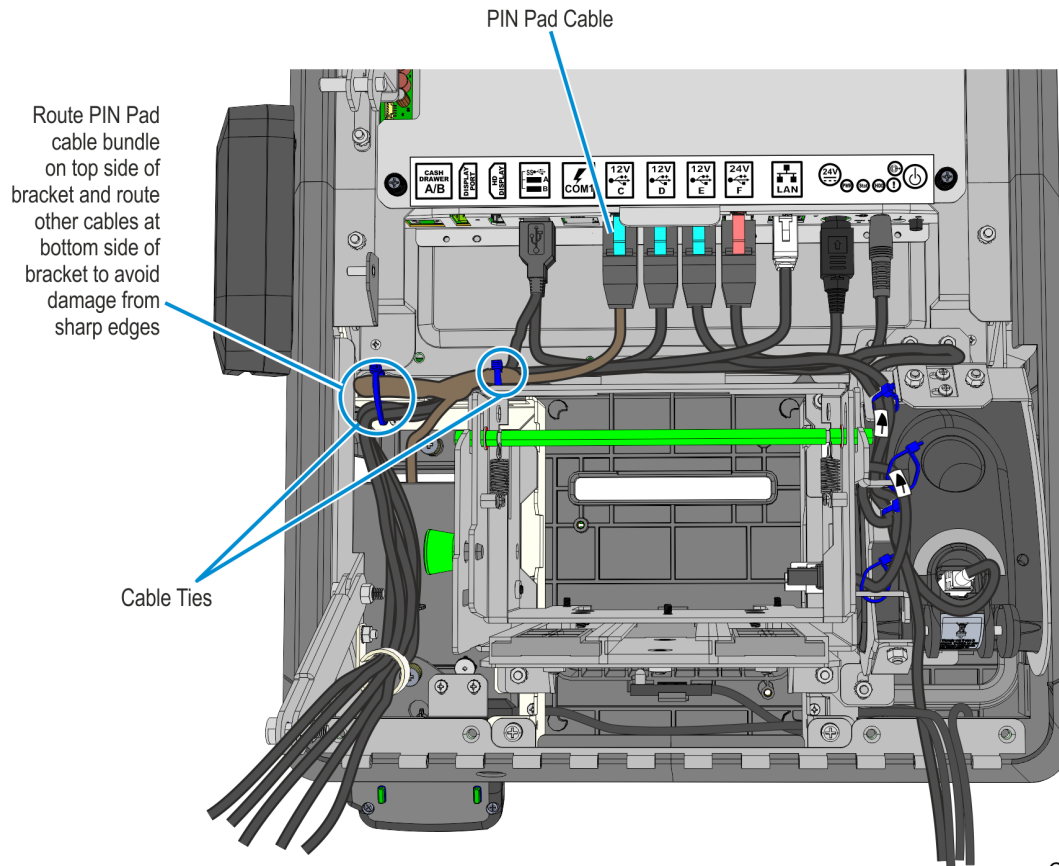

CCP-73740

2. While holding the PIN Pad from outside the Kiosk, loosen the two thumb screws securing the PIN Pad Cradle to the Display Head and then remove the PIN Pad and PIN Pad Cradle Assembly.

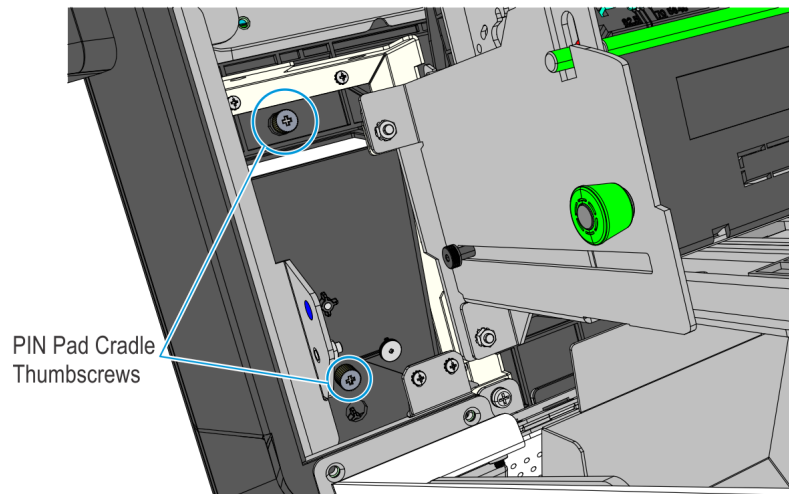

CCP-78706

3. Remove the two screws securing the PIN Pad to the PIN Pad Cradle.
4. Disconnect the PIN Pad Cable from the PIN pad.

# Removing the Imaging Scanner

Remove the two nuts that secure the Imaging Scanner Assembly to the kiosk and then, remove the assembly from the studs.

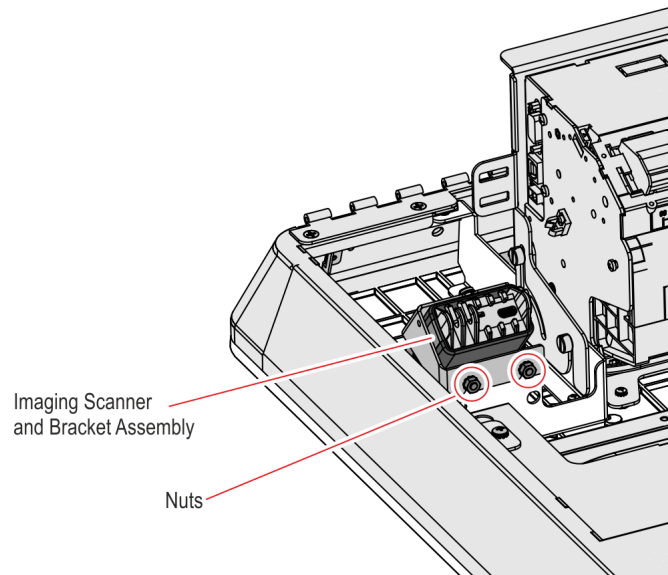

CCP-61361

# Removing the Receipt Printer

1. Disconnect the Printer USB and Power Cables from the Receipt Printer.

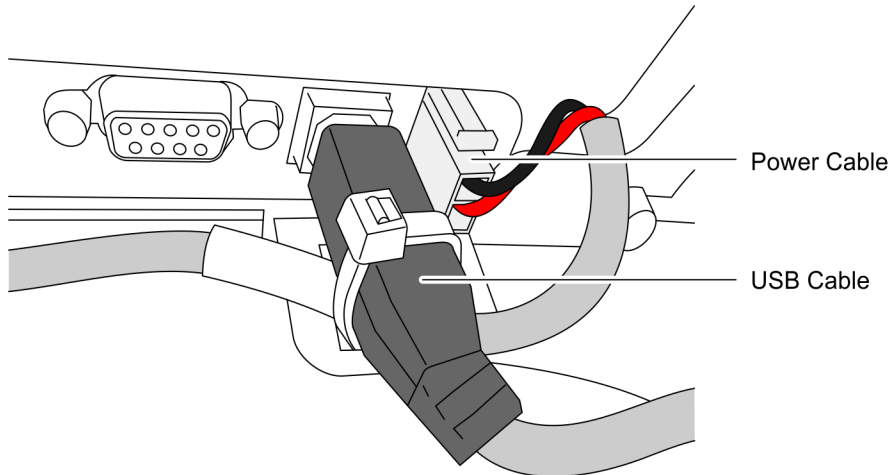

CCP-60042

2. To remove the Printer Assembly from the kiosk, remove the six screws (three on each side) that secure the Printer Assembly to the Z-shaped Brackets, and then gently lift the Printer Assembly off the kiosk.



## Note

Be careful not to damage the Printer Chute and the areas around the Printer Opening.

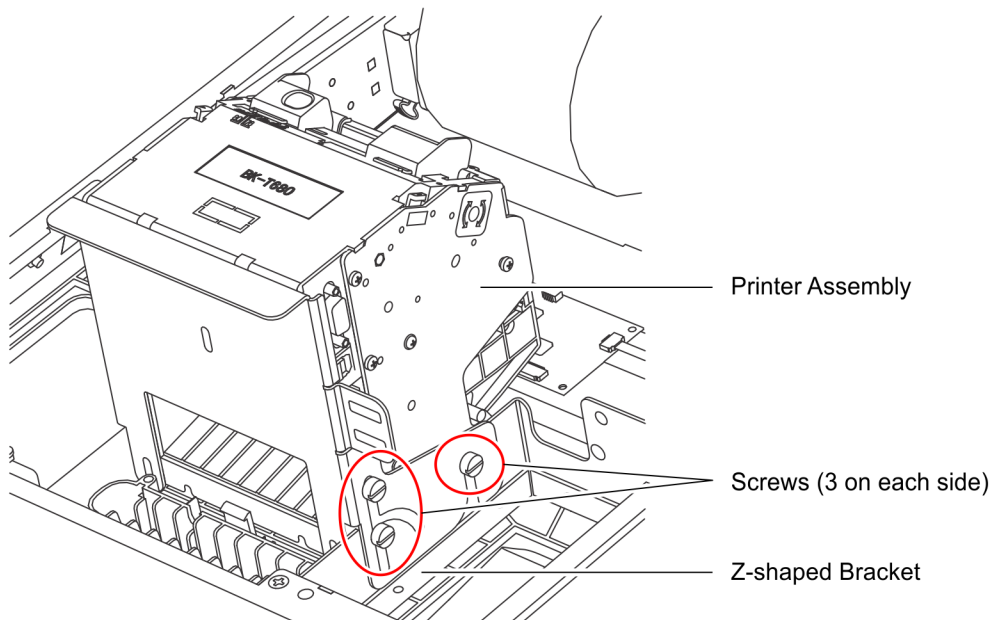

CCP-60039

# Attaching the New Printer Service Label

Place the new printer service label over the old printer service label.



## Note

Ensure that the Motherboard I/O board label is not covered.

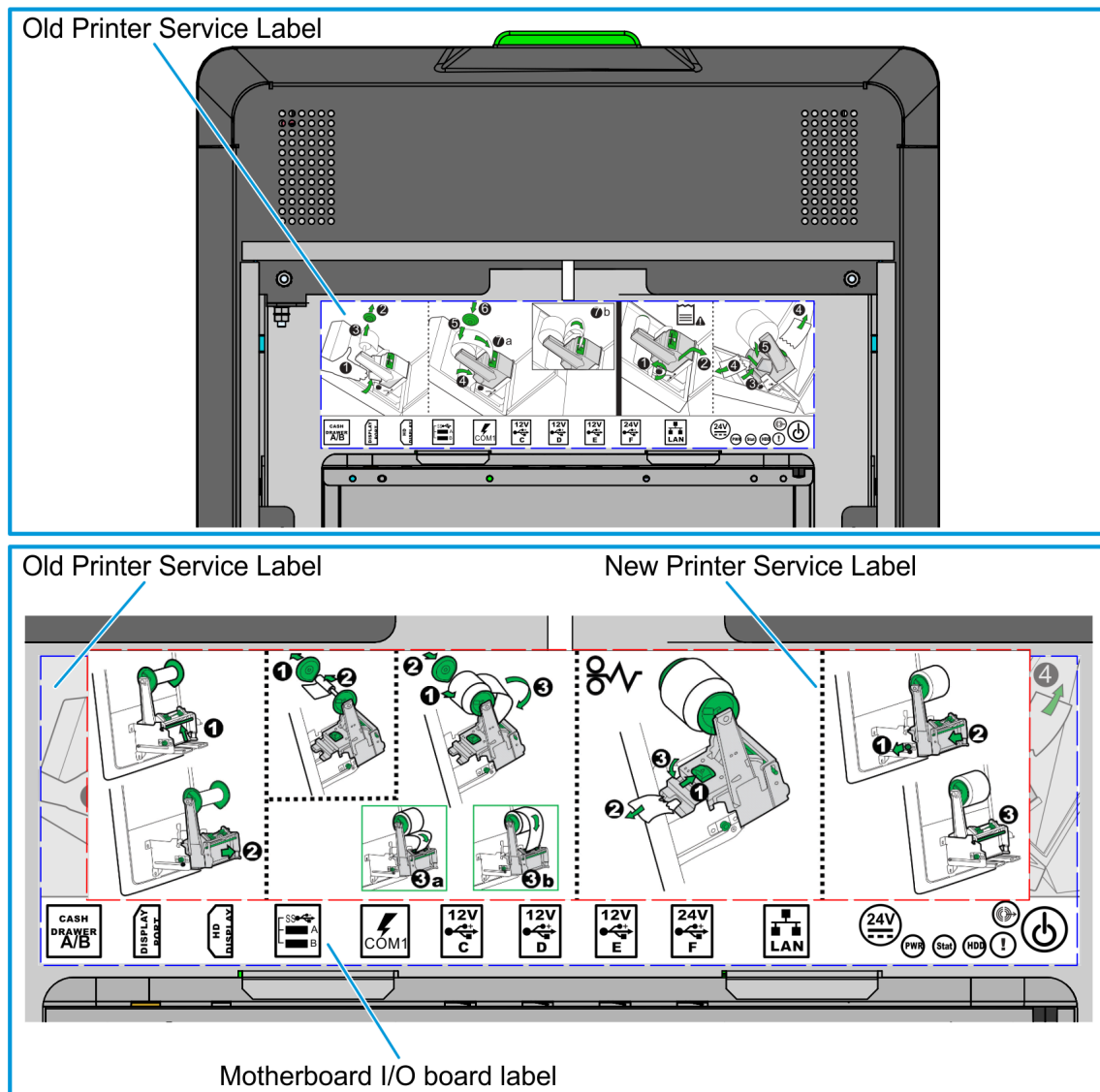

CCP-80907

Confidential and proprietary information of NCR Voyix.

Use and disclose solely pursuant to company instructions.

# Removing the Supervisor Switch

1. Remove the two M4 screws securing the Supervisor Switch assembly to the Display Head and route out the cable from under the two Display Head Brackets shown below.

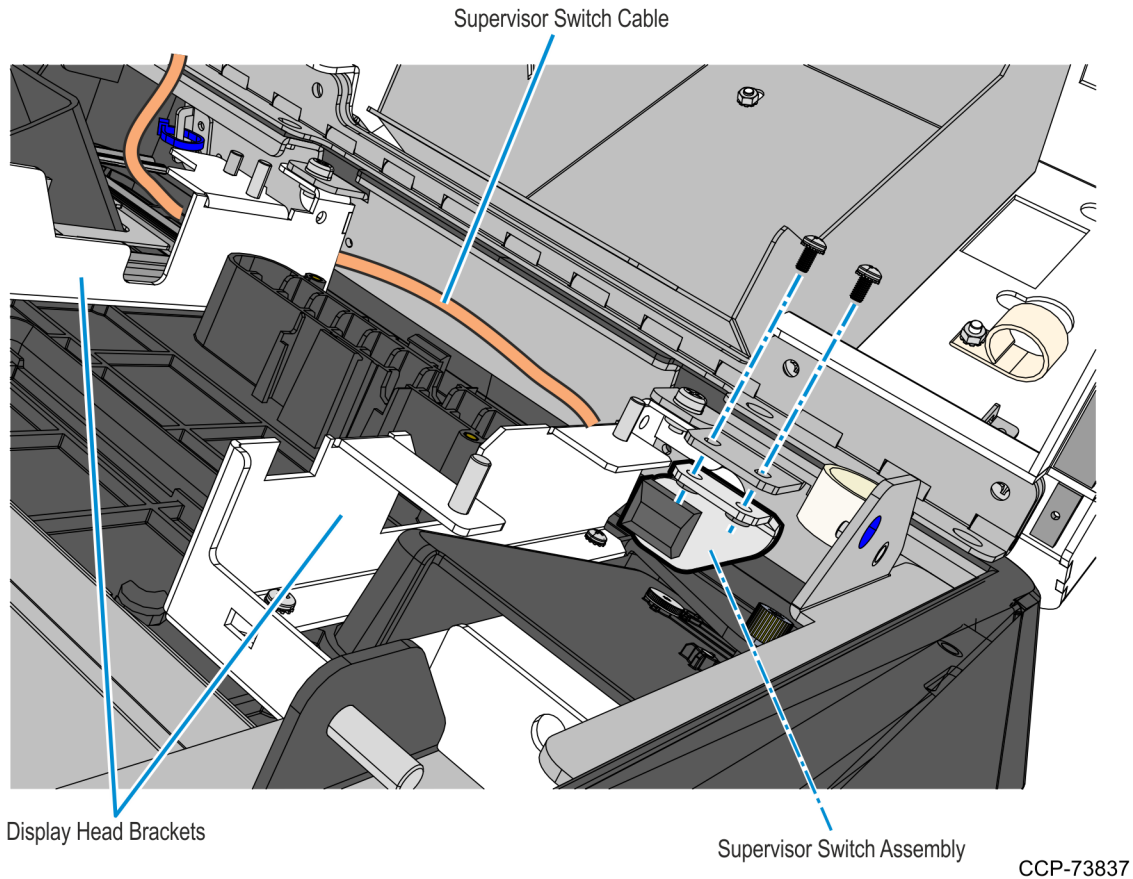

2. Remove cable tie that secures the Supervisor Switch cable to the Display Head, and then temporarily place the Supervisor Switch assembly inside the main cabinet.

# Removing the Coupon Sensors

Remove the Coupon Sensors from the Cable Snaps and route the cable out of the bracket.

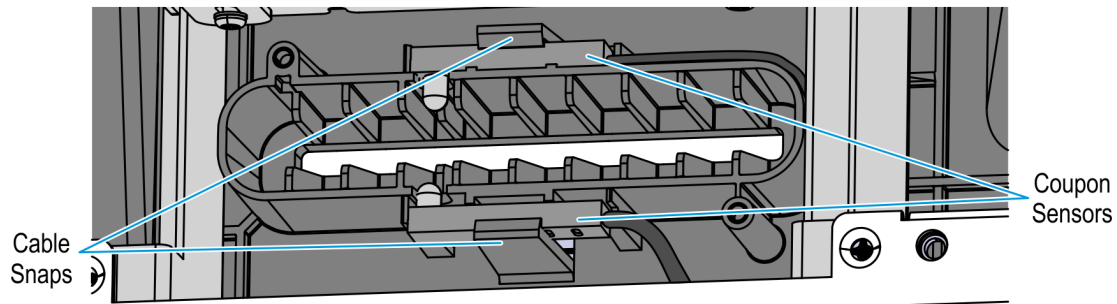

CCP-78473

# Removing the Sensormatic Antenna



## Caution

Make sure that the Sensormatic Controller is powered OFF. Do NOT connect or disconnect the Sensormatic Cables or Antenna from the Sensormatic Controller when power is ON as this could damage the controller.

1. Disconnect the Sensormatic Antenna Pigtail cable from the Antenna Cable.

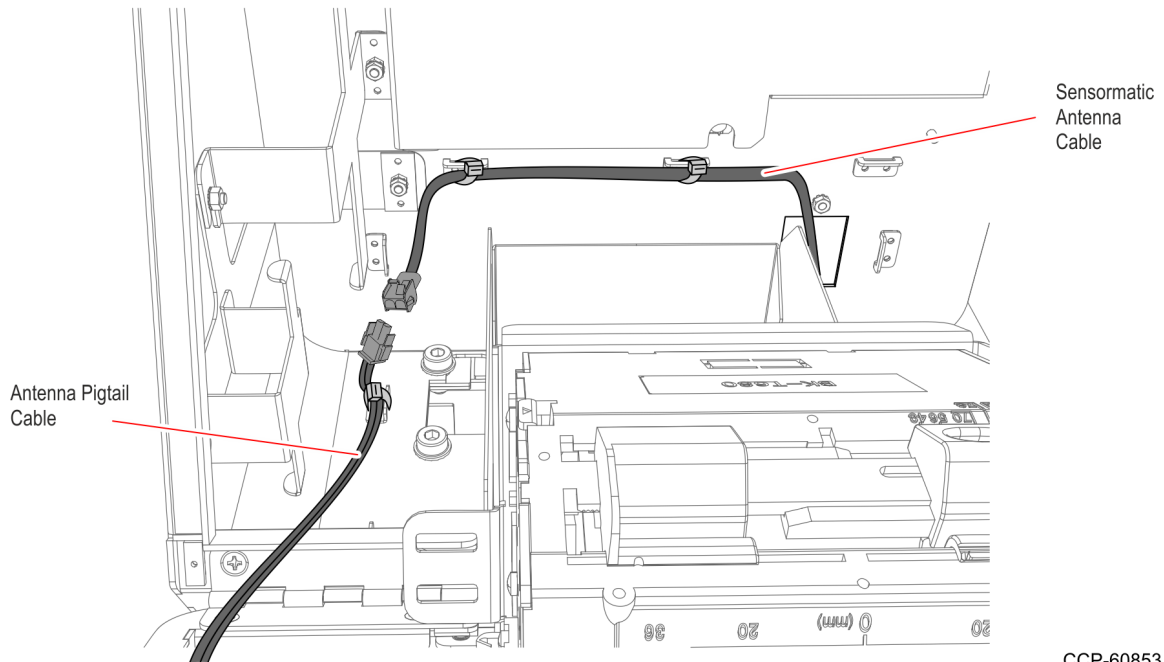



2. Remove the top and side brackets securing the antenna to the Display Head.

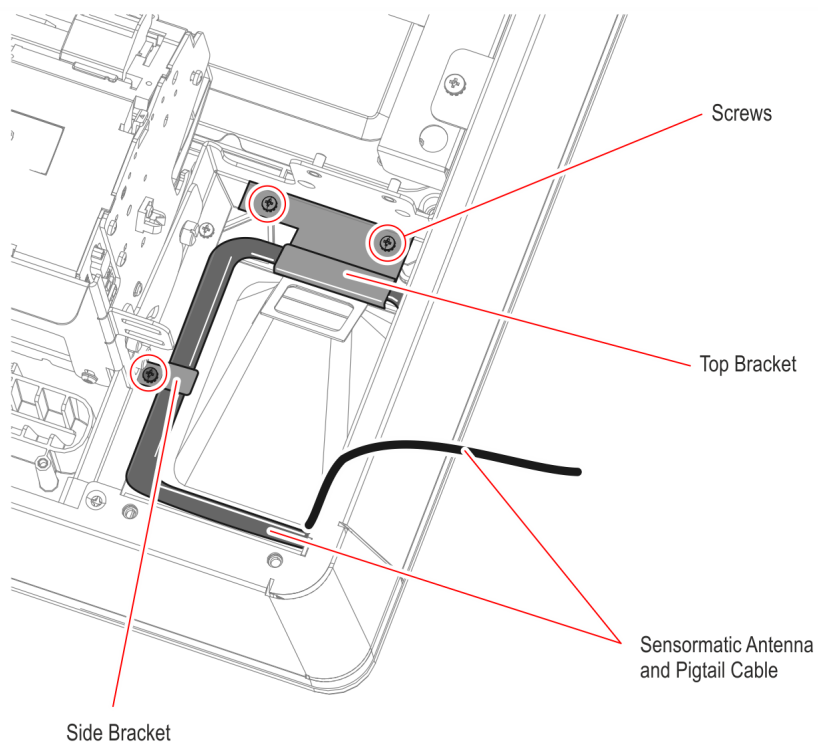

CCP-60832

3. Remove the antenna from the Display Head.

# Removing the Display Head

1. While supporting the Kiosk Display Head, remove the two nuts securing the Display Head Chain to the Kiosk cabinet and remove the chain from the stud.



## Warning

Make sure to properly support the display head so as not to accidentally drop it.

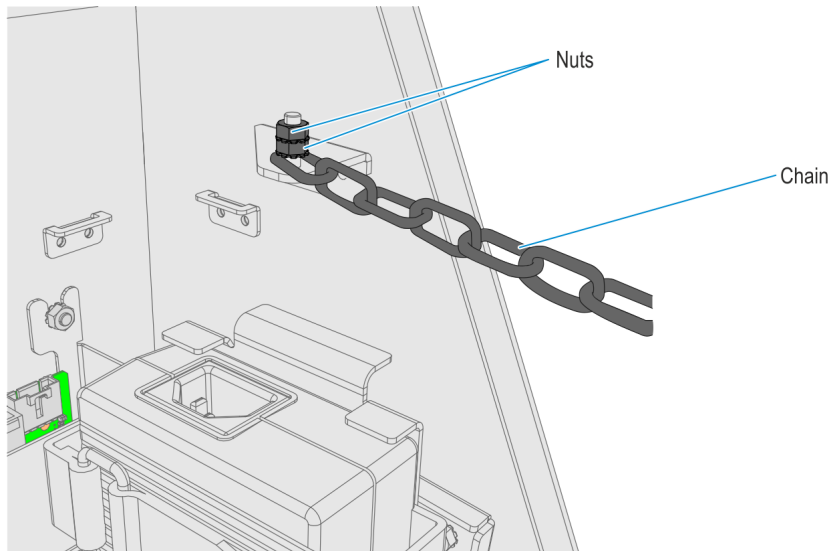

CCP-60828

2. While supporting the display head, remove the four screws that attach the hinge to the kiosk cabinet.

**Warning**

Make sure to properly support the display head so as not to accidentally drop nor damage it.

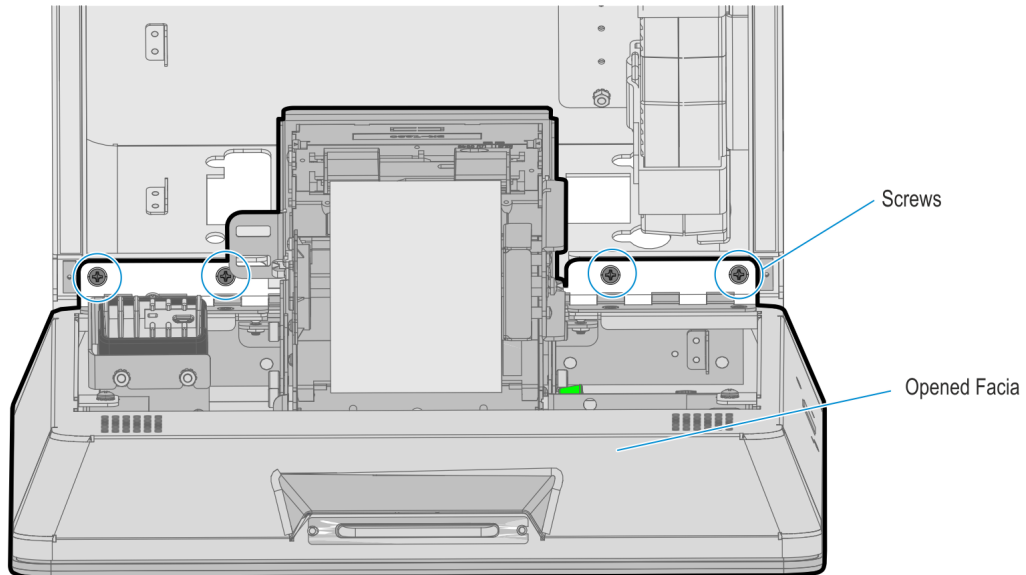

CCP-60824

3. Carefully place the front the kiosk on a flat surface cushioned with bubble wrap or soft cloth.

**Caution**

Be careful not to scratch nor damage the display.

# Removing the Rear Cover

1. If the kiosk has an MSR, disconnect the MSR Cable from the MSR Extension Cable. These two cables are found under the Motherboard Bracket.

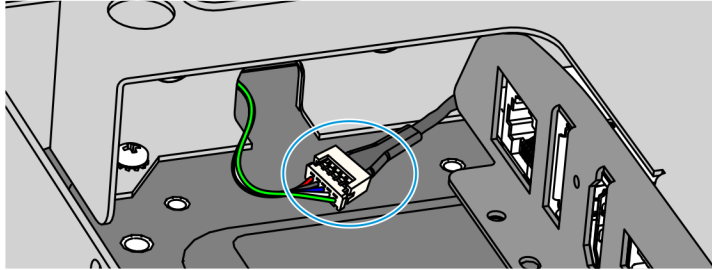

CCP-78472

2. Remove the four screws that secure the hinge to the Rear Cover.

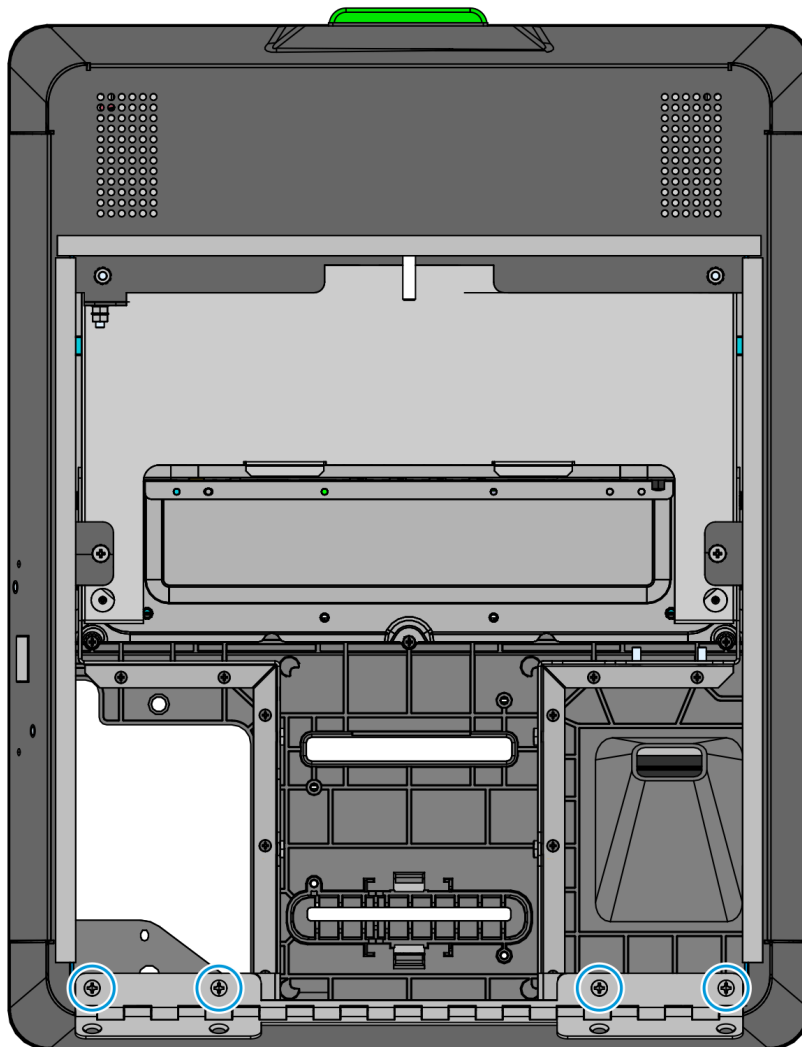

CCP-78497

3. Remove the four screws and two nuts that secure the Rear Cover to the Display Head.

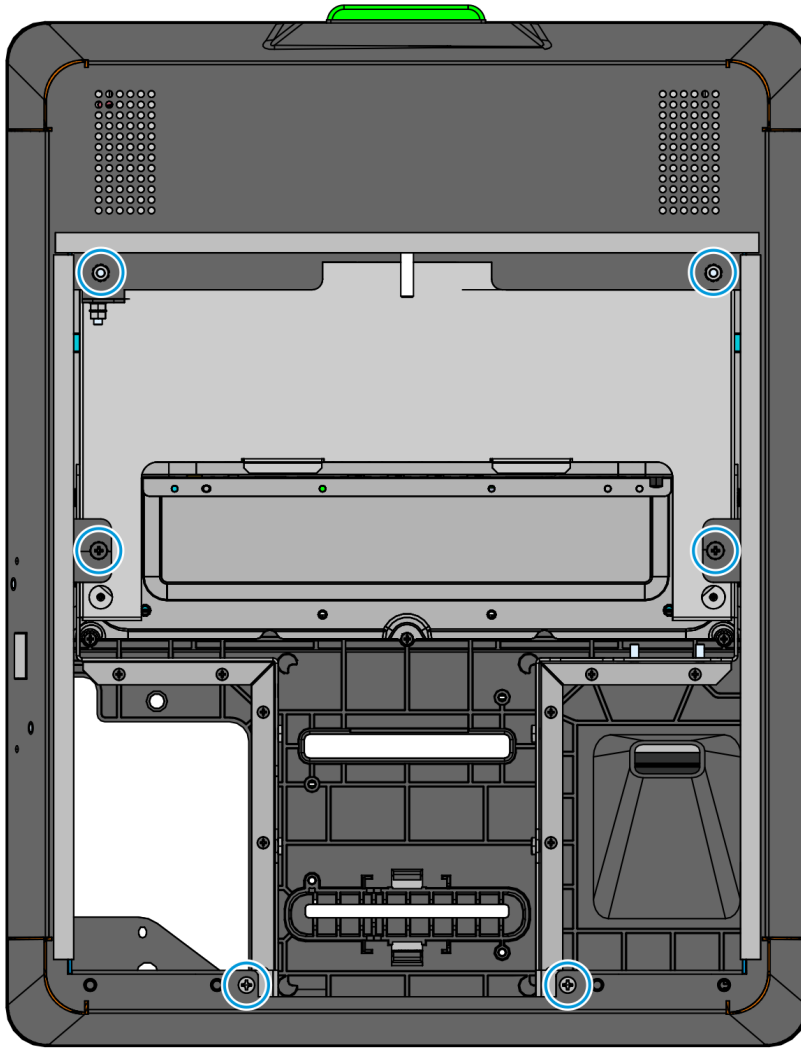

CCP-78496

4. Carefully lift off the Rear Cover from the Display Head.

# Removing the Old Z-shaped Brackets

Remove the fourteen screws that secure the left and right Z-shaped Brackets to the display head.

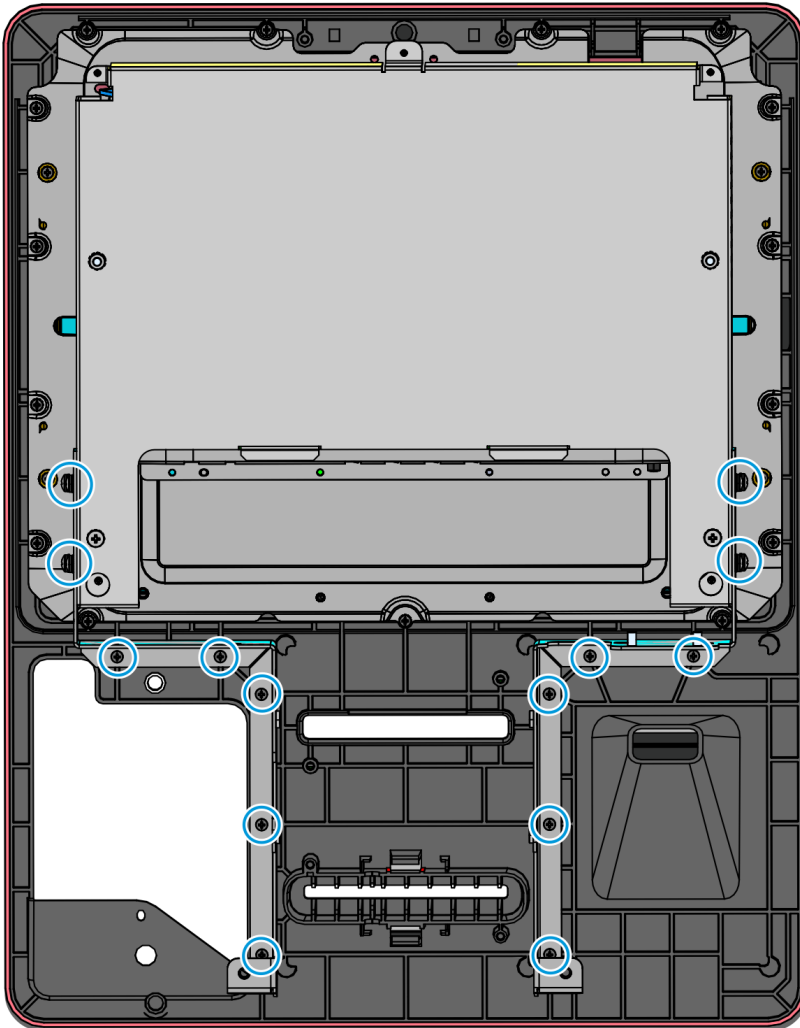

CCP-78494

# Installing the New Z-shaped Brackets

Install the new Z-shaped Brackets and secure with the existing fourteen screws.

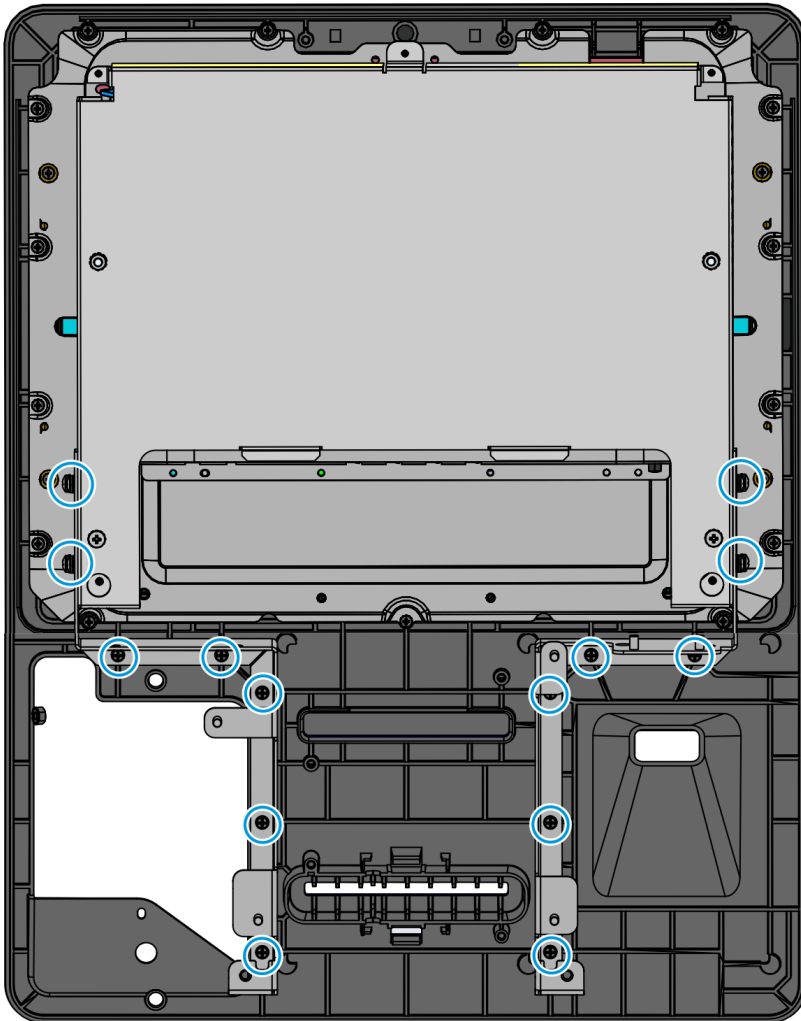

CCP-78493

# Installing the Rear Cover

1. Carefully lower the Rear Cover to the Display Head and secure it with four screws and two nuts.

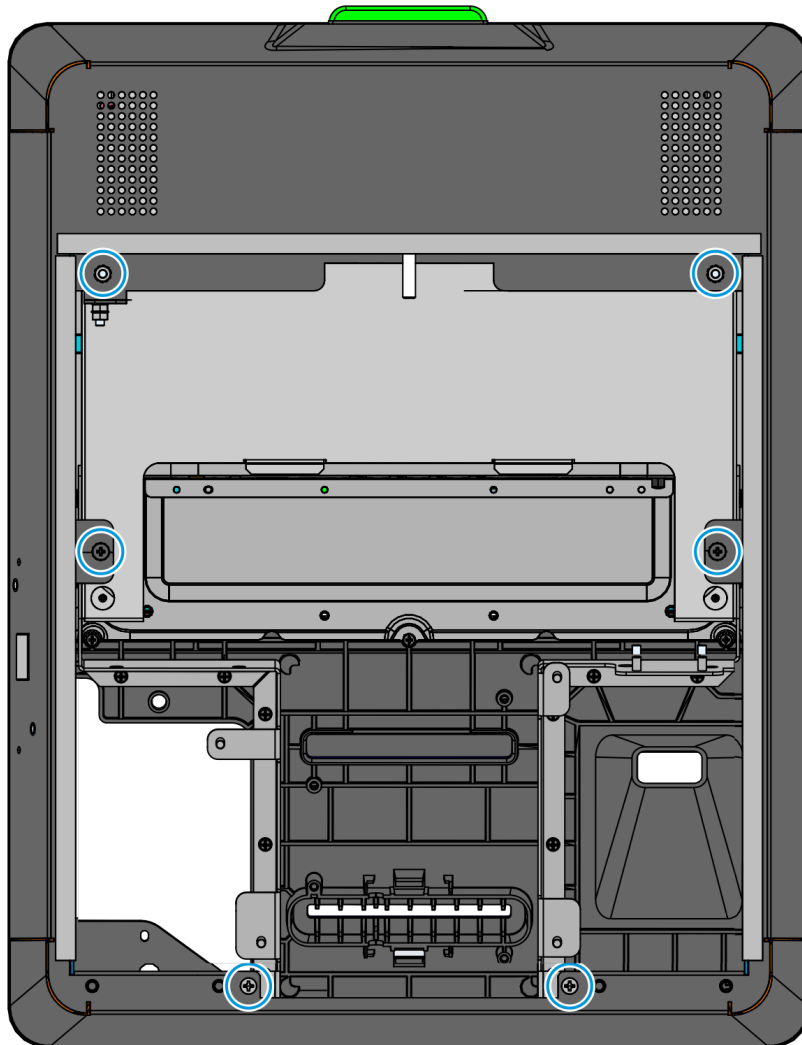

CCP-78471



2. Using the four screws, attach the hinge to the Rear Cover.

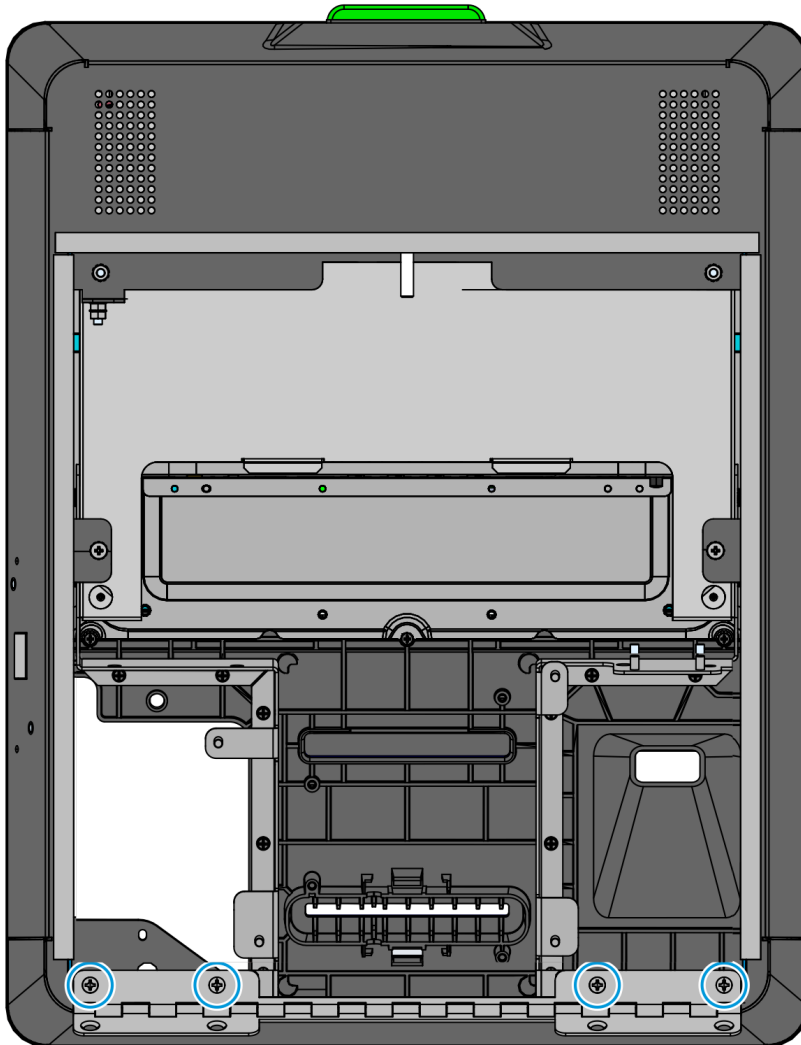

CCP-78470

3. If the kiosk has an MSR, connect the MSR Cable to the MSR Extension Cable.

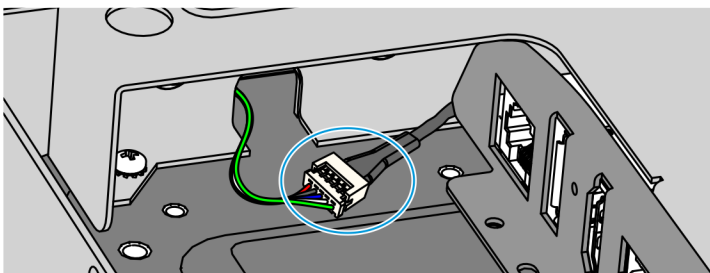

CCP-78472

# Installing the Coupon Bin

1. Remove the old Coupon Bin from the cabinet by removing the two Hex nuts.
2. Install the R1.2 Coupon Bin and secure with the two Hex nuts.

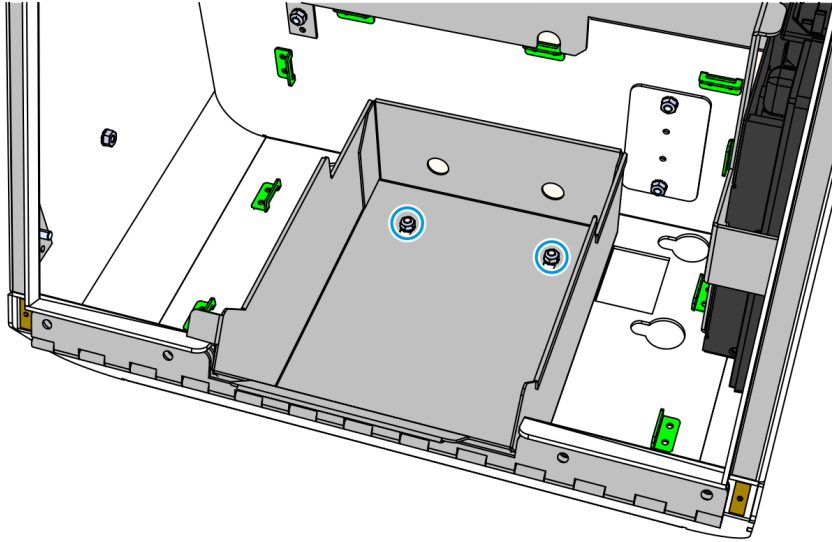

CCP-78478

# Installing the Display Head

1. Position the display head against the bottom part of the cabinet.
2. Attach and secure the hinge to the cabinet with four screws..

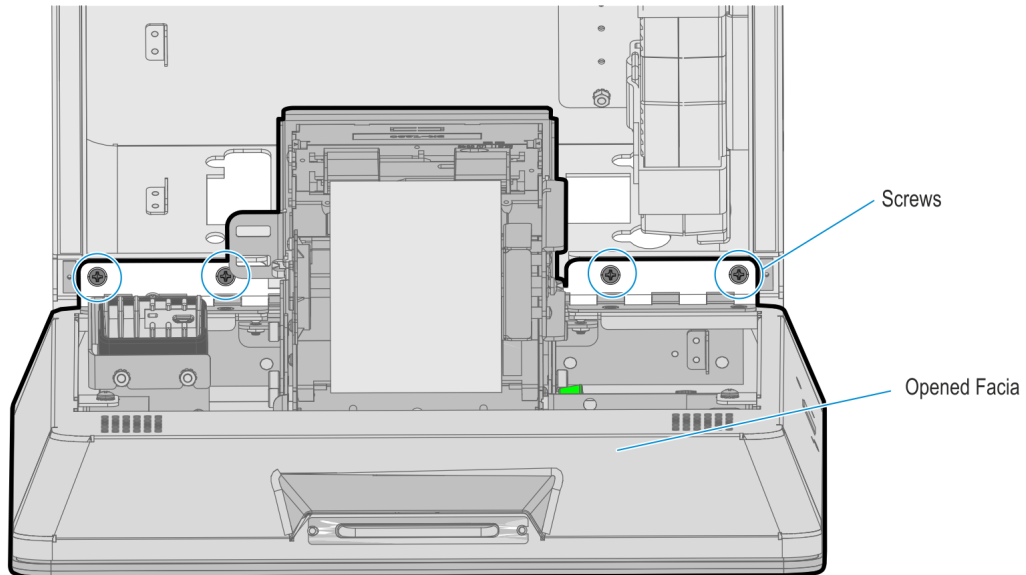

CCP-60824

3. Attach the chain to the stud and secure with two nuts.

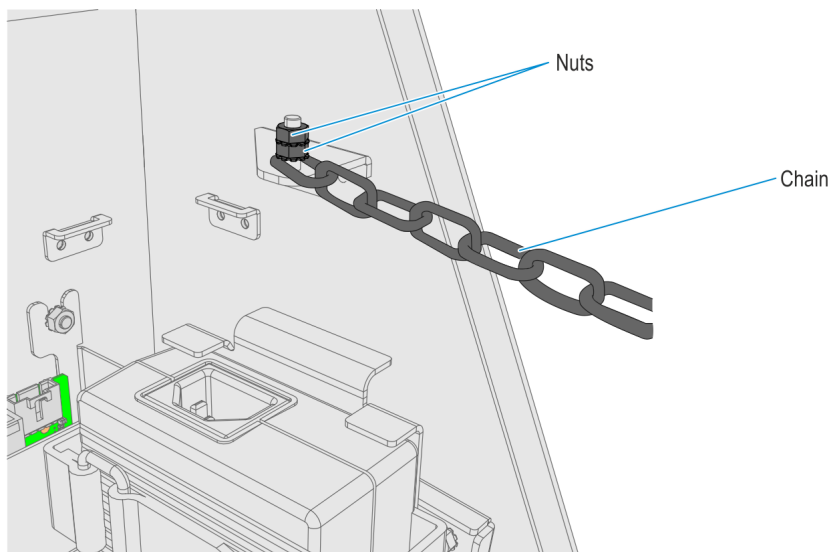

CCP-60828

# Installing the Sensormatic Antenna

1. Place the Sensormatic antenna over the imager funnel with its pigtail cable sticking out at the lower-right hand corner of the Display Head Assembly. Secure the antenna with the top and side brackets.

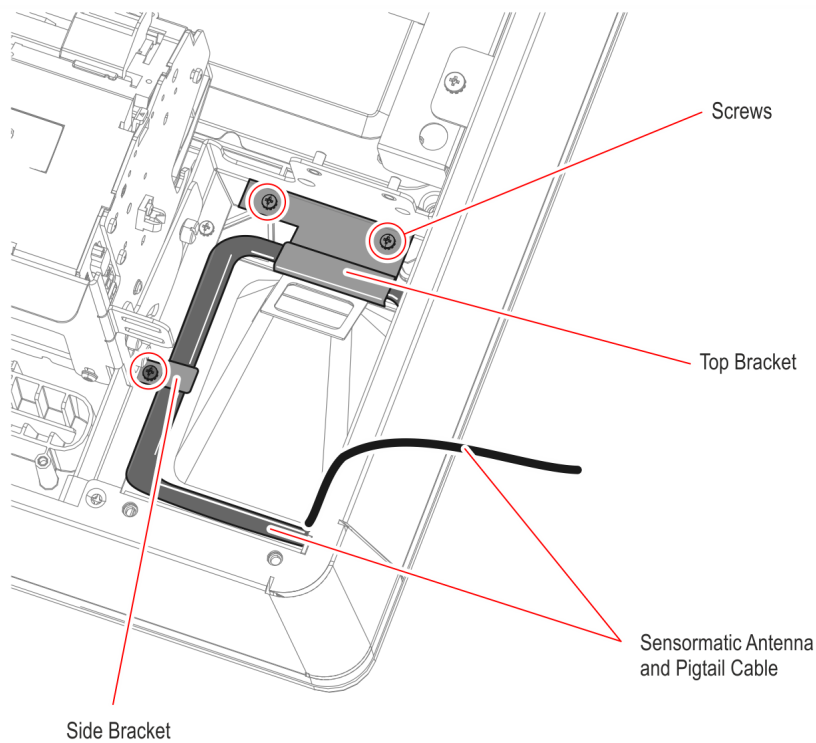

CCP-60832

2. Route the antenna Pigtail Cable into the cabinet at the space on the left-hand side of the coupon bin and plug the Pigtail Cable to the Sensormatic Antenna Cable. Cable tie the pig tail cable as shown below.

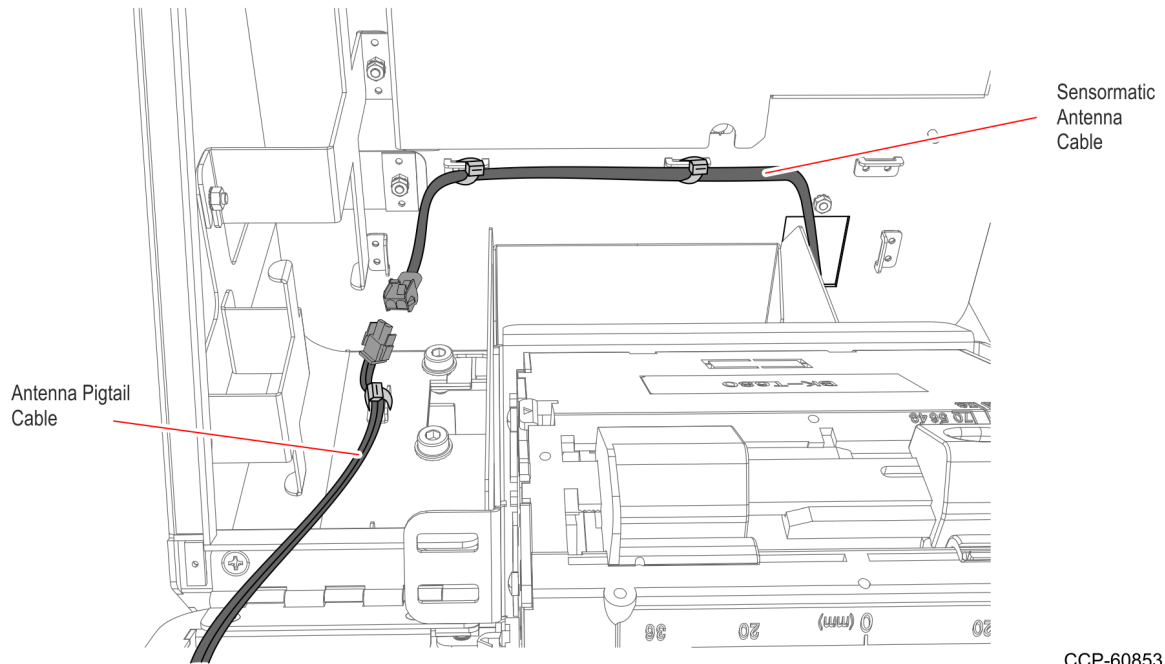

CCP-60853

# Installing the Coupon Sensors

Place the Coupon Sensors in the Cable Snaps.

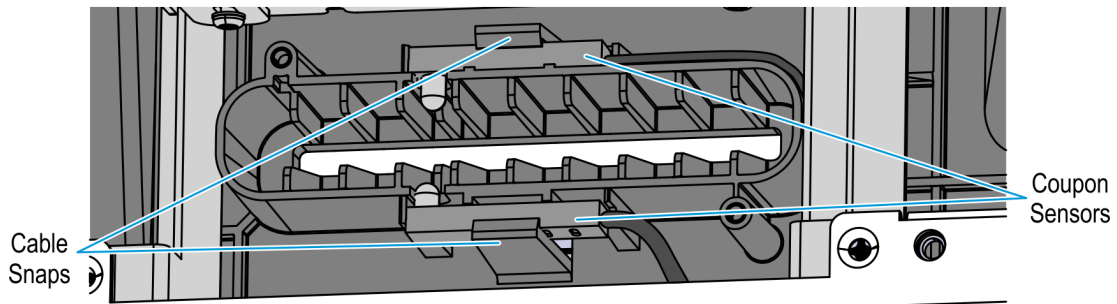

CCP-78473

# Installing the Supervisor Switch

1. Route the Supervisor Cable from the PIN Pad side towards the Imager side, passing the cable under the two Display Head Brackets shown below. Using a cable tie, secure the Supervisor Switch cable to the Display Head.

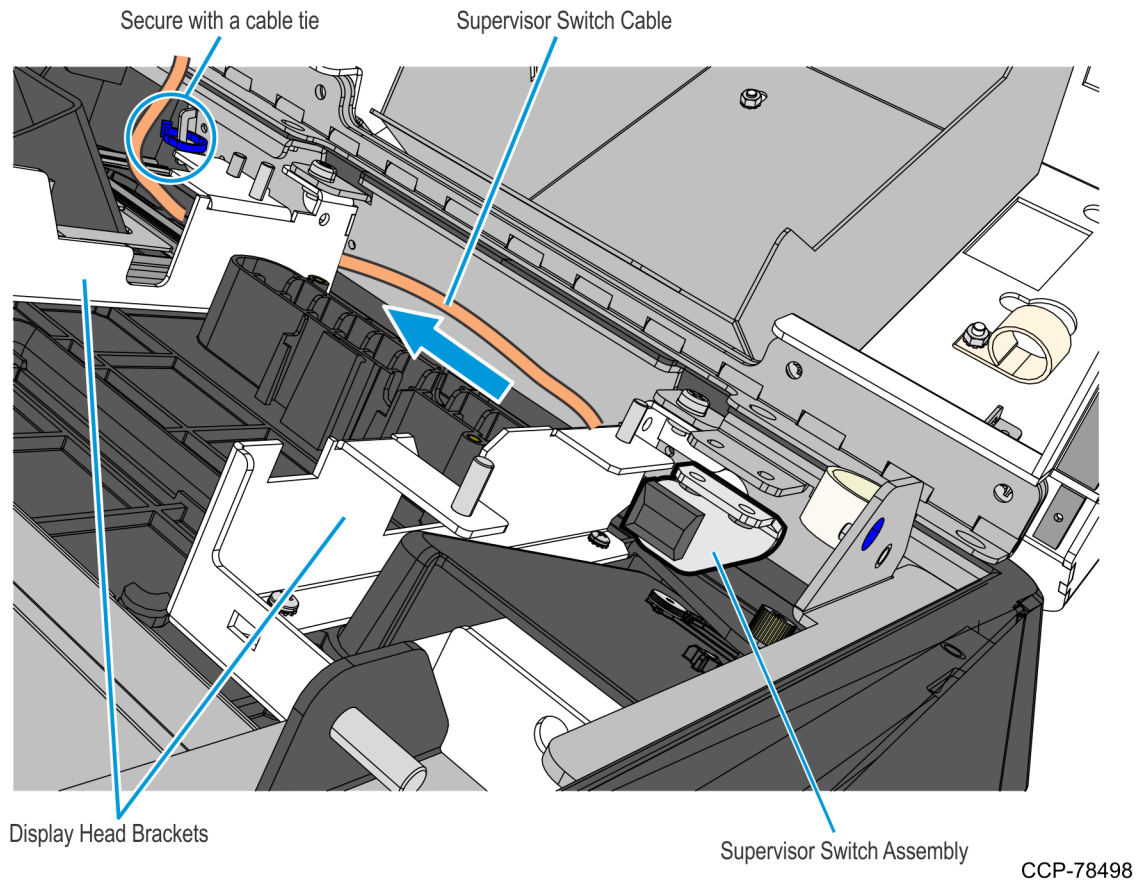

2. Mount and secure the Supervisor Switch assembly to the Display Head using two screws.

**Important**

Make sure that the Supervisor assembly is mounted parallel with its mounting bracket and secured to the top side of the mounting slots. This position provides the appropriate space for the assembly and properly aligns the Supervisor Switch to its external access hole.

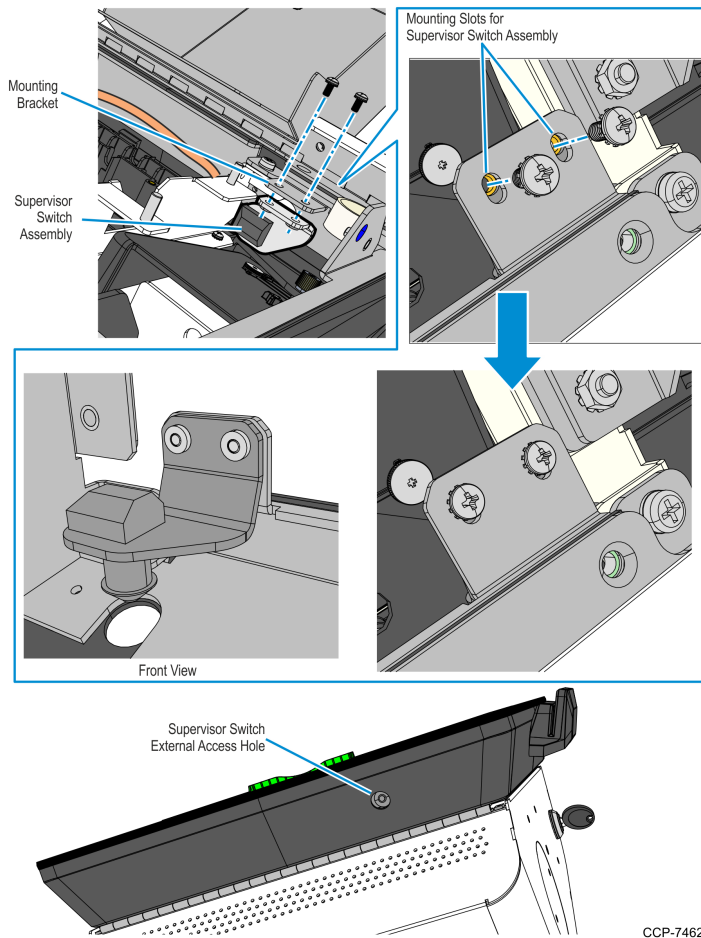



# Installing the Imaging Scanner

Mount the Imaging Scanner Assembly to the two studs and secure with two nuts.

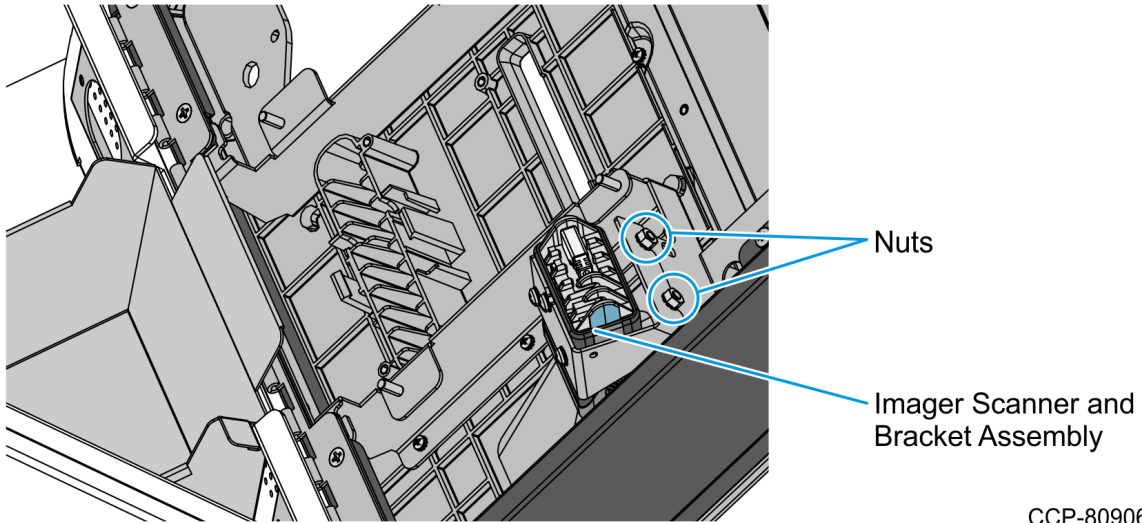

CCP-80906

# Installing the Receipt Printer

1. Install the Doune Receipt Printer on its tray.

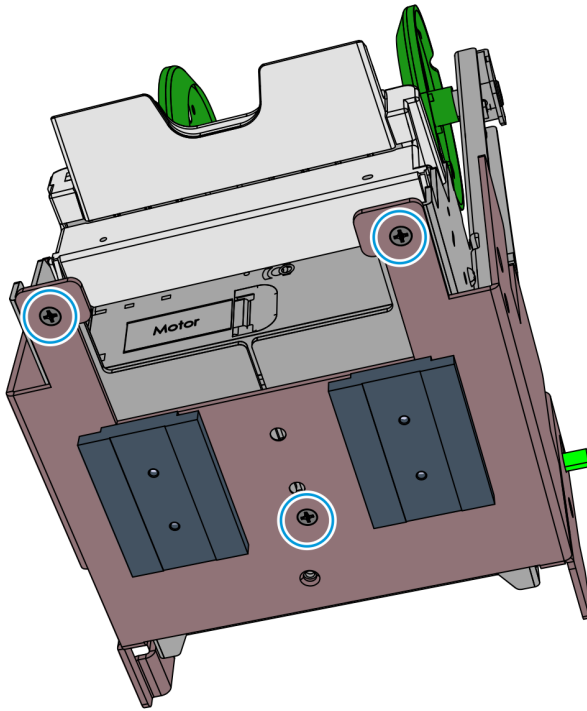

CCP-78740

- a. Remove the Printer Tray from the Printer Bracket.
- b. Mount the Doune Receipt Printer onto the tray and secure with three M3X6 flat head screws.

2. With the Printer Tray in closed position, install the M4 shoulder screw to secure the Printer Assembly to the Printer Bracket.

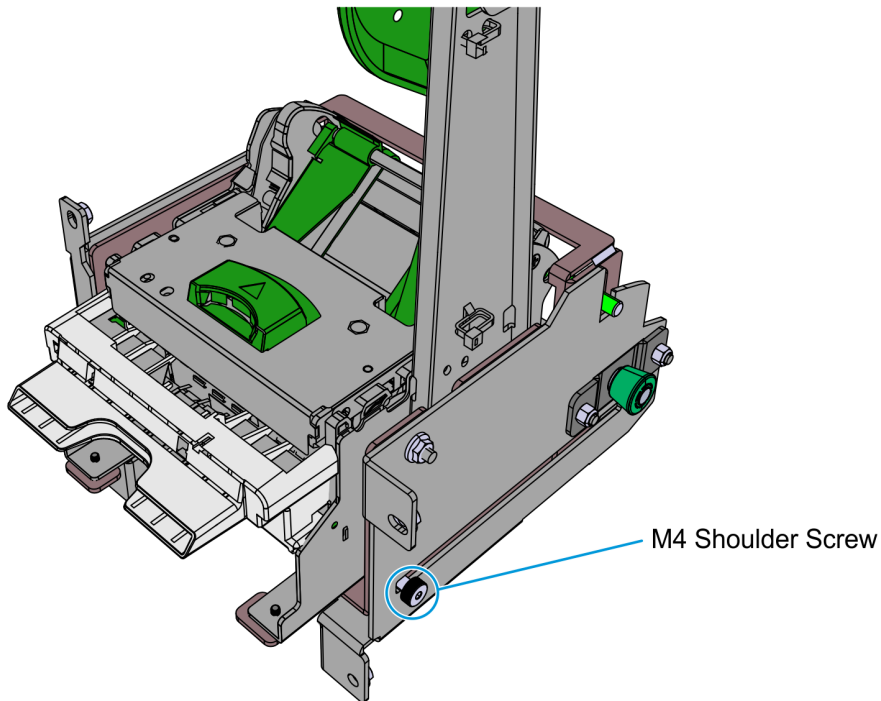

CCP-78742

3. Mount the printer assembly onto its four mounting studs on the Z-bracket, and secure it with four M4 nuts.

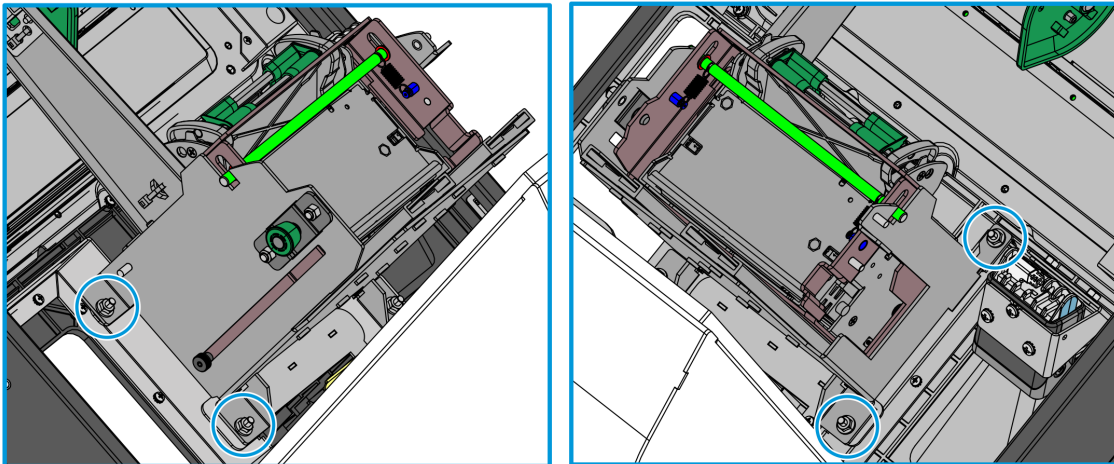

CCP-80901

4. Using two M4 serrated nuts, connect one end of the 6-inch Ground Cable to the stud on the Printer Bracket and the other end to the stud on the Printer Tray.

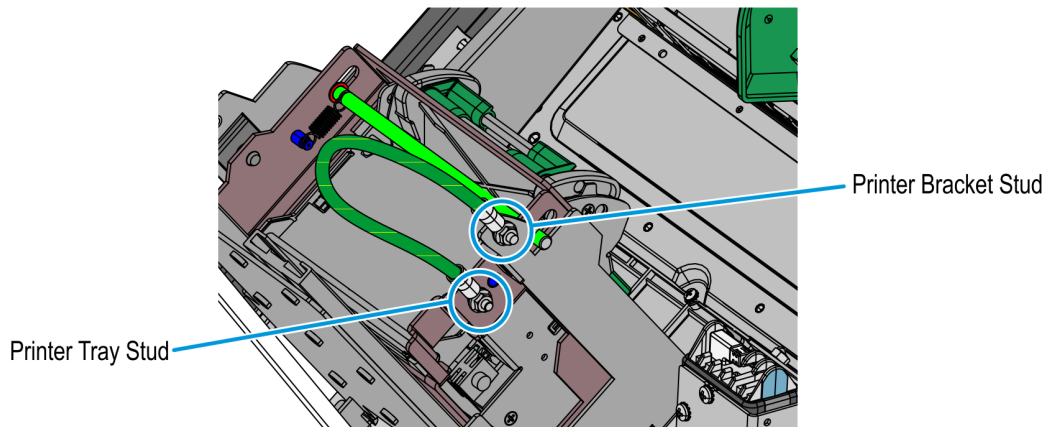

CCP-80902

5. Install the 12-inch Ground Cable.
  - a. Using an M4 serrated nut, connect one end of the 12-inch Ground Cable to the mounting stud on the Printer Bracket.

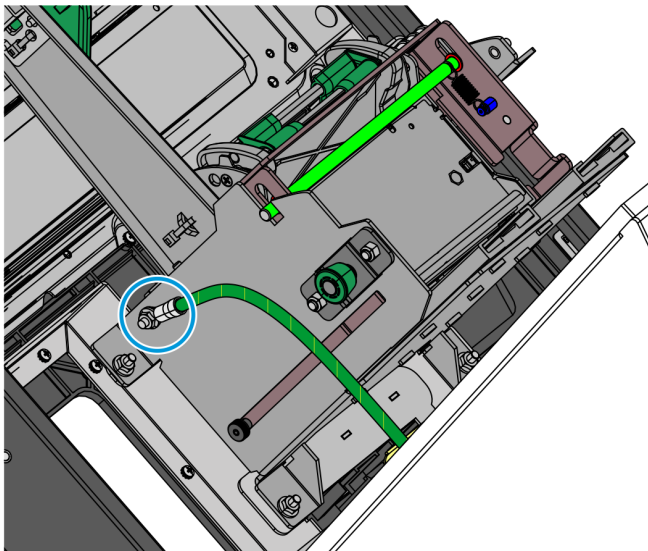

CCP-80903

- b. Secure the other end of the 12-inch Ground Cable to the metal stud on the inner right wall of the bucket, beside the Power Supply Brick.

**Note**

There may be other ground cables attached to the same metal stud.

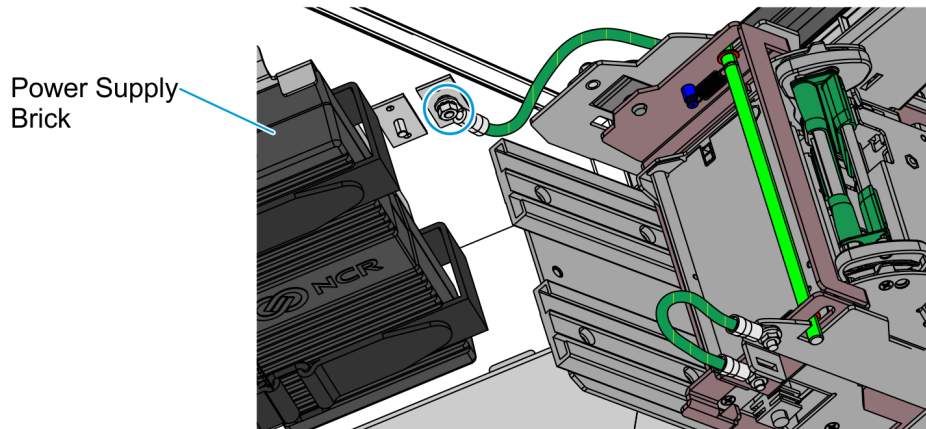

CCP-80904

6. Connect the Printer USB Power Cable to the printer, and use cable ties to secure it to the metal brackets indicated in the image.

**Note**

There should be enough slack to allow the Printer Tray to slide upward.

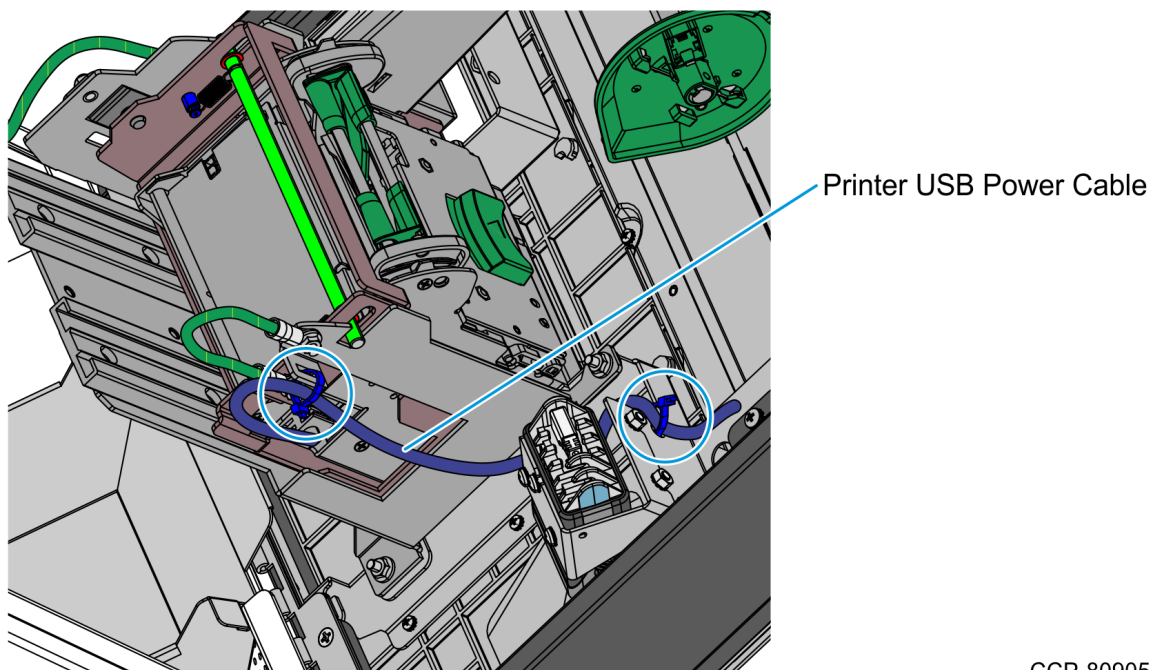

CCP-80905

# Installing the Ingenico IPP320/350 PIN Pad

1. Position the Mounting Bracket onto the screws, and then tighten the screws.
2. Connect the PIN Pad Cable to the PIN Pad.
3. Mount the PIN Pad to the Mounting Bracket by aligning the slot on the lower back of the PIN Pad with the small tab on the lower portion of the Mounting Bracket.

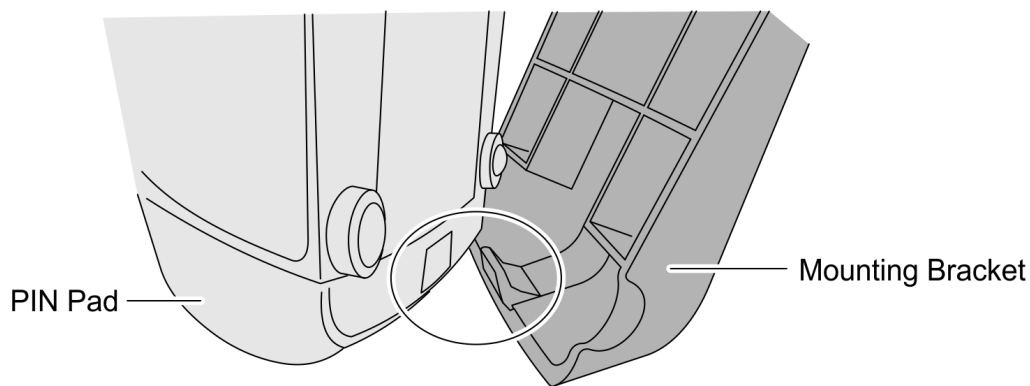

CCP-60071

4. Push the PIN Pad until it snaps to the upper portion of the Mounting Bracket.

# Installing the Verifone VX805/820 PIN Pad

1. Connect the PIN Pad Cable to the PIN pad and route the cable through the access hole on the PIN Pad cradle.

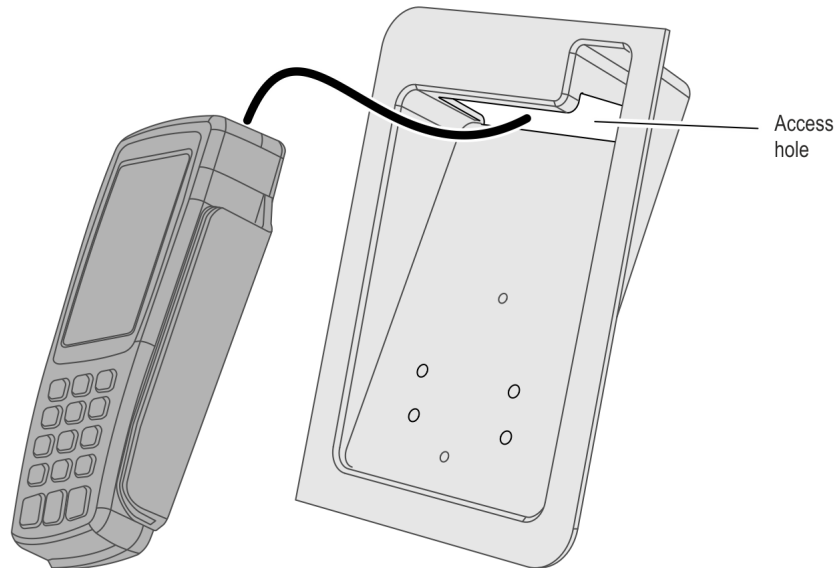

CCP-61344

2. Align the PIN pad mounting holes to the appropriate mounting holes set on the PIN pad cradle as shown below and secure the PIN Pad with two screws.
  - Use Set A mounting holes for VX 805 PIN pad
  - Use Set B mounting holes for VX820 PIN pad

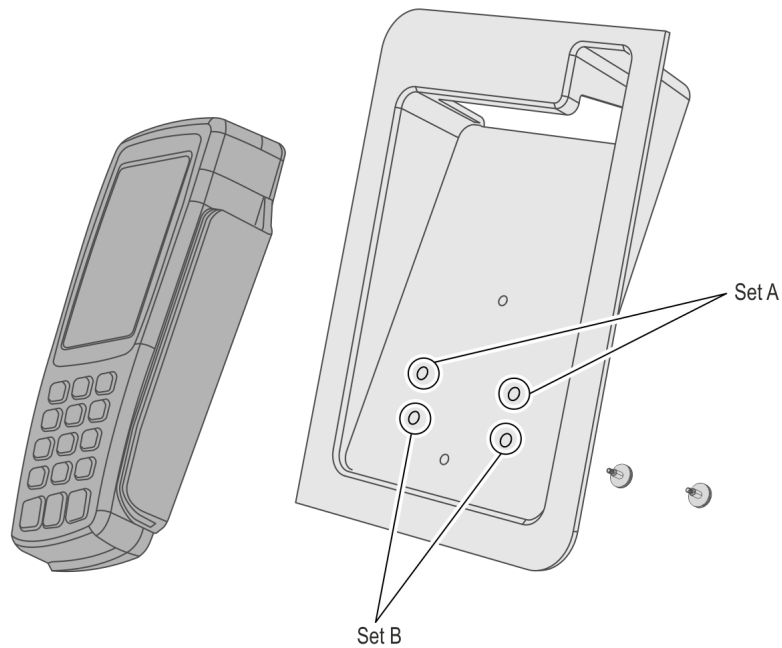

CCP-61346

3. Mount the PIN Pad and Cradle Assembly on the Display head and secure with two thumbscrews.

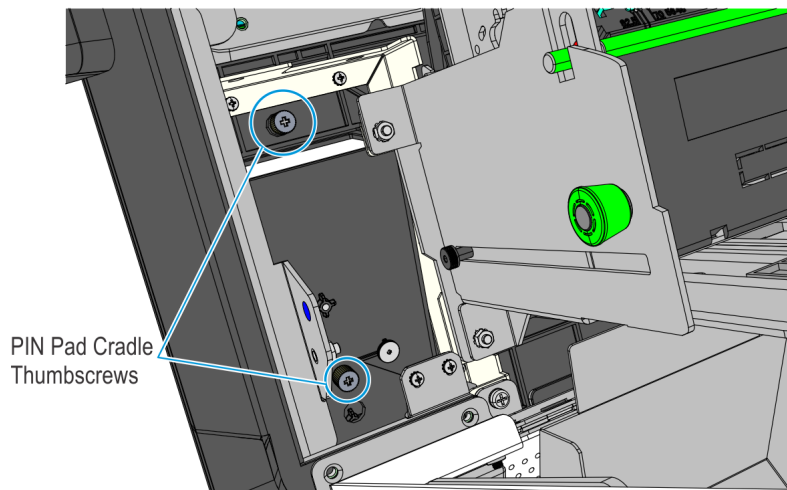

CCP-78706



4. Connect the PIN Pad Cable to the PIN Pad. Cable tie the extra length of the cable as shown below.

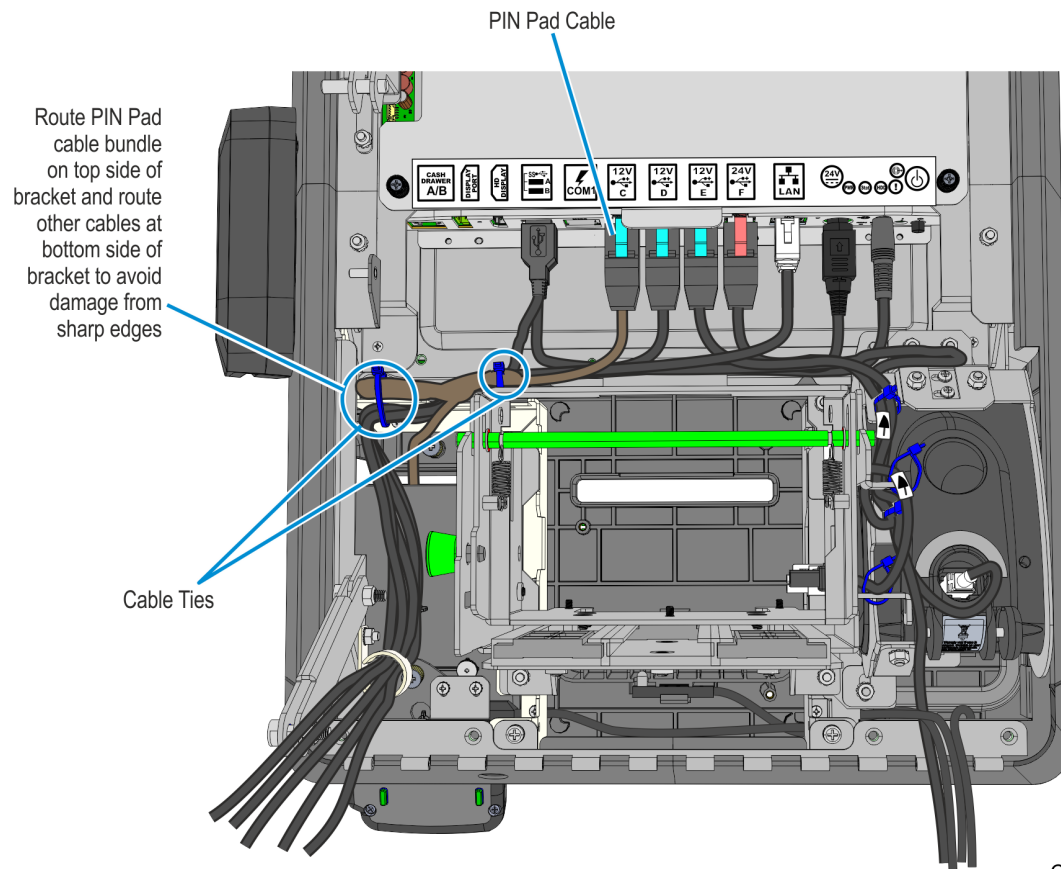

CCP-73740

# I/O Motherboard Cable Connections

The NCR Voyix SelfServ™ 90 (7709) provides labels that show the connectors of the Motherboard. The table below indicate the type of device or cable for each connector.

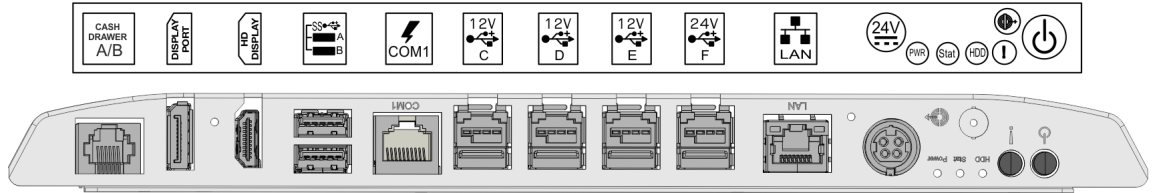

CCP-61343

Motherboard Port	Device/Cable
COM 1	Ingenico IPP350 PIN Pad
LAN	LAN Ethernet Cable
24V	Power Supply Cable
Line Out	Dual Speaker
USB A	Sensormatic Controller
USB B	Imaging Scanner
USB C	Verifone VX805, VX820, or MX915 PIN Pad
USB D	Security Scale
USB E	I/O Adapter
USB F	Receipt Printer

Connector	Device/Cable
COM 1	Ingenico IPP320, IPP350, or Lane 5000 PIN Pad
LAN	LAN Ethernet Cable
24V	Power Supply Cable
Line Out	Dual Speaker

Connector	Device/Cable
USB A	Sensormatic Controller
USB B	Imaging Scanner
USB C	Verifone VX805, VX820, or MX915 PIN Pad
USB D	Security Scale
USB E	I/O Adapter
USB F	Receipt Printer

# I/O Adapter Cable Connections

The NCR Voyix SelfServ™ 90 (7709) provides labels that show the connectors of the Adapter. The table below indicates the type of device or cable for each connector.

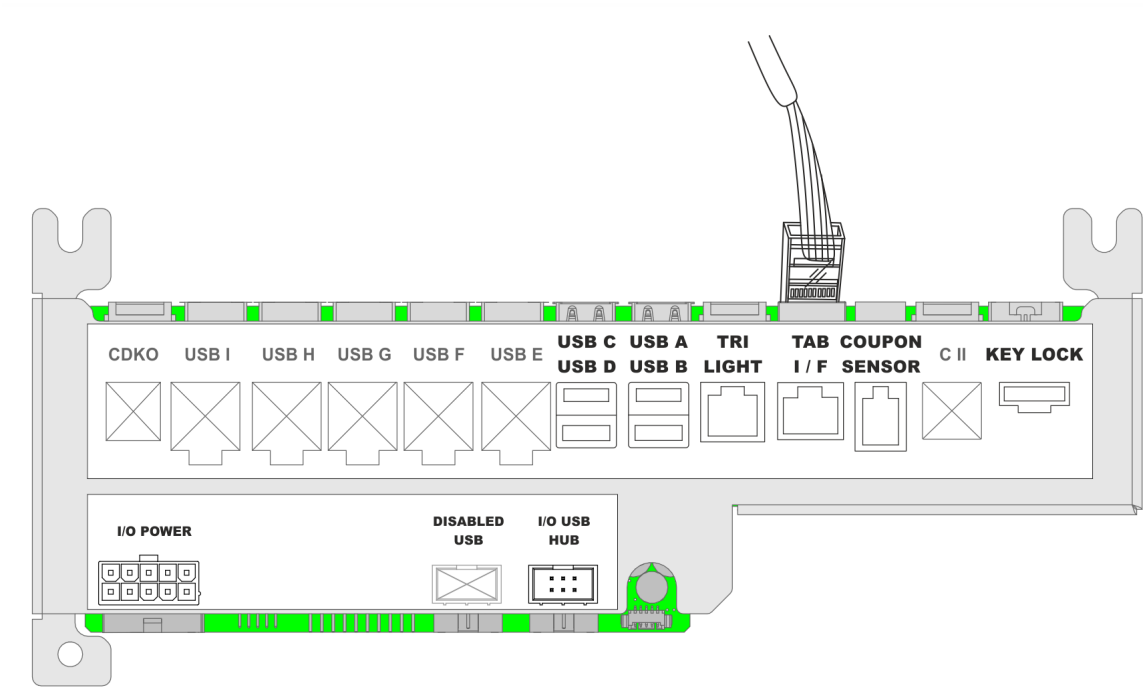

CCP-61349

I/O Adapter Port	Device/Cable
USB A	Handheld Scanner
Tri Light	Indicator Light
TAB I/F	Checkpoint Signal Cable
Coupon Sensor	Coupon Sensor Cable
I/O Power	P2 of the I/O Cable
I/O USB Hub	P3 of the I/O Cable