

Kit Instructions

Turntable

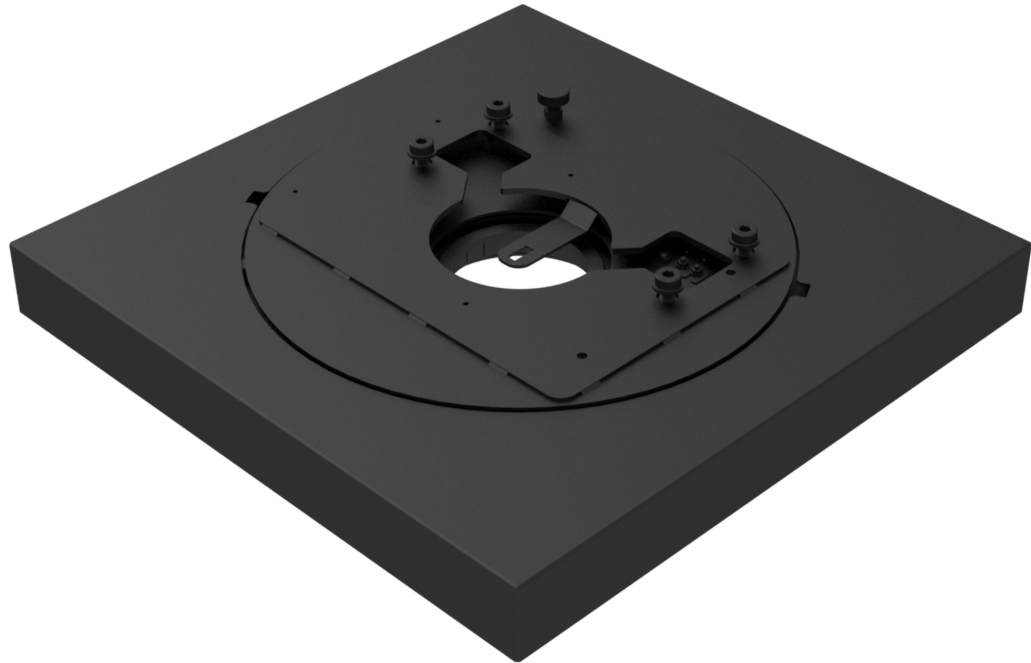

7709-K739
Issue A



The product described in this document is a licensed product of NCR Corporation.

NCR is a registered trademark of NCR Corporation. NCR SelfServ™ is a trademark of NCR Corporation in the United States and/or other countries. Other product names mentioned in this publication may be trademarks or registered trademarks of their respective companies and are hereby acknowledged.

The terms HDMI and HDMI High-Definition Multimedia Interface, and the HDMI Logo are trademarks or registered trademarks of HDMI Licensing LLC in the United States and other countries.

Where creation of derivative works, modifications or copies of this NCR copyrighted documentation is permitted under the terms and conditions of an agreement you have with NCR, NCR's copyright notice must be included.

It is the policy of NCR Corporation (NCR) to improve products as new technology, components, software, and firmware become available. NCR, therefore, reserves the right to change specifications without prior notice.

All features, functions, and operations described herein may not be marketed by NCR in all parts of the world. In some instances, photographs are of equipment prototypes. Software screen images are representative, and in some cases, may not match a customer's installed software exactly. Therefore, before using this document, consult with your NCR representative or NCR office for information that is applicable and current.

To maintain the quality of our publications, we need your comments on the accuracy, clarity, organization, and value of this book. Please use the link below to send your comments.

Email: FD230036@ncr.com

Copyright © 2019
By NCR Corporation
864 Spring St. NW
Atlanta, GA 30308
United States
All Rights Reserved

Revision Record

Issue	Date	Remarks
A	Sep 2019	First Issue

Turntable

This publication provides procedures for counter top installation of the NCR SelfServ™ 90 (7709) Kiosk using a Turntable kit.

Kit Contents

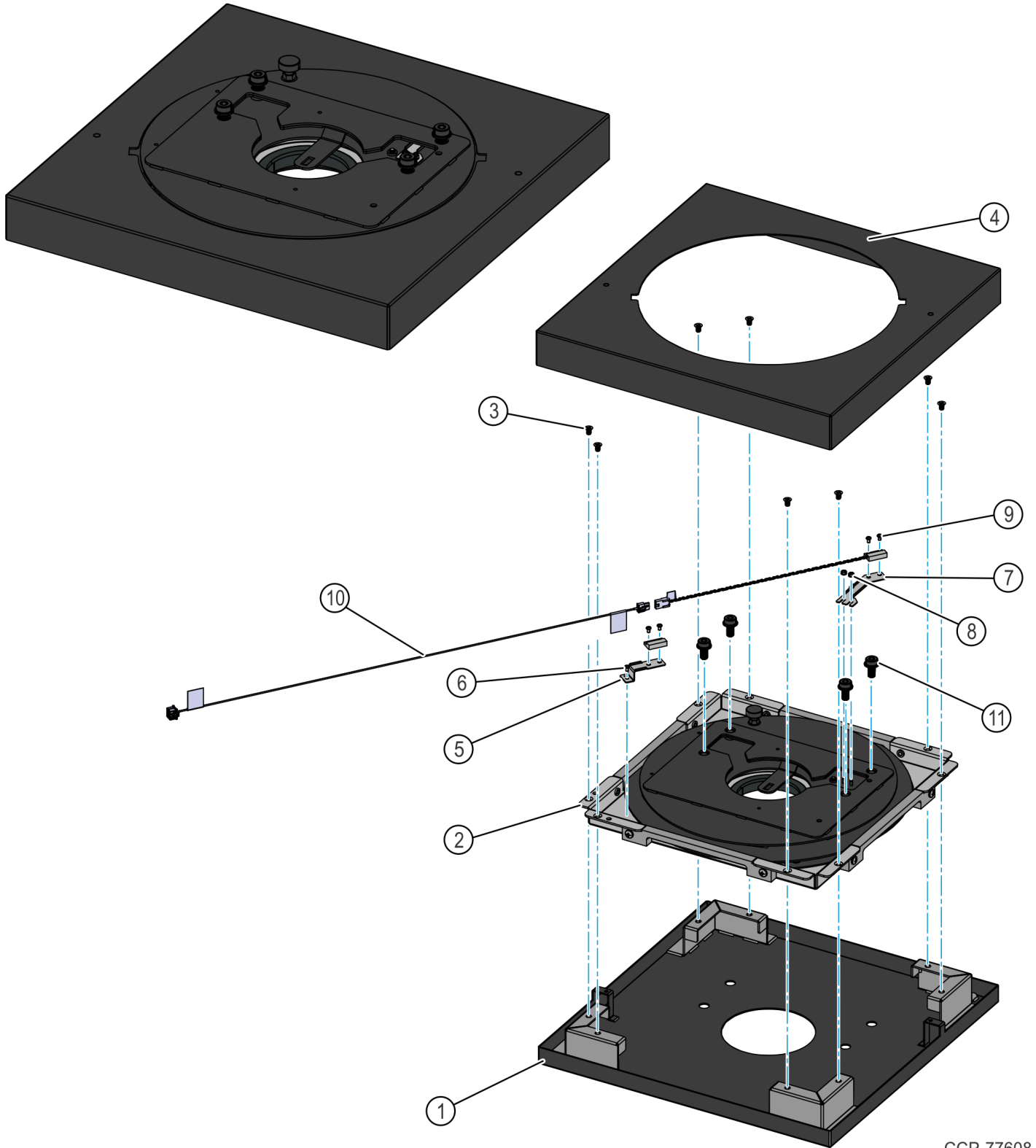

	Part Number	Item	Description
	497-0524398		Kit - Turntable R1.3
	497-0524341	1	Base Cover, 7709 R1.3
	497-0525812	2	Assembly - SS90 Turn Table
	006-8624481	3	Screw - M5X8, Flat Head, Phillips, Machine Screw (8 pcs)
	795-0274406	4	Cover, Top Plate, 7709 R1.3 (Powder Coat Black, blk 7)
	497-0524343	5	Bracket, Sensor, Stationary, 7709 R1.3
	006-8624173	6	Screw - M3 X 0.5 X 5 mm Phillips Pan Head (5 pcs)
	497-0524344	7	Bracket, Sensor, Rotating, 7709 R1.3
	006-8611952	8	Nut, Hex, M3 x 0.5, Keps, Zn (2 pcs)
	497-0508330	9	Convertible Mode Sensor
	497-0524311	10	Cable, Adapter, Convertible Mode Sensor, 590 mm
	006-8624161	11	Screw - M8 X 16, Socket Cap, Flanged, Serrated (4 pcs)
*	497-0423108	12	Instructions - Kit (Reference Sheet)
*	006-8615143	13	Cable Tie, 142mm x 3.6mm



Note: Items marked with an asterisk (*) are not shown in the image.

Installation Procedures

Installing the Turntable kit involves the following procedures:

1. Prepare the installation location. For more information, refer to [Preparing the Installation Location](#) on the facing page.
2. Disassemble the Turntable kit. For more information, refer to [Disassembling the Turntable Kit](#) on page 8.
3. Mount the base onto the table. For more information, refer to [Mounting the Base onto the Table](#) on page 10.
4. Re-assemble the Turntable kit. For more information, refer to [Reassembling the Turntable Kit](#) on page 11.
5. Mount the NCR 7709 onto the Turntable. For more information, refer to [Mounting the NCR 7709 onto the Turntable](#) on page 13.
6. Route and connect the Sensor Cable. For more information, refer to [Routing and Connecting the Sensor Cable](#) on page 16.

Preparing the Installation Location

Before installing the NCR 7709 kiosk and the Turntable kit, mounting holes must be drilled on the counter top. The counter top may either be with or without a cutout.

The counter top construction determines the type of anchors to use: bolts and nuts, lag bolts, screws, and so forth. The anchors are not shipped with the kiosk and must be obtained locally.

There are four Mounting Holes in the bottom of the kiosk cabinet. The diameter of these holes is **9.0 mm** (0.35 in.). One hole is round and the other three are keyholes.

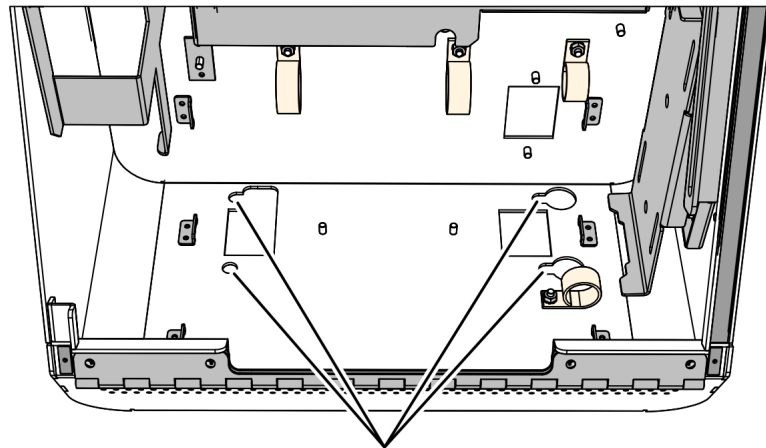

Mounting Holes

CCP-77600



Note: Make sure that the kiosk is not set too far back from the front edge of the counter, preventing the front of the kiosk from fully opening when maintenance and service are required. The bottom front of the kiosk cannot be any farther than **45 mm** (1¾ in.) from the front edge of the counter top.

Table without a cutout

To prepare a table without a cutout, follow this step:

- Using the following dimensions, mark the bolt holes on the table and drill the four holes.

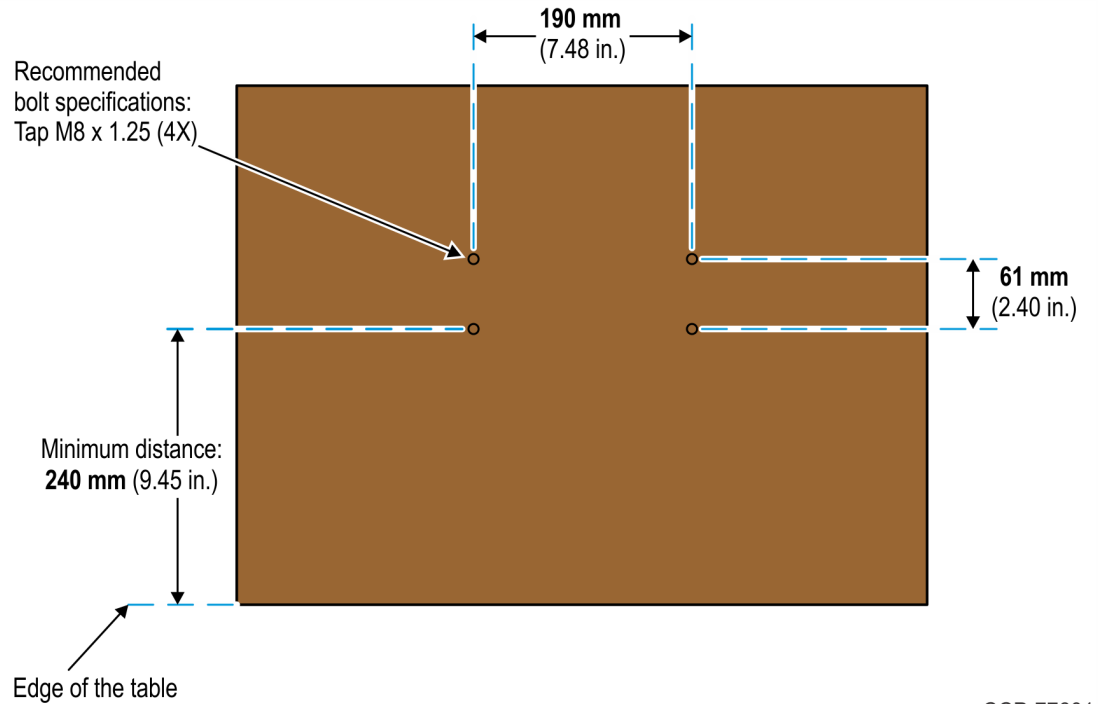

CCP-77601

Table with a cutout

To prepare a table with a cutout, follow this step:

- Using the following dimensions, mark the bolt holes on the table cutout and drill the four holes.

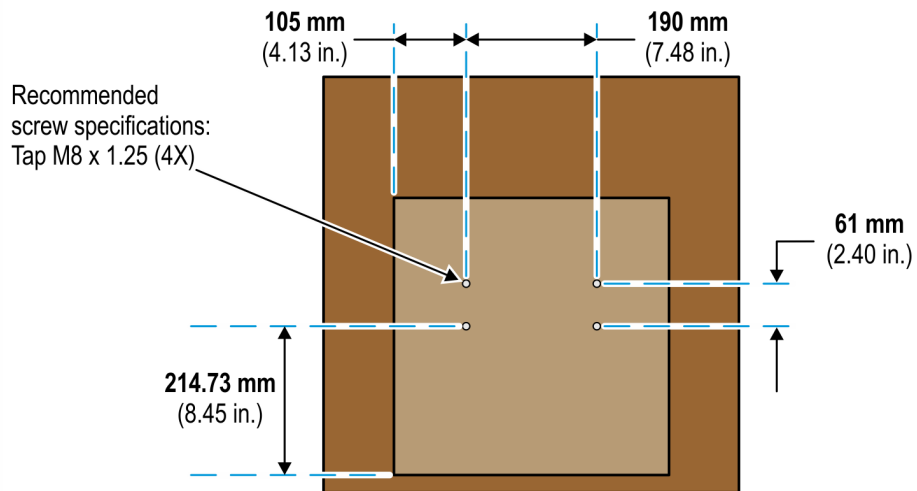
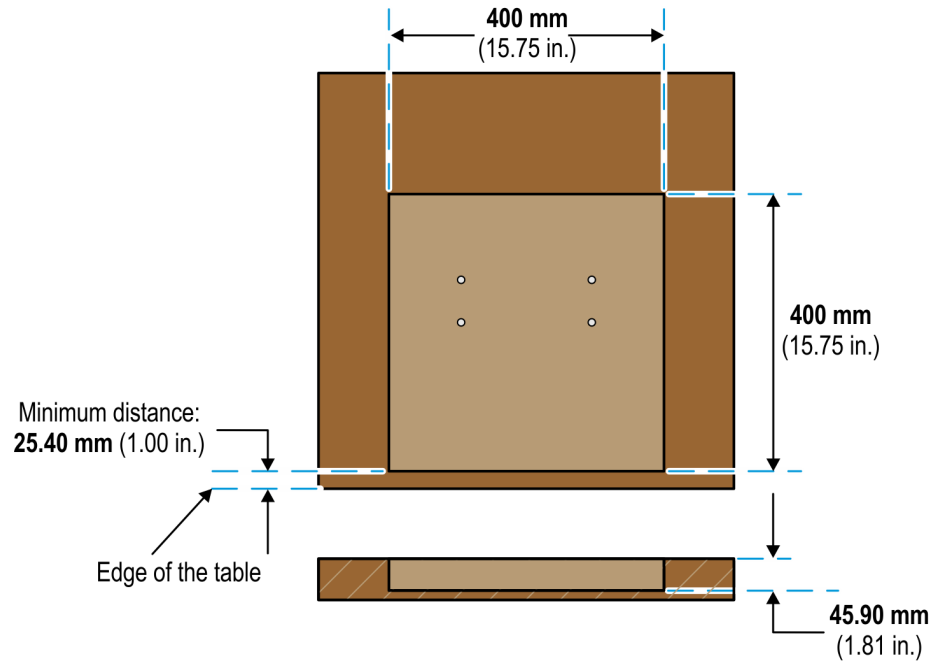

Disassembling the Turntable Kit

The Turntable kit cannot be directly installed on the table without disassembling the kit.

To disassemble the Turntable kit, follow these steps:

1. Using a screwdriver or any available tool as a lever, remove the top cover of the Turntable kit, as shown in the following image.

 **Caution:** Be careful not to damage any part of the kit.

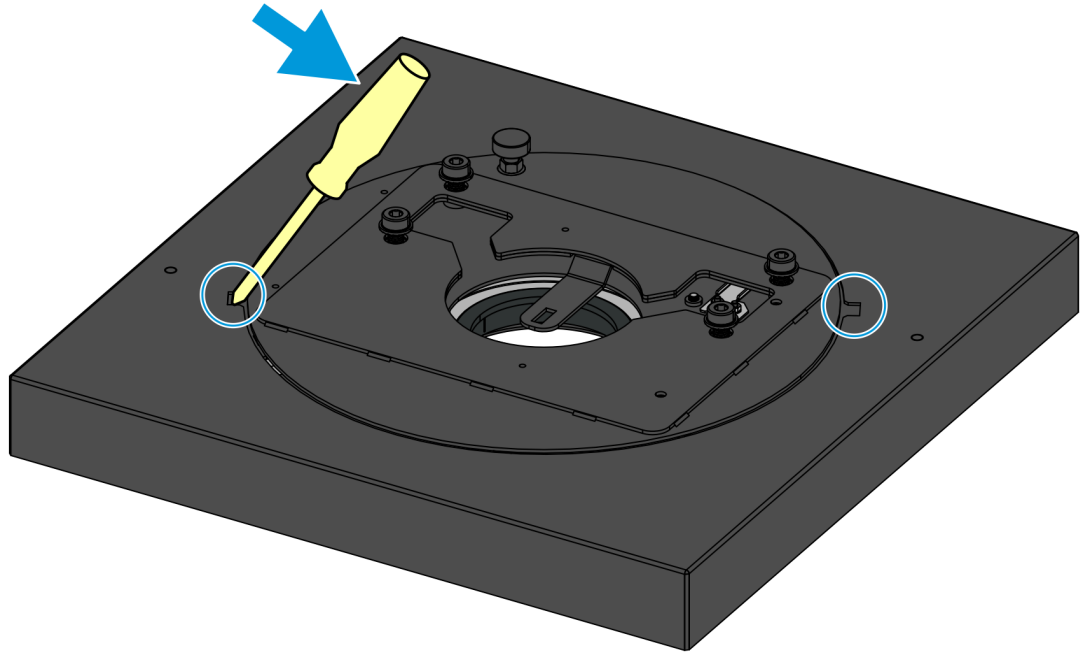

CCP-77610

2. Remove the eight flat head screws that secure the Turntable assembly to its base, and then remove the Turntable assembly.

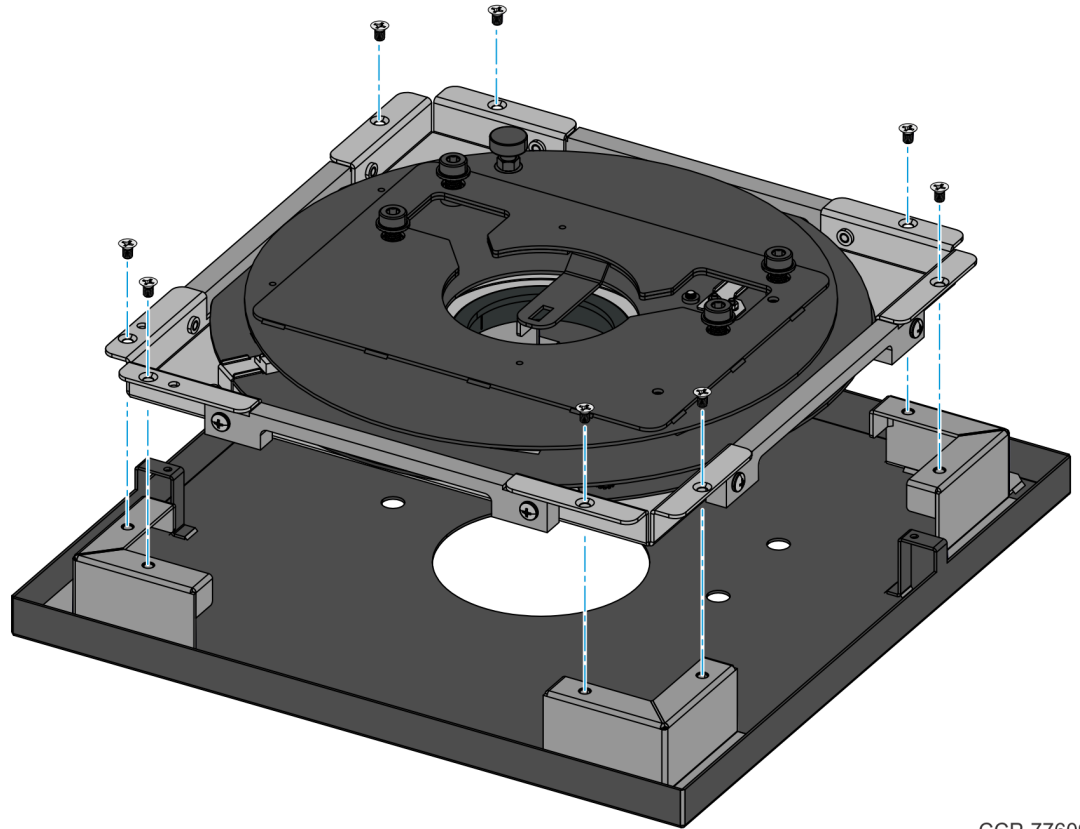

CCP-77609

Mounting the Base onto the Table

To mount the Turntable base on the table, follow these steps:

1. Position the base on the table top or into the table cutout.



Note: Ensure that the four holes on the base are properly aligned with the four holes on the table.

2. Using four screws, secure the base on the table.



Note: It is recommended to use four M8X1.25 serrated flange head screws.

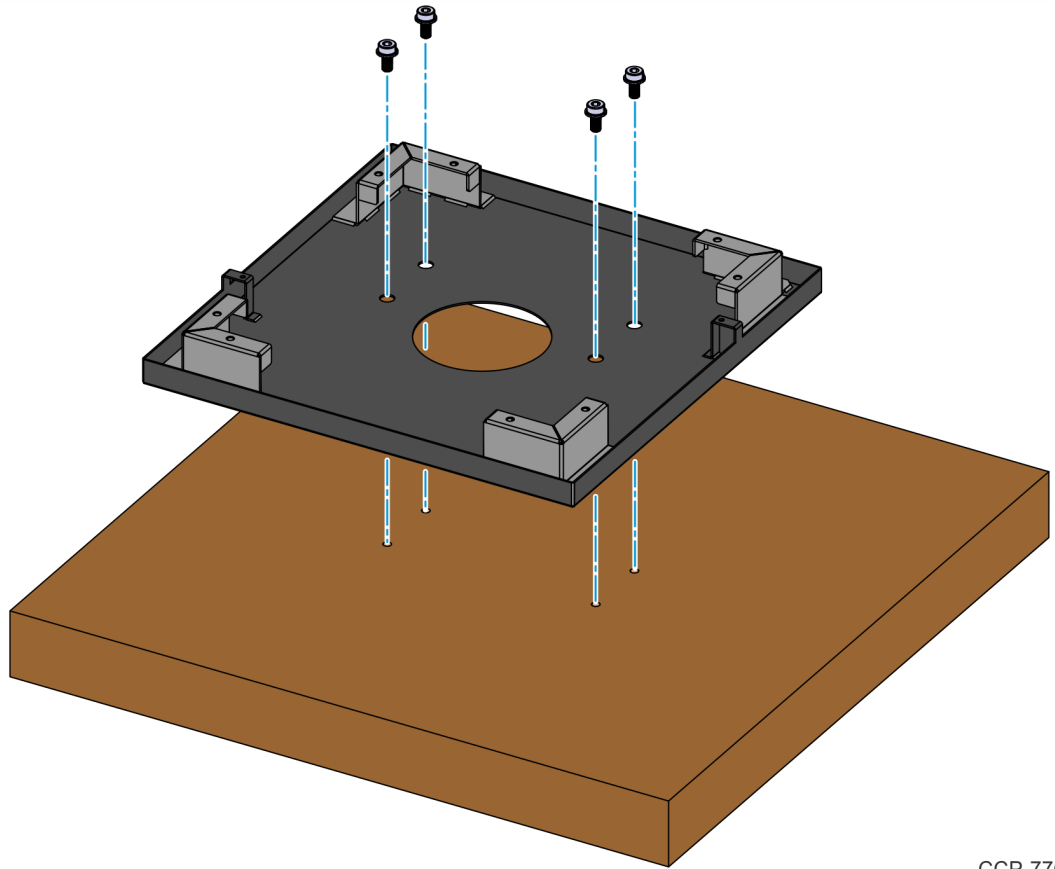

Reassembling the Turntable Kit

To reassemble the Turntable kit, follow these steps:

1. Mount the Turntable assembly onto the base and secure the assembly using the eight screws.



Note: Ensure that the eight holes on the Turntable assembly are properly aligned with the eight holes on the base.

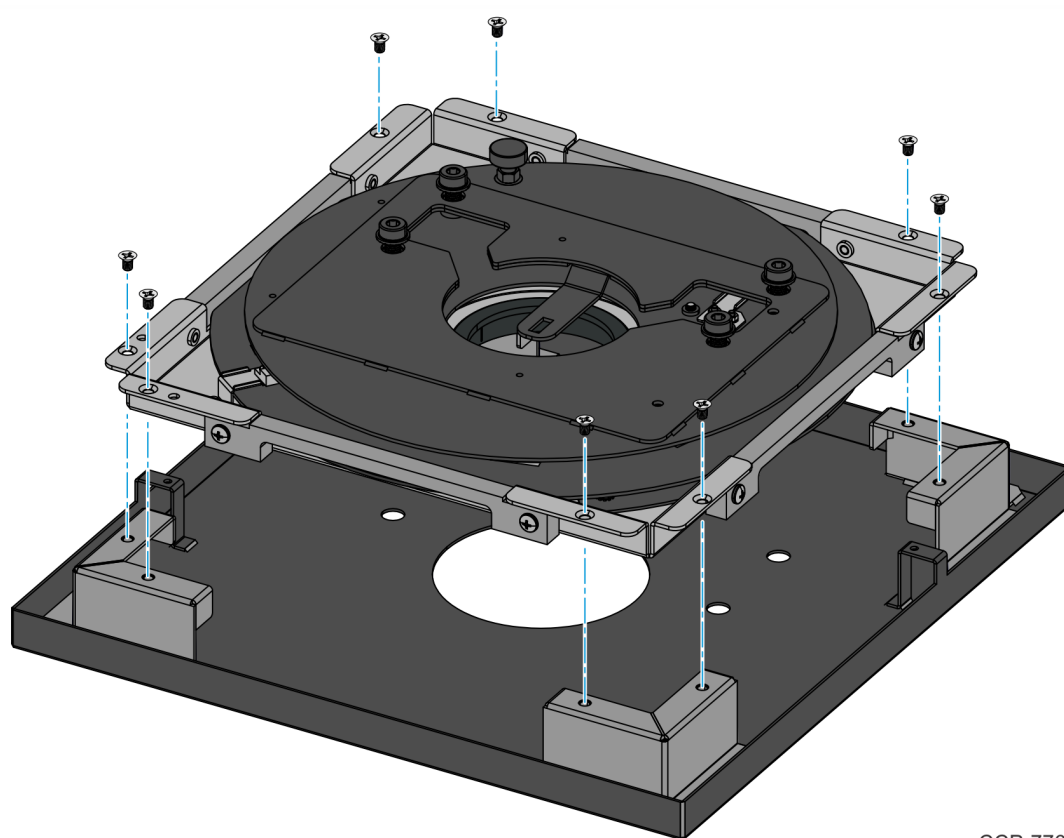

CCP-77609

2. Mount the top cover onto the Turntable assembly.

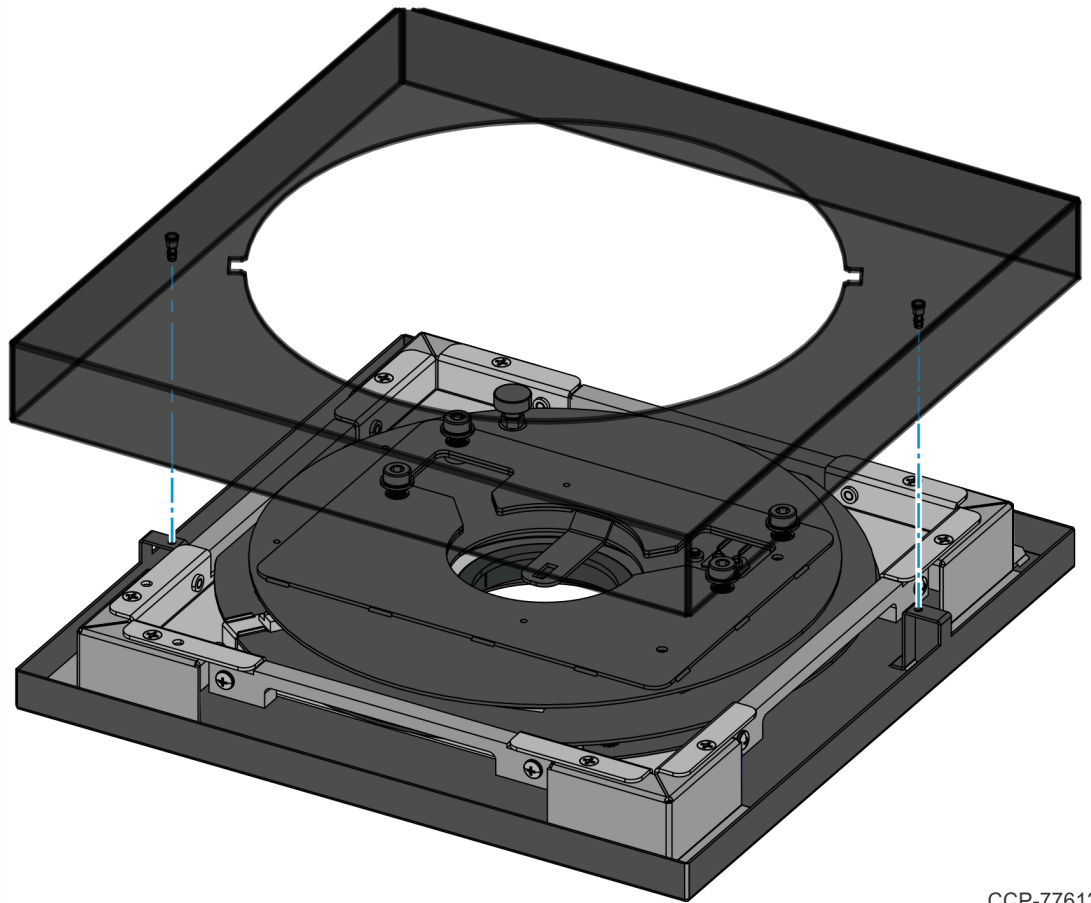

CCP-77612

- a. Align the two mushroom studs on the bottom of the top cover with the two slots on the base.
- b. Push the top cover down to lock it in place.

Mounting the NCR 7709 onto the Turntable

To mount the NCR 7709 onto the Turntable, follow these steps:

1. Remove the serrated flange head screw shown in the following image.

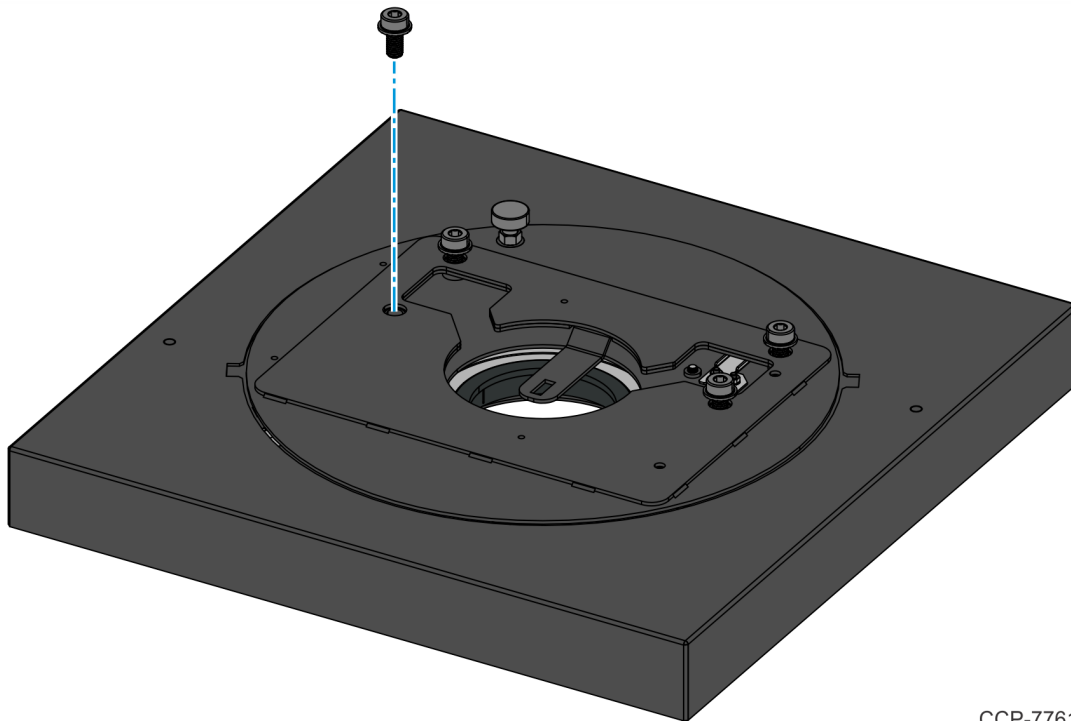

CCP-77613

2. Loosen the three remaining serrated flange head screws.

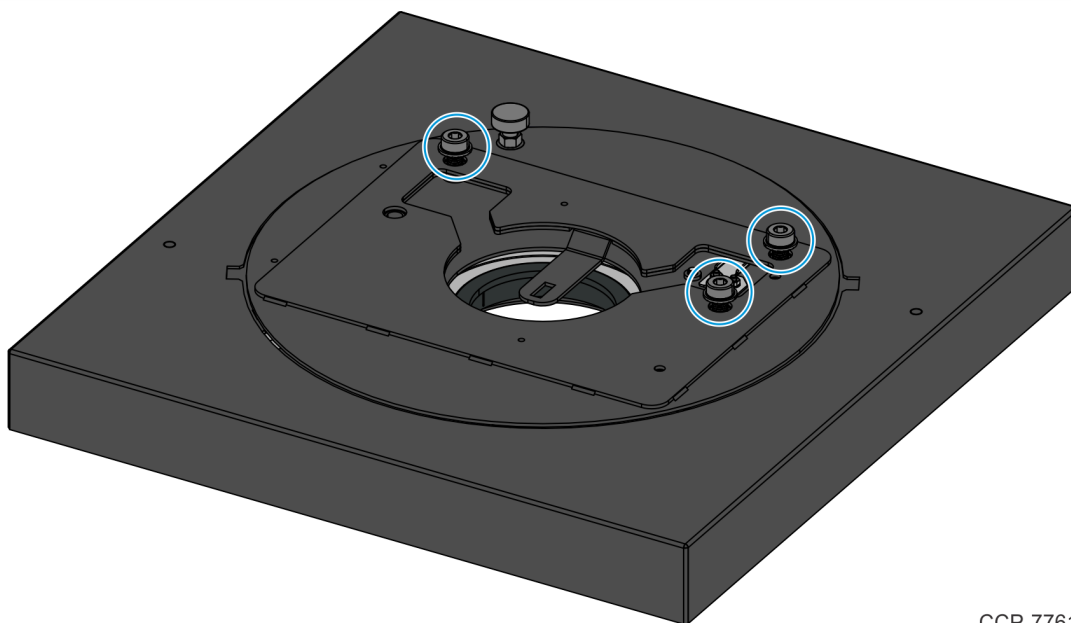

CCP-77614

3. Position the NCR 7709 kiosk on top of the Turntable assembly.
 - a. Route the sensor cable through the rectangular cutout on the base of the kiosk.

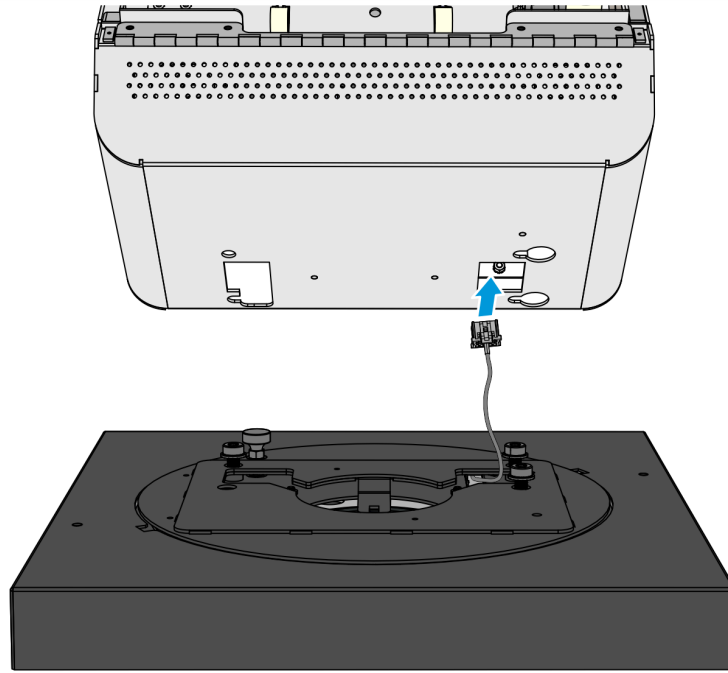

CCP-77615

- b. Align the three mounting holes on the base of the kiosk with the three serrated flange head screws on the Turntable assembly.

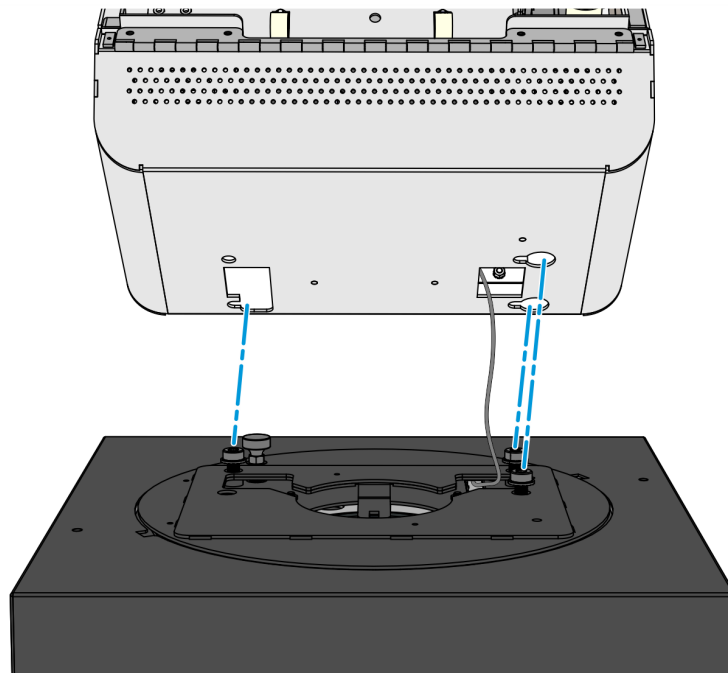

CCP-77616

4. To lock the kiosk in place, push it to the right.

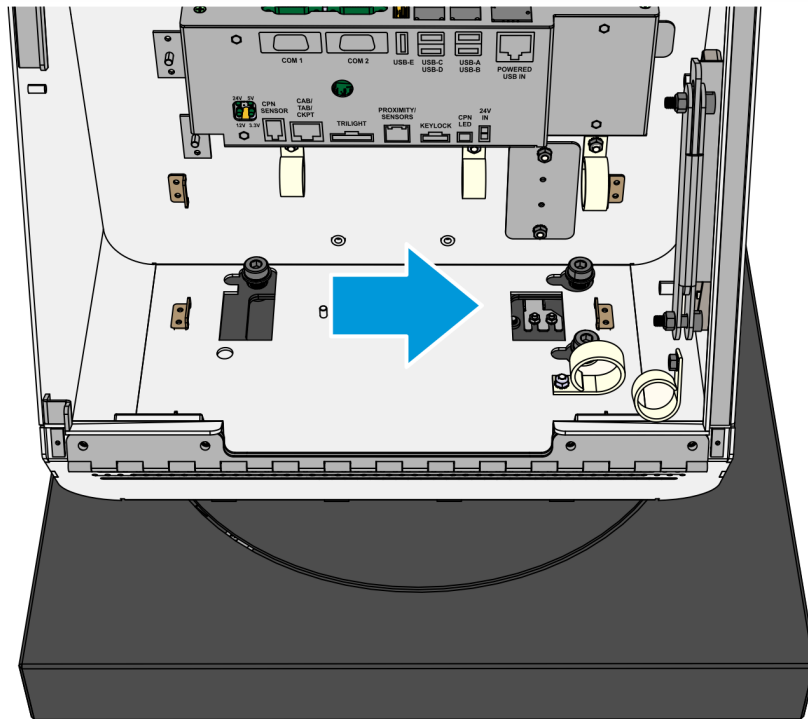

CCP-77617

5. Install the previously removed serrated flange head screw, and then tighten all four screws.

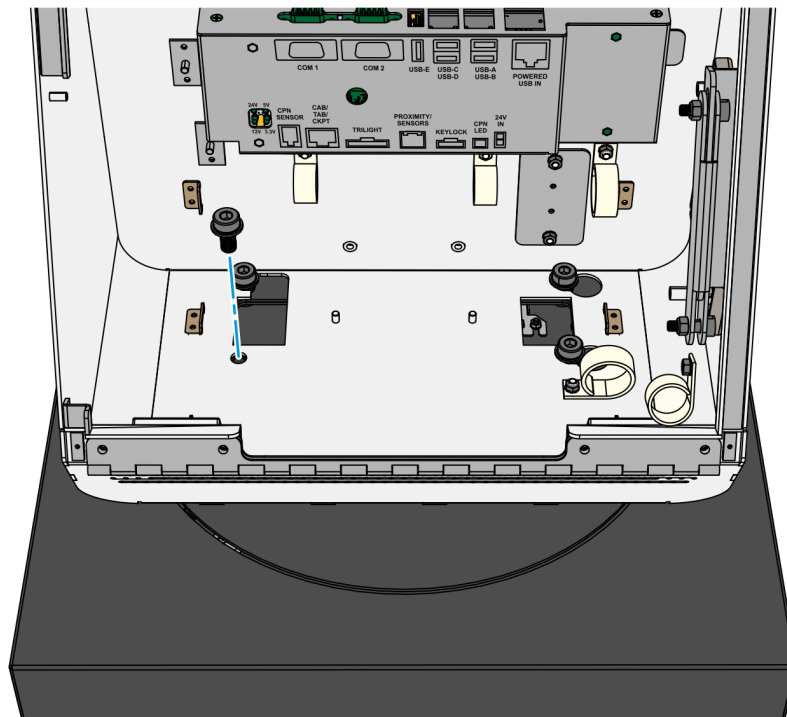

CCP-77618

Routing and Connecting the Sensor Cable

To route and connect the sensor cable, follow this step:

- Route the sensor cable through the P-loop indicated in the following image, and then connect the sensor cable to the **Proximity/Sensors Port**.

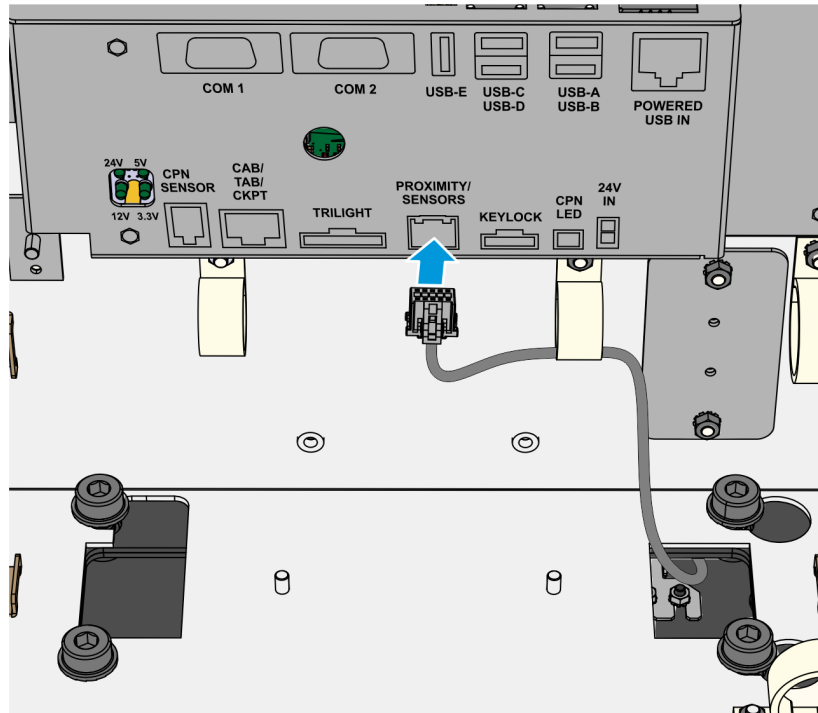

CCP-77619

Using the Turntable Kit

With the Turntable kit installed, the NCR 7709 kiosk can be rotated 180 degrees.

To rotate the kiosk, follow this step:

- Lift the plunger (1) and then rotate the turntable and the kiosk (2).

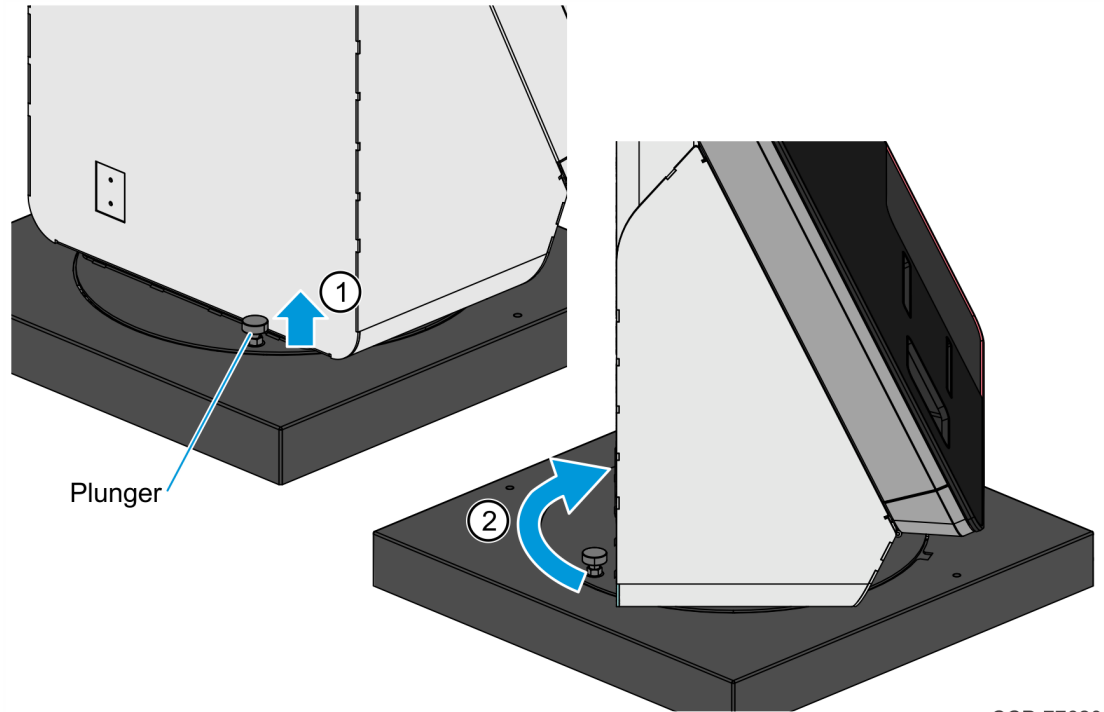

CCP-77620



Note: The plunger automatically locks in place when the rotation reaches 180 degrees.

