



# Kit Instructions

## Japan Goods Holder

---



7371-K461

Issue B

# Copyright and Trademark Information

---

The product described in this document is a licensed product of NCR Voyix Corporation.

NCR Voyix FastLane SelfServ™ Checkout is a trademark of NCR Voyix Corporation in the United States and/or other countries. Other product names mentioned in this publication may be trademarks or registered trademarks of their respective companies and are hereby acknowledged.

Where creation of derivative works, modifications or copies of this NCR Voyix copyrighted documentation is permitted under the terms and conditions of an agreement you have with NCR Voyix, NCR Voyix's copyright notice must be included.

Disclaimer:

It is the policy of NCR Voyix Corporation to improve products as technology, components, software and firmware become available. NCR Voyix therefore reserves the right to change specifications without prior notice.

All features, functions and operations described herein may not be marketed by NCR Voyix in all parts of the world. In some instances, photographs are of equipment prototypes.

Therefore, before using this document, consult with your NCR Voyix representative or NCR Voyix office for information that is applicable and current.

© 2018 - 2026

By NCR Voyix Corporation

Atlanta, Georgia, USA

All Rights Reserved

# Table of Contents

---

<b>Japan Bag Rack with Arm Flap</b> .....	<b>5</b>
Kit Contents .....	5
Installation Procedure .....	6

# Revision Record

---

Issue	Date	Remarks
A	Jun 2018	First issue.
B	Jan 2026	Updated IP PDF template to NCR Voyix Branding.

# Japan Bag Rack with Arm Flap

This publication provides procedures for installing a Japan Bag Rack with Arm Flap on the Scale Tray of an NCR Voyix SelfServ™ Checkout (7707) unit.

## Kit Contents

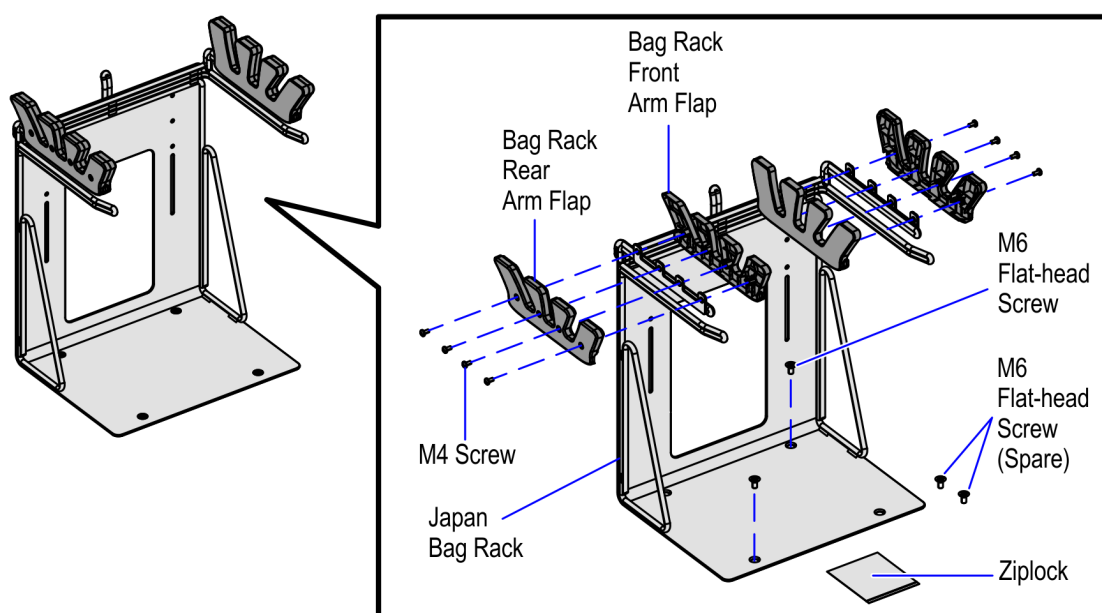

CCP-74442

Part Number	Description
497-0510936	7707-K461 Japan Bag Rack with Arm Flap
497-0510866	Japan Bag Rack
497-0510803	Bag Rack Front Arm Flap
497-0510804	Bag Rack Rear Arm Flap
006-8615964	M4 Screw (8 pcs)
007-7022141	M6 Flat-head Screws (4 pcs)

\* Items marked with an asterisk are not called out on the image.

# Installation Procedure

To install the Japan Bag Rack with Arm Flap on the Scale Tray of an R6-Japan unit, follow these steps:

1. Remove plug holes from the Scale Tray.

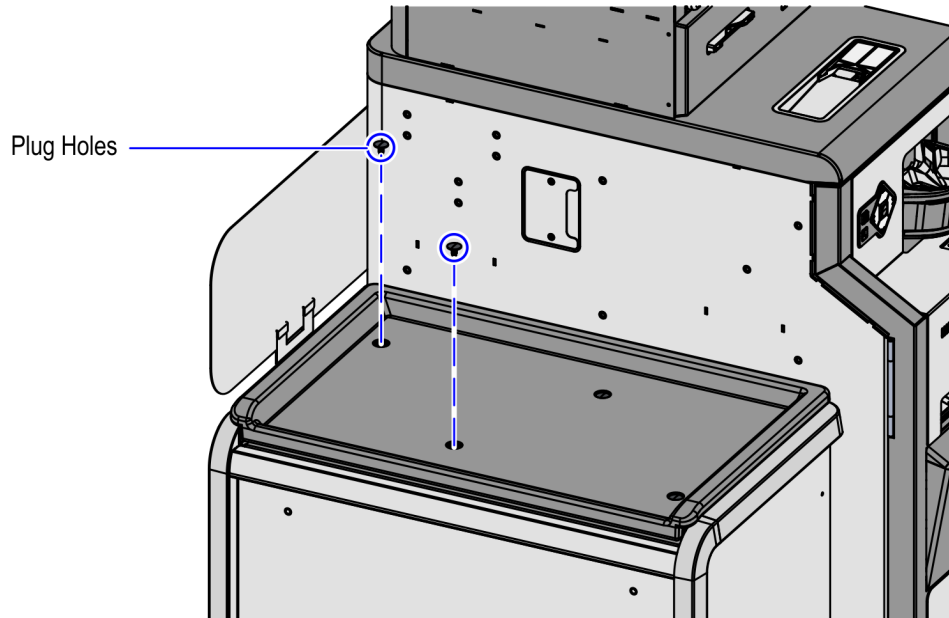

CCP-74449

2. Align the Japan Bag Rack with the two screw holes on the Scale Tray.

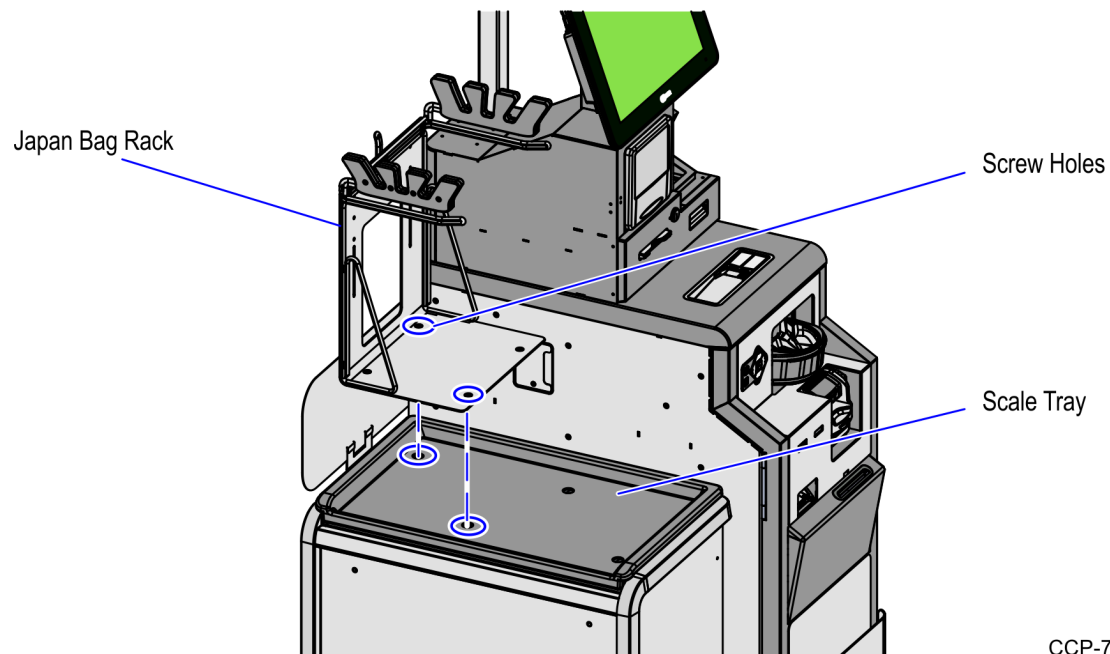

CCP-74452

3. Secure the Japan Bag Rack to the Scale Tray using two M6 Flat-head screws.

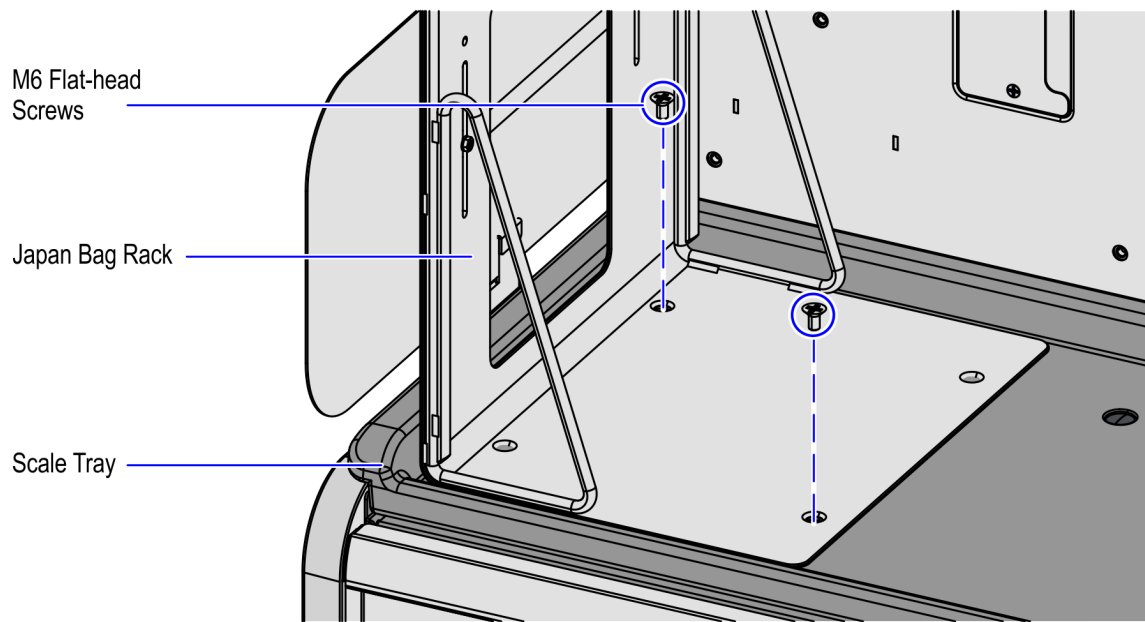

CCP-74451