

7409-K922

Slim Pedestal Wood Laminate

Kit Instructions



Issue A

Revision Record

Issue	Date	Remarks
A	Nov 2012	First Issue

This kit provides a decorative laminate for the front of the 7409-K921 Slim Pedestal.

Installation Procedures

The Pedestal Front Panel has elongated holes for the screw mounts so the panel can be *inset* to accommodate the laminate thickness. When there is no laminate the panel can be positioned flush with the pedestal.

The default position for the panel is *inset*, but if necessary loosen the screws (6) on the Pedestal Front Panel and adjust the panel position.

Note: The Pedestal Front Panel is shown exploded from the Pedestal below to show the elongated screw hole locations (6). You may need to remove some of the internal kiosk components to gain access the screws.

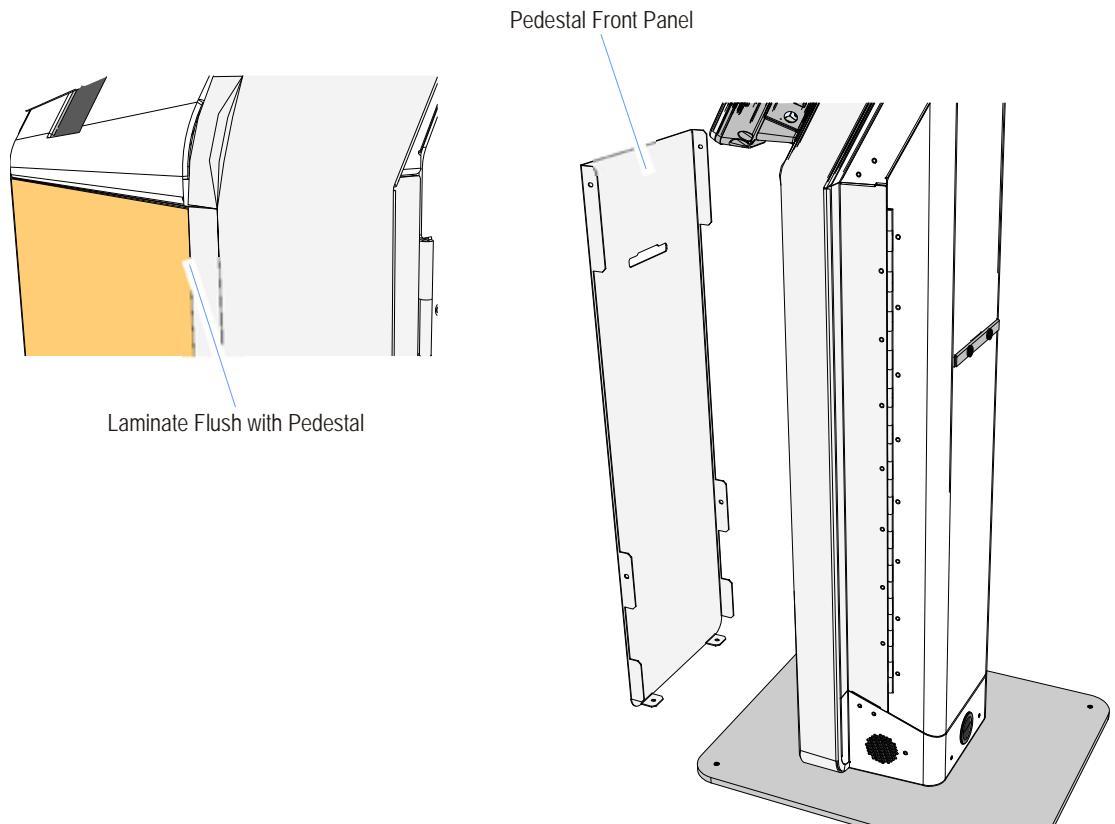

1. Remove the paper backing from the double-sided tape on the back side of the laminate.
2. Position the laminate in the bottom edge of the panel inset.
3. Carefully pivot the laminate into position, making sure the opening in the laminate aligns with the Paper Chute.
4. Firmly press on the laminate over where the adhesive strips are located.

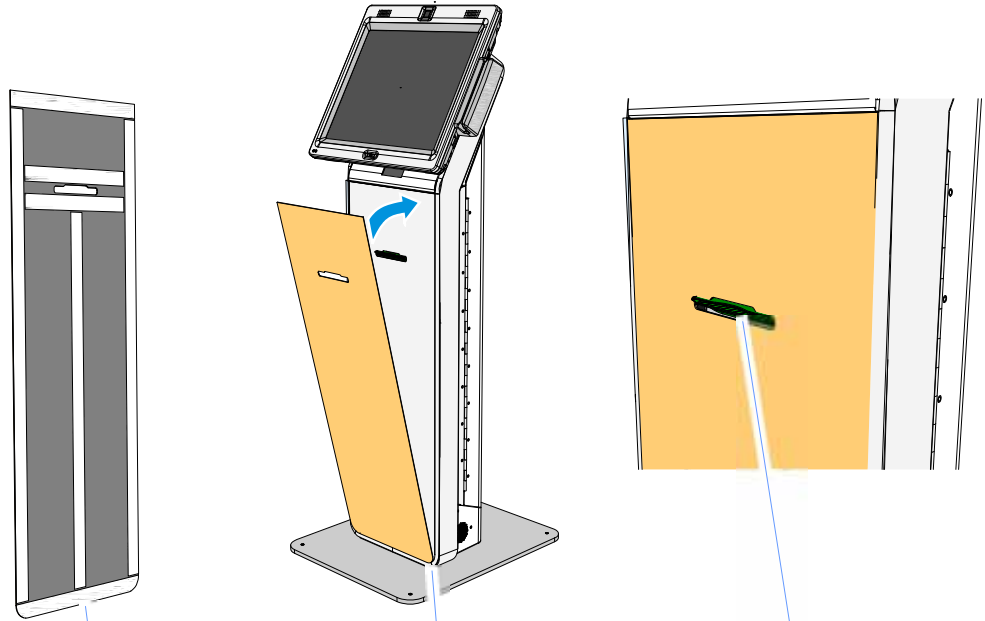

Remove the paper backing from the Double-Sided Adhesive

1

Position the bottom edge of the laminate in the bottom edge of the panel inset.

2

Make sure the Paper Chute is aligned with the laminate opening.

3

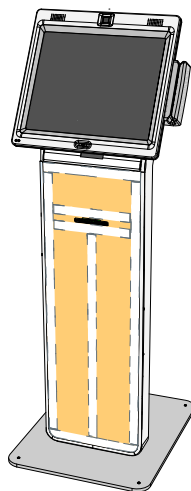

Press firmly on the Laminate over the adhesive strips.

4