

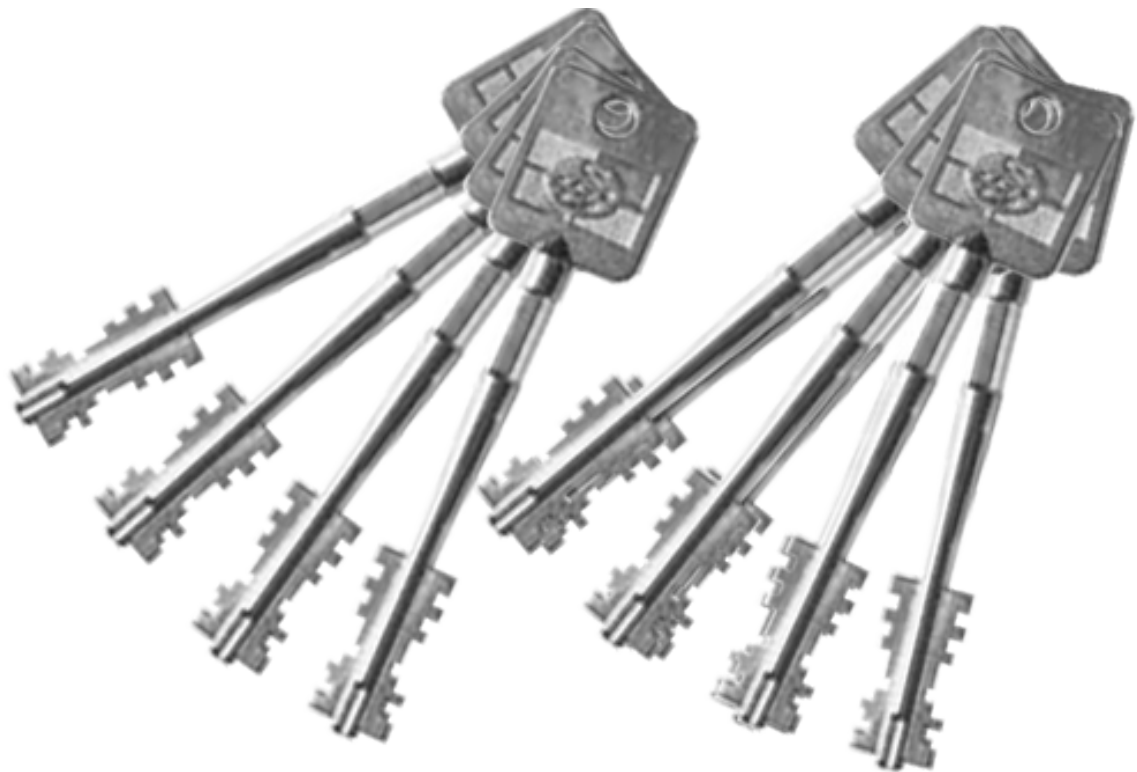

Kit Instructions

Self-Checkout Internal Key (Key Code 10)



7360-K969

Issue A

Copyright and Trademark Information

The product described in this document is a licensed product of NCR Voyix Corporation.

NCR Voyix FastLane SelfServ™ Checkout is a trademark of NCR Voyix Corporation in the United States and/or other countries. Other product names mentioned in this publication may be trademarks or registered trademarks of their respective companies and are hereby acknowledged.

Where creation of derivative works, modifications or copies of this NCR Voyix copyrighted documentation is permitted under the terms and conditions of an agreement you have with NCR Voyix, NCR Voyix's copyright notice must be included.

Disclaimer:

It is the policy of NCR Voyix Corporation to improve products as technology, components, software and firmware become available. NCR Voyix therefore reserves the right to change specifications without prior notice.

All features, functions and operations described herein may not be marketed by NCR Voyix in all parts of the world. In some instances, photographs are of equipment prototypes.

Therefore, before using this document, consult with your NCR Voyix representative or NCR Voyix office for information that is applicable and current.

© 2025

By NCR Voyix Corporation

Atlanta, Georgia, USA

All Rights Reserved

Table of Contents

Self-Checkout Internal Key (Key Code 10) 5

Kit Contents 5

Changing the keys 6

Revision Record

Issue	Date	Remarks
A	May 2025	First issue.

Self-Checkout Internal Key (Key Code 10)

This kit provides instructions in changing the internal keys to the Security Door locks (Sargent and Greenleaf) of the following Self-Checkout units:

- NCR Voyix Self-Checkout (7360) Fixed
- NCR Voyix Self-Checkout (7360) Convertible
- NCR Voyix Self-Checkout (7360) Cash Tender Module (CTM)
- NCR Voyix SCO Full Function (7371) Fixed
- NCR Voyix SCO Full Function (7371) Hybrid

Kit Contents

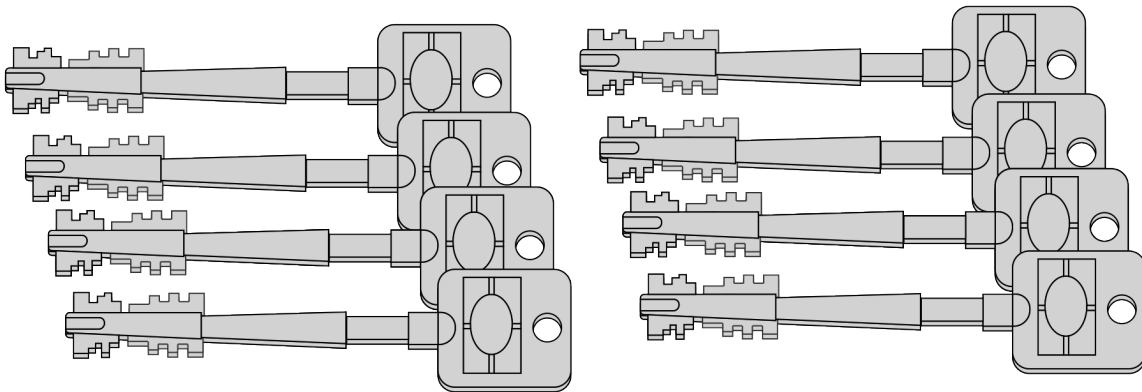

CCP-85672

Part Number	Description
497-0527799	7360-K969 Kit, Internal Key S&G - Key Code 10 (Quantity 8)
006-8627663	Operating Key, Pair, S&G Key Lock, Code 10 (4 pcs)

* Items marked with an asterisk are not called out on the image.

Changing the keys

To change the keys of the Security Door lock (Sargent and Greenleaf), follow these steps:

1. Open the Self-Checkout exterior door using a key.

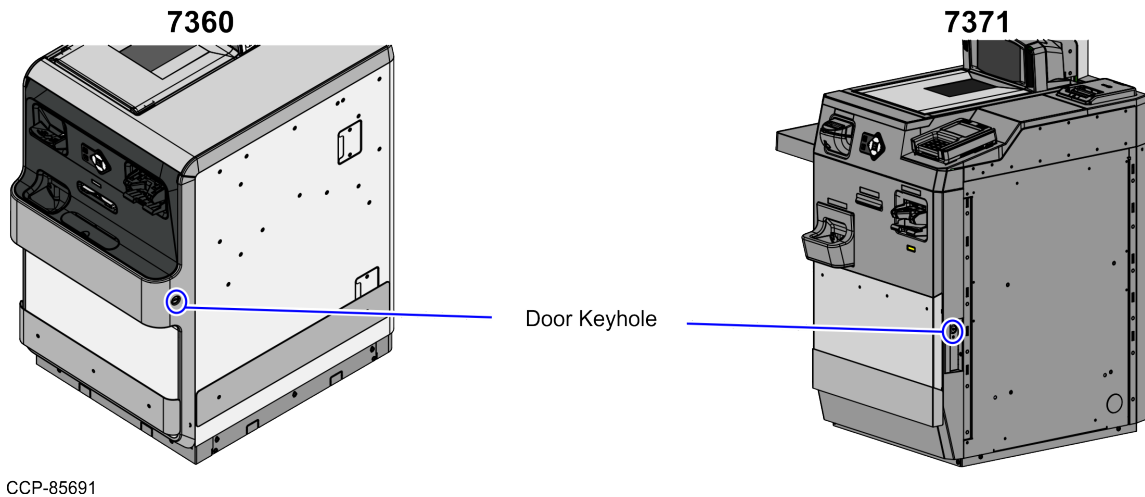

2. Do the following:
 - a. On the Security Door, insert the Setup Key or the current Operating Key through the keyhole.
 - b. Turn the Security Doorknob counterclockwise, and then remove the key to open the Security Door.

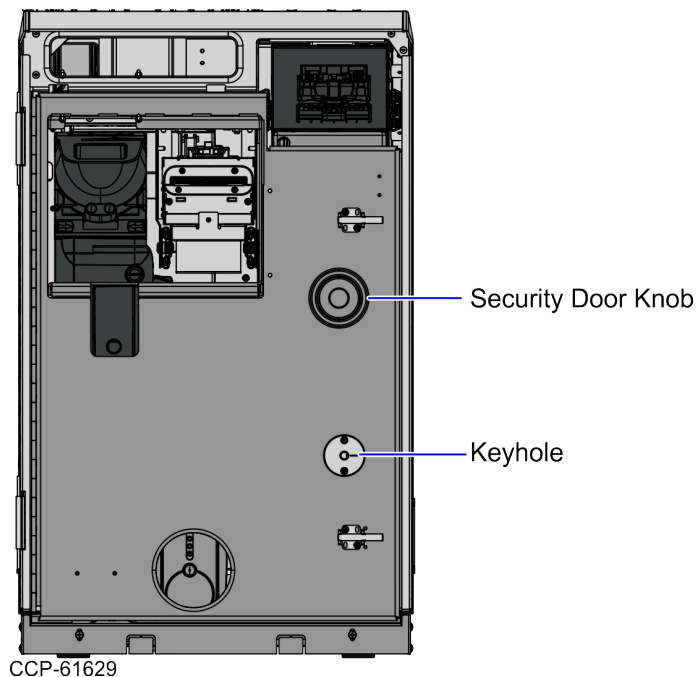

3. Do the following:

- a. Locate the changing button on the back of the Security Door lock.

7360

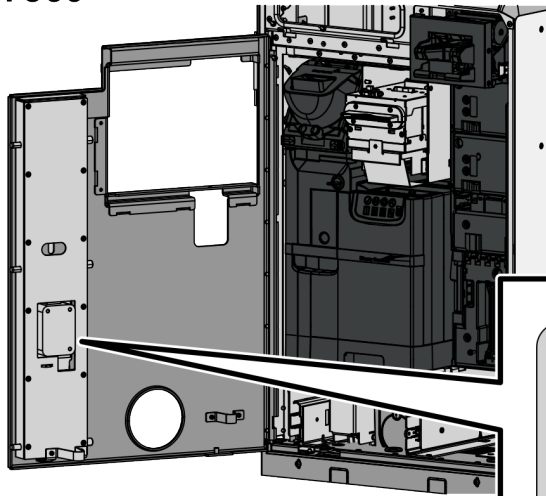

CCP-85668

7371

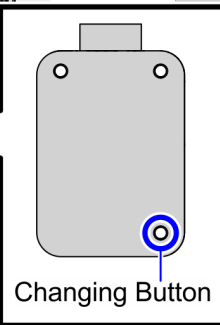
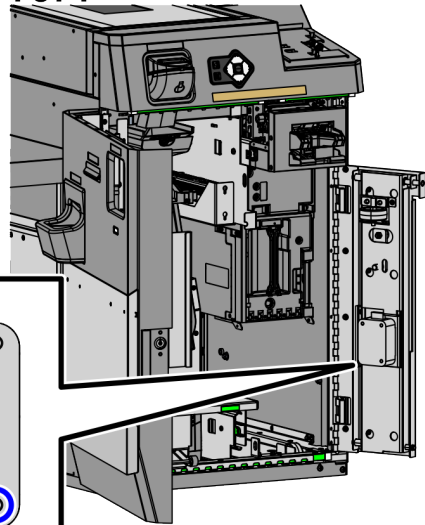

- b. Insert a probe into the changing button hole and keep the changing button pressed.

Note

The probe is not included in the 7360-K960 kit. Use any object that can fit into the changing hole (such as the tip of a ball point pen).

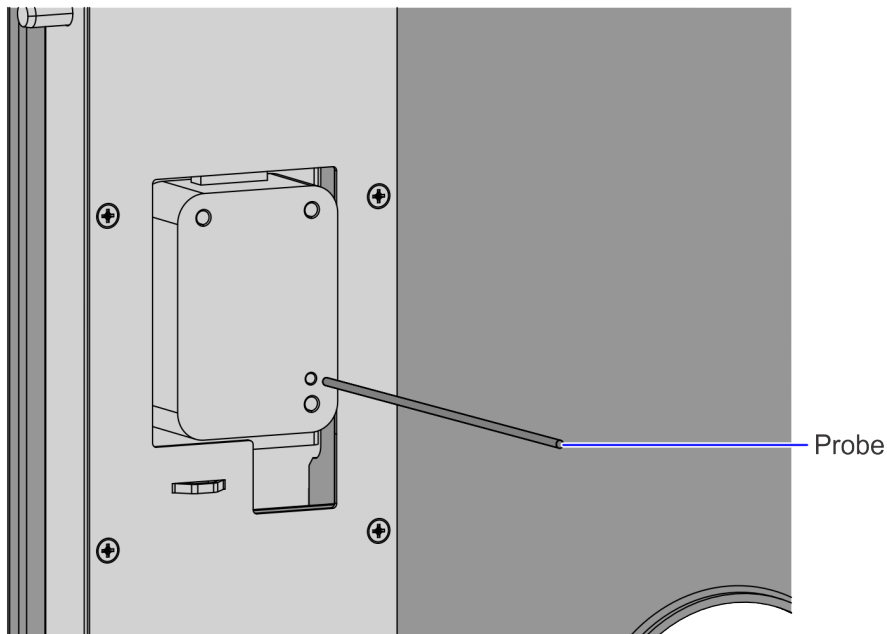

CCP-85669

4. While keeping the changing button pressed, insert the existing key and turn it 180° clockwise until it reaches its stop.

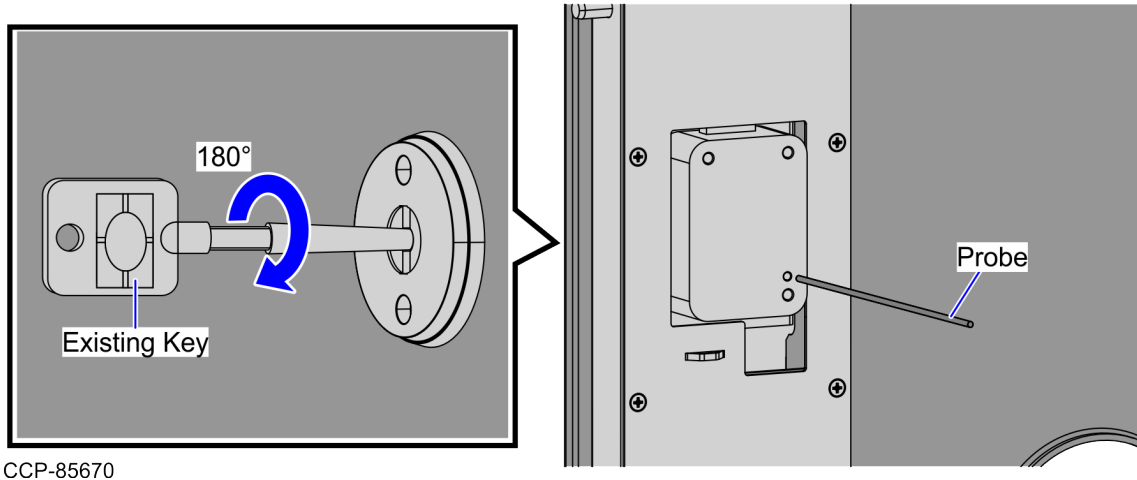

5. Release the changing button and then remove the existing key.
6. Do the following:
 - a. Insert the new key into the keyhole.

Note

Ensure that the new key is fully engaged into the lock.

- b. Turn the new key 180° counter clockwise in a slow and deliberate motion (4-5 seconds) until it reaches its stop.

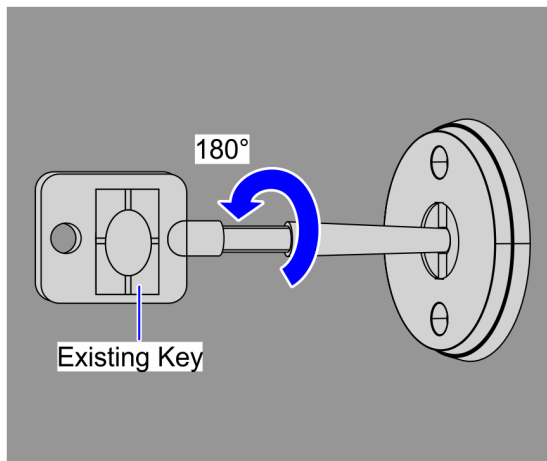

- c. Remove the new key.

7. Test the new key several times by opening the lock. Turn the key clockwise until it stops and then turn the knob.
8. Close the Security Door.
9. Turn the key counterclockwise and then remove it.
10. Close the Core Cabinet Door.