

Kit Instructions

Attendant Checkstand

7360-K710/K711/K713/K728/K729/K731
Issue C



The product described in this document is a licensed product of NCR Corporation.

NCR is a registered trademark of NCR Corporation. NCR FastLane SelfServ™ Checkout is a trademark of NCR Corporation in the United States and/or other countries. Other product names mentioned in this publication may be trademarks or registered trademarks of their respective companies and are hereby acknowledged.

The terms HDMI and HDMI High-Definition Multimedia Interface, and the HDMI Logo are trademarks or registered trademarks of HDMI Licensing LLC in the United States and other countries.

Where creation of derivative works, modifications or copies of this NCR copyrighted documentation is permitted under the terms and conditions of an agreement you have with NCR, NCR's copyright notice must be included.

It is the policy of NCR Corporation (NCR) to improve products as new technology, components, software, and firmware become available. NCR, therefore, reserves the right to change specifications without prior notice.

All features, functions, and operations described herein may not be marketed by NCR in all parts of the world. In some instances, photographs are of equipment prototypes. Therefore, before using this document, consult with your NCR representative or NCR office for information that is applicable and current.

To maintain the quality of our publications, we need your comments on the accuracy, clarity, organization, and value of this book. Please use the link below to send your comments.

EMail: FD230036@ncr.com

Copyright © 2016-2017

By NCR Corporation

Duluth, GA U.S.A.

All Rights Reserved

Revision Record

Issue	Date	Remarks
A	Sep 2016	First issue.
B	Jun 2017	Updated IP PDF template.
C	Oct 2017	Updated Kit image with the following color variants: <ul style="list-style-type: none">• 7360-K713 (Beige)• 7360-K731 (Beige)

Attendant Checkstand

The kit contains a Remote Attendant Station Checkstand for the NCR FastLane SelfServ™ Checkout 7360. The Attendant Checkstand may be Full Size (Standard) or Compact.

Full Size Attendant Checkstand

7360-K710 (White)
7360-K713 (Beige)
7360-K728 (Black)

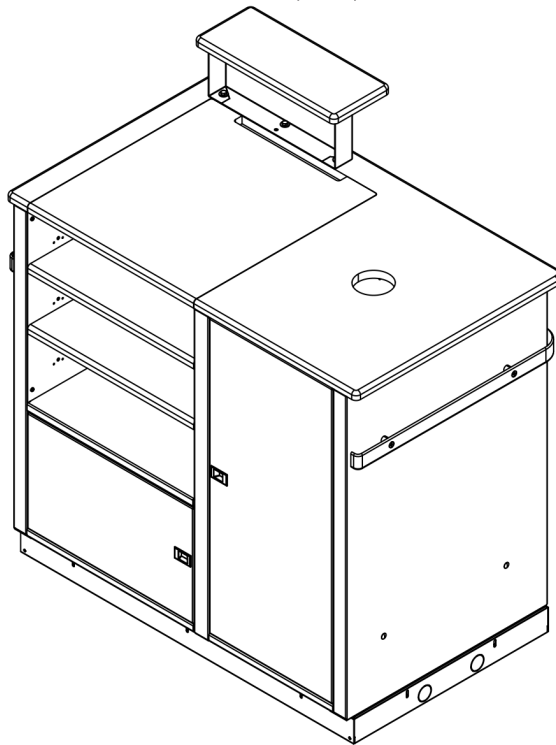

Compact Attendant Checkstand

7360-K711 (White)
7360-K729 (Black)
7360-K731 (Beige)

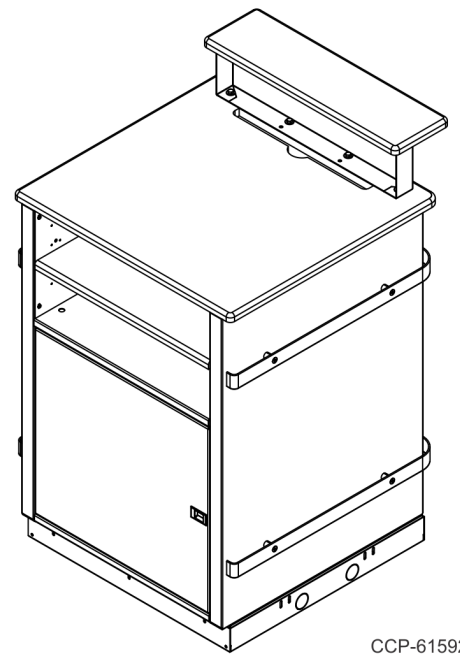

Installation Procedure

1. Move the Attendant Checkstand to the installation location.
2. Level the Attendant Checkstand.
 - a. Drop all of the leveling feet until they touch the floor.

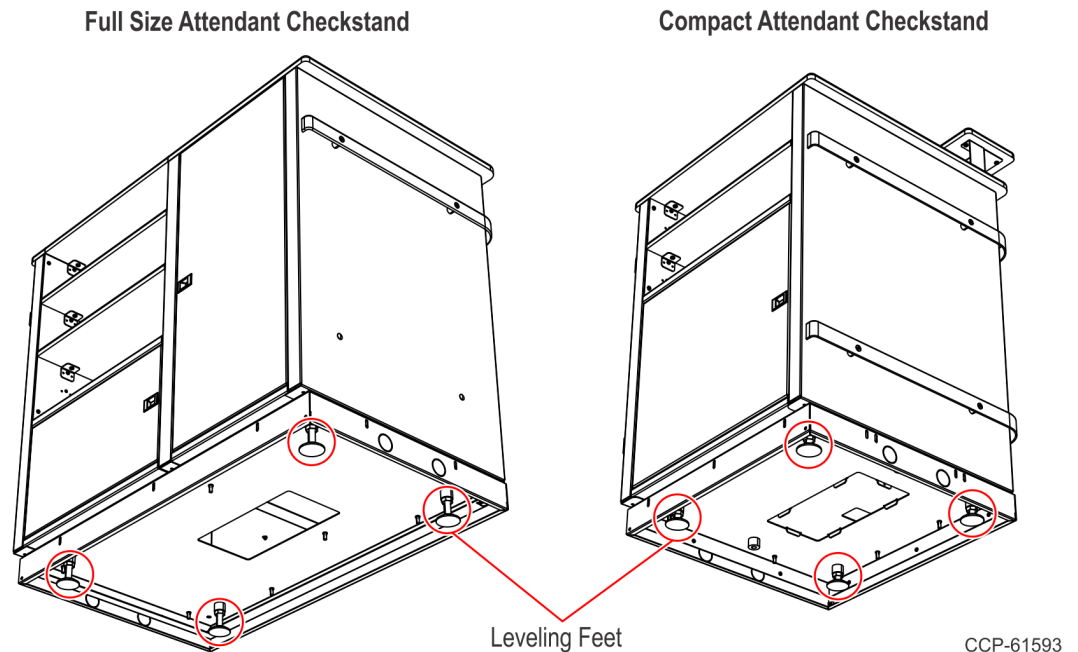

- b. Place a level left-to-right on the Checkstand.
- c. Adjust the leveling feet to obtain a level left-to-right reading.
- d. Turn the level so that it sits front-to-back on the Checkstand. Determine and make any adjustments necessary.
- e. Verify that the unit is still level from left-to-right by placing the level left-to-right on the Checkstand. Make necessary adjustments.
- f. Check to make sure the unit does not wobble or rock by placing hands and exerting moderate pressure on various parts of the Checkstand.
- g. Verify that all leveling feet are solidly on the floor. Sometimes the feet previously adjusted may rise off the floor when other feet are adjusted.

3. Attach the skirt around the bottom of the Attendant Checkstand.



Note: The side skirt panels of the Attendant Checkstand must be installed before the front or back skirt panels. The illustration below uses the Full Size Attendant Checkstand as an example.

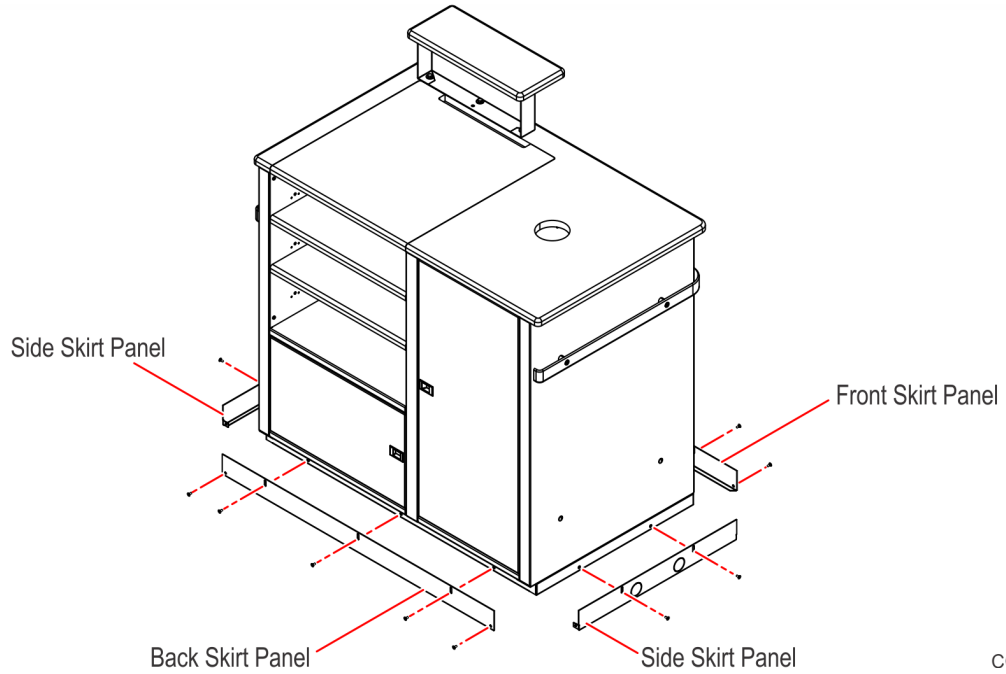

CCP-61594

- a. Attach the side skirt panel to the side skirt bracket by aligning the open slots in the skirt panel with the screw holes in the skirt bracket.
- b. Secure the skirt panel to the bracket using two screws.
- c. Adjust the skirt panel so that it is flush with the floor.
- d. Tighten the screws to secure the skirt in place.
- e. Attach the front or back skirt panel to the skirt bracket by aligning the open slots in the skirt panel with the screw holes in the skirt bracket.
- f. Secure the skirt panel to the bracket using five screws.
- g. Adjust the skirt panel so that it is flush with the floor.
- h. Tighten the screws to secure the skirt in place.



Note: Raising the Checkstand too high during leveling may cause the skirt to not touch the floor when it is installed and adjusted. If the skirt does not touch the floor, debris may accumulate under the unit.