

# Kit Instructions

7350 Lower Bumper Kits

7350-K600/K601/K602  
Issue A



---

The product described in this document is a licensed product of NCR Corporation.

NCR is a registered trademark of NCR Corporation. NCR SelfServ™ Checkout is a trademark of NCR Corporation in the United States and/or other countries. Other product names mentioned in this publication may be trademarks or registered trademarks of their respective companies and are hereby acknowledged.

The terms HDMI and HDMI High-Definition Multimedia Interface, and the HDMI Logo are trademarks or registered trademarks of HDMI Licensing LLC in the United States and other countries.

Where creation of derivative works, modifications or copies of this NCR copyrighted documentation is permitted under the terms and conditions of an agreement you have with NCR, NCR's copyright notice must be included.

It is the policy of NCR Corporation (NCR) to improve products as new technology, components, software, and firmware become available. NCR, therefore, reserves the right to change specifications without prior notice.

All features, functions, and operations described herein may not be marketed by NCR in all parts of the world. In some instances, photographs are of equipment prototypes. Therefore, before using this document, consult with your NCR representative or NCR office for information that is applicable and current.

To maintain the quality of our publications, we need your comments on the accuracy, clarity, organization, and value of this book. Please use the link below to send your comments.

*EMail:* [FD230036@ncr.com](mailto:FD230036@ncr.com)

Copyright © 2018  
By NCR Corporation  
Duluth, GA U.S.A.  
All Rights Reserved

### Revision Record

Issue	Date	Remarks
A	Feb 2018	First issue.

---

# Lower Bumper Kits

---

This publication provides procedures for installing Lower Bumpers on the Core Cabinet, Core Door, and Bagwell module in an NCR SelfServ™ Checkout (7350) unit.

## Kit Contents

Depending on the existing configuration, refer to any of the following kits:

- [7350-K600 Lower Bumper Kits 1-Bag Unit](#) on the next page.
- [7350-K601 Lower Bumper Kits 2-Bag Unit](#) on page 3.
- [7350-K602 Lower Bumper Kits 3-Bag Unit](#) on page 4.

## 7350-K600 Lower Bumper Kits 1-Bag Unit

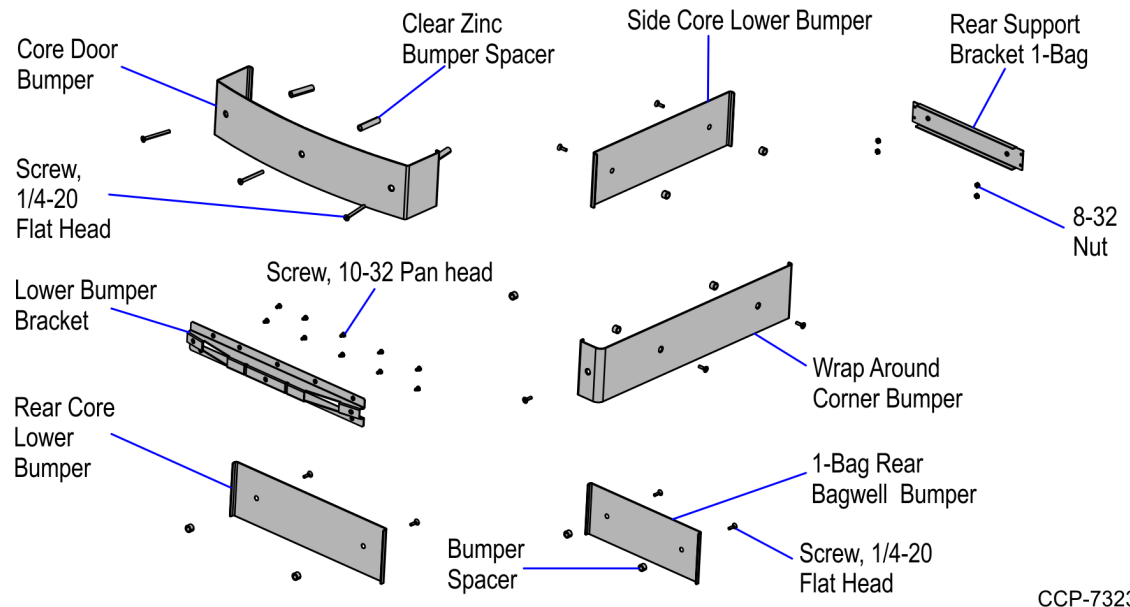

CCP-73235

Part Number	Description
497-0521061	Lower Bumper Kits 1-Bag
497-0518275	Core Door Bumper
497-0518268	Clear Zinc Bumper Spacer (3pcs)
006-8613205	Screw, 1/4-20 Flat Head (3pcs)
497-0470147	Lower Bumper Bracket
006-8613179	Screw, 10-32 Pan Head (10pcs)
497-0518276	Rear Core Lower Bumper Side Core Lower Bumper
497-0518277	Wrap Around Corner Bumper
497-0518274	1-Bag Rear Bagwell Bumper
497-0457054	Bumper Spacer (9 pcs)
006-8612492	Screw, 1/4-20 Flat Head (9pcs)
497-0464172	Rear Support Bracket 1-Bag
006-8611143	8-32 Nut (4pcs)

## 7350-K601 Lower Bumper Kits 2-Bag Unit

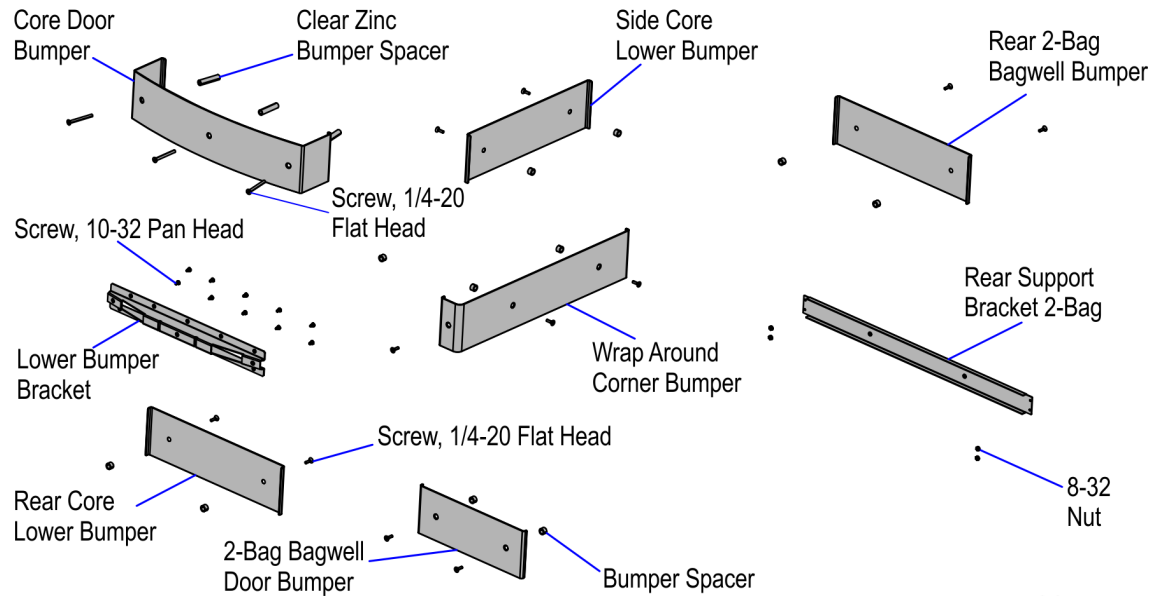

Part Number	Description
497-0521062	Lower Bumper Kits 2-Bag
497-0518275	Core Door Bumper
497-0518268	Clear Zinc Bumper Spacer (3pcs)
006-8613205	Screw, 1/4-20 Flat Head (3pcs)
497-0470147	Lower Bumper Bracket
006-8613179	Screw, 10-32 Pan head (10pcs)
497-0518276	Rear Core Lower Bumper Side Core Lower Bumper Rear 2-Bag Bagwell Bumper
497-0518277	Wrap Around Corner Bumper
497-0518274	2-Bag Bagwell Door Bumper
497-0457054	Bumper Spacer
006-8612492	Screw, 1/4-20 Flat Head (11pcs)
497-0455678	Rear Support Bracket 2-Bag
006-8611143	8-32 Nut (4pcs)

## 7350-K602 Lower Bumper Kits 3-Bag Unit

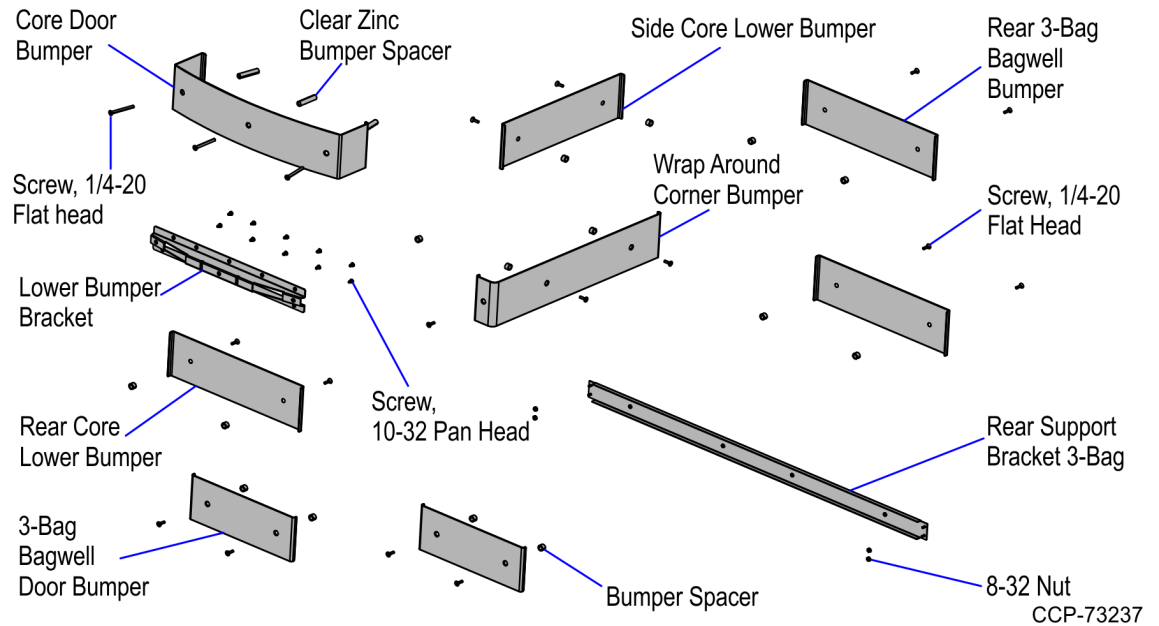

Part Number	Description
497-0521063	Lower Bumper Kits 3-Bag
497-0518275	Core Door Bumper
497-0518268	Clear Zinc Bumper Spacer (3pcs)
006-8613205	Screw, 1/4-20 Flat Head (3pcs)
497-0470147	Lower Bumper Bracket
006-8613179	Screw, 10-32 Pan head (10pcs)
497-0518276	Rear Core Lower Bumper Side Core Lower Bumper Rear 3-Bag Bagwell Bumper
497-0518277	Wrap Around Corner Bumper
497-0518274	3-Bag Bagwell Door Bumper
497-0457054	Bumper Spacer (15pcs)
006-8612492	Screw, 1/4-20 Flat Head (15pcs)
497-0455675	Rear Support Bracket 3-Bag
006-8611143	8-32 Nut (4pcs)

# Installation Procedures

Installing the Lower Bumpers on the NCR SelfServ™ Checkout (7350) unit involves the following procedures:

- [Installing Core Door Bumper](#) on the next page.
- [Installing Lower Bumpers on Core Cabinet](#) on page 9.
- [Installing Lower Bumpers on Bagwell](#) on page 11.



## Installing Core Door Bumper

To install the Core Door Bumper, follow these steps:

1. Uninstall the plastic door fascia from the metal core door by removing ten 8-32 pan head screws.

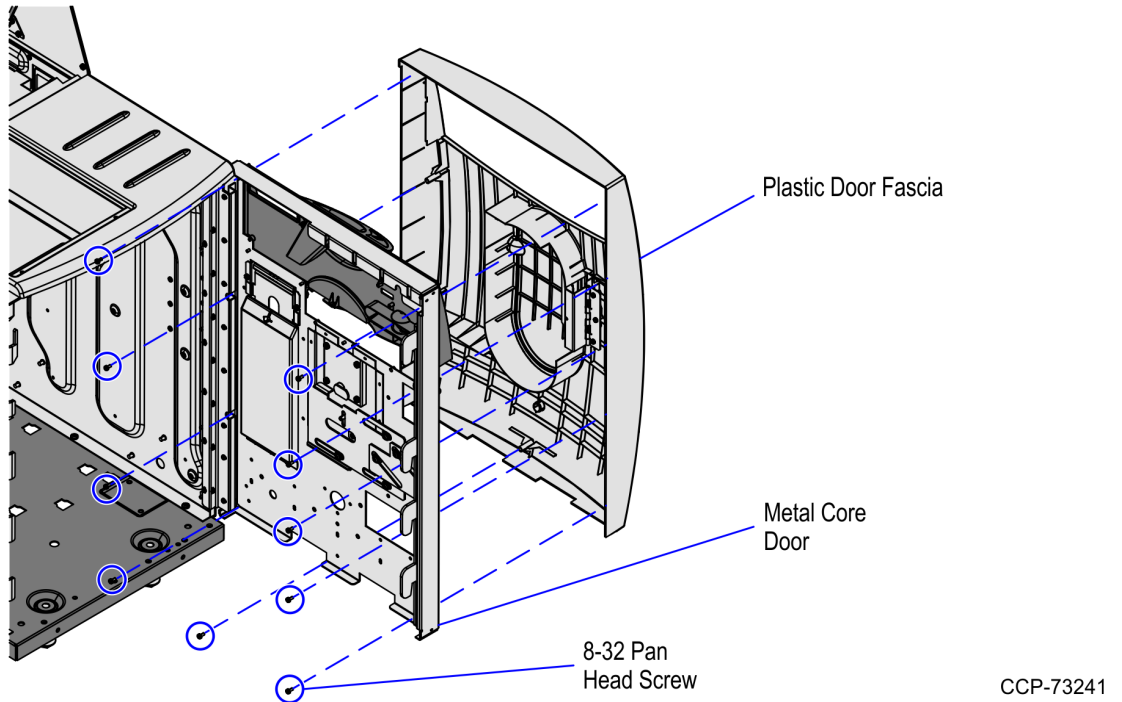

2. Attach the lower bumper bracket onto the metal core door using 10-32 pan head screws.

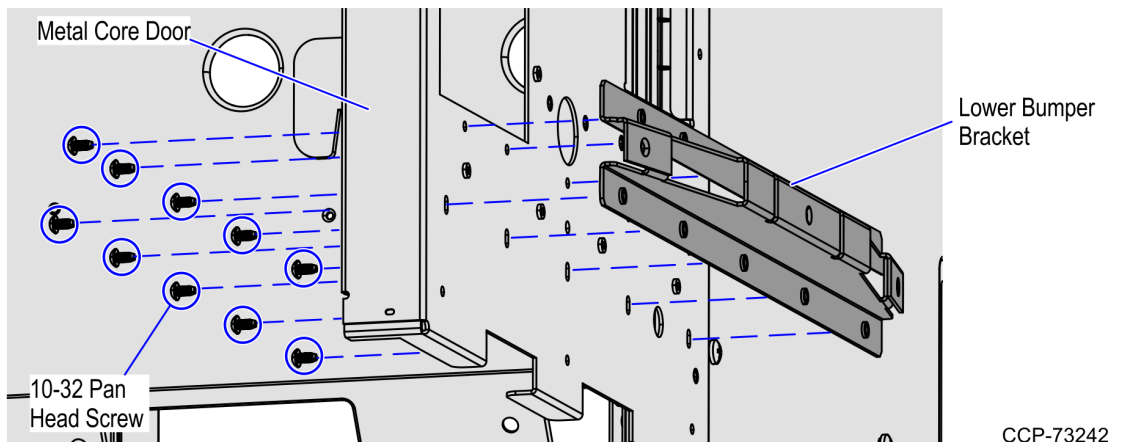

3. Attach the plastic door fascia onto the metal core door using ten 8-32 pan head screws.

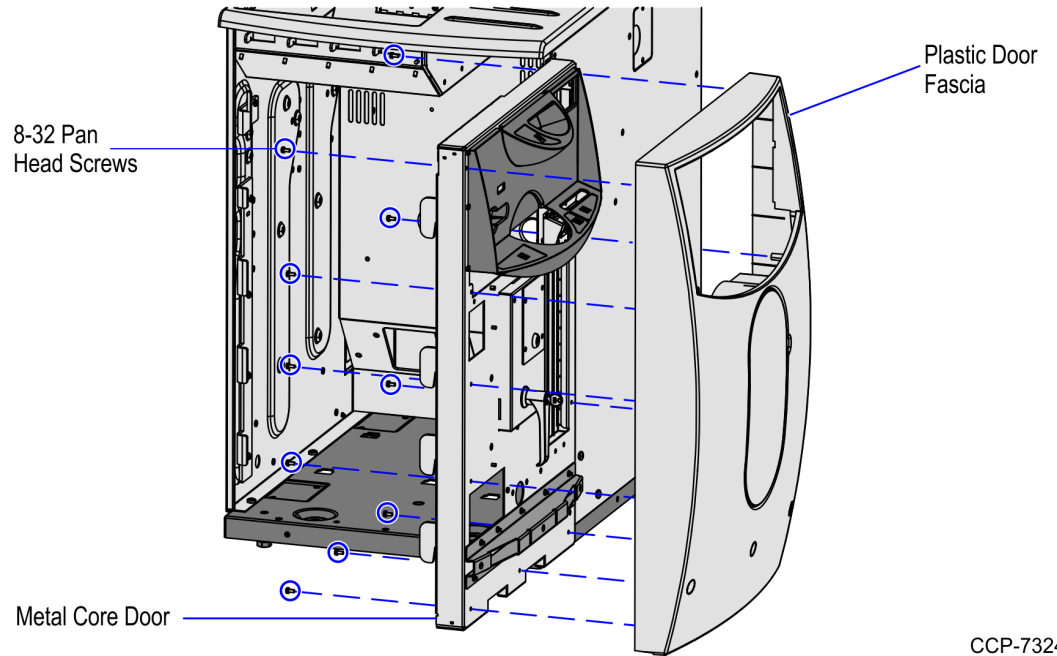

4. Remove the three plastic plugs from the plastic door fascia as shown in the image below.

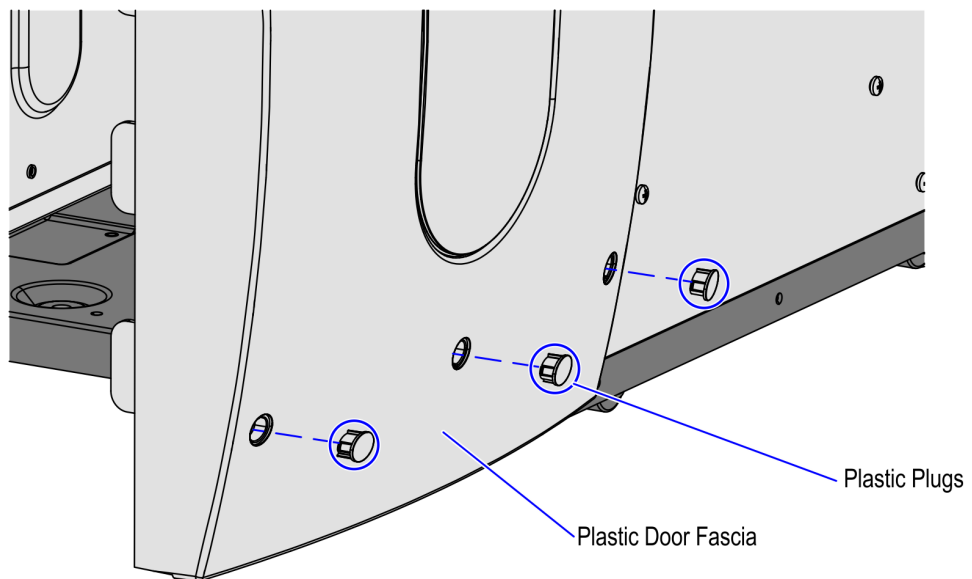

5. Do the following:
  - a. Insert three clear zinc bumper spacers into each hole on the plastic door fascia.
  - b. Align the core door bumper holes with the corresponding bumper spacer and then secure using three 1/4-20 flat head screws as shown in the image below.

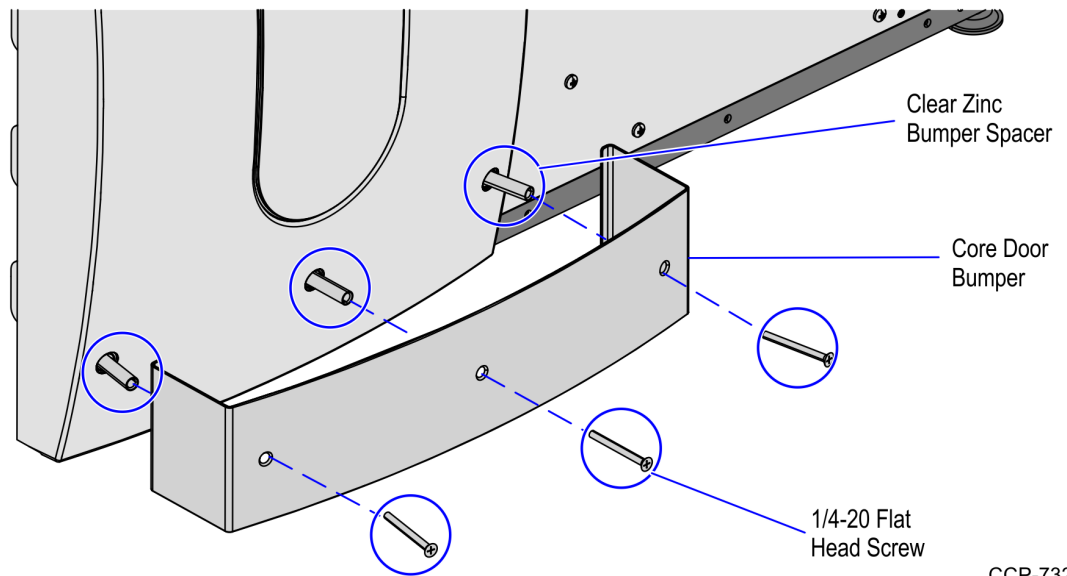

CCP-73245

## Installing Lower Bumpers on Core Cabinet

To install lower core bumpers on the Core Cabinet, follow these steps:

1. Remove hole cover labels located from the lower area of the Core Cabinet as shown in the image below.

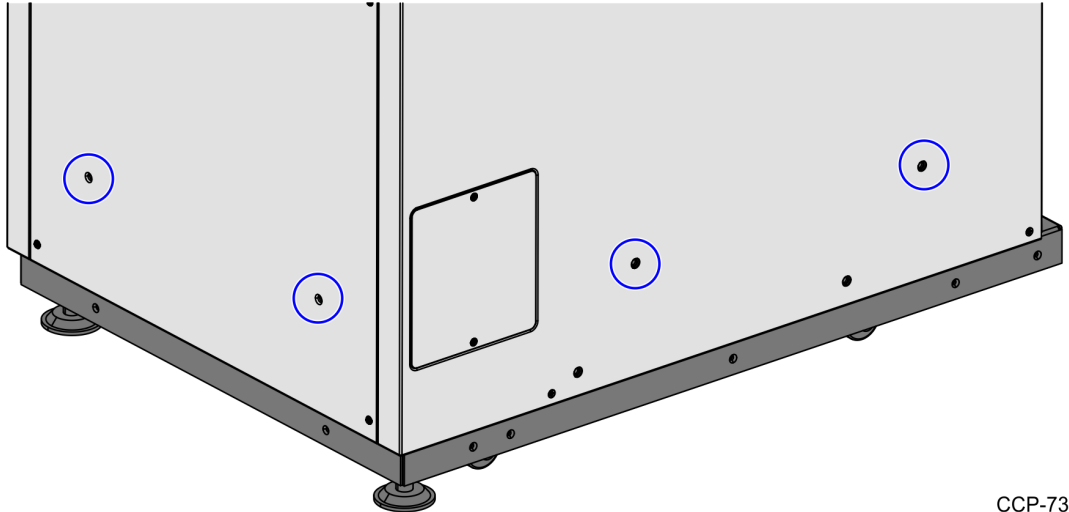

CCP-73246

2. To install the Side Core Lower Bumper, do the following:
  - a. Insert a bumper spacer into each hole.
  - b. Align the Side Core Lower Bumper holes with the corresponding bumper spacer and then secure using two 1/4-20 flat head screws as shown in the image below.

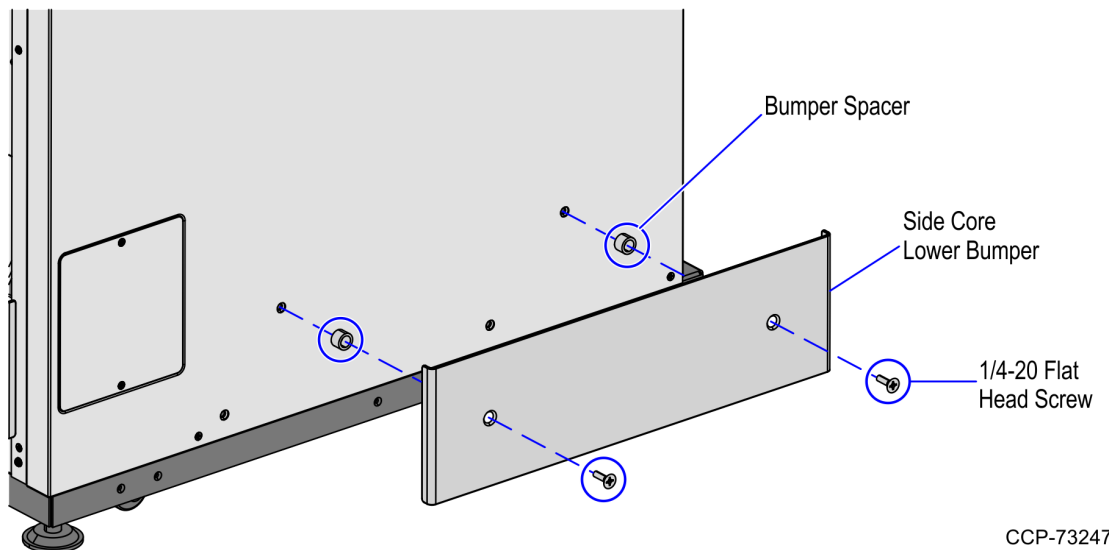

CCP-73247

3. To install the Rear Core Lower Bumper, do the following:
  - a. Insert a bumper spacer into each hole.
  - b. Align the Rear Core Lower Bumper holes with the corresponding bumper spacer and then secure using two 1/4-20 flat head screws as shown in the image below.

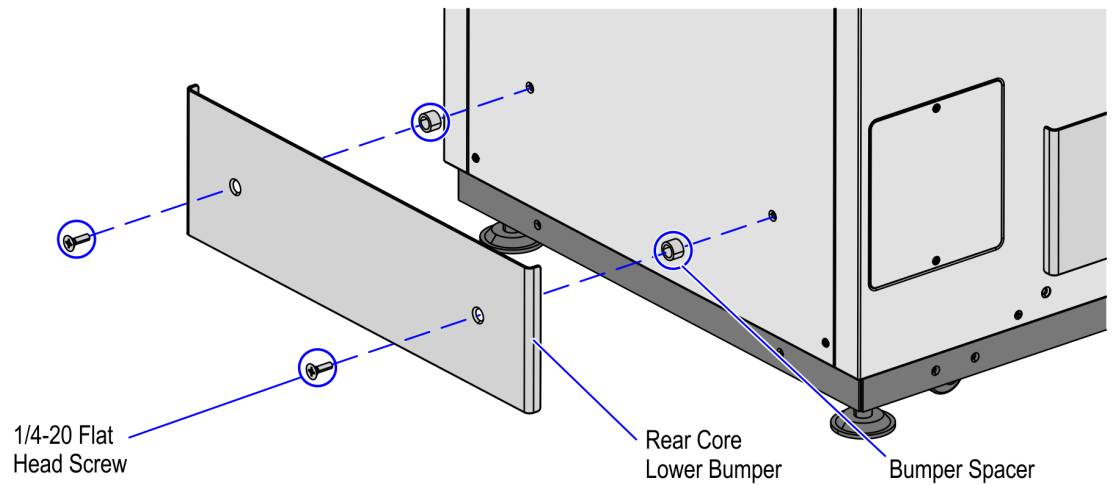

CCP-73248

## Installing Lower Bumpers on Bagwell

To install lower bumpers on the bagwell, follow these steps:



**Note:** This procedure provides instructions for installing the kit on a 3-Bag Bagwell configuration only as an example.

1. Remove hole cover labels from the lower area of the Bagwell as shown in the image below.

Front and Side Bagwell

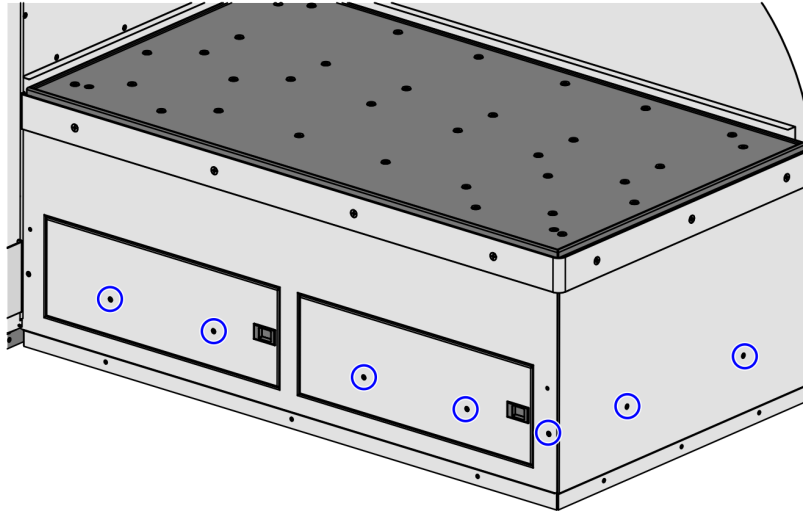

Rear Bagwell

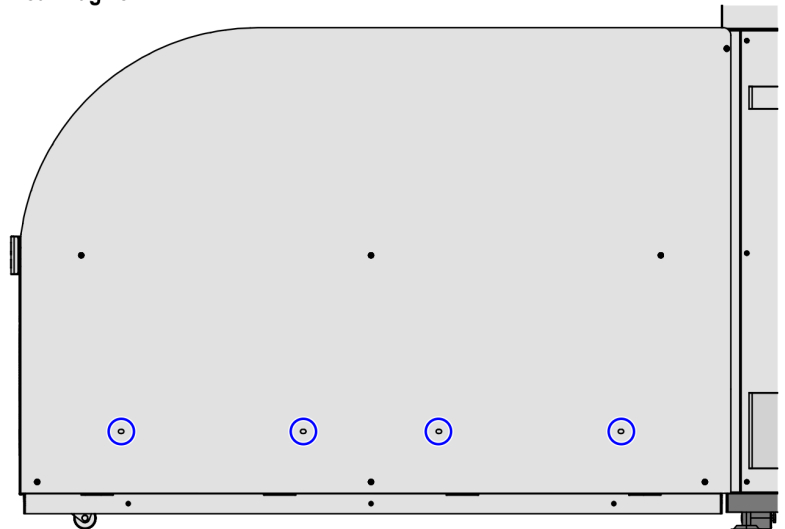

2. To install the Bagwell Door Bumpers, do the following:
  - a. Insert a bumper spacer into each hole on the bagwell doors.
  - b. Align the Bagwell Door Bumper holes with the corresponding bumper spacer and then secure each bumper using two 1/4-20 flat head screws as shown in the image below.

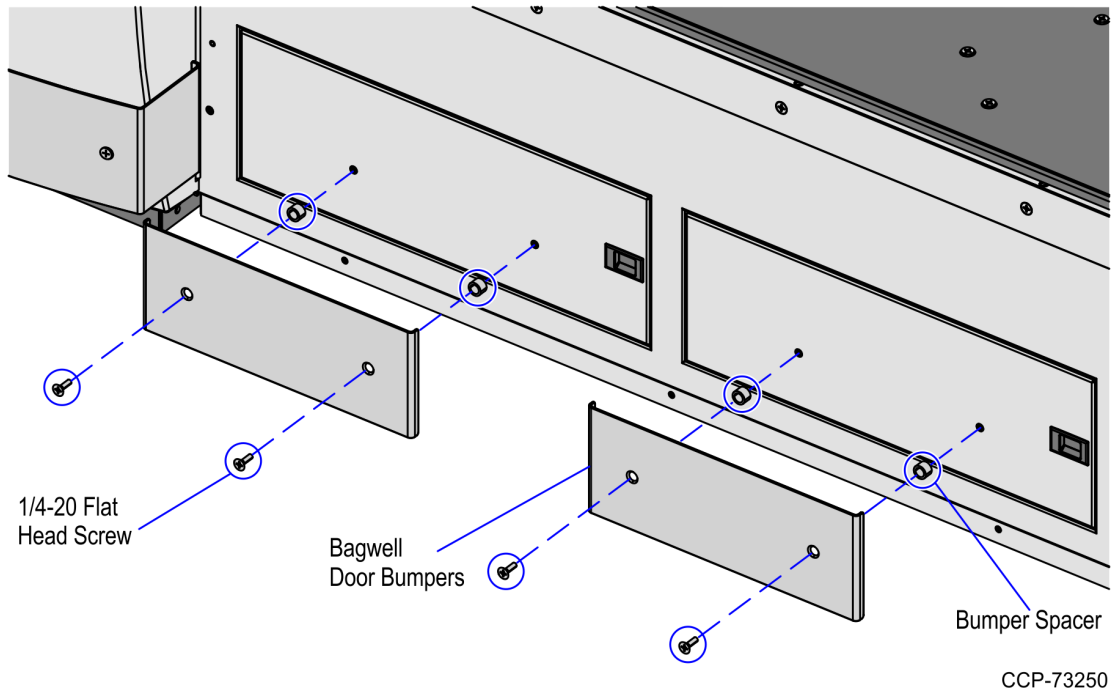

**Note:** There is only one Bagwell Door Bumper on a 2-Bag Bagwell unit. No Bagwell Door Bumper on a 1-Bag Bagwell unit.

3. To install the Wrap Around Corner Bumper on the Bagwell side, do the following:
  - a. Insert a bumper spacer into each hole.
  - b. Align the Wrap Around Corner Bumper holes with the corresponding bumper spacer and then secure using three 1/4-20 flat head screws as shown in the image below.

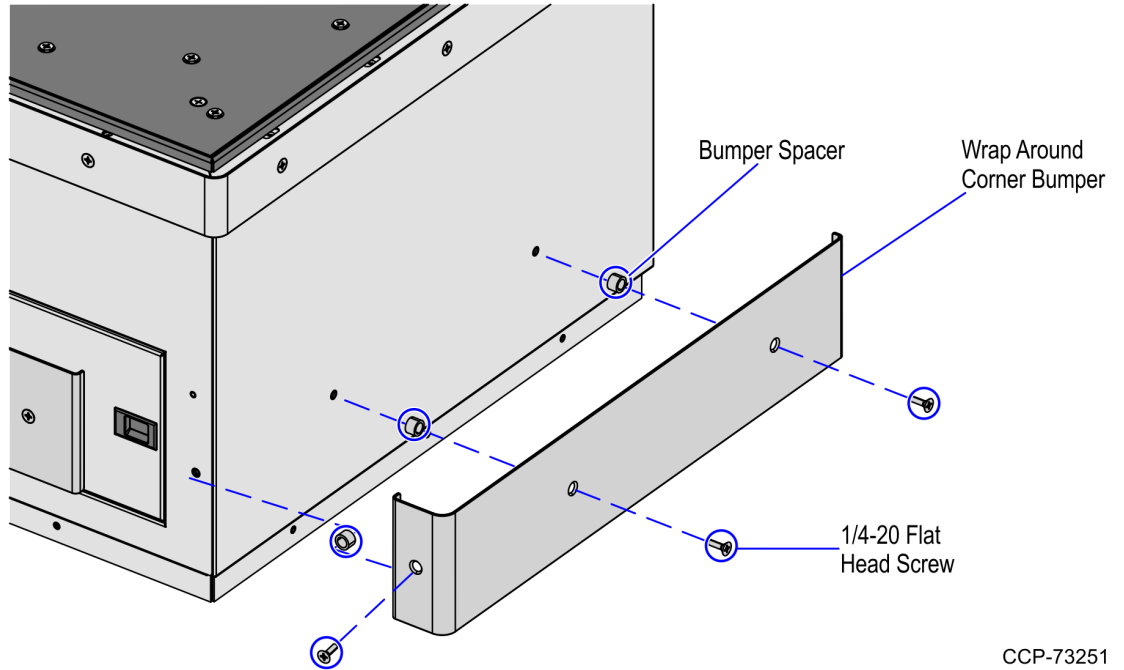

CCP-73251



- Detach the back splash from the bagwell frame by removing seven 8-32 pan head screws.

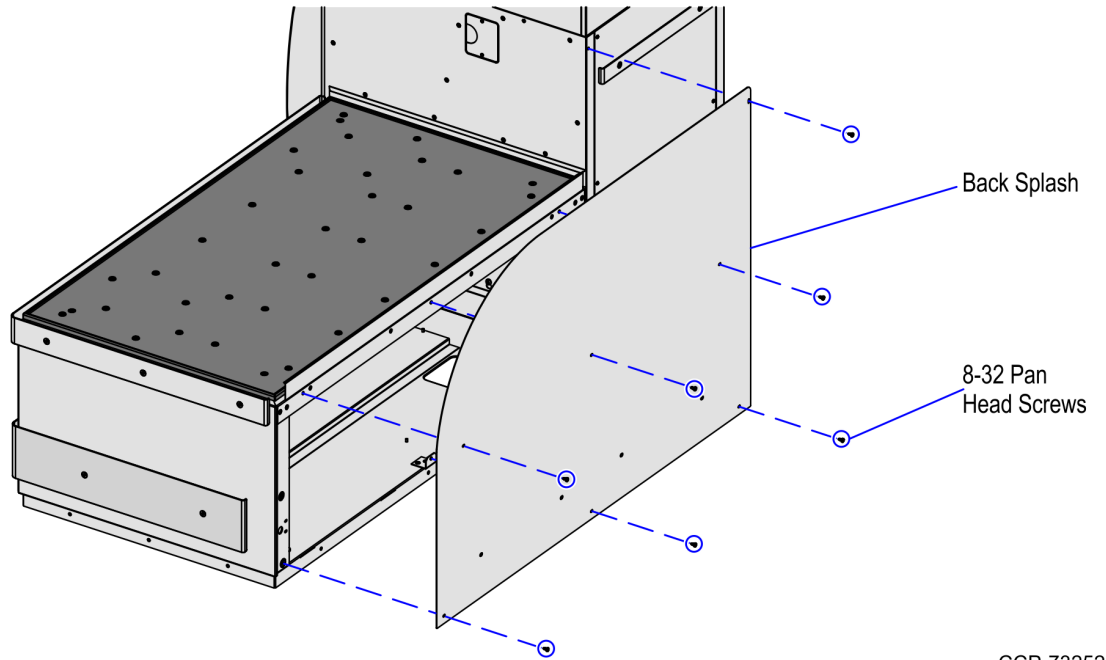

- Attach the rear support bracket onto the bagwell frame using four 8-32 nut.

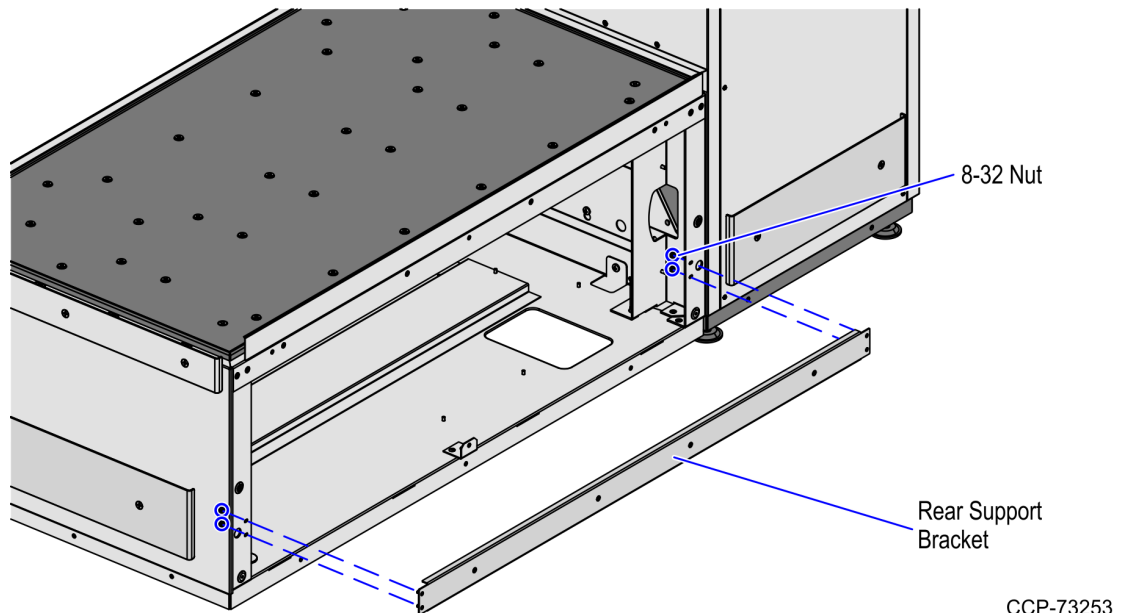

6. Attach the back splash onto the bagwell frame using seven 8-32 pan head screws.

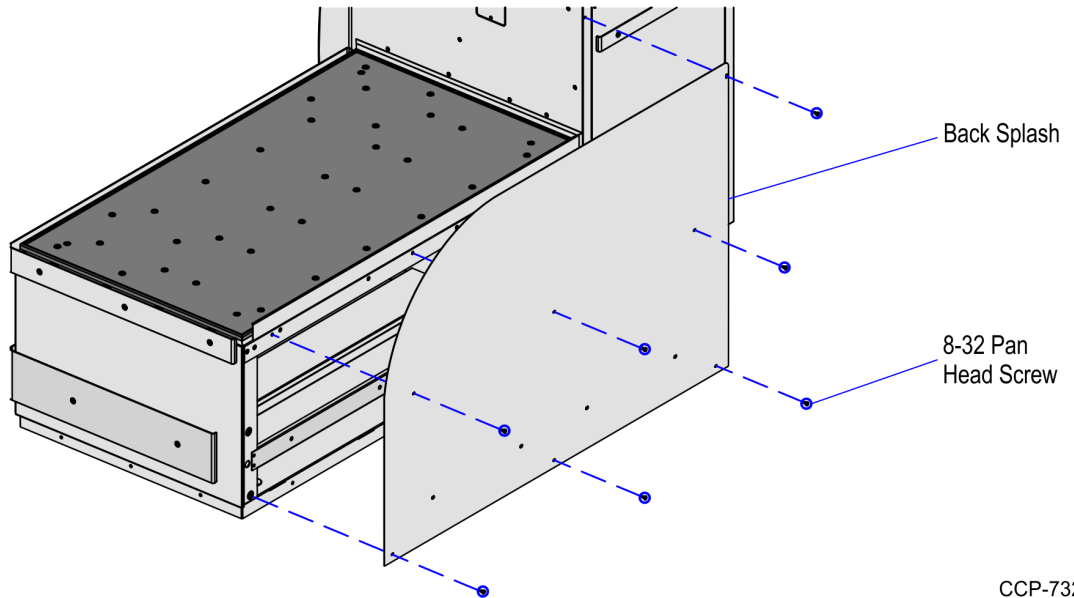

CCP-73254

7. To install a Rear Bagwell Bumper, do the following:
- Insert a bumper spacer into each hole on the back splash.
  - Align the Rear Bagwell Bumper holes with the corresponding bumper spacer and then secure each bumper using two 1/4-20 flat head screws as shown in the image below.

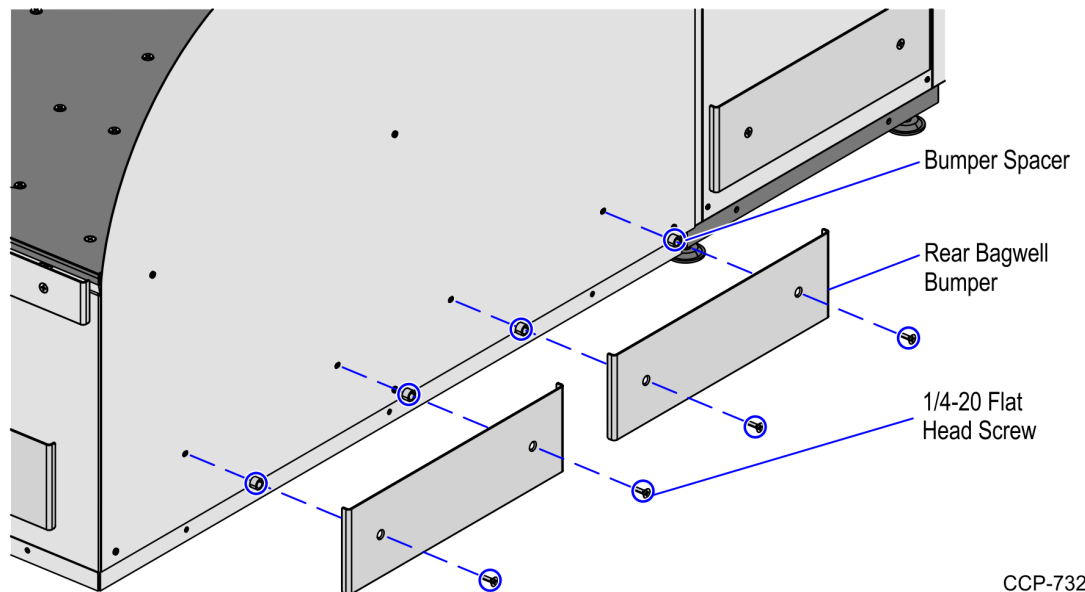

CCP-73255



**Note:** There is only one Rear Bagwell Bumper for 2-Bag Bagwell and 1-Bag Bagwell units.