

Kit Instructions

58–mm Paper Guide

7199-K058
Issue A



The product described in this document is a licensed product of NCR Corporation.

NCR is a registered trademark of NCR Corporation. NCR RealPOS is a trademark of NCR Corporation in the United States and/or other countries. Other product names mentioned in this publication may be trademarks or registered trademarks of their respective companies and are hereby acknowledged.

The terms HDMI and HDMI High-Definition Multimedia Interface, and the HDMI Logo are trademarks or registered trademarks of HDMI Licensing LLC in the United States and other countries.

Where creation of derivative works, modifications or copies of this NCR copyrighted documentation is permitted under the terms and conditions of an agreement you have with NCR, NCR's copyright notice must be included.

It is the policy of NCR Corporation (NCR) to improve products as new technology, components, software, and firmware become available. NCR, therefore, reserves the right to change specifications without prior notice.

All features, functions, and operations described herein may not be marketed by NCR in all parts of the world. In some instances, photographs are of equipment prototypes. Therefore, before using this document, consult with your NCR representative or NCR office for information that is applicable and current.

To maintain the quality of our publications, we need your comments on the accuracy, clarity, organization, and value of this book. Please use the link below to send your comments.

Email: FD230036@ncr.com

Copyright © 2017

By NCR Corporation

Atlanta, GA U.S.A.

All Rights Reserved

Revision Record

Issue	Date	Remarks
A	Jul 2017	First Issue

58 MM PAPER GUIDE KIT INSTRUCTION

Introduction

This kit serves as a guide for the 58 mm paper receipt when inserted in the printer.

Installation Procedure

- 1) User has the option to turn the printer OFF when attaching the guide.



- 2) Open the top cover/printer door.



- 3) Insert the 58 mm paper guide to the slots located on the left side of the main cover.

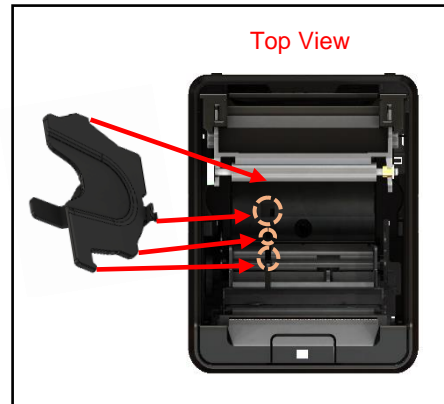

- 4) Once inserted, user may now insert the 58 mm receipt paper.

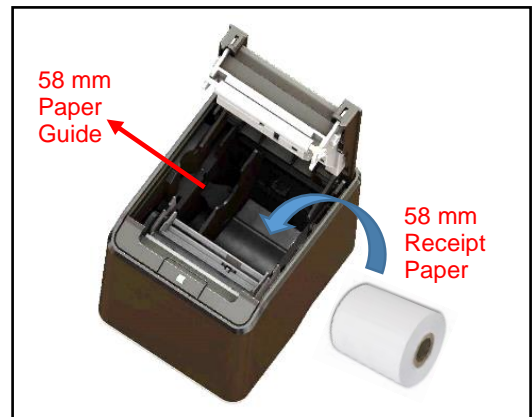

Removal Procedure

- 1) Pull the paper guide arm away from the printer to remove.

