

# Kit Instructions

58-mm Paper Guide

7168-K059  
Issue A



---

The product described in this document is a licensed product of NCR Corporation.

NCR is a registered trademark of NCR Corporation. NCR RealPOS is a trademark of NCR Corporation in the United States and/or other countries. Other product names mentioned in this publication may be trademarks or registered trademarks of their respective companies and are hereby acknowledged.

The terms HDMI and HDMI High-Definition Multimedia Interface, and the HDMI Logo are trademarks or registered trademarks of HDMI Licensing LLC in the United States and other countries.

Where creation of derivative works, modifications or copies of this NCR copyrighted documentation is permitted under the terms and conditions of an agreement you have with NCR, NCR's copyright notice must be included.

It is the policy of NCR Corporation (NCR) to improve products as new technology, components, software, and firmware become available. NCR, therefore, reserves the right to change specifications without prior notice.

All features, functions, and operations described herein may not be marketed by NCR in all parts of the world. In some instances, photographs are of equipment prototypes. Therefore, before using this document, consult with your NCR representative or NCR office for information that is applicable and current.

To maintain the quality of our publications, we need your comments on the accuracy, clarity, organization, and value of this book. Please use the link below to send your comments.

Email: [FD230036@ncr.com](mailto:FD230036@ncr.com)

Copyright © 2018  
By NCR Corporation  
Atlanta, GA U.S.A.  
All Rights Reserved

## Revision Record

Issue	Date	Remarks
A	Mar 2018	First Issue

## 58 MM PAPER GUIDE (7168-K059) KIT INSTRUCTIONS

### Introduction

This kit serves as a guide for the 58-mm paper receipt when inserted in the following printers:

- 7168 Release 1.0
- 7168 Series II
- 7198 Release 1.0

### Installation Procedure

User has the option to turn the printer OFF when attaching the guide.

- 1) Open the top cover/printer door.
- 2) Insert the 58 mm guide to slots located on the left side of the main cover.

Paper Guide

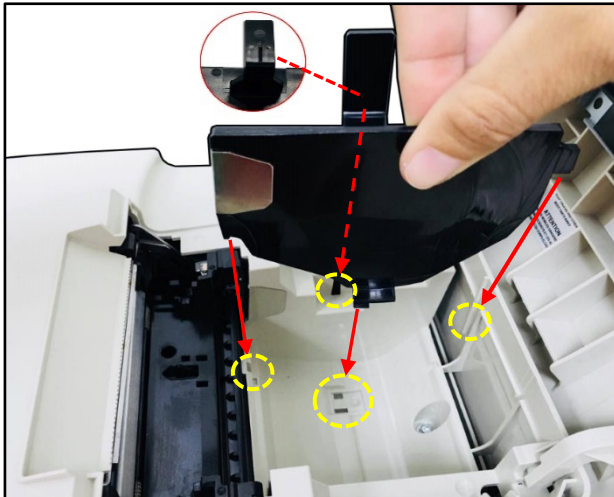
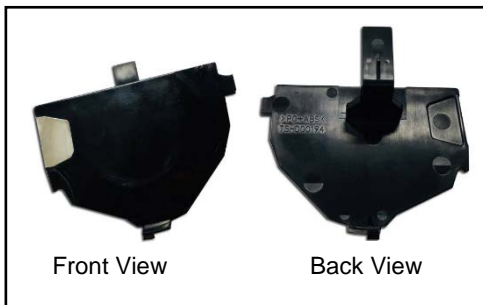

- 3) Press it downward to insert the guide. Once inserted, user may insert the 58-mm receipt paper.

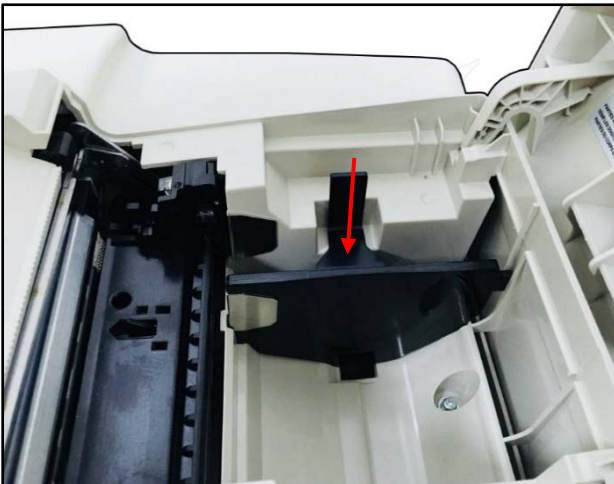

### Removal Procedure

- 1) Pull the paper guide arm to the opposite direction to unlatch it.



- 2) Pull the paper guide away from the printer to remove it.