

Kit Instructions

Mobile Shopper PS20 Spare Battery

2394-K002/K011
Issue A



The product described in this document is a licensed product of NCR Corporation.

NCR is a registered trademark of NCR Corporation. Product names mentioned in this publication may be trademarks or registered trademarks of their respective companies and are hereby acknowledged.

Where creation of derivative works, modifications or copies of this NCR copyrighted documentation is permitted under the terms and conditions of an agreement you have with NCR, NCR's copyright notice must be included.

It is the policy of NCR Corporation (NCR) to improve products as new technology, components, software, and firmware become available. NCR, therefore, reserves the right to change specifications without prior notice.

All features, functions, and operations described herein may not be marketed by NCR in all parts of the world. In some instances, photographs are of equipment prototypes. Therefore, before using this document, consult with your NCR representative or NCR office for information that is applicable and current.

To maintain the quality of our publications, we need your comments on the accuracy, clarity, organization, and value of this book. Please use the link below to send your comments.

Email: FD230036@ncr.com

Copyright © 2019
By NCR Corporation
864 Spring St NW
Atlanta, GA 30308
U.S.A.
All Rights Reserved

Revision Record

Issue	Date	Remarks
A	May 2019	First Issue

Mobile Shopper PS20 Spare Battery

Introduction

This kit contains a PowerPrecision + Lithium Ion battery with a capacity rating of 3500 mAh. The battery is compatible with all PS20 configurations.

This kit has the following options:

- 2394-K002 — contains one battery unit
- 2394-K011 — contains ten battery units

Kit Components

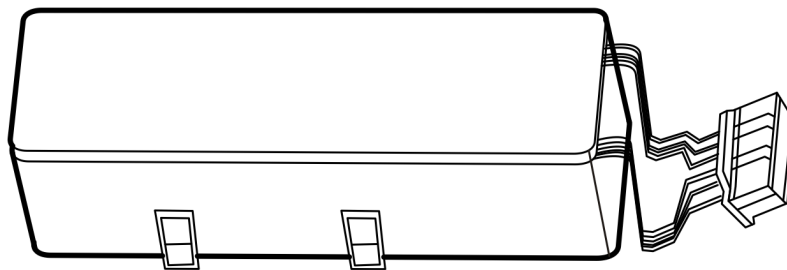

CCP-61902

PID	Description
2394-K002	FL Mobile Shopper PS20 Hand Scanner Spare Battery, 3500 mAh, Lithium-Ion, Power Precision + Battery (1 Pack)
2394-K011	FL Mobile Shopper PS20 Hand Scanner Spare Battery, 3500 mAh, Lithium-Ion, Power Precision + Battery (10 Packs)

Installation Procedures

To install the Spare Battery, perform the following procedures:

1. Power off the Personal Shopping Device. For more details, refer to [Powering off the device](#) below.
2. Remove the old battery from the battery compartment. For more details, refer to [Removing the old battery](#) on the facing page.
3. Install the new battery. For more details, refer to [Installing the spare battery](#) on page 4.

Powering off the device

To power off the Personal Shopping Device, follow these steps:

1. Touch and hold the  button.
2. Select **Power Off** → **OK**.



Caution: The device must be turned off before removing the battery. Failing to suspend the Personal Shopping Device before removing the battery may damage the data stored on flash memory or corrupt the operating system files.

Removing the old battery

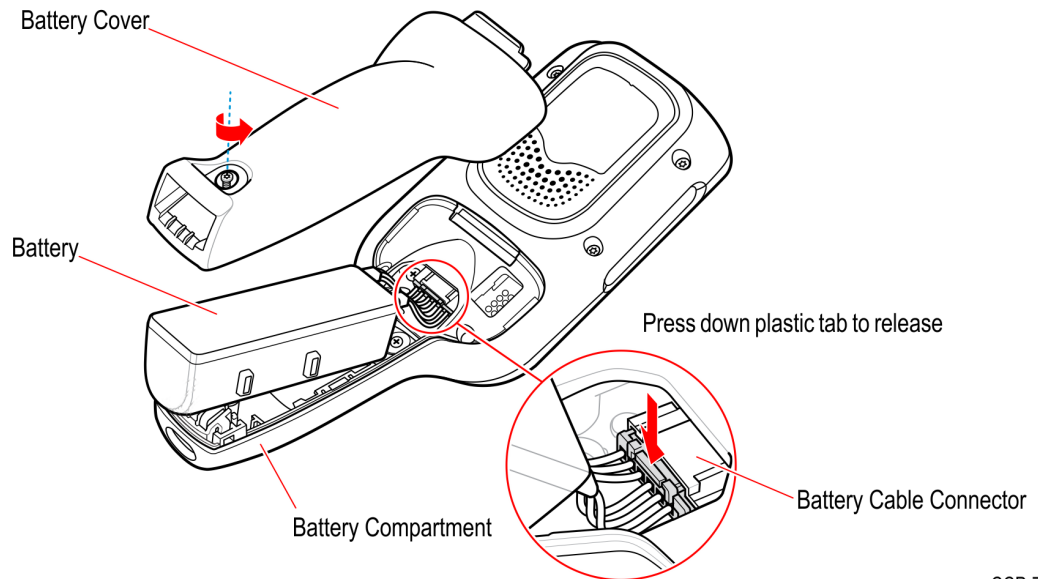

CCP-75998

To remove the old battery, follow these steps:

1. Use a Phillips (PH00) screwdriver to remove the captive screw that secures the battery cover.
2. Lift the battery cover from the handle.
3. Inside the battery compartment, press down the plastic tab of the battery cable connector and slide it out of the shrouded male pin connector.
4. Remove the old battery from the battery compartment.

Installing the spare battery

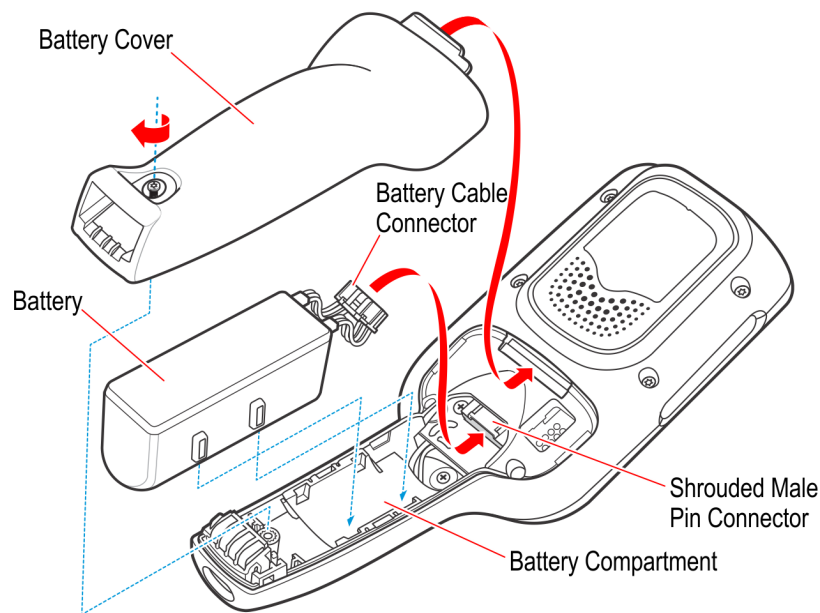

CCP-75997

To install the battery, follow these steps:

1. Guide and press the battery cable connector into the shrouded male pin connector inside the battery compartment.



Note: The connector is designed to only fit one way.

2. Place the battery inside the battery compartment.
3. Place the battery cover onto the handle.
4. Use a Phillips (PH00) screwdriver to secure the battery cover with the screw.