

Kit Instructions

Demo/Lab Base Plate

2246-K045
Issue C



The product described in this document is a licensed product of NCR Corporation.

NCR is a registered trademark of NCR Corporation. NCR SelfServ™ is a trademark of NCR Corporation in the United States and/or other countries. Other product names mentioned in this publication may be trademarks or registered trademarks of their respective companies and are hereby acknowledged.

The terms HDMI and HDMI High-Definition Multimedia Interface, and the HDMI Logo are trademarks or registered trademarks of HDMI Licensing LLC in the United States and other countries.

Where creation of derivative works, modifications or copies of this NCR copyrighted documentation is permitted under the terms and conditions of an agreement you have with NCR, NCR's copyright notice must be included.

It is the policy of NCR Corporation (NCR) to improve products as new technology, components, software, and firmware become available. NCR, therefore, reserves the right to change specifications without prior notice.

All features, functions, and operations described herein may not be marketed by NCR in all parts of the world. In some instances, photographs are of equipment prototypes. Software screen images are representative, and in some cases, may not match a customer's installed software exactly. Therefore, before using this document, consult with your NCR representative or NCR office for information that is applicable and current.

To maintain the quality of our publications, we need your comments on the accuracy, clarity, organization, and value of this book. Please use the link below to send your comments.

Email: FD230036@ncr.com

Copyright © 2021
By NCR Corporation
864 Spring St. NW
Atlanta, GA 30308
United States
All Rights Reserved

Revision Record

Issue	Date	Remarks
A	Dec 2019	First Issue
B	Jul 2020	Updated procedures for removing and installing the Checkpoint controller and power supply
C	Feb 2021	Updated kit contents

Demo/Lab Base Plate

This publication provides procedures for installing the NCR SelfServ™ XK22 (2246) Kiosk on a Demo/Lab Base Plate kit.

Kit Contents

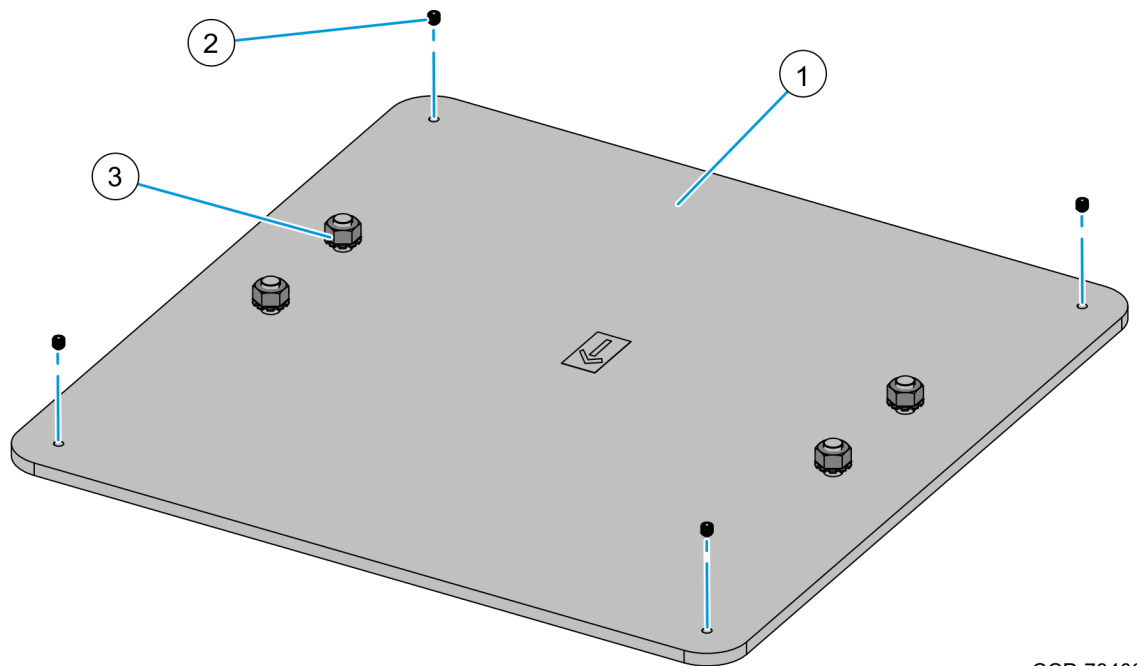

CCP-78403

Part Number		Description
497-0526307		Kit - Demo/Lab Base Plate
1	795-0279902	Base Plate, Demo, 2246
2	006-8627464	Set Screw, M5x5mm Length (4 pcs)
3	006-8623608	Hex Nut with Washer - M8 x 1.25, 6.5mm Thick, Steel, Zinc Plated

Installation Procedures

To install the NCR XK22 Kiosk on the Demo/Lab Base Plate kit, follow these steps:

1. Position the Demo/Lab Base Plate on the installation location.
2. Using a flat-head screwdriver or a similar tool, remove the four knock-out features that cover the mounting holes on the bottom of the kiosk head.

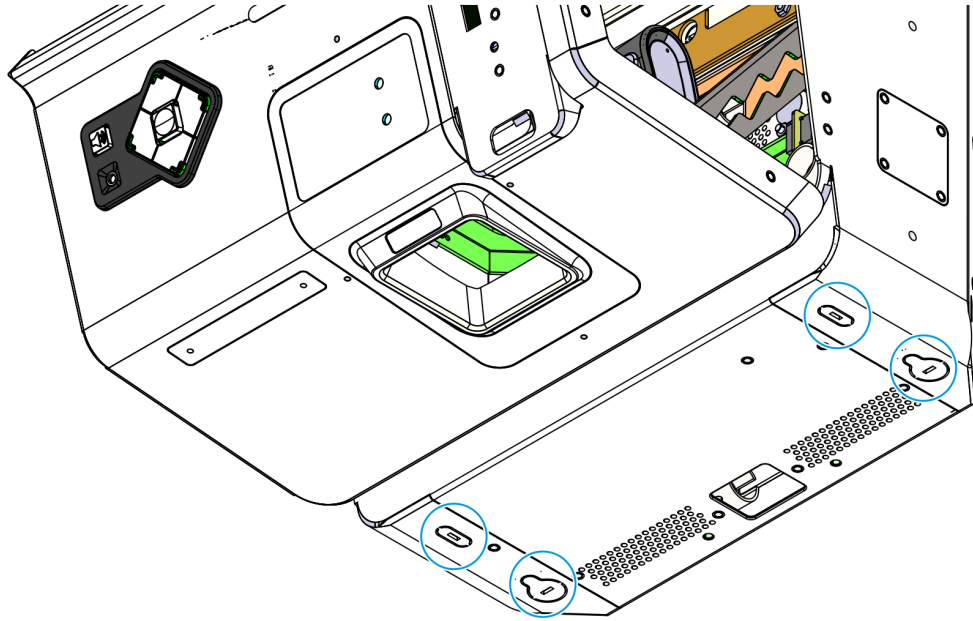

CCP-76691

3. Install but do not tighten the two M8 Keps nuts onto the two rear mounting studs.

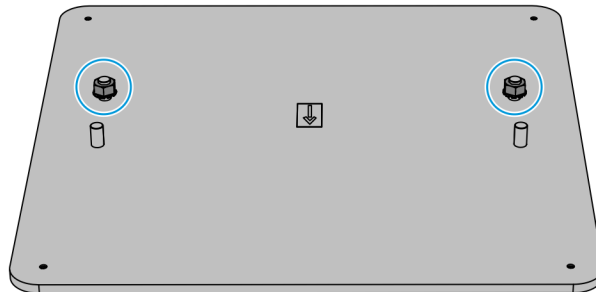

CCP-78404

4. Position the kiosk head onto the studs on top of the Demo/Lab Base Plate, and then slide the kiosk head toward the back.

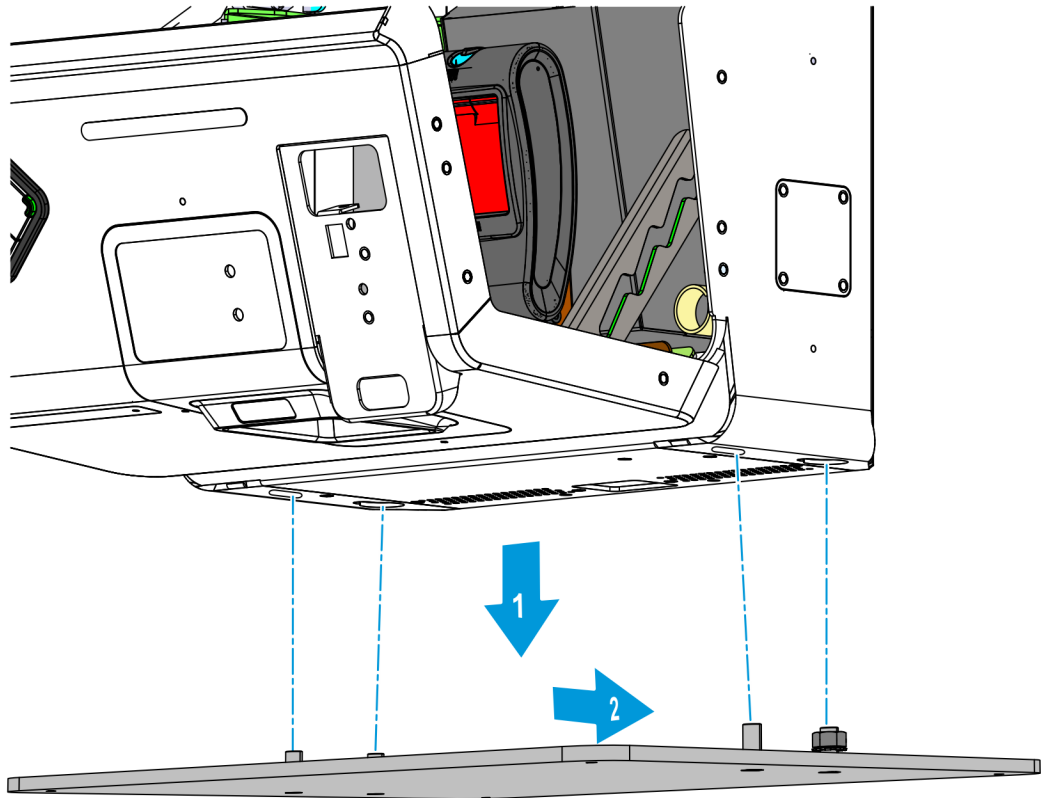

CCP78405

5. While supporting the kiosk, open the Lower Module Door and do the following:



Note: For procedures on how to open the Lower Module Door, refer to [Opening the Kiosk](#) on page 5.

- a. If the kiosk includes the Coupon Bin feature, remove the Coupon Bin from its mounting studs.
- b. If the kiosk includes the Receipt Printer feature, remove the Receipt Printer from its mounting bracket. For more information, refer to [Removing the Receipt Printer](#) on page 9.
- c. If the kiosk includes the Checkpoint feature, remove the Checkpoint Controller, its power supply brick, and its mounting brackets from the kiosk. For more information, refer to [Removing the Checkpoint Controller and Power Supply](#) on page 12.

- d. To access the mounting holes on the left side of the kiosk, remove the DC Power Cable from the p-loop indicated in the following image.

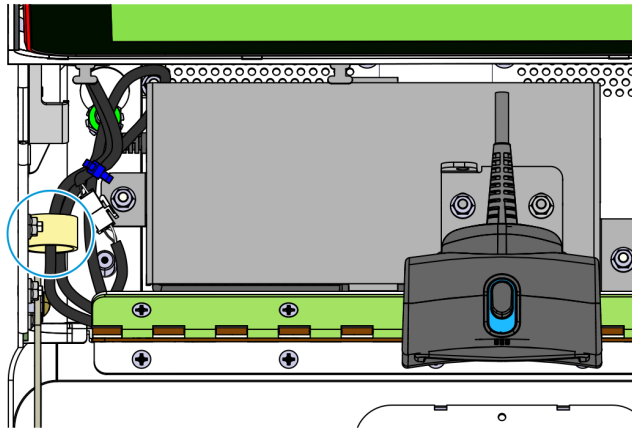

CCP-76697

6. Install but do not tighten the two M8 Keps nuts on the two front studs.

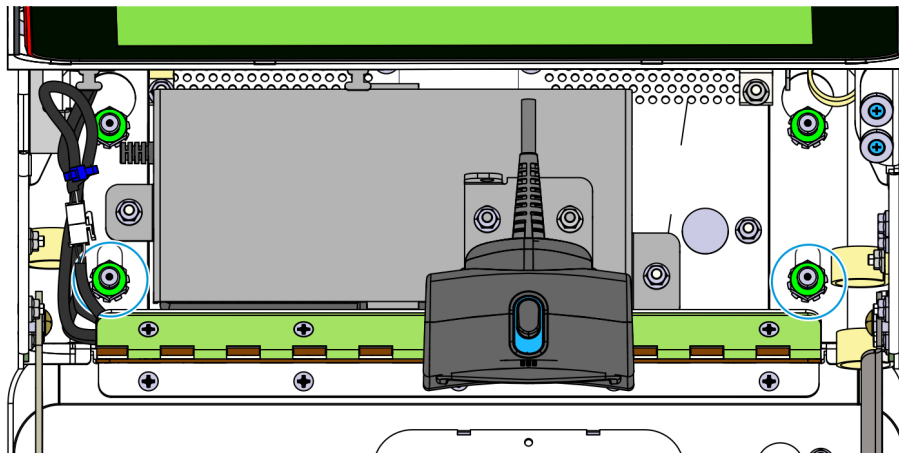

CCP-77906

7. To fully secure the kiosk, tighten the four M8 Keps nuts.



Note: Do not fully tighten any screw on the first turn. Use a stepping method when tightening the screws. Tighten each screw a little at a time to evenly install the kiosk to the Demo/Lab Base Plate.

8. Route the AC Power Cable and the LAN Cable. For more information, refer to [Routing the Cables](#) on page 19.
9. If the kiosk includes the Receipt Printer feature, re-install the receipt printer. For more information, refer to [Installing the Receipt Printer](#) on page 10.
10. If the kiosk includes the Checkpoint feature, re-install the Checkpoint Controller, its power supply brick, and its mounting brackets. For more information, refer to [Installing the Checkpoint Controller and Power Supply](#) on page 15.
11. If the kiosk includes the Coupon Bin feature, re-install the Coupon Bin on its mounting studs.

Opening the Kiosk

To open the kiosk, follow these steps:

1. Open the Lower Module Door.
 - a. Insert the Lower Module Door key into the keyhole on the left-hand side of the kiosk, turn the key clockwise (OPEN position), and then partially pull the key (about halfway) out of the keyhole.



Note: When the key is partially out of the keyhole, the cam lock mechanism is held at the OPEN position. This technique prevents the cam lock from automatically re-engaging with the lock catch.

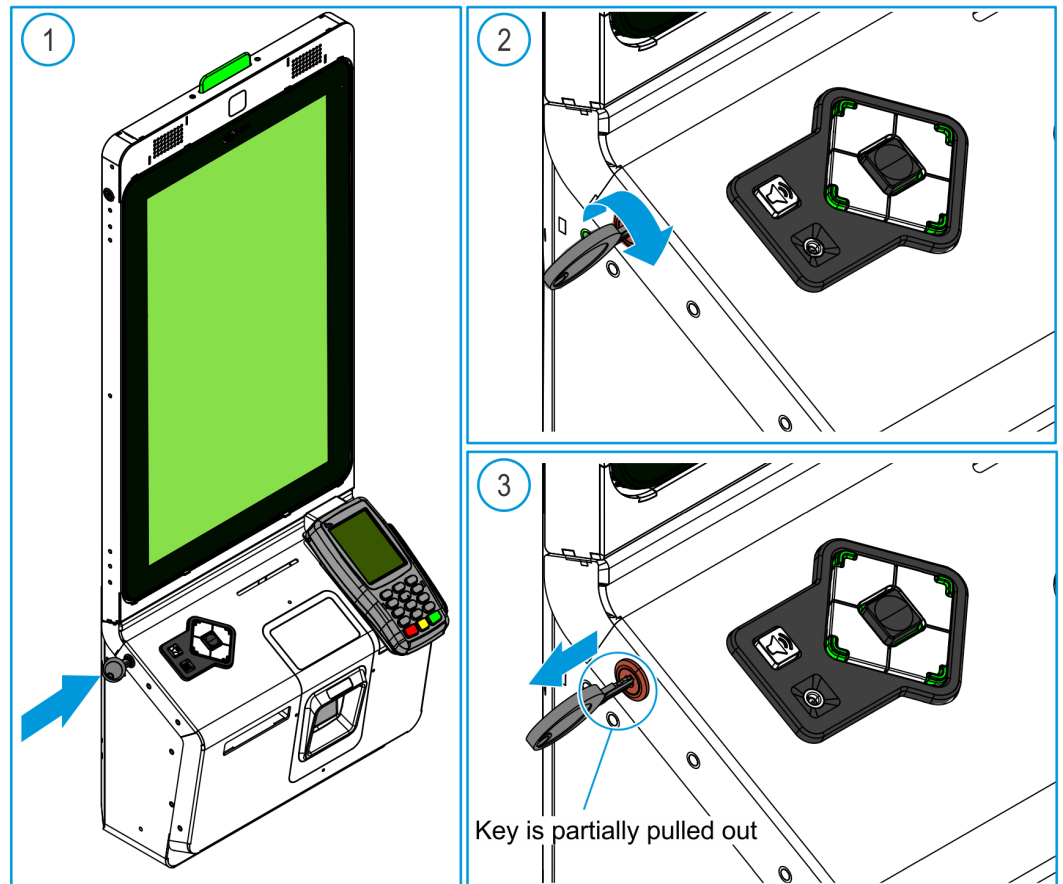

- b. While the key and the cam lock are at the OPEN position, grip the left and right edges of the Lower Module Door, pull the door forward, and guide the door until the door linkage is fully extended.



Caution: Do NOT abruptly open and release the Lower Module Door. Hold and support the Lower Module Door until fully extended.

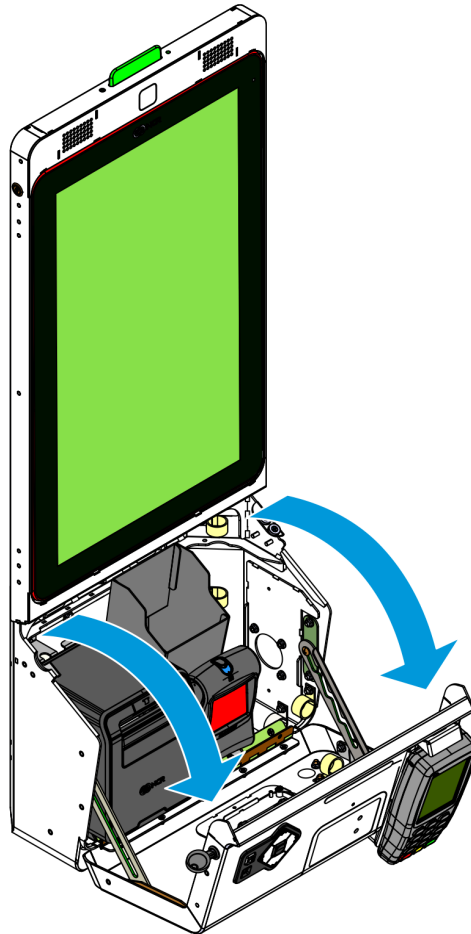

2. Open the Upper Module Door.

- a. Insert the Upper Module Door key into the lock on the left-hand side of the kiosk, turn the key clockwise (OPEN position), and then partially pull the key (about halfway) out of the keyhole.



Note: When the key is partially out of the keyhole, the cam lock mechanism is held at the OPEN position. This technique prevents the cam lock from automatically re-engaging with the lock catch.

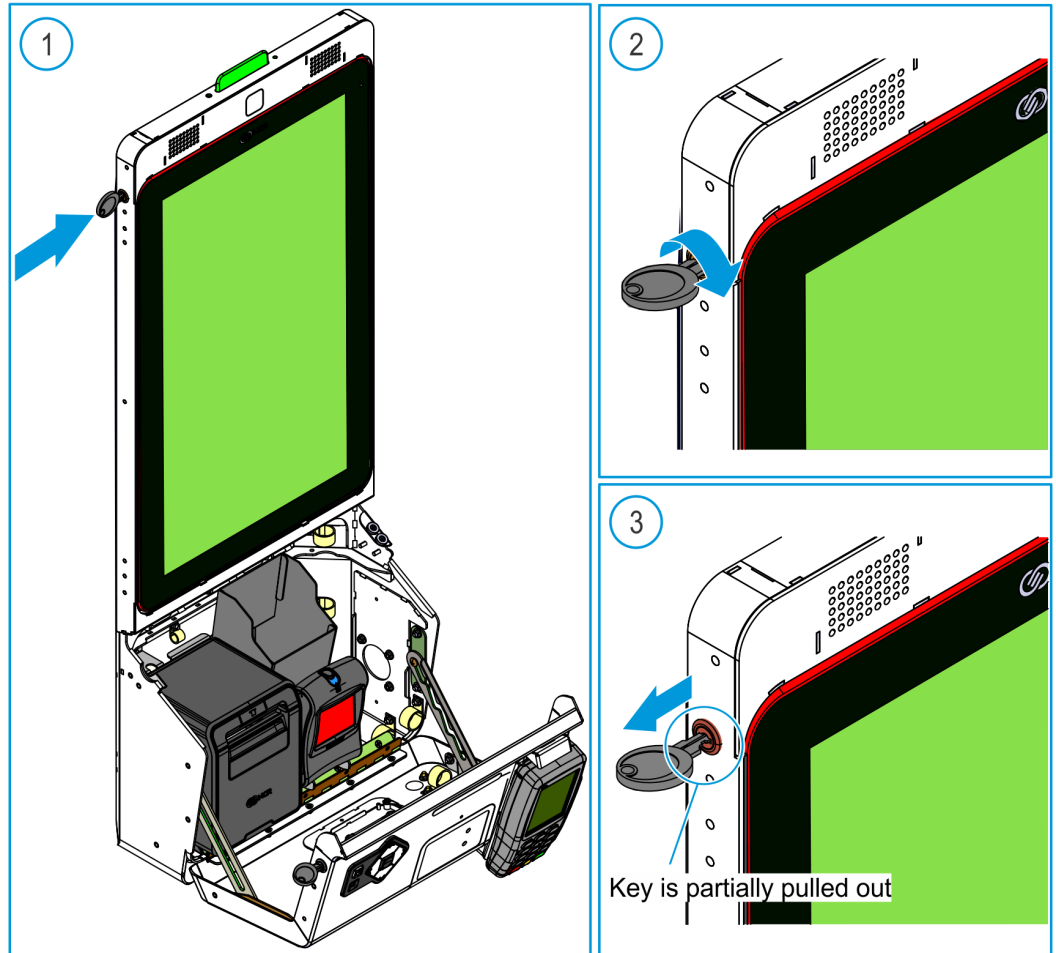

- b. While the key and the cam lock are at the OPEN position, grip the left edge of the Upper Module Door and pull the door forward.

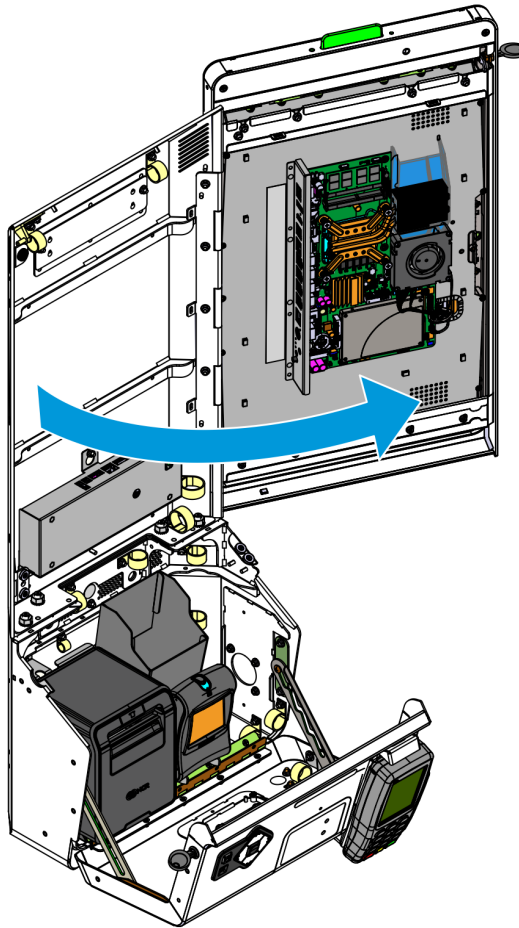

Receipt Printer

Removing the Receipt Printer

1. Slightly slide the receipt printer upward to unhook it from its bracket, and then carefully remove the printer from its bracket.

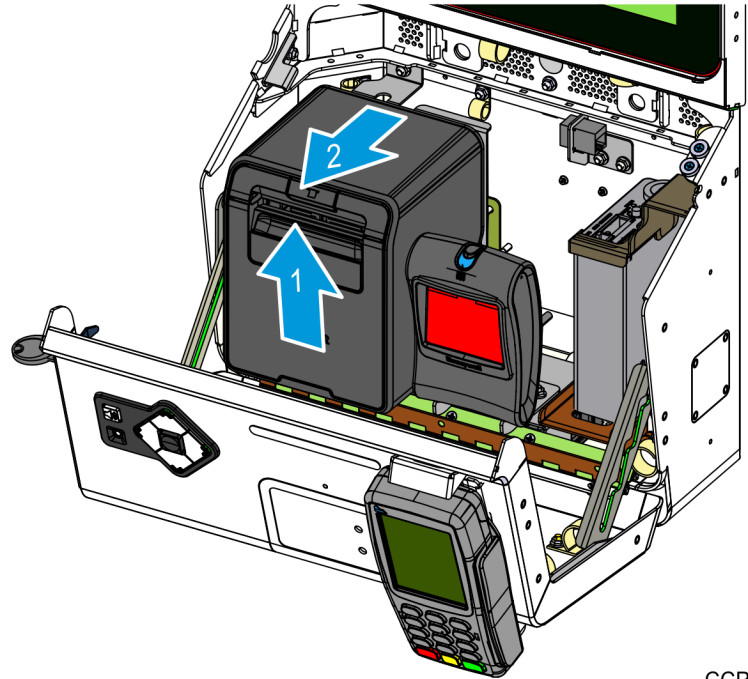

CCP-77653



Caution: At this point, the printer cables are still connected to the rear side of the printer. To avoid damaging the cables or the printer, do not pull the printer too far away from its mounting bracket.

2. Disconnect the Power and USB cables from the rear side of the printer.



Note: The Power Cable connector has a lock feature. Slightly pull the external shell of the connector then pull the connector out of its port.

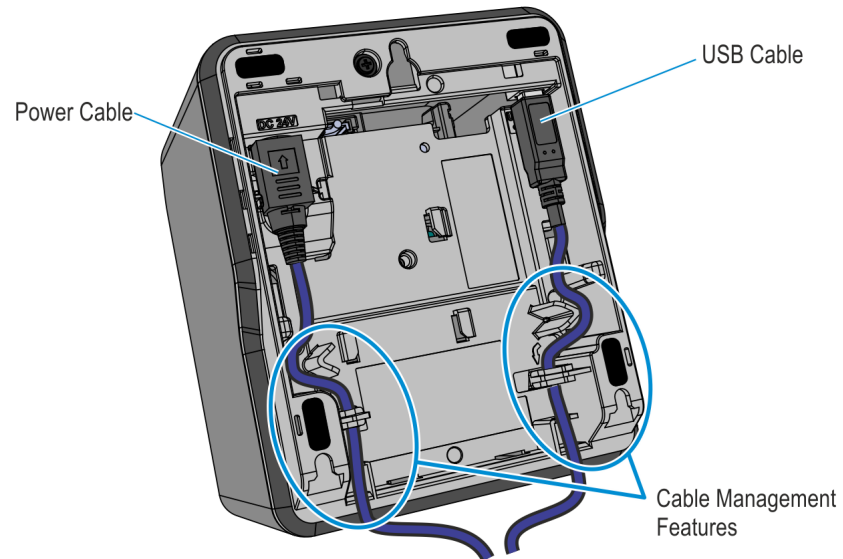

CCP-73161

Installing the Receipt Printer

1. Connect the Power and USB cables to the rear side of the printer. Route the cables downward and secure them using the cable management features in the printer.

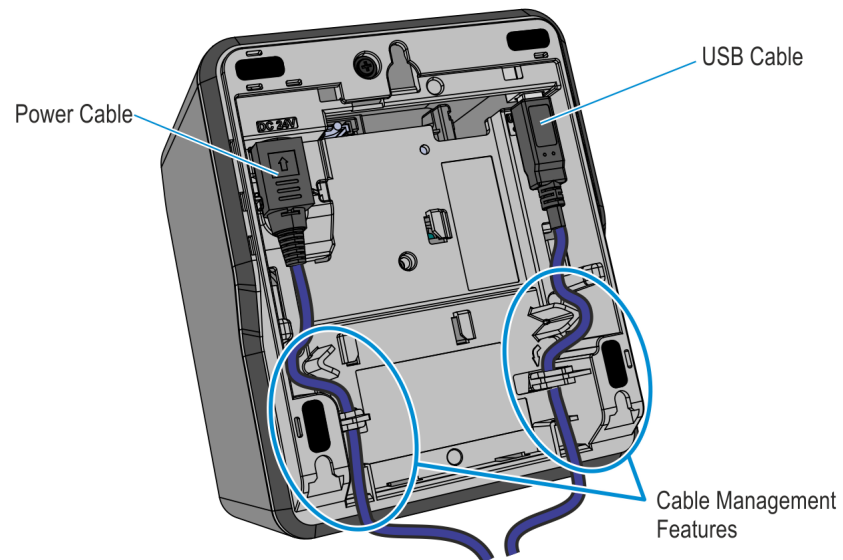

CCP-73161

2. Mount the printer to its bracket using the hook features and slide it down to lock it in place, while inserting the cable to the cable slot on the bracket.



Note: To avoid damaging the printer when the door is closed, ensure that the printer is properly hooked to its bracket.

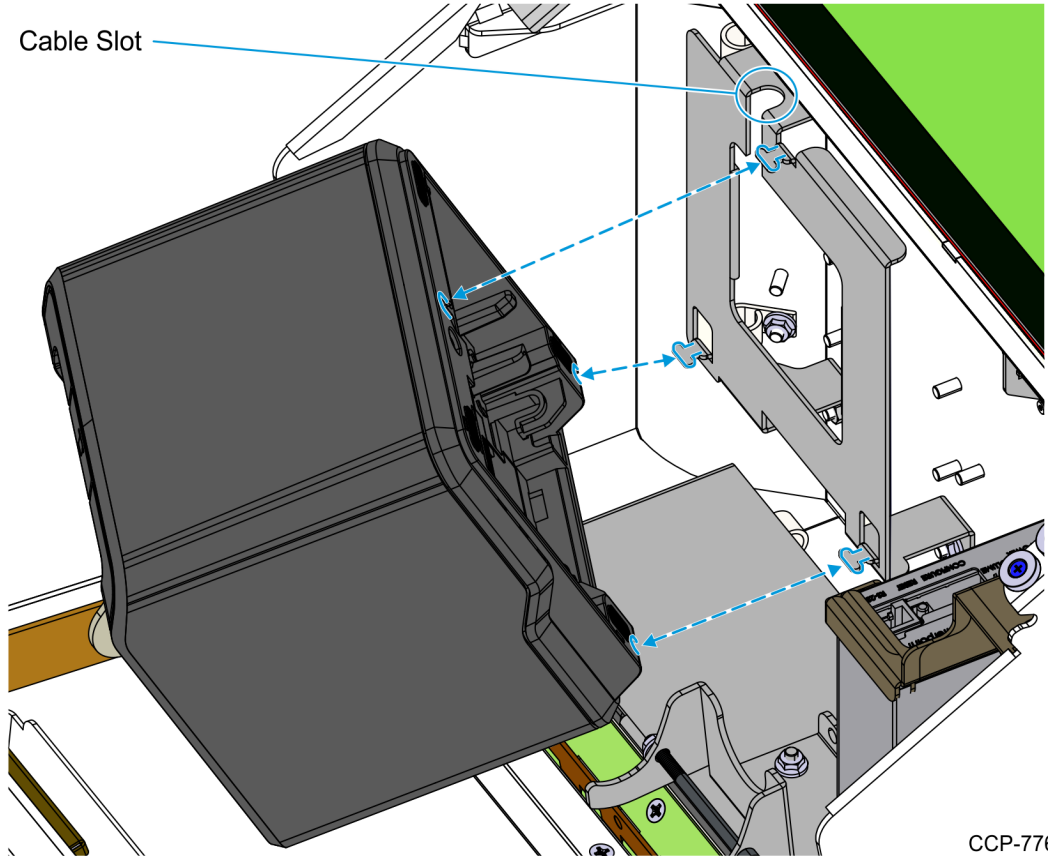

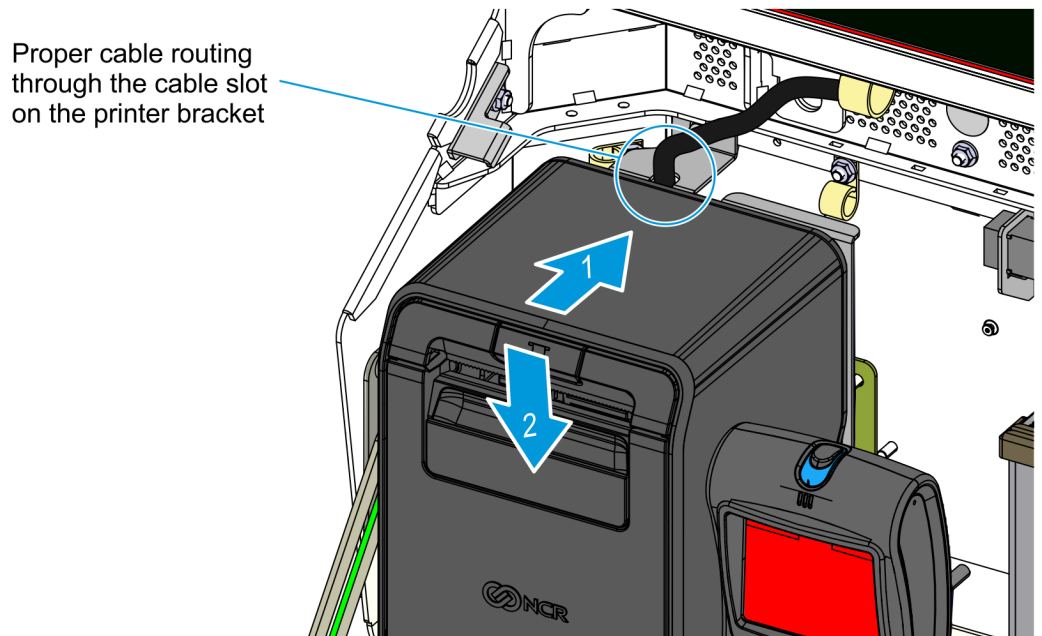

CCP-77652



CCP-77651

Checkpoint Controller and Power Supply

 **Warning:** Before removing or replacing the Checkpoint Controller or Checkpoint Power Supply, ensure to disconnect the Checkpoint Power Supply AC Power Cord from the AC outlet.

 **Note:** This section provides procedures for removing and re-installing the Checkpoint Controller and Power Supply, in case either one or both need to be removed to access other devices in the kiosk.

Removing the Checkpoint Controller and Power Supply

1. Open the Upper Module Door and disconnect the Checkpoint Signal Cable connector from the **CKPT** connector on the I/O Adapter. Remove it from the p-loops along its route.

 **Note:** For procedures on how to open the Upper Module Door, refer to [Opening the Kiosk](#) on page 5.

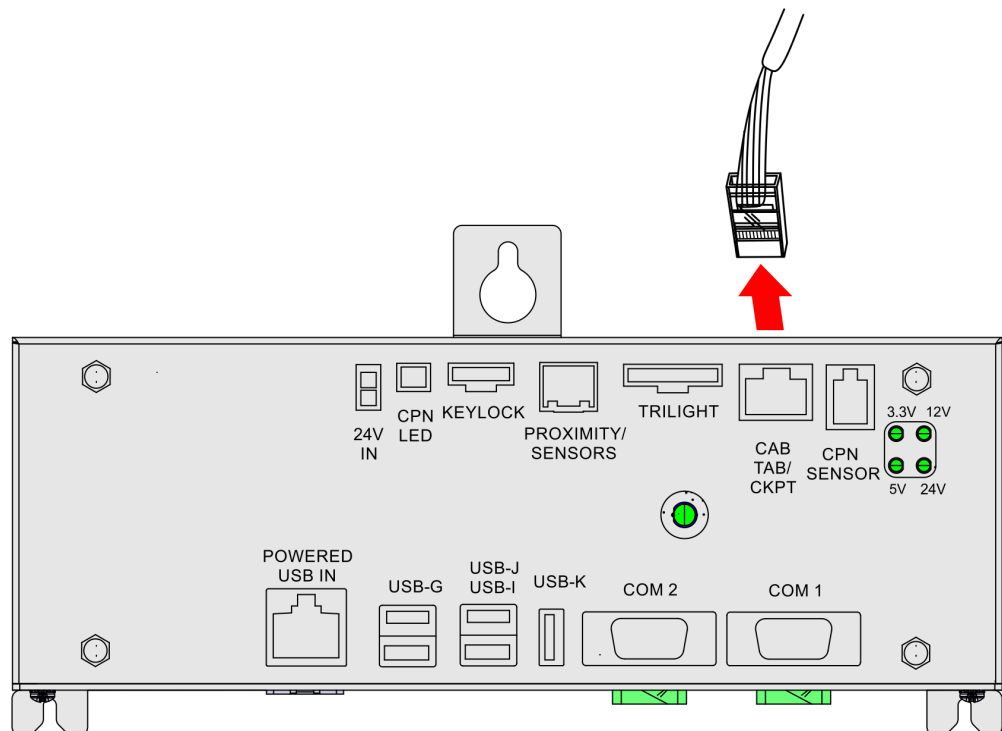

CCP-79188

2. Remove the two hex nuts that secure the Checkpoint Controller lock bracket onto the side of the lower module.

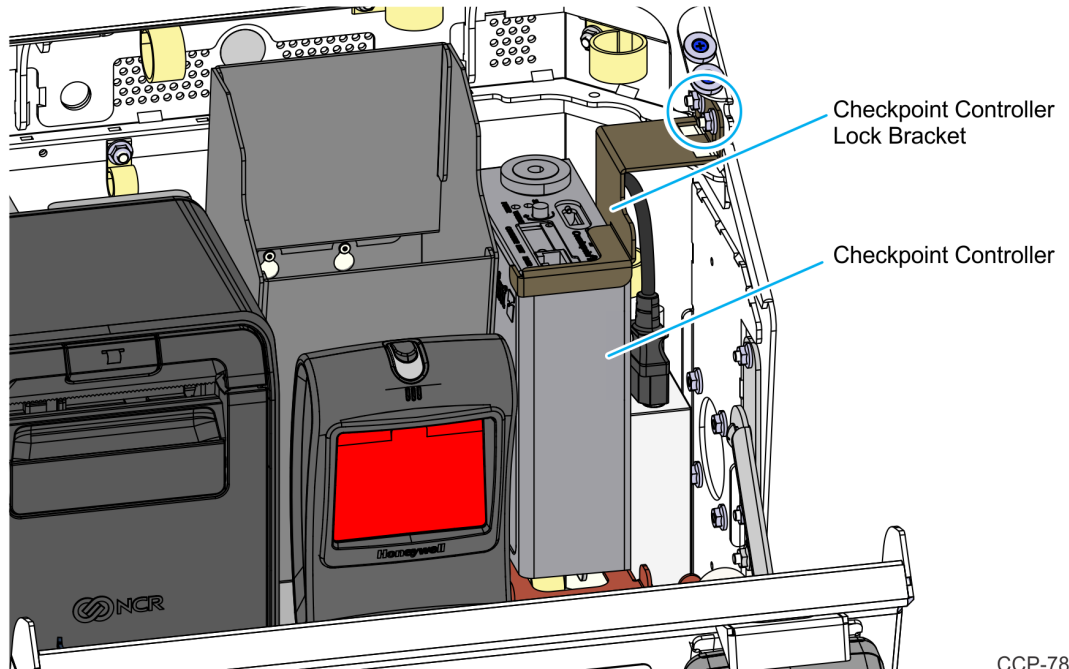

3. Lift the Checkpoint Controller off the mounting bracket and disconnect the DC Power Cable from the DC In connector at the bottom of the Checkpoint Controller.

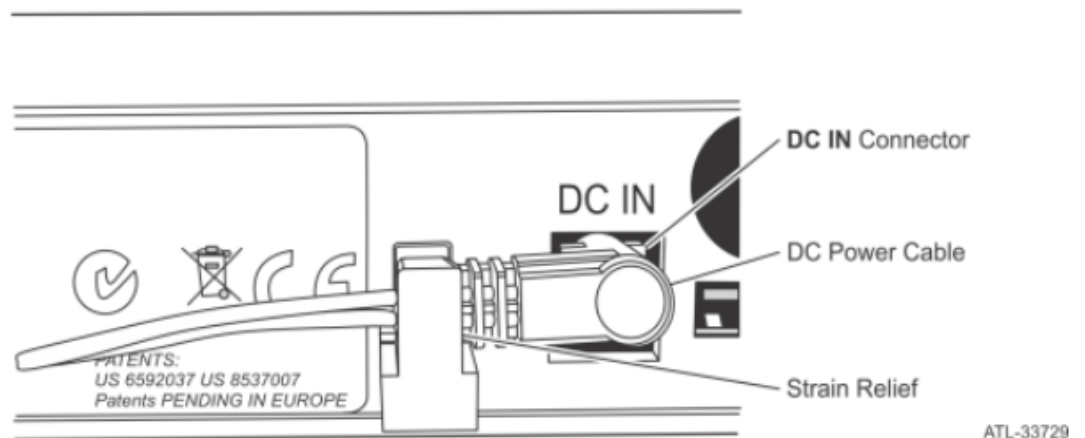

4. Place the Checkpoint Controller beside the kiosk.



Caution: At this point, the Checkpoint Antenna Cable is still connected to the Checkpoint Controller. Be careful not to pull too much on the cable.

5. Disconnect the AC Power Cord from the Checkpoint Power Supply, and then remove the Checkpoint Power Supply from the mounting bracket.

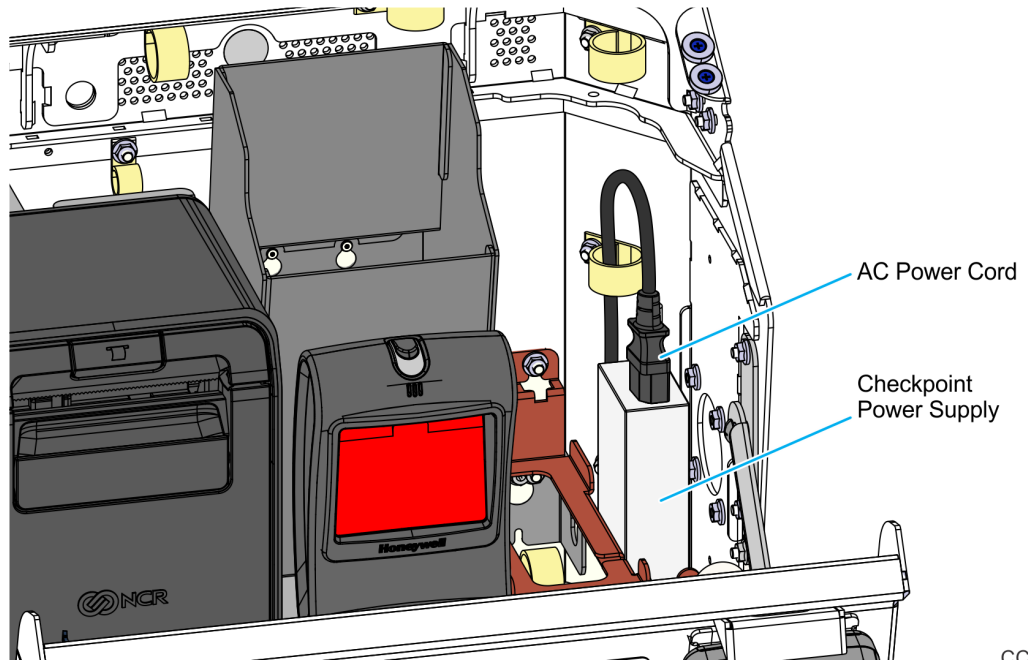

CCP-78187

6. Remove the two hex nuts that secure the Checkpoint mounting bracket onto the side of the lower module.

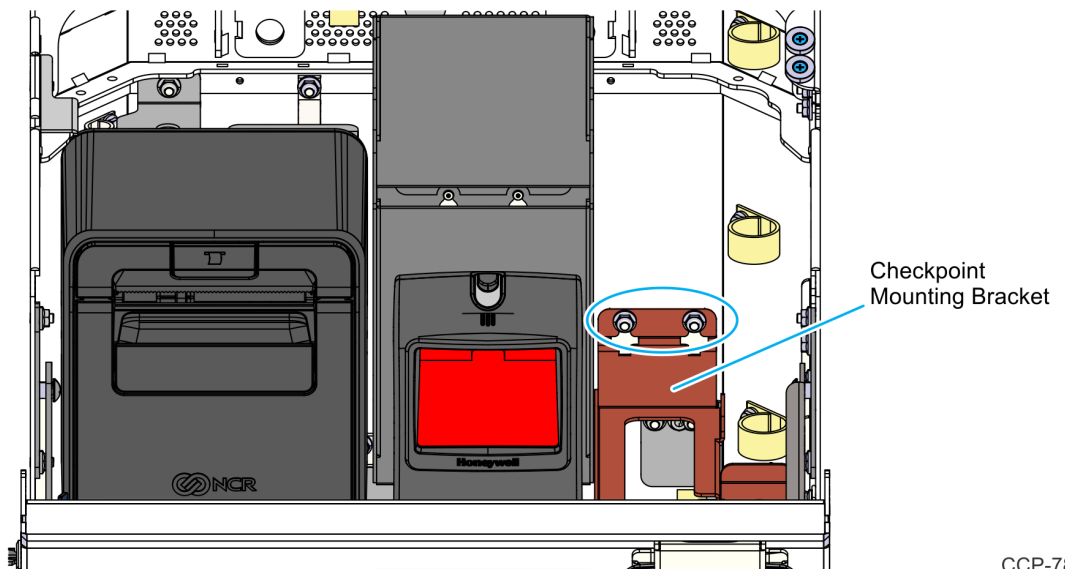

CCP-78186

Installing the Checkpoint Controller and Power Supply

1. Install the Checkpoint mounting bracket on the right inner side of the lower module and secure it with the two hex nuts.

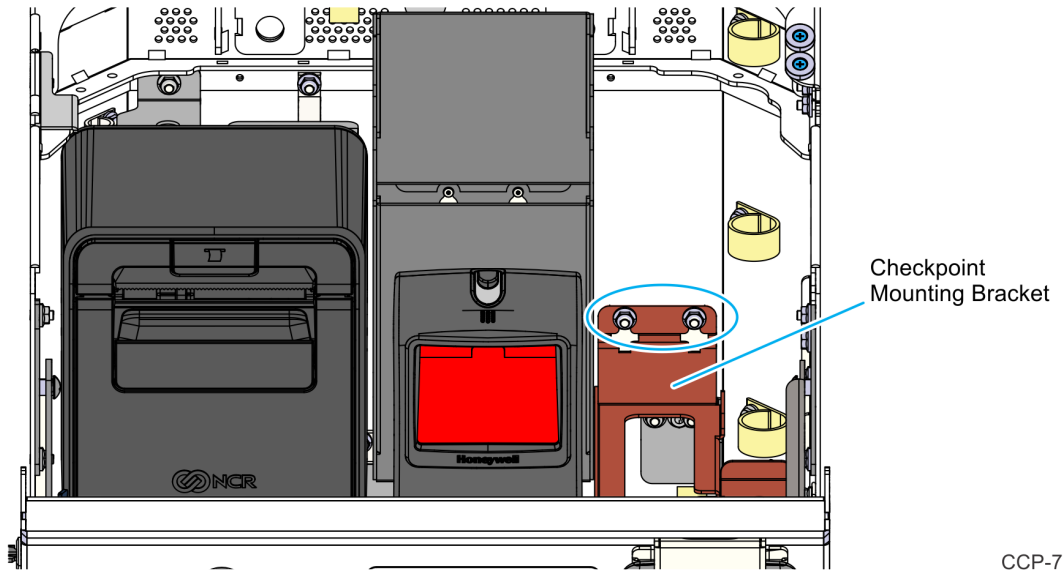

CCP-78186

2. Install the Checkpoint Power Supply.

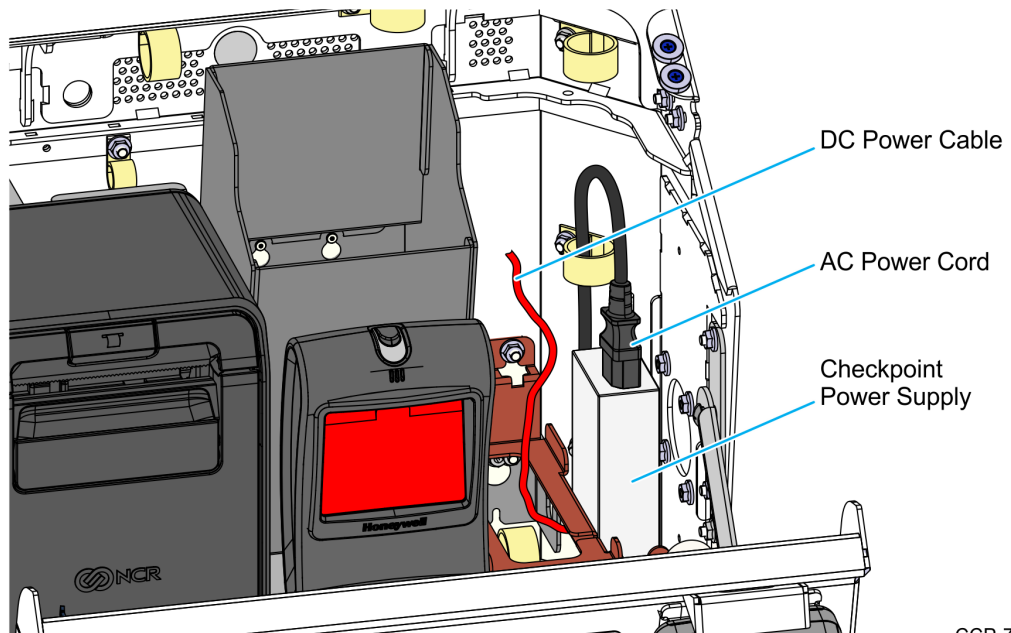

CCP-78185

- a. Route the DC Power Cable of the power supply through the bottom access hole of the mounting bracket.
- b. Position the power supply on the right side of the mounting bracket.
- c. Connect the AC Power Cord to the power supply.

3. Connect the DC Power Cable to the DC In connector at the bottom of the Checkpoint Controller and slide the jack behind the Strain Relief.

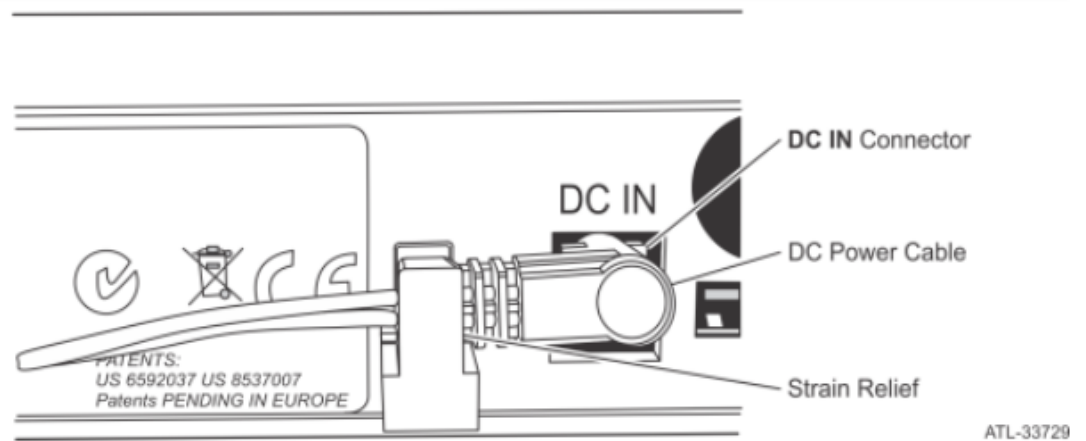

4. Install the Checkpoint Controller.
 - a. Route the Checkpoint Signal Cable through the bottom access hole of the mounting bracket and partially route it through the p-loops beside the Checkpoint Power Supply.

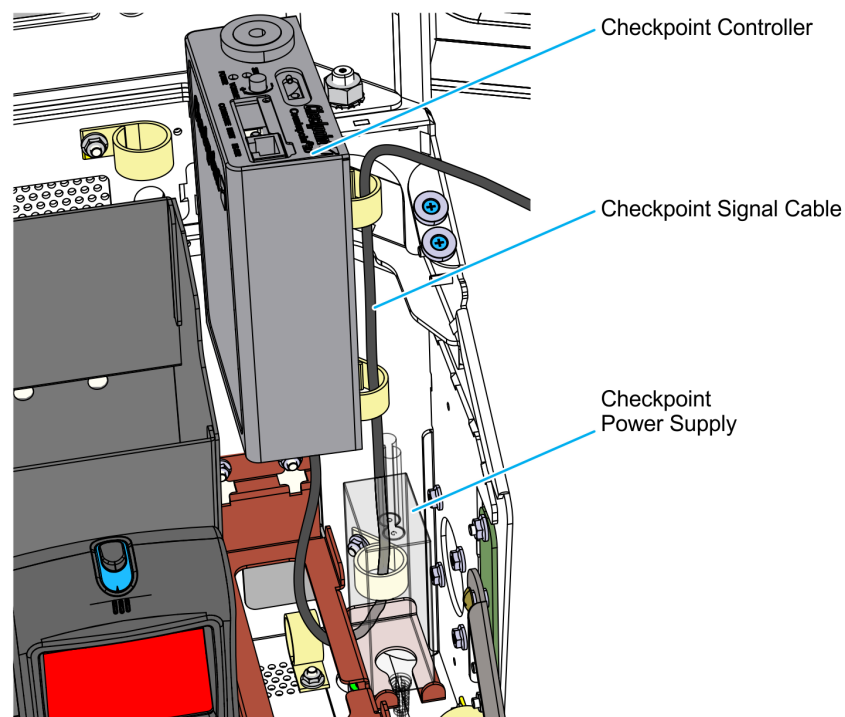

- b. Position the Checkpoint Antenna Cable onto the cable slot on the mounting bracket, and place the Checkpoint Controller on the mounting bracket.



Caution: Ensure that no cables are pinched.

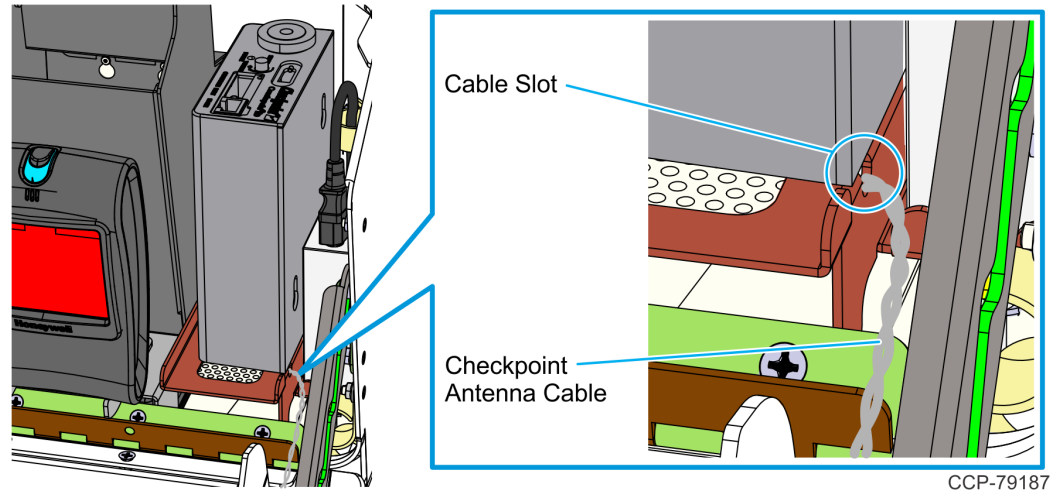

- c. Route the Checkpoint Antenna Cable through the p-loop indicated in the image, and then tuck the excess cable length under the Checkpoint Controller mounting bracket.

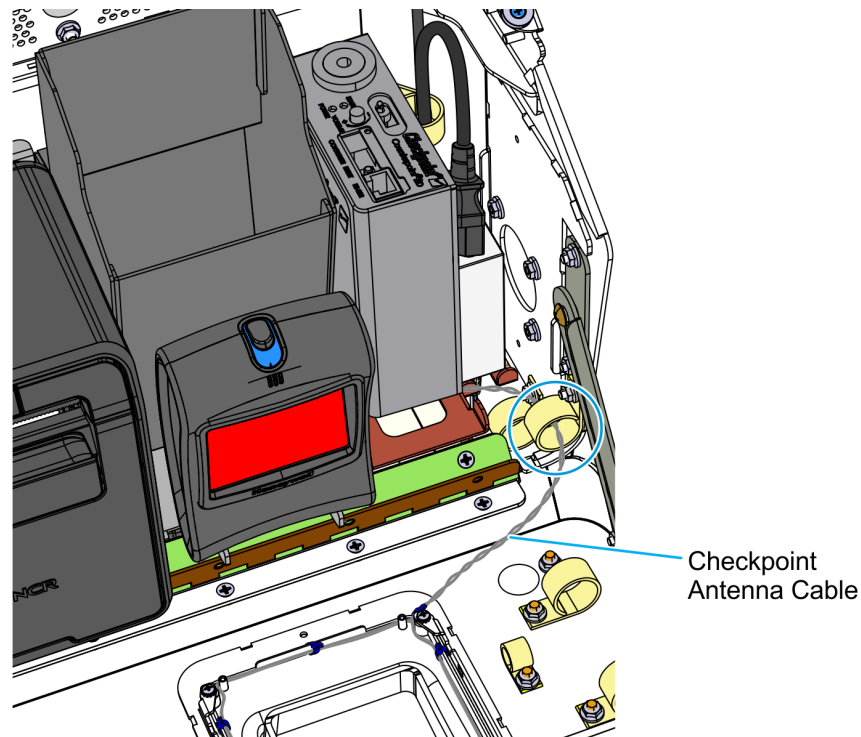

- d. Using a cable tie, bundle any excess length of the DC Power Cable. Place the bundle underneath the Checkpoint Controller mounting bracket.

- e. Install the Checkpoint lock bracket on the right inner side of the lower module and secure it with the two hex nuts.

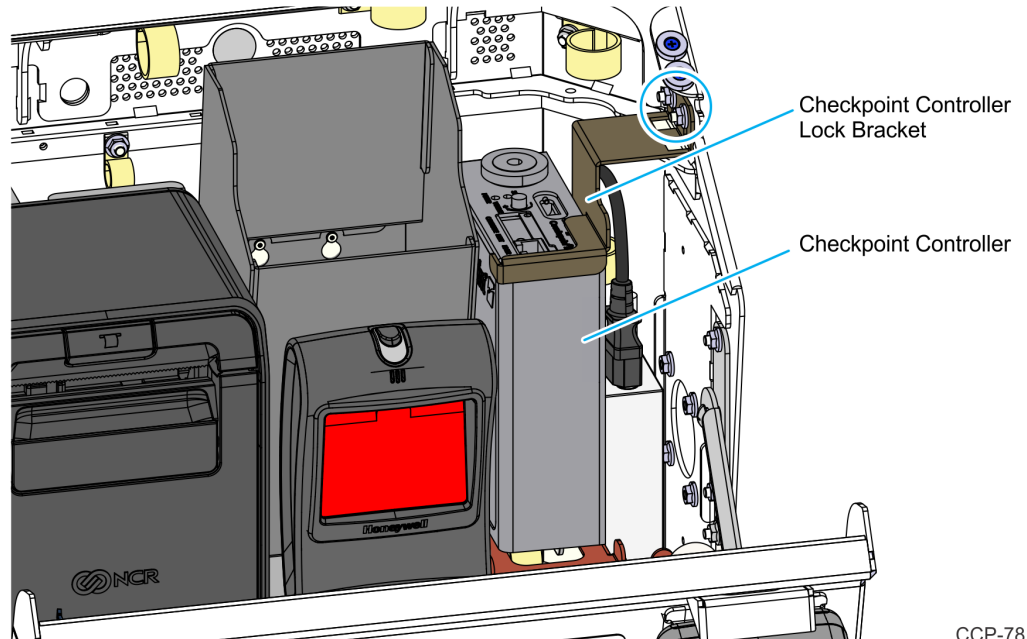

CCP-78188

5. Connect the Checkpoint Signal Cable connector to the **CKPT** connector on the I/O Adapter. Secure it with p-loops along its route.

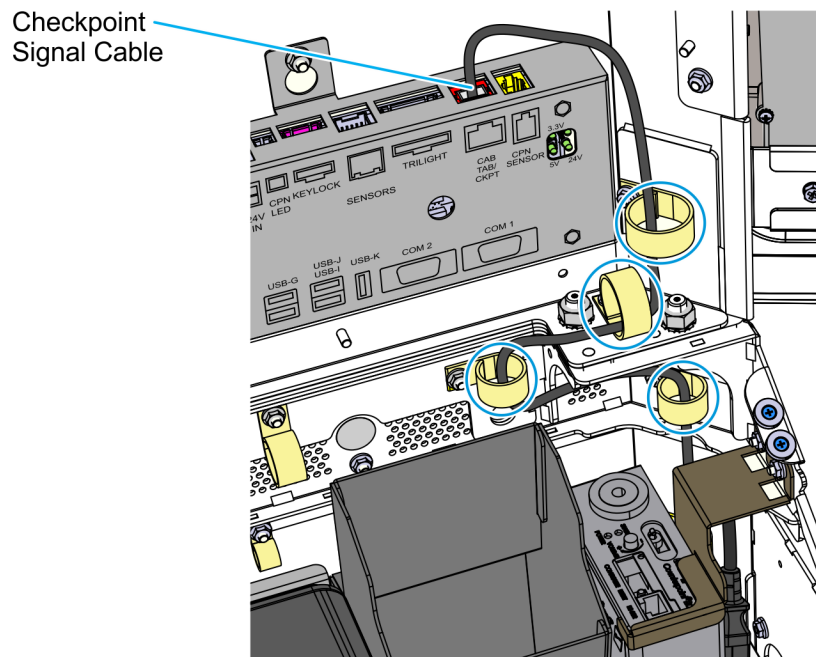

CCP-79186

Routing the Cables

1. Remove the nuts that secure the p-loops and the blanking plate to the inner back surface of the lower module, and then remove the p-loops and the blanking plate from their mounting studs.

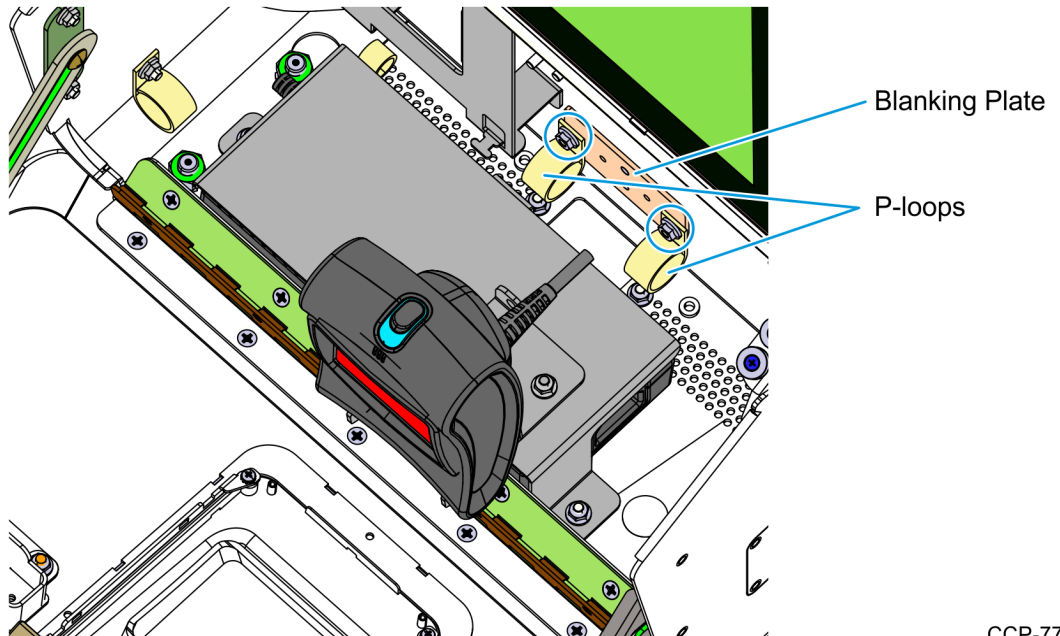

CCP-77922

2. Install the blanking plate on the mounting studs behind the Power Supply, and then secure it with two nuts.

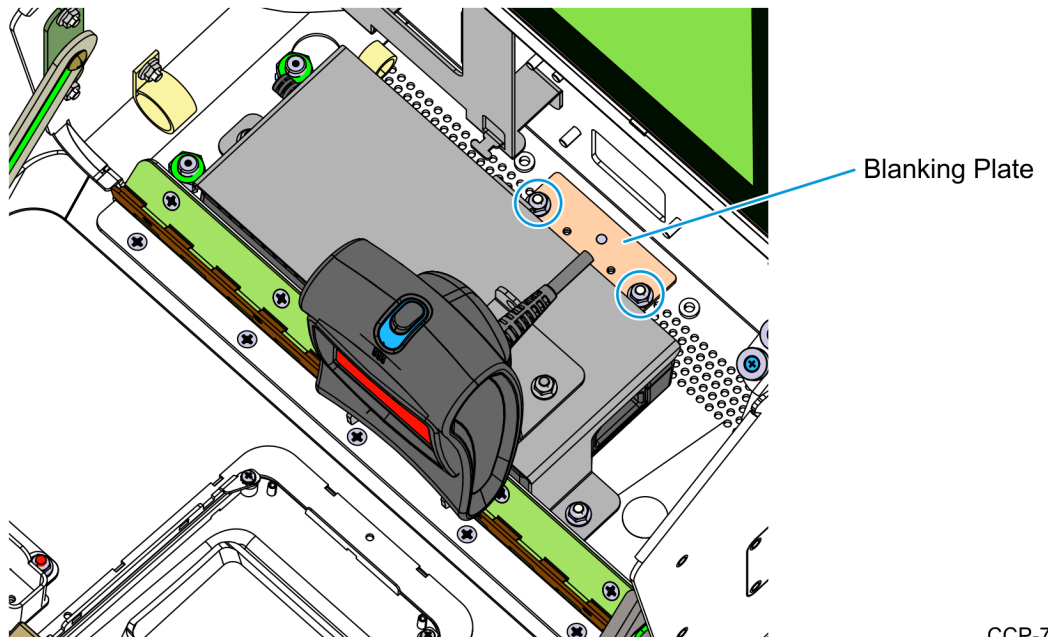

CCP-76695

3. Re-install the p-loops onto the studs on the inner back wall of the lower module, and then secure them with nuts.

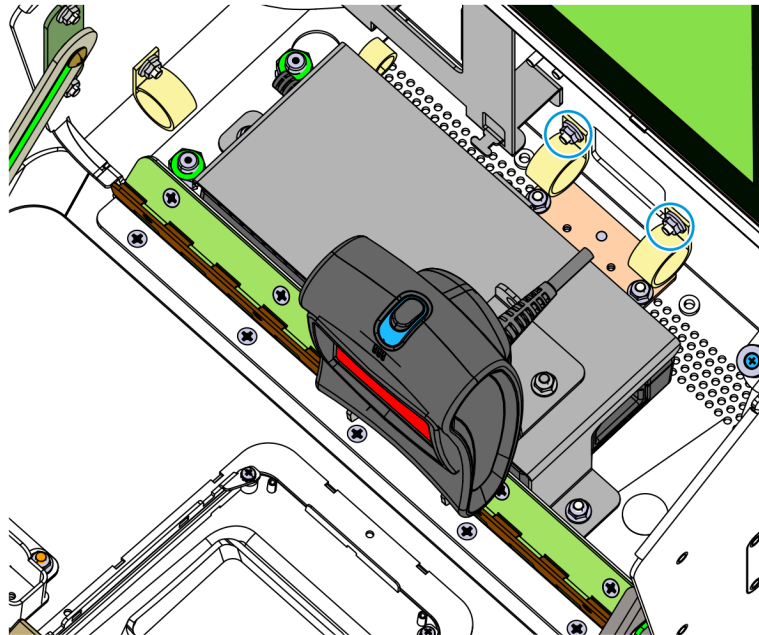

CCP-76694

4. Unpack the AC Power Cable.



Note: The AC Power Cable is bundled and packed inside the center cutout of the foam pack.

5. Insert the AC Power Cable connector through the access hole on the rear of the kiosk, and then connect it to the power brick.

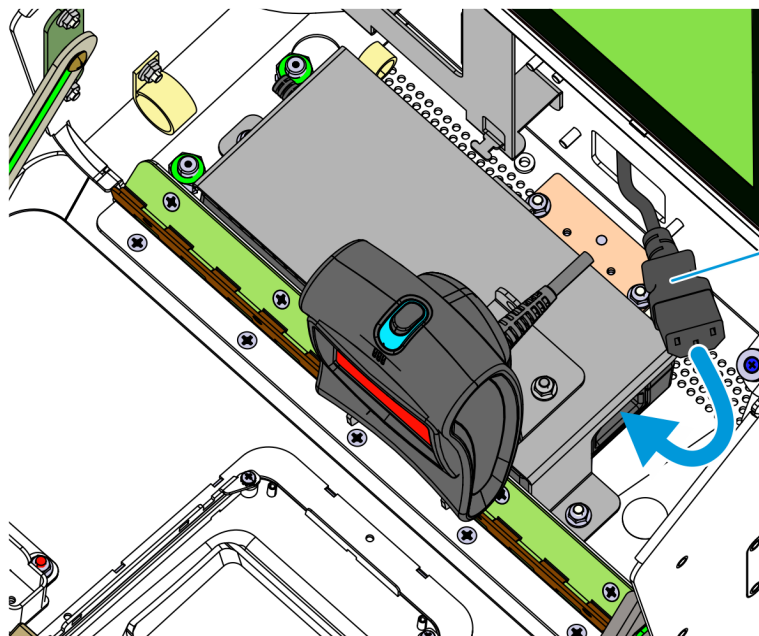

CCP-77924

6. Route the AC Power Cable and the LAN Cable through the p-loops and through the access hole on the rear of the kiosk.

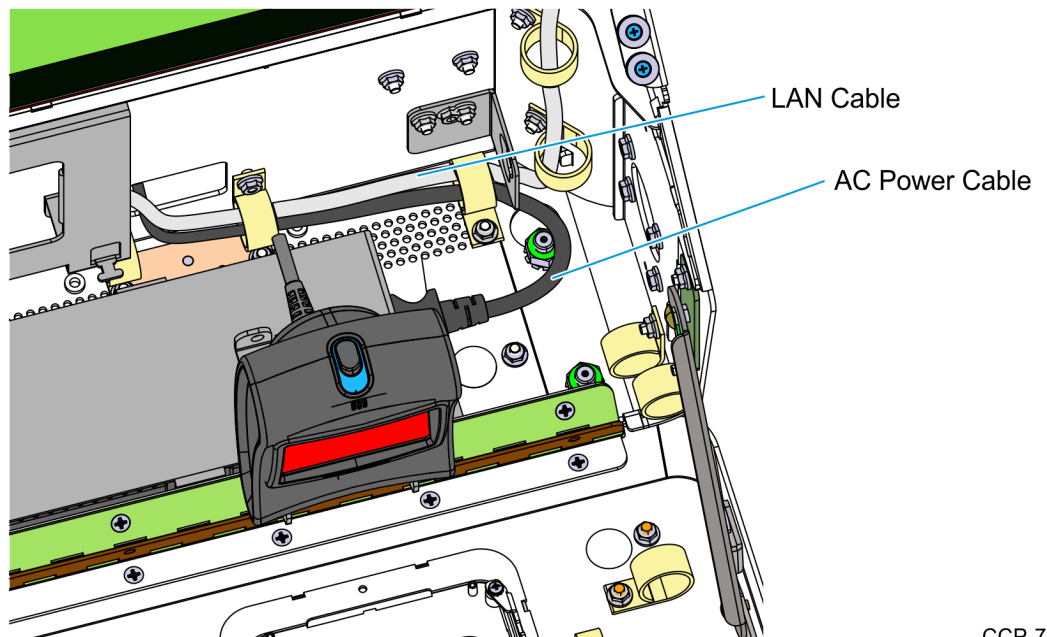

CCP-76692

