



# SpacePole Display Mount, with 2x20 Mount Kit Instructions

---



1668-K106  
Issue D

# Copyright and Trademark Information

---

The products described in this document are copyrighted works of NCR Voyix Corporation.

NCR Voyix 1668 is a trademark of NCR Voyix Corporation in the United States and/or other countries. Other product names mentioned in this publication may be trademarks or registered trademarks of their respective companies and are hereby acknowledged.

Where creation of derivative works, modifications or copies of this NCR Voyix copyrighted documentation is permitted under the terms and conditions of an agreement you have with NCR Voyix, NCR Voyix's copyright notice must be included.

Disclaimer:

It is the policy of NCR Voyix Corporation to improve products as technology, components, software and firmware become available. NCR Voyix therefore reserves the right to change specifications without prior notice.

All features, functions and operations described herein may not be marketed by NCR Voyix in all parts of the world. In some instances, photographs are of equipment prototypes.

Therefore, before using this document, consult with your NCR Voyix representative or NCR Voyix office for information that is applicable and current.

© 2017–2025

By NCR Voyix Corporation

Atlanta, Georgia, USA

All Rights Reserved

Confidential and proprietary information of NCR Voyix.

Use and disclose solely pursuant to company instructions.

# Table of Contents

---

<b>SpacePole Display Mount with 2x20 Mount</b> .....	<b>5</b>
Kit Contents .....	5
Dimensions .....	5
Installation Procedure .....	6

# Revision Record

---

Publication issue	Date	Description of change
A	Apr 2017	First issue
B	Dec 2017	Added pole dimensions
C	Sep 2020	<ul style="list-style-type: none"><li>• Updated Kit Contents illustration</li><li>• Added XL Display</li></ul>
D	Sep 2025	Updated to NCR Voyix brand

# SpacePole Display Mount with 2x20 Mount

This kit provides the components to install a SpacePole Display Mount with 2x20 Mount.

## Kit Contents

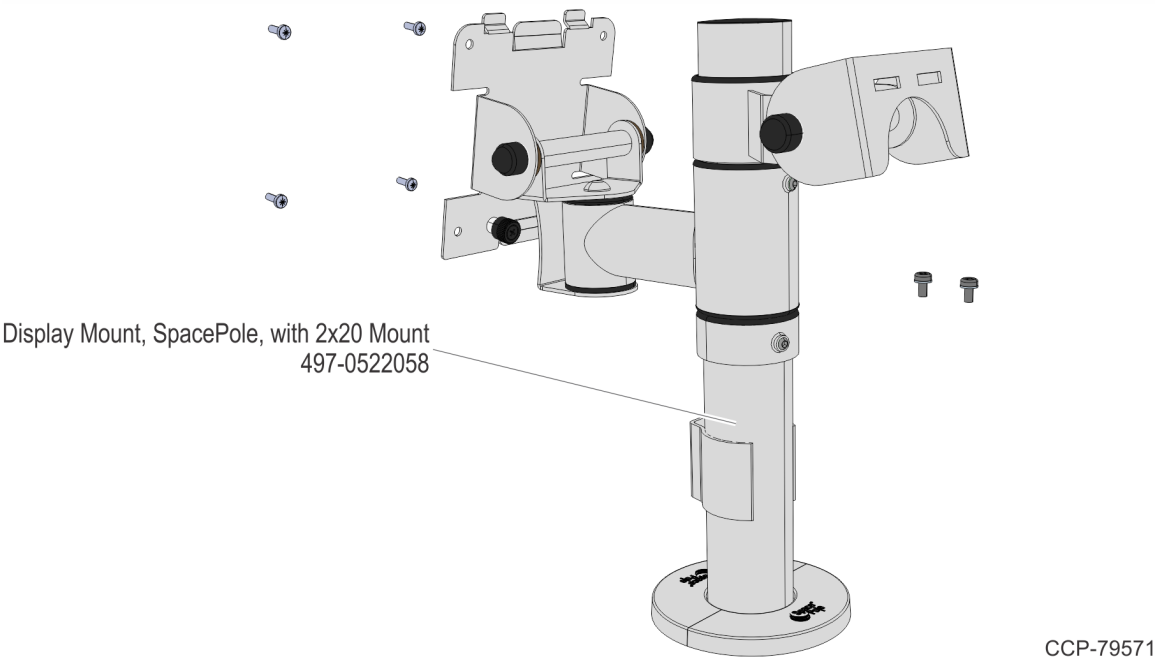

## Dimensions

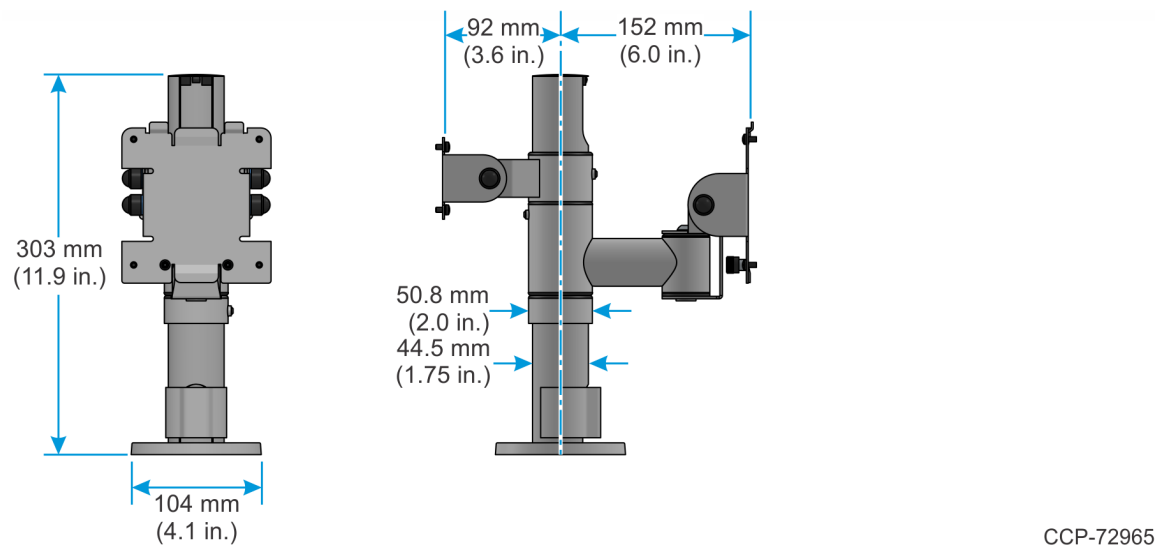

# Installation Procedure

1. For countertop installation, drill four holes for the mounting bolts in the desired location. Use the SpacePole Mount base as a template for locating the holes. Install the SpacePole Display Mount with 2x20 mount and secure with screws (4) or bolts (4) included in the hardware pack or with your preferred fasteners.

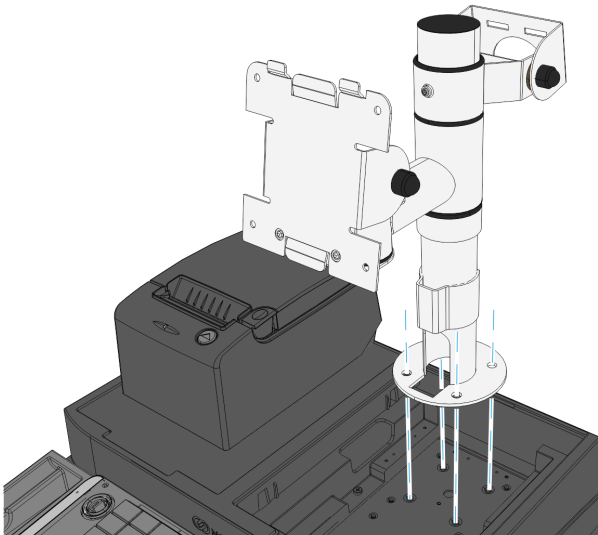

INTEGRATION TRAY

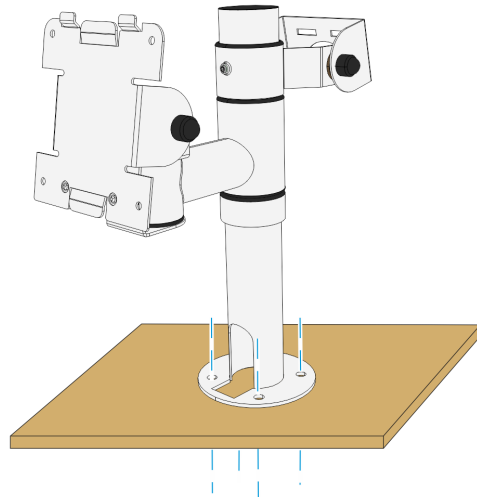

COUNTERTOP

71307

2. Install the Flange Cover.

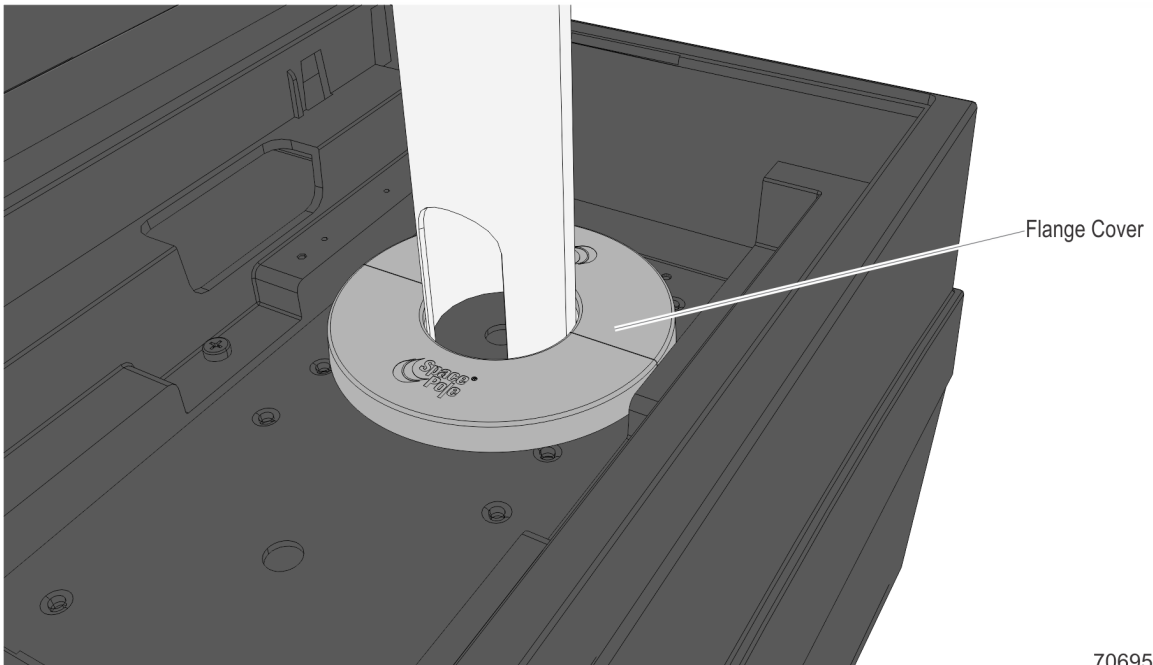

70695

3. Attach the POS main display to the SpacePole arm by sliding the bracket tabs into the head slots.

**Note**

For XL Displays, connect the cables to the back of the display before mounting the display on the bracket.

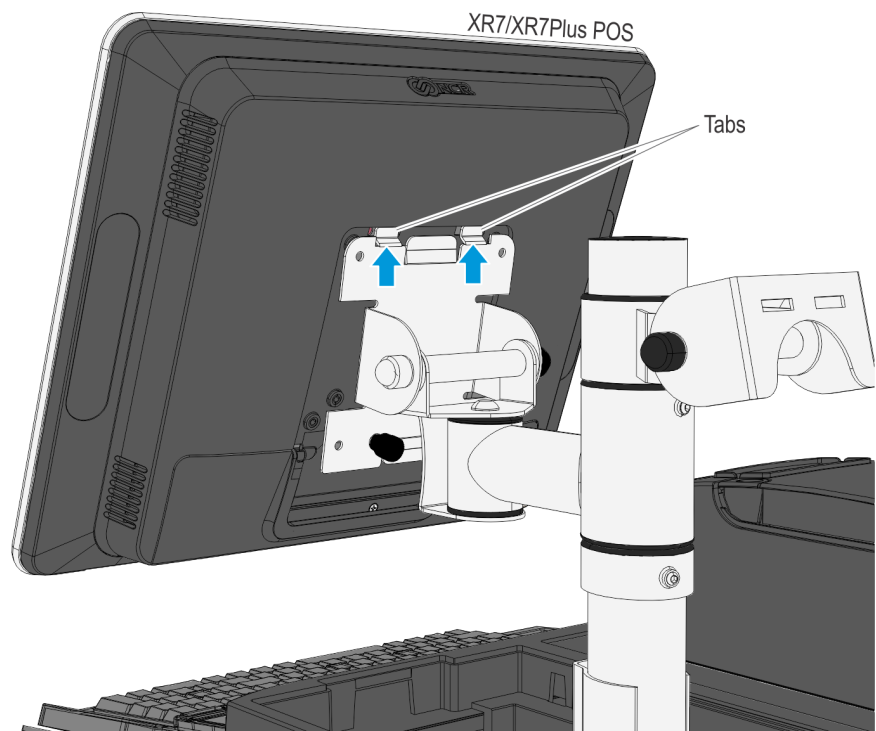
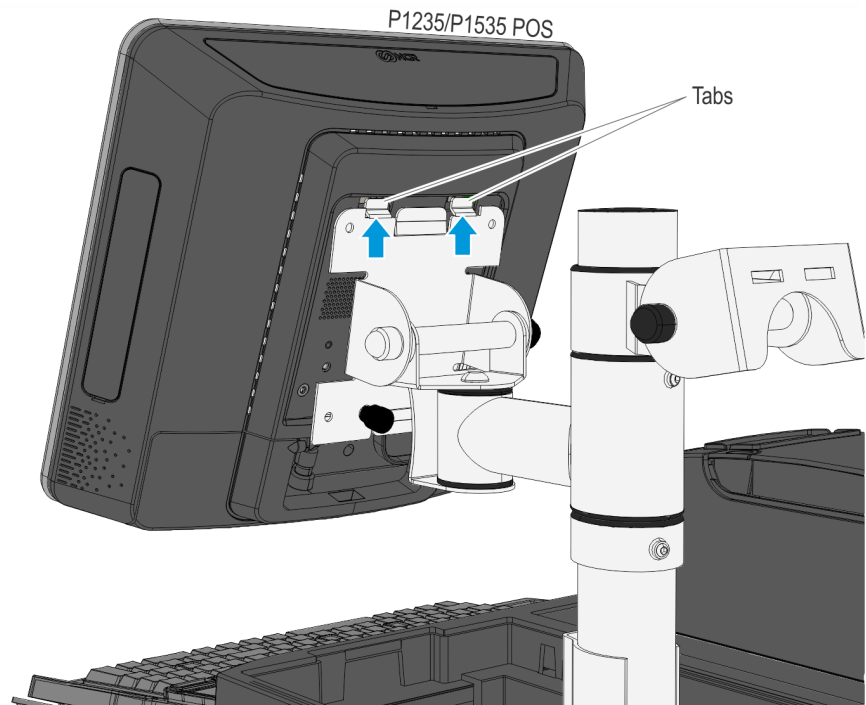

CCP-79580

4. Tighten the (2) thumbscrews at the bottom of the bracket to secure the main display. For XL Displays, tighten the (2) thumbscrews and install (4) M4x12 screws to secure the display.

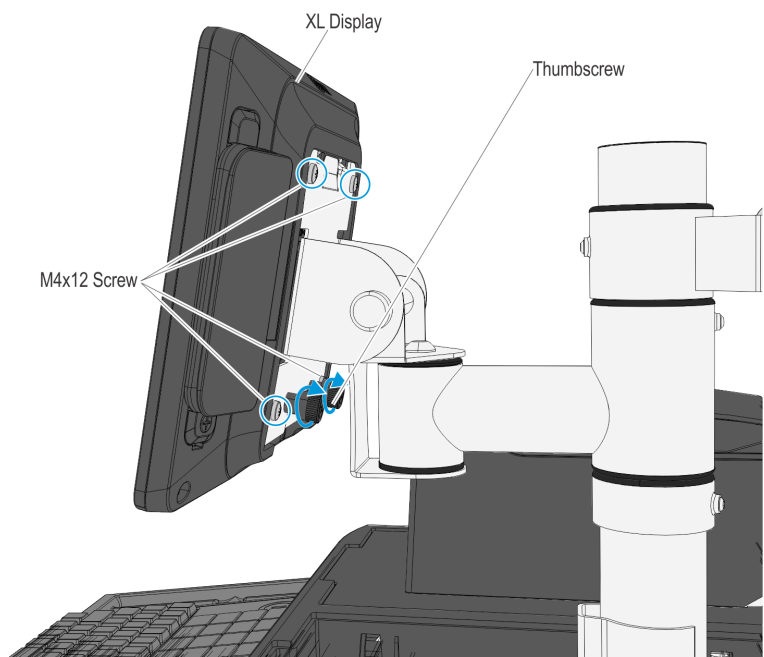
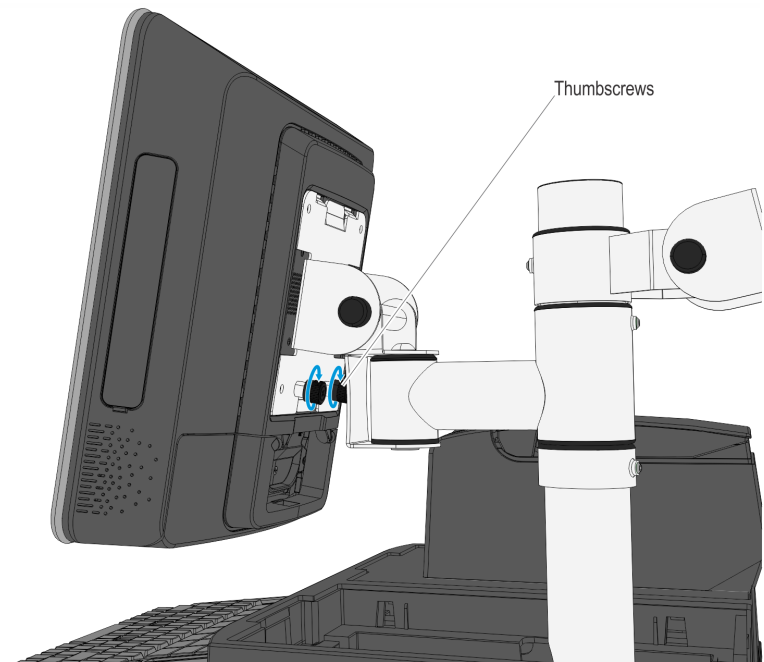

CCP-79572



5. Attach the 2x20 customer display to the SpacePole arm and secure with screws (2).

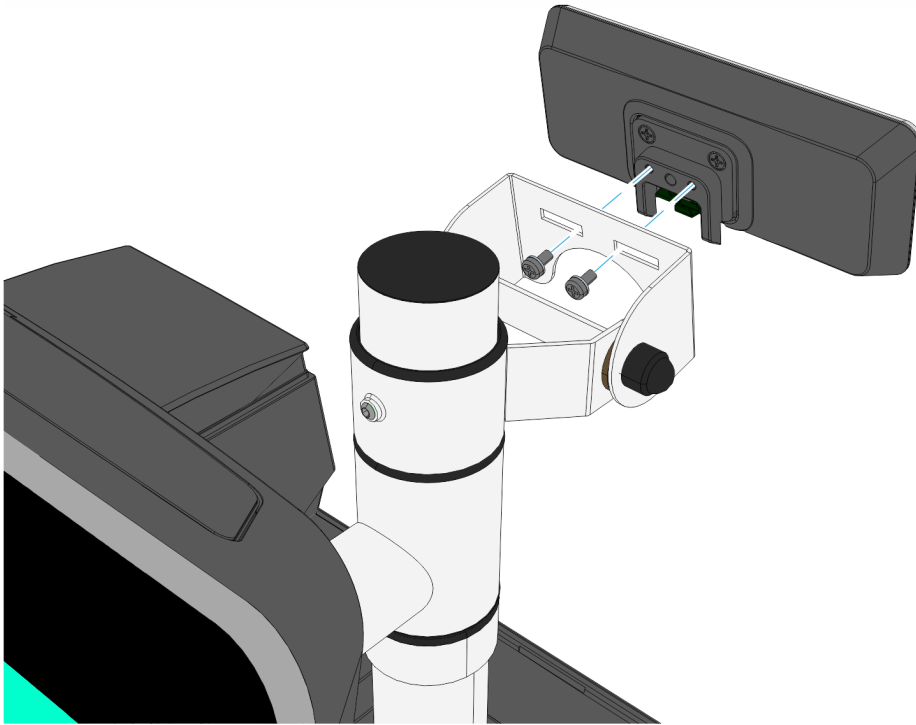

71310

6. Pivot the main display towards the back.

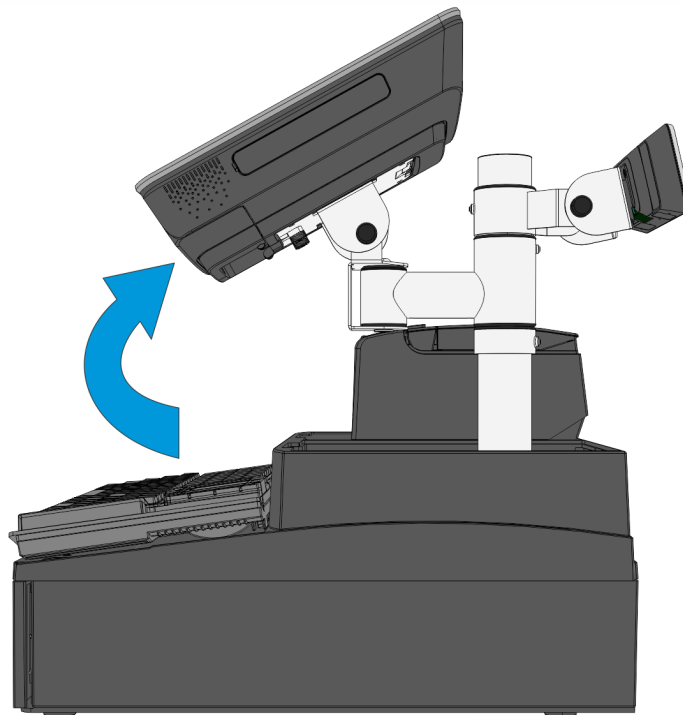

71311

7. Open the Terminal Cable Cover.

**NCR P1235 POS (7745)/NCR P1535 POS (7761)**

- Loosen the screw on the Terminal Cable Cover. To open, press the indentations in the Cable Cover to unlatch the cover then pivot to open.

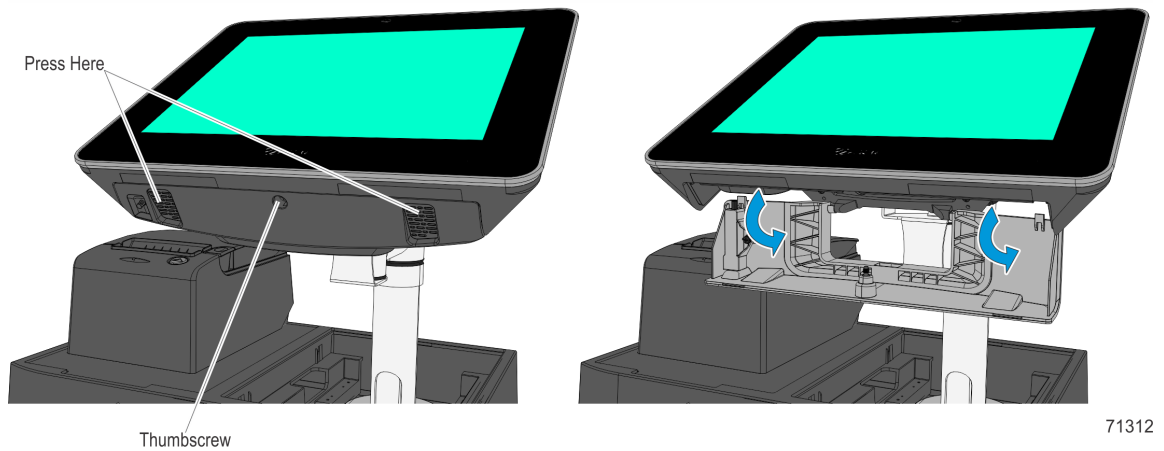

**NCR XR7 POS (7702)/NCR XR7 Plus POS (7703)**

- Press on the indentations in the Cable Cover to unlatch the cover and then pivot the cover open.

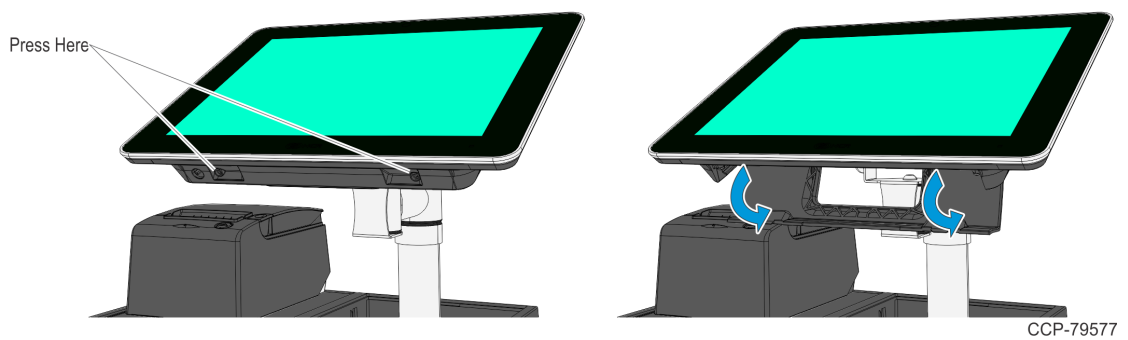

8. Route the customer display cable to the main display and connect to the corresponding connectors. Close the Cable Cover.

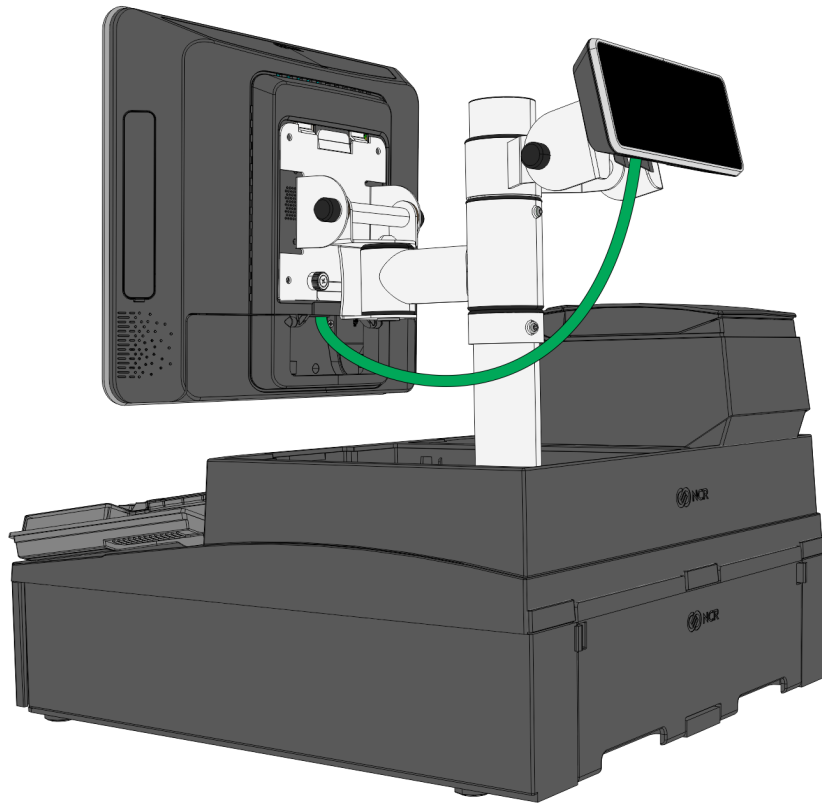

71313

9. Route the cables from the main display down the SpacePole Mount and out of the integration tray or countertop.

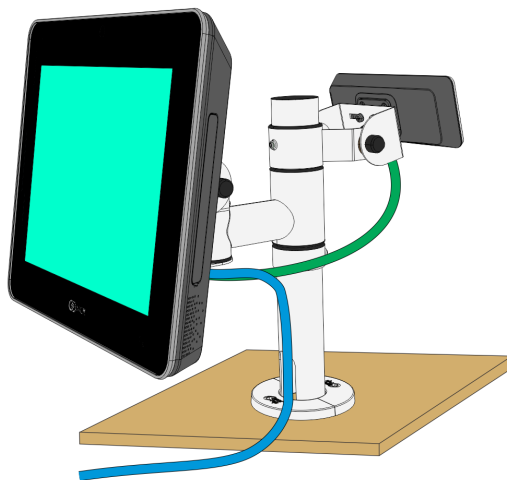
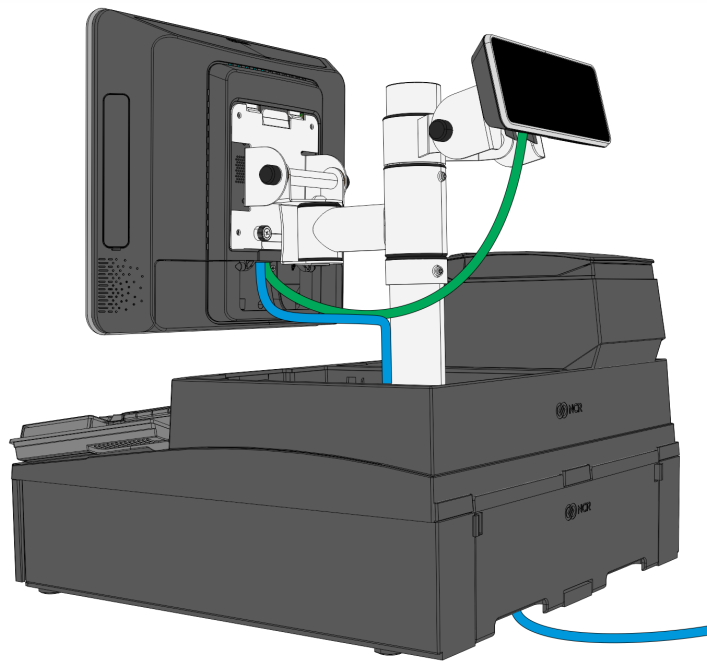

COUNTERTOP WITHOUT HOLE

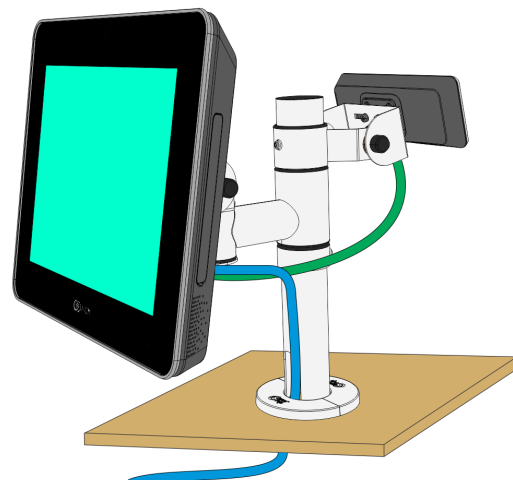

COUNTERTOP WITH HOLE

71314

10. Install the Cable Clip to secure the cables.

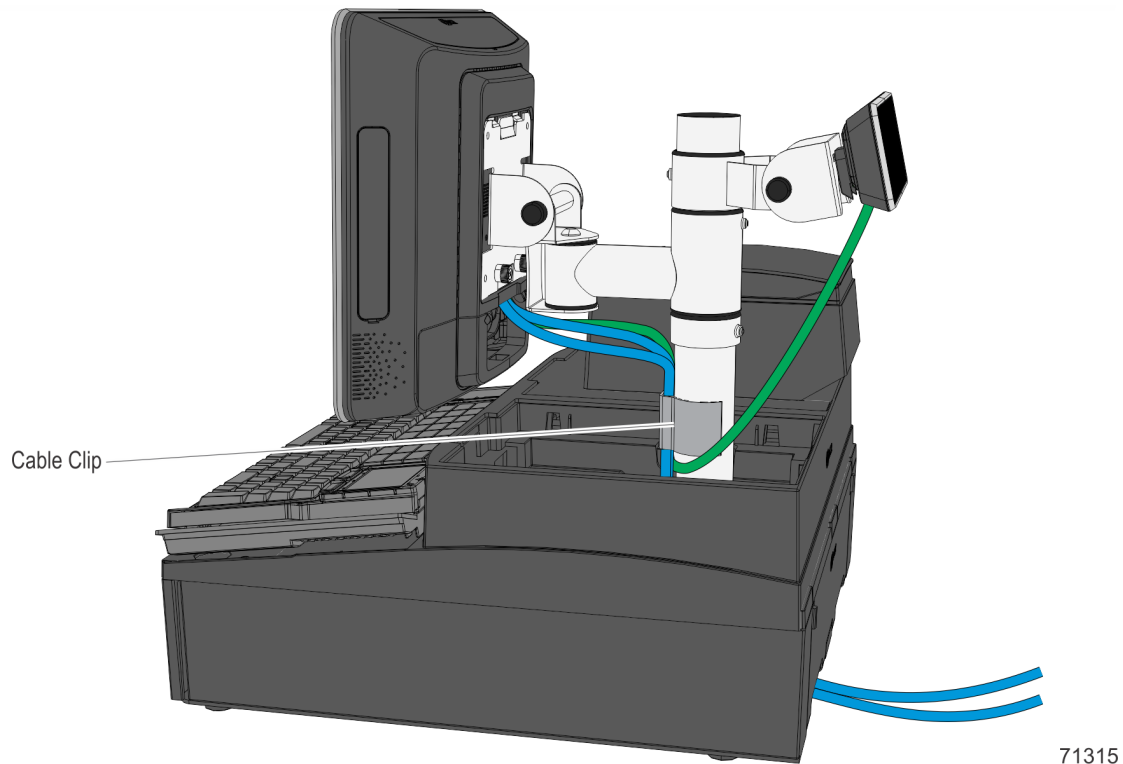

11. Add the integration tray cover.

